

Operating and installation instructions

Fridge-freezer combination



To prevent the risk of accidents or damage to the appliance, it is **essential** to read these instructions before it is installed and used for the first time.

Contents

Description of the appliance	5
Caring for the environment	7
Warning and Safety instructions	8
How to save energy	17
Switching on and off	19
Switching the appliance on	19
Operation	19
Switching off	20
Further settings	21
Switching off for longer periods of time	22
The correct temperature	23
. . . in the refrigerator and the MasterFresh zone	23
DynamicCooling	23
. . . in the freezer	23
Setting the temperature in the refrigerator/freezer zones	24
Temperature range	24
Temperature (Fahrenheit/Celsius)	25
Temperature display	26
Alarm	27
SuperCool and SuperFreeze	29
SuperCool	29
Using the refrigerator efficiently	31
Different storage zones	31
Food which should not be stored in a refrigerator	33
What to be aware of when shopping for food	33
Storing food correctly	33
Storing food in the MasterFresh zones	34
Storage temperature	34
Humidity level	34
Storing food in the MasterFresh zones	34
Arranging the interior fittings	37
Moving the shelves	37
Floating deli drawer	37
The MasterFresh drawer	37
Adjusting the door shelves/bottle shelf	38
To remove the shelf above the MasterFresh drawer	39
Small freezer basket	39

Large freezer basket with dividing panel	40
Freezing and storing food	41
Freezing fresh food	41
Storing frozen food	41
Home freezing	42
Defrosting	43
Cooling drinks	44
Making ice cubes	45
Defrosting	47
Cleaning and care	48
Before cleaning	48
Cleaning the interior and accessories	48
Ice cube container	49
Humidity filters	50
Ventilation gaps	50
Door seals	51
Problem solving guide	52
Water filter	58
Reminder to change the water filter	58
To change the water filter	59
To confirm the water filter has been changed	60
Using an external water filter	60
Noises	61
After Sales / Warranty	62
Warranty	62
Mains water connection	63
Notes on connecting to the mains water supply	63
Preparing for plumbing the appliance into the mains water supply	64
Fitting the stainless steel hose to the appliance	66
Electrical connection	67
Installation advice	68
Location	68
Climate range	68
Floor	70
Door hinging	70
Adjoining furniture/units	70

Contents

Ventilation	70
Side-by-side installation.	70
Limiting the opening angle of the door	72
Appliance door dimensions (opening angle 90°)	73
Appliance door dimensions (opening angle 115°)	74
Building-in dimensions	75
Installation	77
Tools and accessories required	77
Weight of the door fronts	78
Building into a peninsular run	78
Building-in at the end of a run of units.	78
Aligning the housing unit	79
Checking the building-in niche	79
Before installation	79
Preparing the niche	80
Assembly parts	80
Anti-tipping mechanism	81
Placing the appliance in the niche	83
Aligning the appliance.	84
Securing the appliance in the niche	85
Preparing the furniture fronts	87
Securing and aligning the furniture door.	89
Securing the covers.	91
Fitting the plinth facing	92
Fitting the air separator	93
Contact details	95

Description of the appliance

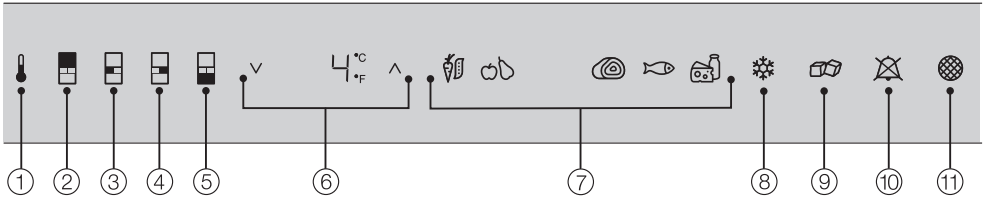

- ① Access sensor
- ② Sensor for selecting the refrigerator zone
- ③ Sensor for selecting the left-hand MasterFresh drawer
- ④ Sensor for selecting the right-hand MasterFresh drawer
- ⑤ Sensor for selecting the freezer zone
- ⑥ Sensor for selecting the temperature in the refrigerator or freezer zone (V for colder; ^ for warmer)
- ⑦ Sensors for selecting the humidity in the MasterFresh drawers (left: high humidity; right: low humidity)
- ⑧ On/Off sensor for the SuperCool and SuperFreeze functions
- ⑨ On/Off sensor for the ice cube maker (only visible if the freezer zone has been selected)
- ⑩ Sensor for switching off the temperature or door alarm (only visible when the temperature or door alarm is sounding)
- ⑪ Reminder to change the water filter

Description of the appliance

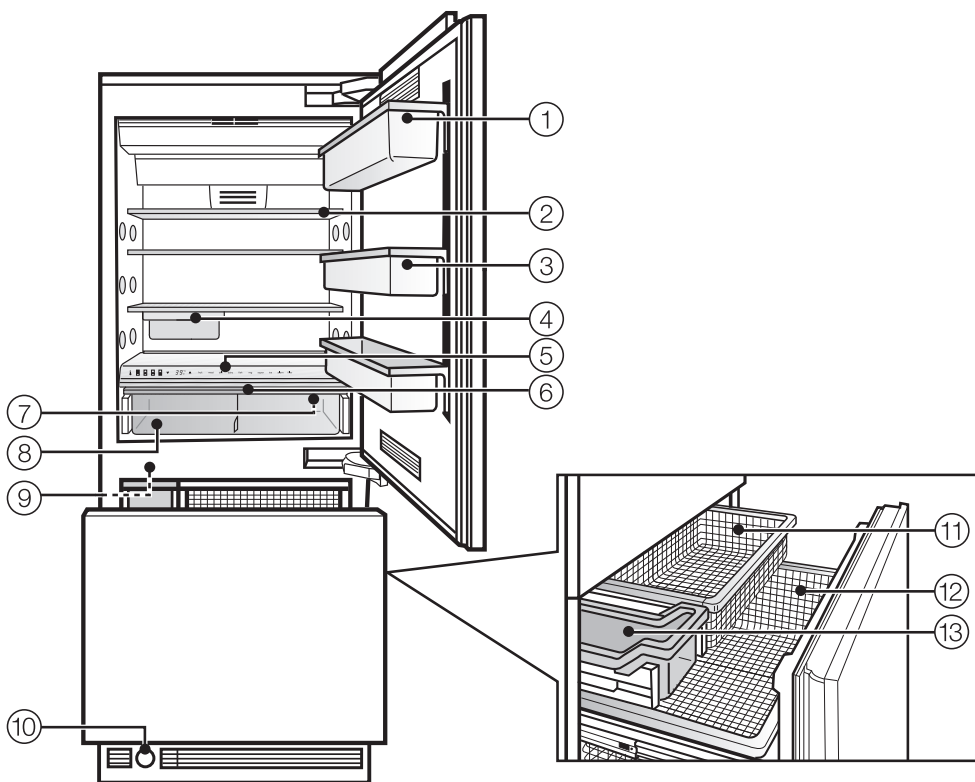

- ① Butter and cheese compartment
- ② Adjustable shelf
- ③ Door shelf
- ④ Floating deli drawer
- ⑤ Control panel
- ⑥ Humidity filters for the MasterFresh zones

- ⑦ Rocker switch for switching the whole appliance on and off
- ⑧ MasterFresh zones
- ⑨ Ice cube maker
- ⑩ Water filter
- ⑪ Small freezer basket
- ⑫ Large freezer basket
- ⑬ Ice cube container

Disposal of the packing material

The transport and protective packing has been selected from materials which are environmentally friendly for disposal and can normally be recycled.

Ensure that any plastic wrappings, bags, etc. are disposed of safely and kept out of the reach of babies and young children. Danger of suffocation.

Rather than just throwing these materials away, please ensure they are offered for recycling.

Disposing of your old appliance

Electrical and electronic appliances often contain materials which, if handled or disposed of incorrectly, could be potentially hazardous to human health and to the environment. They are, however, essential for the correct functioning of your appliance. Please do not therefore dispose of it with your household waste.

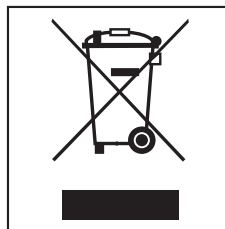

Please dispose of it at your local community waste collection / recycling centre and ensure that it presents no danger to children while being stored for disposal.

The plug must be rendered useless and the cable cut off directly behind the appliance to prevent misuse. Take care not to damage the pipework at the back of it before or during transportation to an authorised collection depot. In this way, refrigerant in the pipework and oil in the compressor will be contained, and will not leak out into the environment.

Warning and Safety instructions

This appliance complies with all relevant local and national safety requirements. Improper use of the appliance can, however, present a risk of both personal injury and material damage.

To avoid the risk of accidents and damage to the appliance, please read these instructions carefully before installation and before using it for the first time. They contain important notes on the installation, safety, operation and care of the appliance. Miele cannot be held liable for damage caused by non-compliance with these Warning and Safety instructions.

Keep these instructions in a safe place and pass them on to any future owner.



Danger of injury!

This appliance is very heavy and can tip forwards when the door is open. Keep the appliance door shut until the appliance has been built in and secured in its housing in accordance with these operating and installation instructions.

Correct application

► This appliance is designed for domestic use and for use in similar environments by guests in hotel or motel rooms, bed & breakfasts and other typical living quarters. This does not include common/shared facilities or commercial facilities within hotels, motels or bed & breakfasts.

This appliance is not suitable for outdoor use.

Warning and Safety instructions

► This appliance is intended only for the cool storage of food and drink as well as for storing deep frozen food, freezing fresh food and for preparing ice.

Any other usage is at the owner's risk and could be dangerous.

► This appliance is not suitable for storing and refrigerating medications, blood plasma, laboratory preparations or similar substances or products. Incorrect use of the appliance may result in damage to or spoiling of the food or drinks being stored.

Furthermore, the appliance must not be operated in areas where explosions may occur.

Miele cannot be held liable for damage resulting from improper or incorrect use of the appliance.

► This appliance is not intended for use by persons (including children) with reduced physical, sensory or mental capabilities, or lack of experience and knowledge, unless they have been given supervision or instruction concerning its use by a person responsible for their safety, and are able to recognise the dangers of misuse.

Safety with children

► Young children must not be allowed to use this appliance.

► Older children may only use the appliance when its operation has been clearly explained to them and they are able to use it safely, recognising the dangers of misuse.

► Cleaning work may only be carried out by older children under the supervision of an adult.

Warning and Safety instructions

▶ Children should be supervised when they are near the appliance. This appliance is not a toy! To avoid the risk of injury, do not allow children to play with it or to use the controls. They will not understand the potential dangers posed by it. They should be supervised whenever you are working in the kitchen.

▶ The door hinges can cause injury. Keep children well away at all times.

▶ Please bear in mind that by removing the dividing panel in the large freezer basket, children may be tempted to climb inside. **THIS COULD PUT THEIR LIVES IN DANGER.**

▶ Danger of suffocation! Children may be able to wrap themselves in packing material or pull it over their heads with the risk of suffocation. Keep children away from any packing material.

Technical safety

▶ The refrigerant circuit has been checked for leaks. This appliance complies with all current local and national safety requirements.

▶ This appliance contains the coolant Isobutane (R600a), a natural gas which is environmentally friendly. Although it is flammable, it does not damage the ozone layer and does not increase the greenhouse effect.

The use of this coolant has, however, led to a slight increase in the noise level of the appliance. In addition to the noise of the compressor, you might be able to hear the coolant flowing around the system. This is unavoidable, and does not have any adverse effect on the performance of the appliance.

Care must be taken during the transportation and setting up of the appliance that no parts of the cooling system are damaged. Leaking refrigerant can damage the eyes.

In the event of any damage:

- avoid any flames or anything which creates a spark,

Warning and Safety instructions

- switch off at the mains and unplug the appliance,
- ventilate the room where the appliance is located for several minutes, and
- call Miele.

► The more coolant there is in an appliance, the larger the room it should be installed in. In the event of a leakage, if the appliance is in a small room, there is the danger of combustible gases building up. For every 8 g of coolant at least 1 m³ of room space is required. The amount of coolant in the appliance is stated on the data plate inside the appliance.

► Before connecting the appliance, make sure that the connection data on the data plate (fuse rating, voltage and rated load) matches the mains electricity supply. This data must correspond in order to avoid the risk of damage to the appliance.

Consult a qualified electrician if in any doubt.

► The electrical safety of this appliance can only be guaranteed when continuity is complete between it and an effective earthing system which complies with local and national safety regulations. It is most important that this basic safety requirement is present and tested regularly and, where there is any doubt, the household wiring system should be inspected by a qualified electrician.

► If the connection cable is faulty, it must only be replaced by a Miele approved service technician to protect the user from danger.

► Do not connect the appliance to the mains electricity supply by a multi-socket unit or an extension lead. These do not guarantee the required safety of the appliance (e.g. danger of overheating).

Warning and Safety instructions

► If moisture gets into electrical components, it could cause a short circuit.

Therefore, do not operate this appliance in areas which are exposed to moisture.

► This appliance must not be installed and operated in mobile installations (e.g. on a ship).

► A damaged appliance is dangerous. Check the appliance for any visible damage. Never install or attempt to use a damaged appliance.

► For safety reasons, this appliance may only be used when it has been fully installed.

► During installation, maintenance and repair work, the appliance must be disconnected from the mains electricity supply. It is only completely isolated from the electricity supply when:

- the mains fuse has been disconnected, or
- the screw-out fuse is removed (in countries where this is applicable), or
- it is switched off at the wall socket and the plug is withdrawn from the socket, or it is switched off at the isolator.

► Repairs and installation work by unqualified persons could be dangerous. The manufacturer cannot be held liable for unauthorised work. Installation, maintenance work and repairs to electrical appliances must only be carried out by a Miele approved service technician.

► The manufacturer's warranty will be invalidated if the appliance is not repaired by a Miele approved service technician.

Warning and Safety instructions

- ▶ Faulty components must only be replaced by genuine Miele spare parts. The manufacturer can only guarantee the safety of the appliance when Miele replacement parts are used.
- ▶ Miele cannot be held liable for damage caused by a faulty connection to the mains water supply.
- ▶ Connection to the mains water supply and any repairs to the ice cube maker must only be carried out by a Miele approved technician.
- ▶ The ice cube maker is not suitable for connection to a hot water supply.
- ▶ Connect the appliance to a potable water supply only.
- ▶ Before plumbing the appliance in, ensure that it is disconnected from the mains electricity supply.
- ▶ Never tamper with the movable components on the ice cube maker or the element on the ice cube maker. Danger of injury!

Correct use

- ▶ The appliance is designed for use within a certain climate range (ambient temperatures), and should not be used outside this range. The climate range of the appliance is stated on the data plate inside the appliance. Installing the appliance in a room with too low an ambient temperature, e.g. a garage, can lead to the appliance switching off for longer periods so that it cannot maintain the required temperature.
- ▶ To ensure proper air flow in and out of the appliance, the air vents must not be covered or blocked in any way.
It would also increase the energy consumption and could cause damage to the appliance.

Warning and Safety instructions

- ▶ Make sure that any oil, or foods containing oil, do not come into contact with plastic components as this could cause stress cracks.
- ▶ Do not store explosive materials in the appliance or any products containing propellants (e.g. spray cans). Flammable gas mixtures can be ignited by electrical components.
Danger of fire and explosion!
- ▶ Do not operate any electrical equipment (e.g. an electric ice cream maker) inside the appliance. Danger of sparking and explosion!
- ▶ Do not store cans or bottles containing carbonated drinks or liquids which could freeze in the freezer. The cans or bottles could explode causing injury and damage.
- ▶ If storing alcohol with a high percentage proof, make sure it is tightly closed and stored upright in the refrigerator section. Danger of explosion!
- ▶ When cooling drinks quickly in the freezer, make sure bottles are not left in for more than one hour; otherwise they could burst, causing injury and damage.
- ▶ Never handle frozen food or the metal parts of the appliance with wet hands. Your hands may freeze to the frozen food or to the metal.
Danger of injury!
- ▶ Do not take ice cubes out with your bare hands and never place ice cubes or ice lollies in your mouth straight from the freezer. The very low temperature of the frozen ice or lollies can cause frost burn to the lips and tongue. Danger of injury!

Warning and Safety instructions

► Do not refreeze food once it has thawed. Defrosted food should be used up as quickly as possible as food soon loses its nutritional value and goes off. Defrosted food may only be refrozen after it has been cooked.

► Food stored for too long may present a risk of food poisoning. Storage times will depend on several factors, including the freshness and quality of the food, as well as the temperature at which it is stored. Follow the instructions given on the food manufacturer's packaging regarding storage conditions and "use by" dates.

► To avoid the risk of any potential illness, do not deactivate the reminder to change the water filter.

► Use only Miele Original spare parts. If spare parts or accessories from other manufacturers are used, the warranty will be invalidated, and Miele cannot accept liability.

Cleaning and care

► Do not use any oils or grease on the door seal, as these will cause the seal to deteriorate and become porous with time.

► Do not use a steam-cleaning appliance to clean this appliance. Pressurised steam could reach the electrical components and cause a short circuit.

► Do not use sharp edged objects to

- remove frost and ice,
- separate frozen foods and remove ice trays.

They will damage the evaporator, causing irreversible damage to the appliance.

Warning and Safety instructions

► Never place electric heaters or candles in the appliance to defrost it. These can damage the plastic parts.

► Do not use defrosting sprays or de-icers, as they might contain substances which could damage the plastic parts or which could cause a build-up of gases and pose a danger to health.

Disposal of your old appliance

► Before disposing of an old appliance, first make the door lock unusable.

This way you will prevent children from accidentally locking themselves in and endangering their lives.

► Be careful not to damage any part of the pipework whilst awaiting disposal, e.g. by

- puncturing the refrigerant channels in the condenser,
- bending any pipework, or
- scratching the surface coating.

Splashes of refrigerant can harm the eyes.

How to save energy

	Normal energy consumption	Increased energy consumption
Installation/Maintenance	In a ventilated room.	In an enclosed, unventilated room.
	Protected from direct sunlight.	In direct sunlight.
	Not situated near a heat source (radiator, oven).	Situated near a heat source (radiator, oven).
	Where the ideal room temperature is approx. 20 °C.	Where there is a high room temperature.
	Where the cross-section of the air inlet and outlet is not covered and kept free of dust.	Where the air inlets and outlets are covered or dusty.
Temperature settings	Refrigerator section 4 to 5 °C	With a low temperature setting: The lower the temperature in the appliance, the higher the energy consumption.
	MasterFresh zones 1.5 °C	
	Freezer section -18 °C	

How to save energy

	Normal energy consumption	Increased energy consumption
Use	Do not change the arrangement of the drawers and shelves as when delivered.	
	Only open the door when necessary and for as short a time as possible. Store food in an organised way.	Frequent opening of the door for long periods will cause a loss of coldness. The appliance will try to cool down and the running time of the compressor will increase.
	Take a cooler bag when shopping and load food in the appliance as quickly as possible on your return home. When food is taken out of the refrigerator, be sure to put it back before it becomes warm. Allow hot food and drinks to cool down before placing them in the appliance.	Warm food and food brought in from room temperature add heat to the appliance. The appliance will try to cool down and the running time of the compressor will increase.
	Store food covered or packaged.	The evaporation or condensation of liquids will cause a loss of coldness in the refrigerator.
	Place frozen food in the refrigerator to defrost.	
	Do not overfill the appliance in order to allow air to circulate.	

Before using for the first time

- Clean the inside of the appliance and the accessories with lukewarm water and a little washing-up liquid, and then dry with a soft cloth.

Important: To ensure the correct functioning of the appliance, and especially if it has been transported horizontally, let it stand for 8 hours after transporting it to its final location before connecting it to the mains.

To enable the temperature to get sufficiently cold inside the appliance, allow the appliance to run for a few hours before placing food in it.

Do not place food in the freezer section until the temperature is at least -18°C .

Please note: switching off with the rocker switch does not disconnect the appliance from the mains.

Switching the appliance on

- Open the upper appliance door.



- Press the rocker switch.

This switch is located on the right-hand side underneath the control panel.

This switches all of the zones in the appliance on or off together.

The appliance will start to cool, and the interior lighting will come on when the door is opened.



The access sensor in the control panel will also light up.

Operation

A light touch of the finger on the sensors is all that is required to operate this appliance.

Please note:

- A **selectable** sensor is always highlighted in **white**.
- A **selected** sensor is always highlighted in **yellow**.



- Touch the access sensor so that it is highlighted in yellow.



The sensors for the four zones in the appliance will now appear in the control panel: Refrigerator section, left and right-hand MasterFresh zones and the freezer section.

Switching on and off



The On/Off sensor for the ice cube maker appears on the right-hand side of the control panel (only visible if the freezer zone has been selected).

If the ice cube maker is in operation, the sensor is highlighted in yellow.

To select settings for your appliance (e.g. to set the temperature, etc.),

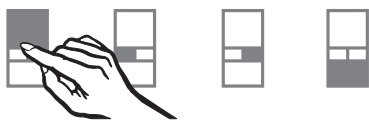

- touch the sensor for the particular zone of the appliance where you would like to select the settings.

The applicable sensor will then be highlighted in yellow, and depending on the zone, further settings which may be selected will now appear in the display.

Depending on which zone you have selected, you can

- adjust the temperature,
- select the Supercool/SuperFreeze functions,
- select the humidity level in the MasterFresh zones,
- switch on the ice cube maker.

Please refer to the relevant section for more information.

To switch off a section again,

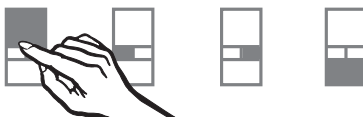

- touch the sensor of the selected zone again so that it is highlighted in white, or select a different sensor.

To leave settings mode,



- touch the access sensor so that it is highlighted in white.

Your last selected settings will now be saved to memory.

If you do not touch the access sensor, the electronics for accessing the settings will switch off after a period.

Switching off



- Press the rocker switch.





The cooling system and the lighting are now switched off.

Further settings

Further settings can be selected in the settings mode.

In settings mode, you can select certain appliance functions via the control panel and adjust the settings. The settings for the different functions are described in more detail in the relevant section of these instructions.

Overview of functions that can be selected in the settings mode:

Function	Symbol displayed
To enter or leave settings mode	
To select the temperature unit (see "The correct temperature")	
No function selected	
To switch the sensor tone on/off (see "Switching on and off")	
No function selected	

To switch the sensor tone on/off

The tone which sounds each time a sensor is touched can be deactivated.



- Touch the access sensor so that it is highlighted in yellow.

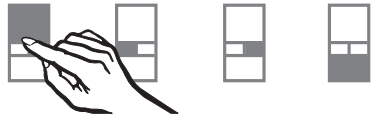

- Touch the sensor for the refrigerator zone so that it is highlighted in yellow.
- Take note of the position of the √ sensor (but do not touch it!).
- Touch the access sensor until it is highlighted in white and all of the other sensors are no longer lit up.
- Place your finger in the position of the √ sensor, and leave it there.
- At the same time, briefly touch the access sensor (without letting go of the √ sensor).

Switching on and off

- Leave your finger on the √ sensor for another 4 seconds until **c** and the **^** sensor also appear in the display.



- Now touch the √ sensor repeatedly until **b** appears in the display.
- Touch the access sensor again.
- By touching the √ sensor, you can now select whether the sensor tone is switched on or off:
 - b 0**: Sensor tone switched off
 - b 1**: Sensor tone switched on
 - b -**: Return to menu
- After selecting a new setting, touch the access sensor to confirm your choice.
- Touch the √ sensor repeatedly until **c** appears in the display.



- Touch the access sensor.

You have now left settings mode.

The door alarm is automatically disabled when the appliance is in settings mode. As soon as the door is closed, the door alarm is activated again.

Switching off for longer periods of time

If the appliance is not going to be used for a longer period of time, e.g. whilst on holiday:

- switch the appliance off,
- switch off at the wall and withdraw the plug from the socket, or disconnect the mains fuse or remove the screw-out fuse in countries where this is applicable,
- turn off the tap to the water supply (a few hours before you switch off the appliance),
- empty the ice cube container,
- clean the appliance out,
- replace the water filter and
- leave the door ajar to air the appliance.

If, during a long absence, the appliance is switched off but not cleaned out and the doors are left shut, there is a danger of mould and odours building up inside the appliance.

It is very important to set the correct temperature for storing food in the appliance. Micro-organisms will cause food which is not stored at the correct temperature to deteriorate rapidly. Temperature influences the growth rate of these micro-organisms. Reducing the temperature reduces their growth rate.

The temperature in the appliance will rise:

- the more often the door is opened and the longer it is kept open,
- the more food that is stored in it,
- the warmer the food is which is being put into it,

– the higher the ambient temperature surrounding the appliance.
The appliance is designed for use in specific ambient temperatures (climate ranges). Do not use in ambient temperatures for which it is not designed.

. . . in the refrigerator and the MasterFresh zone

We recommend a temperature of **4 °C** in the refrigerator.

The temperature in the MasterFresh zone is controlled automatically and is maintained at **1.5 °C**.

DynamicCooling

The DynamicCooling fan automatically switches on when the cooling system for the refrigerator switches on. It distributes the temperature in the appliance to all areas more evenly so that all the food will be chilled to about the same degree.

. . . in the freezer

To freeze fresh food and to store frozen food for a long time, a temperature of **-18 °C** is required. At this temperature the growth of micro-organisms is generally halted. As soon as the temperature rises above -10 °C, the micro-organisms become active in the food again so that it cannot be kept as long. For this reason, partially defrosted or defrosted food must not be re-frozen. Food may be re-frozen once it has been cooked, as the high temperatures achieved when cooking destroy most micro-organisms.

The correct temperature

Setting the temperature in the refrigerator/freezer zones

The temperatures in the refrigerator and freezer zones are set independently of one another.



- Touch the access sensor so that it is highlighted in yellow.

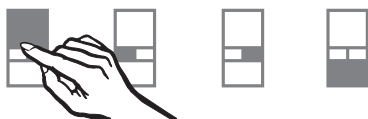

- Touch the sensor for the refrigerator or freezer zone so that it is highlighted in yellow.



- The temperature inside the appliance can be selected by touching the arrow sensors on either side of the temperature display.

By touching the

- ∇ sensor: the temperature will get colder
- ∧ sensor: the temperature will get warmer.

The temperature range being set will flash in the display as you do this.

- Touching the sensor once: adjusts the temperature shown in 1 °C steps.
- Keeping your finger on the sensor: changes the temperature continuously.

If the highest or lowest temperature that it is possible to set is reached, the ∇ or ∧ sensor will disappear from the display.

The temperature display on the control panel always shows the **selected** temperature.

When you have adjusted the temperature, **wait for approx. 6 hours if the appliance is not very full** and **for approx. 24 hours if the appliance is full** before checking the temperature, as it will take this long for the appliance to reach the temperature. If, after this time, the temperature is still too high or too low, you will need to adjust it again.

Temperature range

The temperature can be adjusted:

- In the refrigerator section from 2 °C to 8 °C
- In the freezer section from -14 °C to -24 °C.

The ambient temperature in the room and the installation location can affect the time it takes for the appliance to reach the lowest temperature. If the ambient temperature is too high, the appliance may not reach the lowest temperature.

Temperature (Fahrenheit/Celsius)

The temperature can be displayed in degrees Celsius or degrees Fahrenheit.



- Touch the access sensor so that it is highlighted in yellow.

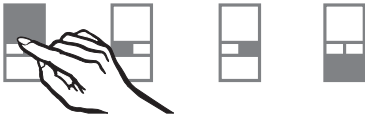

- Touch the sensor for the refrigerator zone so that it is highlighted in yellow.
- Take note of the position of the √ sensor (but do not touch it!).
- Touch the access sensor until it is highlighted in white and all of the other sensors are no longer lit up.
- Place your finger in the position of the √ sensor, and leave it there.
- At the same time, briefly touch the access sensor (without letting go of the √ sensor).
- Leave your finger on the √ sensor for another 4 seconds until ⚡ and the ^ sensor also appear in the display.



- Now touch the √ sensor repeatedly until ⚡ appears in the display.
- Touch the access sensor again.
- By touching the √ sensor, you can now set the temperature to be displayed in Fahrenheit or Celsius.
⚡ 0: Temperature in Fahrenheit
⚡ 1: Temperature in Celsius
⚡ -: Return to menu.
- After selecting a new setting, touch the access sensor to confirm your choice.
- Now touch the √ sensor repeatedly until ⚡ appears in the display.



- Touch the access sensor again.
- You have now left settings mode.

The door alarm is automatically disabled when the appliance is in settings mode. As soon as the door is closed, the door alarm is activated again.

The correct temperature

Temperature display

The temperature display on the control panel always shows the **selected** temperature.

The **temperature displays flash** if

- a different temperature is being set,
- the temperature in the appliance has risen by several degrees, indicating that the appliance is warming up too much.

This loss of coldness is no cause for concern in the following circumstances:

- when the door has been left open for a while, e.g. for removing or storing a large amount of food,
- when fresh food is being frozen.

However, if the temperature in the freezer section remains above -18°C for a long time, check that the frozen food has not started to defrost. If it has, check that the food is safe to use and if it is, then use it as soon as possible.

Your appliance has been fitted with a warning system which ensures that the temperature in the appliance cannot rise unnoticed and to avoid energy being wasted if a door is left open.

Activating the alarm system

The alarm system is always active. It does not have to be switched on manually.

Temperature alarm

If the temperature in one of the zones gets too warm, the sensor for the zone concerned will flash in the control panel.

The Alarm off sensor will flash at the same time.

An audible alarm will also sound.

If the temperature rises in the freezer, the temperature display will show the highest temperature that was reached during the time the temperature in the freezer rose.

The alarm will sound and the relevant symbol will flash, for example,

- if the freezer door has been left open for a while, e.g. in order to load, re-arrange or take food out.
- when freezing large amounts of food at once.
- in the event of a power cut.

The alarm will stop and the Alarm off sensor in the display will go out again as soon as the temperature has dropped down to the correct level again. The sensor for the zone concerned will constantly light up.

Switching the temperature alarm off early

If the noise disturbs you, you can switch the alarm off early if you wish.



- Touch the Alarm off sensor.

The alarm will stop.

The Alarm off sensor will continue to be lit up until the temperature has dropped down to the correct level again.

However, if the temperature in the freezer section remains above -18 °C for a long time, check that the frozen food has not started to defrost. If it has, check that the food is safe to use and if it is, then use it as soon as possible.

Alarm

Door alarm

The alarm will sound if a door is left open for more than 5 minutes. The Alarm off button will also light up.

The alarm will stop and the Alarm off sensor in the display will go out as soon as the door has been shut.

Switching the door alarm off early

If the noise disturbs you, you can switch the alarm off early if you wish.



- Touch the Alarm off sensor.

The Alarm off sensor in the display will go out and the alarm will stop.

SuperCool

The SuperCool function can be used to rapidly reduce the temperature in the refrigerator to its lowest setting (depending on the room temperature).

Switching on SuperCool

SuperCool is particularly recommended for the faster chilling of large amounts of fresh food or drink.

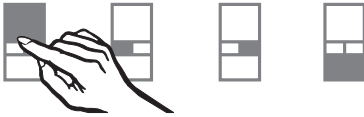

- Touch the sensor for the refrigerator zone so that it is highlighted in yellow.



- Touch the SuperCool sensor so that it lights up in yellow.

The appliance will now operate at full power to lower the temperature in the refrigerator zone, and the newly set temperature of 2°C will show in the temperature display.

Switching off SuperCool

The SuperCool function will switch itself off automatically after approx. 6 hours. The sensor is highlighted in white and the appliance continues running at normal power.

To save energy, the SuperCool function can be switched off once food and drinks are sufficiently chilled.



- Touch the SuperCool sensor so that it is highlighted in white.

The original temperature will now appear in the temperature display for the refrigerator, and the appliance will continue to operate at normal power.

SuperCool and SuperFreeze

SuperFreeze

Switch the SuperFreeze function on before putting fresh food into the freezer section.

This helps food to freeze quickly and retain its nutrients, vitamins, flavours and appearance.

SuperFreeze is not necessary:

- when placing food in the freezer that is already frozen.
- when freezing less than 2 kg fresh food in any one day.

Switching on SuperFreeze

When freezing small quantities of food in the freezer, the SuperFreeze function should be switched on **4-6 hours beforehand**. When freezing **the maximum load of food** the SuperFreeze function should be switched on **24 hours beforehand**.

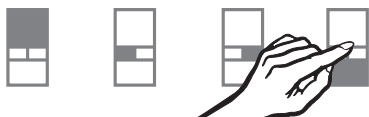

- Touch the sensor for the freezer zone so that it is highlighted in yellow.



- Touch the SuperFreeze sensor so that it lights up yellow.

The appliance will now operate at full power to lower the temperature in the freezer zone, and the newly set temperature of -30 °C will show in the temperature display.

Switching off SuperFreeze

Depending on the amount of food placed in the freezer section, the SuperFreeze function will switch off automatically after approx. 52 hours. The sensor is highlighted in white and the appliance continues running at normal power.

To save energy, the SuperFreeze function can be switched off once the temperature in the freezer is low enough.



- Touch the SuperFreeze sensor so that it is highlighted in white.

The original temperature will now appear in the temperature display for the freezer, and the appliance will continue to operate at normal power.

Using the refrigerator efficiently

Different storage zones

Due to the natural circulation of the air in the appliance, there are different temperature zones in the refrigerator.

Cold, heavy air sinks to the lowest section of the appliance. Make use of the different zones when placing food in the appliance.

- pre-packed vegetables and other fresh food with a label stating it should be kept at a temperature of approx. 4 °C.

This appliance has DynamicCooling, which helps to keep an even temperature when the fan is running. When DynamicCooling is switched on, the difference between the various zones is less pronounced.

Warmest area

The warmest area is in the top section of the door. Use this area for storing butter and cheese.

Coldest area

The coldest area in the refrigerator is directly above the MasterFresh zones. However, the MasterFresh zones are even colder.

Use these areas in the refrigerator and in the MasterFresh zones for all delicate and highly perishable food, e.g.

- fish, meat, poultry,
- sausage products, ready meals,
- dishes or baked goods containing eggs or cream,
- fresh dough, cake mixtures, pizza or quiche dough,
- soft cheese and other dairy products,

Using the refrigerator efficiently

Do not store explosive materials in the appliance or any products containing propellants (e.g. spray cans).

Danger of explosion!

If storing alcohol with a high percentage proof, make sure it is tightly closed, and stored upright.

Do not store cooking oil in the refrigerator door. Traces of oil can cause stress cracks to occur in the plastic components in the door.

Ensure the air vents in the refrigerator are not covered (e.g. by bottles) as food may freeze.

Food must not touch the back wall of the refrigerator, as it may freeze to the back wall.

Ensure that when placing food in the refrigerator, a gap of at least 35 mm is maintained under the ceiling of the appliance to enable the air to circulate freely.

Only use the area to the front of the refrigerator shelves to place food temporarily, but do not leave it there, as when you shut the door it may get pushed over, causing spillages.

To allow air to circulate efficiently, do not pack food too closely together in the refrigerator. Make sure that the vents at the back of the appliance are not covered. They are important for trouble-free operation of the appliance.

Food which should not be stored in a refrigerator

Not all food is suitable for refrigeration at temperatures below 5 °C.

Cucumbers, for example, become glassy, eggplants bitter and potatoes sweet. Tomatoes and oranges lose their aroma, and the peel on citrus fruits hardens.

Foods which are sensitive to cold include:

- Pineapples, avocados, bananas, pomegranates, mangoes, melons, papayas, passionfruit, citrus fruits such as lemons, oranges, mandarines, grapefruits
- Fruit which is not yet ripe
- Eggplants, cucumbers, potatoes, capiscum, tomatoes, zucchini
- Some hard cheeses, e.g. Parmesan

What to be aware of when shopping for food

The freshness of food when first placed in the appliance is the most important factor in determining how long it stays fresh, and how long it can be kept in the appliance. Time out of the refrigerator, e.g. during transportation, should be kept to a minimum. For example, do not allow food to stay in a hot car for too long. Once food has started to deteriorate, this process cannot be reversed. As little as two hours outside the refrigerator can cause food to start deteriorating.

Tip: Take a cool bag when shopping and place all cold food immediately in

the refrigerator and freezer upon arrival home.

Storing food correctly

Food should generally be stored covered or packaged in the refrigerator section (there are some exceptions to this rule in the MasterFresh zones - see below). This will prevent food smells from affecting other foods, food from drying out, and also any cross-contamination of bacteria. This is especially important for storing animal products.

The shelf life of food can be significantly increased by setting the correct temperature and maintaining good standards of hygiene.

Storing food in the MasterFresh zones

Food is stored in the MasterFresh zones at a lower temperature than in the conventional refrigerator section. The humidity level in the MasterFresh zones can be regulated to provide the correct conditions for food stored inside them.

Due to the optimum storage conditions created within the MasterFresh zones, food remains fresh for longer, and flavour and vitamins are retained.

Storage temperature

The optimum storage temperature for fresh food which is not sensitive to the cold is 0 - 3 °C. This is the temperature range which is automatically maintained in the MasterFresh zones. Food can be stored in the MasterFresh zones at this temperature without loss of freshness for considerably longer than in a standard refrigerator, as the deterioration process is decelerated at this temperature.

Remember that the initial freshness of the food when placed in the refrigerator is crucial for good storage results.

Humidity level

The humidity level in the MasterFresh zones depends on:

- the moisture content of the stored food, and
- the quantity of food being stored.

The closer the storage humidity is to the moisture content of the food, the crisper and fresher the food remains over a longer period, as the water content of the food is largely retained in the MasterFresh zones.

Storing food in the MasterFresh zones

The MasterFresh drawer is divided into two zones.



- Touch the sensor for the MasterFresh zone in which you wish to place food.

The sensor for the selected MasterFresh zone will be highlighted in yellow. The symbols for the food you wish to store now appear:



- Left: Foods that require high humidity such as fruit and vegetables
 - Right: Foods that require a dry atmosphere such as meat, fish and dairy products
- Touch the sensor for the type of food that you wish to store in the MasterFresh zone selected.

Storing food in the MasterFresh zones

- You can deselect the type of food by touching the relevant sensor again.

You cannot store foods that like high humidity alongside foods that prefer a dry atmosphere. However, you can store several foods from the same humidity/dry group at the same time.

- Place the food in its corresponding MasterFresh zone.

Foods that prefer a higher humidity include:

- Freshly picked vegetables, lettuce, herbs, mushrooms, cabbages and fruit.

TIP

The level of humidity in the MasterFresh zones is dependent upon the moisture content of the food and how much food is being stored in the zones.

When storing a **small amount of food**, it is a good idea to store it in **packaging**.

Foods that prefer a dry atmosphere include:

- fresh fish, shellfish, meat, poultry, sausages, dairy products and specialty salads.

Please note that foods rich in protein deteriorate faster than others.

Shellfish, for example, deteriorates faster than fish, and fish deteriorates faster than meat.

Always keep these foods **covered or wrapped**.

Exception: Meat The surface of the meat dries out slightly, helping to prevent the growth of bacteria, which results in the meat lasting longer. To prevent the risk of bacterial cross-contamination and meat deteriorating, do not let one type of meat come into direct contact with another type.

Take food out of the MasterFresh zones approx. 30 - 60 minutes before using it. The aroma and taste do not fully develop until the food has reached room temperature.

Please note: The function of the MasterFresh zones is reduced when the dividing panel is not in place.

Storing food in the MasterFresh zones

If you are not satisfied with the results of your stored food (e.g. food loses firmness and wilts shortly after placing in the appliance), keep in mind the following instructions:

- Only place fresh food in the appliance as the initial condition of the food is crucial to maintaining freshness.
- Clean the MasterFresh zones before storing food in them.
- Dry the surface of very moist food before placing it in the MasterFresh zones.
- Do not store any food in the MasterFresh zones which is sensitive to cold (see "Food which should not be stored in a refrigerator").
- Please note that not all types of food can be stored together (see "Can all types of food be stored together?").
- Allocate the appropriate settings to food you wish to store (e.g. humid or dry storage).
- Store food with a high moisture content unwrapped in the MasterFresh zones. A high humidity level will be achieved by means of the moisture already contained within the food being stored.
If the humidity level is not high enough (e.g. too little food is being stored), it can be increased by placing a damp sponge in the drawer.
- If you think that the temperature in the MasterFresh zones is not correct, try adjusting it slightly by 1 to 2 °C via the refrigerator section temperature control. To avoid frost damage to food, a higher temperature must be set if ice crystals begin to form on the bottom of the MasterFresh zones.
- If too much water collects at the bottom of the MasterFresh zones, dry it with a cloth. If necessary, dry food before placing it in the appliance or place a rack at the bottom of the MasterFresh zones to allow water to drain off.

Moving the shelves

The shelves can be adjusted according to the height of the food.

- Hold the shelf on both sides and raise it slightly so that it can be lifted over the catches at the back.
- Pull the shelf forwards.
- Place the shelf at the required level, ensuring that it has engaged in the catches at the back.
- Make sure that the shelf is on straight.

Floating deli drawer

The drawer can be positioned to the right or left by sliding it to the required position.

It can also be placed, together with its holder, under a different shelf - or this can be achieved by simply swapping the shelves over.

The floating drawer can be removed completely for cleaning purposes:

- To do this, pull the drawer out over the drawer stops.

To replace it

- Push the drawer straight into runners.

The MasterFresh drawer

The MasterFresh drawer sits on telescopic runners, and can be fully pulled out for loading and unloading.

For cleaning, the MasterFresh drawer can be removed completely.

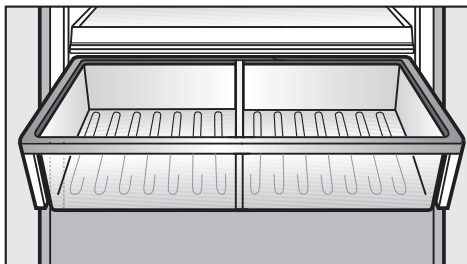

- Pull the MasterFresh drawer out as far it will go.

To prevent children from hurting themselves, there is a pin on the door opening side which needs to be turned to a horizontal position in order to remove the drawer.

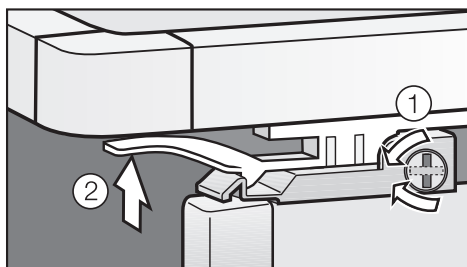

- Use a screwdriver or similar to turn the pin so that the slot in its head is horizontal ①.
- Raise the snap fittings on both sides ②, and lift the MasterFresh drawer up and out.

Arranging the interior fittings

To avoid damaging the telescopic runners, make sure that they are pushed back into the appliance.

The dividing panel in the MasterFresh drawer can be removed for cleaning.

- Take the MasterFresh drawer out of the appliance completely.
- Pull the dividing panel in the MasterFresh drawer up and out to remove it.
- After cleaning, slide the dividing panel back into the drawer.

Please note: The MasterFresh zone does not work as efficiently without the dividing panel in place.

To replace the drawer

- Pull the telescopic rails out as far as they will go.
- Place the MasterFresh drawer on the rails so that it engages at the back and front.
- Turn the slot on the pin to its vertical position.
- Push the MasterFresh drawer all the way back into the appliance.

Adjusting the door shelves/bottle shelf

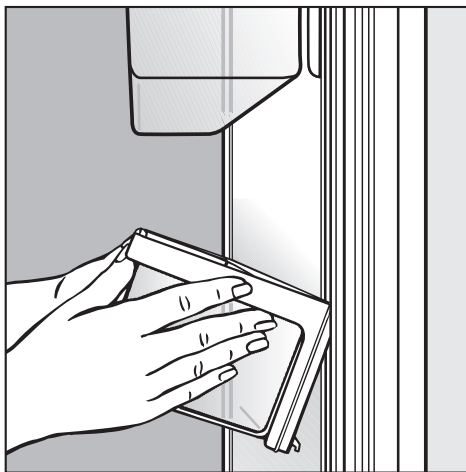

- Hold the door shelf by its frame with both hands, raise it a little and then tip it forwards slightly.
- Slide the shelf in this angled position up or down in the side runners as required, and then lower it into its new position.
- Make sure that the shelf is straight.

To remove the door shelf altogether,

- Slide it up the side runners to the very top, then lift it out.

To replace the door shelf

- Engage the door shelf in the runners at the top, and lower it to the position required.

Arranging the interior fittings

For the purposes of loading and unloading or to clean, the containers can be removed from their frame completely.

To remove the container in the top door shelf from its frame,

- Undo the screws on the shelf and remove the cover.
- Unhinge the flap from its holder.
- Lift the container up and out.

To remove the shelf above the MasterFresh drawer

- Remove the trim at the back, push back the glass shelf slightly, then lift it carefully up and out.

Small freezer basket

The small basket can be removed for cleaning.

- Pull the small basket out as far it will go.

To prevent children from hurting themselves, there is a pin on the door opening side which needs to be turned to a horizontal position in order to remove the basket.

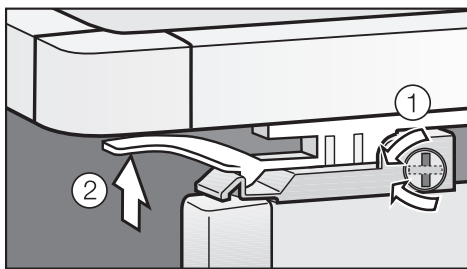

- Use a screwdriver or similar to turn the pin so that the slot in the head is horizontal ①.
- Raise the snap fittings on both sides ②, and lift the freezer basket up and out.

To replace the small freezer basket

- Pull the telescopic rails out as far as they will go.
- Place the freezer basket on the rails so that it engages at the back and front.
- Turn the slot on the pin to its vertical position.
- Push the freezer basket back in.

Arranging the interior fittings

Large freezer basket with dividing panel

The large basket can be removed for cleaning.

- Close the door to the refrigerator section.
- Open the freezer drawer.
- Lift the large freezer basket up and out to remove it.

The dividing panel in the large freezer basket can be removed for cleaning.

The dividing panel is held in place by fittings in the freezer basket.

To loosen the fittings,

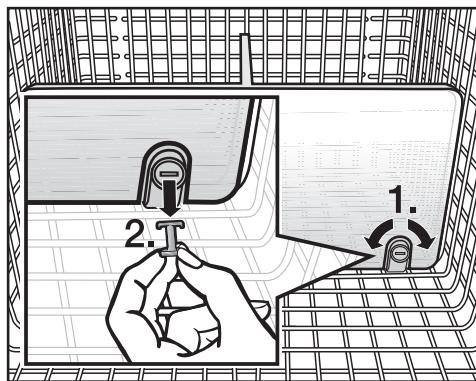

- Use a screwdriver or similar to turn the slots in the pegs to a horizontal position ①.
- Remove the pegs from the fittings ②.
- Pull the dividing panel upwards to remove it.

To replace the dividing panel

- Place the fittings in an upright position, and locate the dividing panel in the fittings so that you hear it click into place.
- Replace the pegs in the fixings, and use a screwdriver or similar to turn the slots in the pegs into a vertical position.

To replace the freezer basket

- Position the basket by locating the pegs into their holes from above.

Freezing fresh food

Fresh food should be frozen as quickly as possible. This way the nutritional value of the food, its vitamin content, appearance and taste are not impaired.

Food which takes a long time to freeze will lose more water from its cells, which then shrink.

During the defrosting process, only some of this water is reabsorbed by the cells; the rest collects around the food.

If food is frozen quickly, the cells have less time to lose moisture, so they shrink less. As there is not so much moisture loss, it is easier for the food to reabsorb it during the defrosting process, and very little water collects around the defrosted food.

Storing frozen food

When buying frozen food to store in your freezer section, check

- that the packaging is not damaged,
- the use-by date,
- the temperature at which the frozen food is being stored in the shop. The length of time it can be kept is reduced if it has been stored at a temperature warmer than -18°C .

- Buy frozen food once you have finished the rest of your shopping, and wrap it in newspaper or use a cool bag or cool box to transport it.
- Store it in the freezer as soon as possible.

Never re-freeze partially or fully defrosted food. Consume defrosted food as soon as possible as it will lose its nutritional value and spoil if left for too long. Defrosted food may only be re-frozen after it has been cooked.

Freezing and storing food

Home freezing

Only freeze fresh food which is in good condition.

Hints on home freezing

- The following types of food **are suitable** for freezing:
Fresh meat, poultry, game, fish, vegetables, herbs, fresh fruit, dairy products, pastry, leftovers, egg yolks, egg whites and a range of pre-cooked meals.
- The following types of food **are not suitable** for freezing:
Grapes, lettuce, radishes, sour cream, mayonnaise, eggs in their shells, onions, whole raw apples and pears.
- To retain colour, taste and vitamin C, vegetables should be blanched after they have been trimmed and washed.
To blanch: bring a large saucepan of water to the boil, immerse the vegetables in the fast boiling water for 2-3 minutes, depending on variety. Remove, and plunge into ice-cold water to cool quickly. Drain and pack ready for freezing.
- Lean meat freezes better than fatty meat, and can be stored for considerably longer.
- To prevent chops, steaks, cutlets or rolled meat from freezing together in solid blocks when packed, separate with a sheet of plastic freezer film.

- Do not season fresh foods or blanched vegetables before freezing. Only season cooked food lightly before freezing, but care should be taken as the taste of some spices alters when frozen.
- Do not place hot food or drinks in the freezer. This causes already frozen food to thaw, and increases the energy consumption considerably. Allow hot food and drinks to cool down before placing them in the freezer.

Packing

- Freeze food in portions.

Unsuitable packing material

- wrapping paper
- grease-proof paper
- cellophane
- bin bags
- plastic carrier bags

Suitable packing material

- plastic freezer film
- freezer bags
- aluminium foil
- freezer containers

- Expel as much air as possible from bags etc. before sealing them, to prevent freezer-burn on food.
- Close the packaging tightly with
 - rubber bands
 - plastic clips
 - string or bag ties
 - freezer tape.

Freezer bags may also be sealed using home heat sealing kits.

- Make a note of the contents and the date of freezing on the packaging.

Before placing food in the freezer

- When freezing more than 2 kg of fresh food, switch on the Super-Freeze function for some time before placing the food in the freezer (see "SuperFreeze").
This also helps to prevent food that is already in the freezer from starting to defrost.

Placing food in the freezer

Food to be frozen can be placed anywhere in the freezer.

Place large quantities of food in the large freezer basket.

Please follow the guidelines in the table below regarding recommended weights for the baskets:

	Small basket	Large basket
KF 1811 Vi, KF 1811 Vi	14 kg	33 kg
KF 1911 Vi, KF 1911 Vi	19 kg	43 kg

- Place the food flat in the bottom of the basket so that it freezes through to the core as quickly as possible.
- Make sure that the packaging and containers are dry to prevent them sticking together when frozen.

When freezing, make sure that food already frozen does not come into contact with fresh food being frozen as this could cause the frozen food to begin to defrost.

Defrosting

Frozen food can be defrosted in different ways:

- in a microwave oven,
- in an oven using the "Fan" or "Defrost" setting,
- at room temperature,
- in the refrigerator (the cold given off by the frozen food helps to keep the other food cold),
- in a steam oven.

Poultry It is particularly important to observe food hygiene rules when defrosting poultry. Do not use the liquid from defrosted poultry. Pour it away and wash the container it was in, the sink and your hands. Danger of salmonella poisoning.

Fruit should be defrosted at room temperature in its packaging, or in a covered bowl.

Most vegetables can be cooked while still frozen. Just put straight into boiling water or hot fat. The cooking time is slightly less than that of fresh vegetables due to changes in the cell structure.

Never re-freeze partially or fully defrosted food. Consume defrosted food as soon as possible as it will lose its nutritional value and spoil if left for too long. Defrosted food may only be re-frozen after it has been cooked.

Freezing and storing food

Cooling drinks

To cool drinks quickly, place them in the refrigerator section, and switch on the SuperCool function. If bottles are, however, placed in the freezer section for rapid cooling, make sure they are not left in for more than one hour, as they could burst.

For the automatic ice cube maker to operate, it must be connected to the mains water supply (see "Mains water connection").

Switching on the ice cube maker

- Make sure that the ice cube container is correctly located underneath the ice cube maker.

The container must be completely shut for ice cubes to be produced.

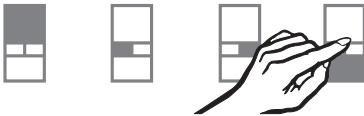

- Touch the sensor for the freezer section so that it is highlighted in yellow.



- Touch the On/Off sensor for the ice cube maker so that it is highlighted in yellow.

Once the freezer section has cooled down to its set temperature, the ice cube maker will fill with water.

When the water has frozen, the ice cubes will fall out of the ice cube maker into the ice cube container.

The ice cube maker can make up to 140 ice cubes in 24 hours.

The number of ice cubes which the appliance makes depends on the

temperature in the freezer: The lower the temperature, the more ice cubes are produced within a certain time frame.

After the appliance has been switched on for the first time it can take up to 10 hours for the first ice cubes to drop out of the ice cube maker and collect in the container.

Ice cube production is halted automatically when the ice cube container is full.

Do not place bottles or other items in the ice cube maker to chill them quickly. The ice cube maker could become blocked and, as a result, be damaged.

The first three containers of ice cubes after switching on for the first time must not be consumed because the water used will have been used to rinse through the pipework.

This is also the case when the appliance has been switched off for a long time.

Making ice cubes

Switching off the ice cube maker

The appliance must be disconnected from the mains water supply a few hours before the ice cube maker is switched off.

The ice cube maker can be switched off independently of the freezer section if you do not want the appliance to make any ice cubes.



- Touch the On/Off sensor for the ice cube maker so that it is highlighted in white.

Refrigerator section and MasterFresh zone

Condensate and frost can build up on the back wall of the refrigerator section and the MasterFresh zone whilst in use. You do not need to remove this, as it will defrost and evaporate automatically with the warmth generated by the appliance.

Freezer section

This appliance is equipped with a "Frost free" system. The freezer section defrosts automatically.

The moisture generated in the appliance collects on the condenser and is automatically defrosted and dissipated by the condenser from time to time.

This automatic defrosting system enables the freezer section to remain permanently ice-free, however, the food stored in the freezer section will not defrost.

Cleaning and care

Do not let water get into the electronic unit or the ventilation gaps.

Do not use a steam cleaning apparatus to clean the appliance. Steam could reach the electrical components and cause a short circuit.

The data plate located inside the appliance must not be removed. It contains information which is required in the event of a service call.

To avoid damaging the outer surfaces of your appliance, do not use:

- cleaning agents containing soda, ammonia, acids or chlorides,
- cleaning agents containing descaling agents,
- abrasive cleaning agents, e.g. powder cleaners and cream cleaners,
- solvent-based cleaning agents,
- stainless steel cleaners,
- dishwasher cleaner,
- oven sprays,
- glass cleaning agents,
- hard, abrasive sponges and brushes, e.g. pot scourers,
- dirt erasers,
- sharp metal scrapers.

Before cleaning



- Switch the appliance off by pressing the On/Off rocker switch.

This switch is located on the right-hand side underneath the control panel.

- Disconnect the appliance from the mains. Switch off at the wall and withdraw the plug from the socket, or disconnect the mains fuse or remove the screw-out fuse in countries where this is applicable.
- Take any food out of the appliance and store it in a cool place.
- Take out any removable parts, e.g. shelves, for cleaning.
- The door shelves can be removed from their frames for cleaning.

Cleaning the interior and accessories

Use lukewarm water with a little washing-up liquid.

Wash all accessories by hand only. Do not wash in a dishwasher.

- Clean the appliance at least once a month.
- After cleaning, wipe the outer casing, interior and accessories with a damp cloth and dry with a soft cloth. Leave the door open to air the appliance for a short while.

Aluminium frames

The frames on the shelves inside the appliance and in the door are made from aluminium.

Aluminium is affected by the way that light falls on it, by the surrounding environment and by the angle you observe it from.

It is also susceptible to scratching.

The aluminium frames may suffer discolouration or damage if soiling is left on for too long. Remove any soiling immediately.

Ice cube container

The ice cube container sits on telescopic runners, and can be fully extended for loading and unloading.

For cleaning, this drawer can be removed completely.

- Pull the ice cube container out as far as it will go.

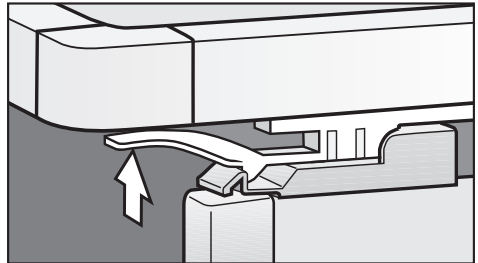

- Raise the snap fittings on both sides and lift the ice cube container out.

To avoid injury or damage to the telescopic runners, make sure that they are pushed back into the appliance.

To replace the ice cube container:

- Pull the telescopic rails out as far as they will go.
- Place the ice cube container on the rails so that it engages at the back and front.
- Push the ice cube container back in.

Cleaning and care

Humidity filters

The two special humidity filters above the MasterFresh drawers have to be removed for cleaning.

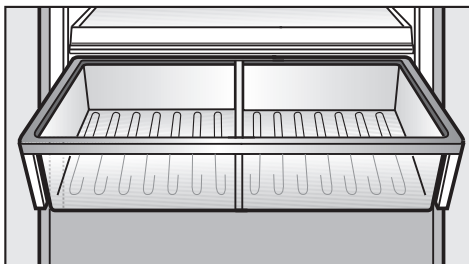

- Pull out the MasterFresh drawer and remove it.

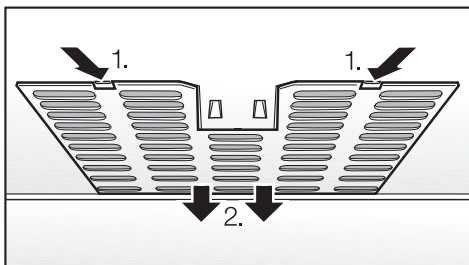

- Release the filter cover (1.), then lower it together with the filter mat and remove it (2.).

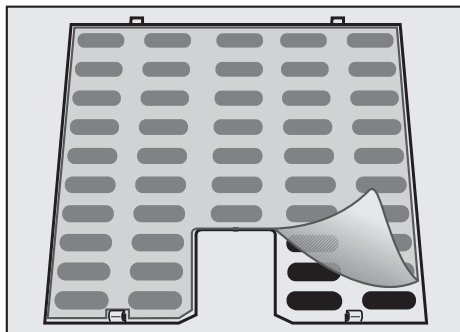

- Take off the filter mat.
- Clean the filter mat in lukewarm water without any detergent.

Do not wash the filter mats in a dishwasher or washing machine.

- Leave the filter mat to dry.
- Replace the filter mat in the filter cover.
- Replace the filter cover, engaging it first at the back and then at the front.
- Replace the MasterFresh drawer in the appliance.

Ventilation gaps

- The ventilation gaps should be cleaned on a regular basis with a brush or vacuum cleaner. A build-up of dust will increase the energy consumption of the appliance.

Door seals

Do not use any oils or grease on the door seals as these will cause the seals to deteriorate and become porous over time.

The door seals should be cleaned regularly with clean water, and then wiped dry with a soft cloth.

After cleaning

- Replace all shelves and accessories in the refrigerator section.
- Reconnect the appliance to the electricity supply and switch it on.
- Place the food back in the appliance and close the door.
- Switch on the SuperFreeze function so that the freezer can cool down quickly.
- Once the freezer has reached the required temperature, place the food back in the freezer baskets and put them back in the freezer.
- Switch off the SuperFreeze function as soon as the temperature in the freezer is a constant -18 °C or colder.

Problem solving guide

Repair work to electrical appliances must only be carried out by a suitably qualified and competent person in strict accordance with current local and national safety regulations. Repairs and other work by unqualified persons could be dangerous. The manufacturer cannot be held liable for unauthorised work.

What to do if . . .

. . . the appliance does not get cold.

- Check whether the appliance has been switched on. If it is switched on, the access sensor will light up in the display.
- Check that the plug is correctly inserted into the socket and switched on.
- Check whether the mains fuse has tripped or whether the fridge freezer, mains voltage or another appliance is faulty.
If this is the case, contact a qualified electrician or Miele.
- Check the temperature settings.

. . . the temperature in the refrigerator or freezer is too low.

- Increase the temperature.
- Switch off the SuperFreeze or SuperCool function if it is switched on.
- Check that the appliance doors are closed properly.

- Has a large amount of fresh food been put in at the same time for freezing?
This makes the compressor run for longer, causing the temperature to fall automatically.

. . . the door will not open because it has been opened and closed too many times in succession.

- This is not a fault. The suction caused by opening and closing the door is preventing the door from opening. Wait a few minutes and then try again. It should now open without force.

. . . the compressor is switching on too frequently and for too long.

- Check whether the ventilation gaps in the plinth have been covered over or become too dusty.
- The doors have been opened too frequently, or a large amount of fresh food has been put in at once for freezing.
- Check that the appliance doors are closed properly.

. . . the compressor runs continuously.

To save energy, the compressor runs at a lower speed when less cooling is required. In this case, the compressor runs for longer.

... the temperature display for the freezer section shows -18 °C even though a higher temperature has been set.

- This is not a fault. If the ice cube maker is switched on and the room temperature is low ($< +18\text{ °C}$), the temperature will automatically switch to -18 °C .
This ensures that the ice cube maker functions properly.

... the frozen food is thawing because the freezer is too warm.

- Is the room temperature lower than the ambient temperature for which the appliance is designed?

If so, raise the temperature of the room.

Operating in a room which is too cold will cause the cooling system to switch off for too long, causing the freezer to become too warm.

... food has frozen together.

- Use a blunt instrument, e.g. a spoon handle or plastic scraper, to prise it apart carefully.

... the alarm sounds.

Has the appliance door been open for longer than 5 minutes?

- Close the appliance door.

... the alarm sounds and the "Alarm off" sensor lights up or is flashing.

- The refrigerator door or the freezer drawer is open, or
- The temperature in one of the zones has risen significantly because
 - too much warm air from the room has entered the appliance,
 - large quantities of food have recently been placed in the freezer,
 - there has been a power cut.

The alarm will stop and the "Alarm off" sensor in the display will go out again as soon as the temperature has dropped down to the correct level again.

If the temperature rises in the freezer, the temperature display will show the highest temperature that was reached during the time the temperature in the freezer rose.

Check the condition of the food in the freezer. If it has defrosted or started to defrost, check that it is still safe to use and, if so, use it as soon as possible. Defrosted food may only be refrozen after it has been cooked.

... the indicator for the reminder to change the water filter lights up red.

The water filter will soon need to be changed.

- You can order a replacement filter from your Miele Chartered Agent or from Miele.

Problem solving guide

... the indicator for the reminder to change the water filter flashes red.

- Replace the water filter.

... you cannot switch the ice cube maker on.

- Check whether the appliance is connected to the electricity supply.
- Check whether the freezer section has been selected. The sensor for this must be highlighted in yellow.

... the ice cube maker is not producing any ice cubes.

- Check whether the appliance has been switched on.
- Check whether the ice cube maker is switched on.
- Check whether the appliance is correctly connected to the mains water supply.
- Was the water inlet pipe purged of air by a qualified and competent person before the appliance was used for the first time?
- Check whether the water inlet is open.
- Check that the ice cube container is positioned correctly.
- Check that the temperature in the freezer section is low enough.
- Check whether there is sufficient water pressure. The water pressure (flow rate) must be between 1.72 and 5.0 bar.

- Check that the correct valve was installed; an incorrect valve may cause a drop in water pressure.

Remember it can take up to 10 hours to produce the first ice cubes.

... the ice cube maker is only producing small ice cubes.

- Are other appliances that are connected to the mains water supply being used at the same time? Avoid using the dishwasher, washing machine etc. at the same time.
- Check whether the water filter needs to be changed.
- Check whether there is sufficient water pressure. The water pressure (flow rate) must be between 1.72 and 5.0 bar.
- Check that the correct valve was installed; an incorrect valve may cause a drop in water pressure.

Remember it can take up to 10 hours to produce the first ice cubes.

... the ice cubes taste or smell odd.

- How often do you use the ice cube maker?
If you do not use it very often, ice cubes that are stored for a long period can absorb the taste and smell of other items.
- Are you storing unwrapped food in the freezer?
Ice can absorb the taste and smell of unwrapped food.
- Check that the ice cube container is clean and wash it if necessary.

... the ice cube maker is producing too few or misshapen ice cubes.

- Check whether there is sufficient water pressure. The water pressure (flow rate) must be between 1.72 and 5.0 bar.
- Check that the temperature in the freezer section is low enough.
- Replace the water filter.

... water is pouring out of the appliance.

- Turn off the tap immediately.
- Check whether the water pipework inside the appliance is damaged.
Call Miele.
- Check whether there is sufficient water pressure.
- Check whether the correct valve was fitted.

... "_F" and "i2i" appear alternately in the temperature display.

There is no water coming into the ice cube maker.

- Check whether the appliance is correctly connected to the mains water supply.
- Check whether the water inlet is open.

... a fault message with "_F" appears in the temperature display.

There is a fault. Call Miele.

... the interior lighting is not working.

Has the refrigerator door been left open for too long? To avoid overheating, the lighting switches itself off automatically after approx. 5 minutes if the door is left open. It will come on again after it has cooled down sufficiently.

If it does not come on when the door is opened briefly, then the lighting is defective.

- Switch the appliance off by pressing the On/Off rocker switch.
- Disconnect the appliance from the mains. Switch off at the wall and withdraw the plug from the socket, or disconnect the mains fuse or remove the screw-out fuse in countries where this is applicable.

Problem solving guide

Top lighting:

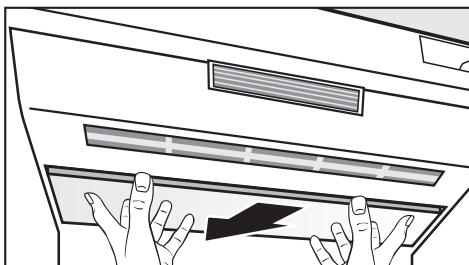

- Hold the lamp cover at the front with both hands and push it back.
- Then lift the lamp cover forwards to remove.

Do not touch halogen lamps with your bare fingers.
Use a soft cloth when changing a halogen lamp.

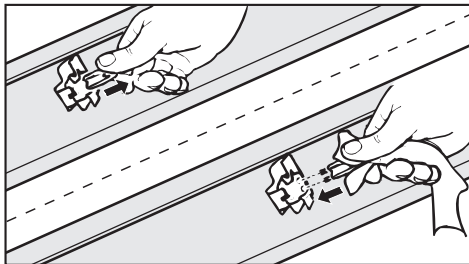

- Pull the defective halogen lamp out.
- Fit the new lamp into the holder.
The following type of halogen lamp is required:
20 W/12 V/ GY 6.35 cap.
- Engage the lamp cover at the back, then pull it forward and click it into place at the front.

Side lighting:

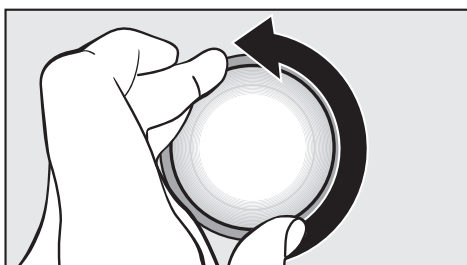

- Turn the lamp cover anti-clockwise to remove it.

Do not touch halogen lamps with your bare fingers.
Use a soft cloth when changing a halogen lamp.

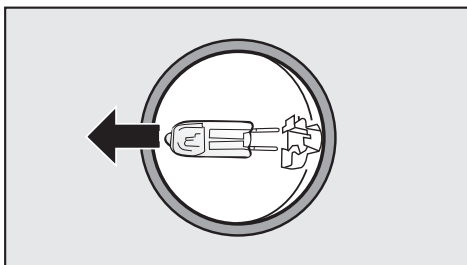

- Pull the defective halogen lamp out.
- Fit the new lamp into the holder.
The following type of halogen lamp is required:
5 W/12 V/ G 4 cap.
- Replace the lamp cover, turning it clockwise as far as it will go.
- Reconnect the appliance to the electricity supply and switch it on.

If you still cannot remedy the fault having followed these suggestions, please contact Miele. However, a call-out charge will be applied for unnecessary service visits where the problem could have been rectified as described in these operating instructions.

To prevent unnecessary loss of temperature, it is advisable not to open the door while waiting for the appliance to be serviced.

Water filter

The appliance is supplied with a standard water filter that filters mains water for making ice cubes.

The installed water filter (bypass filter) can be replaced by a water filter with active charcoal particles. The water filter with active charcoal particles filters out chlorine and other distasteful substances from tap water so that only high quality water is used for producing ice cubes.

New water filters (bypass and active charcoal filter) can be obtained from your Miele Chartered Agent or Miele.

To ensure the quality of the ice cubes remains high, it is essential to change the water filter regularly.

Please note:

- All ice cubes that are produced in the 24 hours after you have changed the water filter should be discarded.
- If you have not used the appliance or the ice cube maker much in the last few weeks, or if the ice cubes smell unpleasant, fit a new water filter.

Reminder to change the water filter

Depending on the amount of ice cubes being made, the water filter will need to be changed approx. every six months.



- When the reminder to change the water filter **lights up** red, this indicates that the filter will soon need to be changed.
- Make sure that you have a spare water filter ready to fit.

New water filters (bypass and active charcoal filter) can be obtained from your Miele Chartered Agent or Miele.

- When the reminder to change the water filter **flashes** red, this indicates that the filter needs to be changed now.

To change the water filter

Air in the system can cause water to gush out and the filter to spring out when it is removed.

Take great care, therefore, when changing the filter.

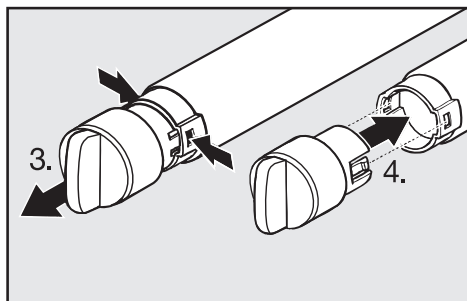

- Remove the cap from the old filter cartridge (3).
- Take the new filter cartridge from its packaging, and remove the protective cover.
- Fit the cap on the new filter cartridge (4).

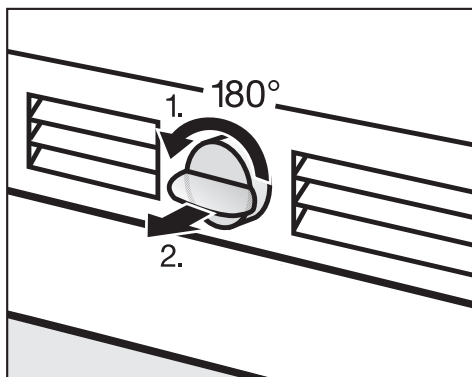

- Press the cap in and turn it 180° in an anti-clockwise direction (1).
- Remove the old filter cartridge (2).

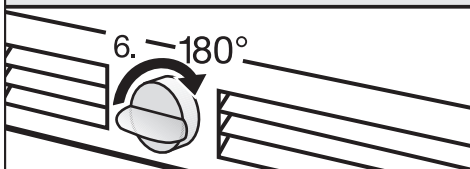
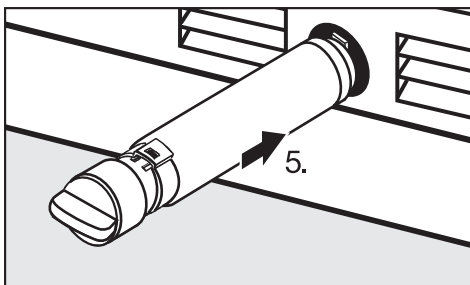

- Push the filter cartridge back into the opening, ensuring that it is straight (5).
- Turn the cap 180° in a clockwise direction until it is horizontal (6).

Water filter



- After the filter has been changed, the reminder to change the filter will continue to flash in the control panel. Confirm that the filter has been changed (see "To confirm the water filter has been changed").

To confirm the water filter has been changed



- Touch and keep your finger on the symbol that reminds you to change the water filter.



- Then place another finger on the access sensor (without moving your finger from the water filter symbol) and leave both fingers there for approx. 5 seconds until you hear a tone.

The replacement of the water filter has now been confirmed and the prompt to remind you of the next water filter change has been activated.

The reminder to change the filter will now go out in the control panel.

- Close the appliance door.

All ice cubes that are produced in the 24 hours after you have changed the water filter should be discarded.

Using an external water filter

If you have already installed an external water filter in your home, still leave the water filter (bypass filter) in place that is supplied with the appliance.

Normal noises	What causes them
Brrrrr ...	A humming noise is made by the motor (compressor). This noise can get louder for brief periods when the motor switches on.
Blubb, blubb ...	A gurgling noise can be heard when coolant is circulating through the pipes.
Click ...	Clicking sounds are made when the thermostat switches the motor on and off.
Sssrrrrr ...	On multi-zone and frost-free appliances you can sometimes just hear the movement of the fan inside the appliance.
	On appliances with a water tank a buzzing sound can be heard when water is being pumped out of the water tank.
Crack ...	A cracking sound can be heard when materials expand inside the appliance.

Remember that the noise of the compressor and the coolant circulating in the system is unavoidable.

Noises that you can easily rectify	Possible cause	Remedy
Rattling, vibrating	The appliance is uneven.	Realign the appliance using a spirit level, by raising or lowering the screw feet underneath the appliance.
	The appliance is touching another appliance or piece of furniture.	Move it away.
	Drawers, baskets or shelves are unstable or sticking.	Check all removable items and refit them correctly.
	Are any bottles or containers unstable or knocking against each other?	Separate them.
	The transport cable clips are hanging loose at the back of the appliance:	Remove the cable clips.

After Sales / Warranty

In the event of a fault which you cannot correct yourself, please contact:

– Miele

The contact details for Miele are given on the back cover of these operating instructions.

When contacting Miele, please quote the model and serial number of your appliance. This information is given on the data plate inside your appliance.

Warranty

The manufacturer's warranty for this appliance is 2 years.

For more information on the manufacturer's warranty specific to your country, please contact Miele.

Notes on connecting to the mains water supply

Connection to the mains water supply should only be carried out by a qualified and competent person in accordance with national and local regulations.

Before plumbing the appliance in, ensure that it is disconnected from the mains electricity supply.

Turn off the water supply at the tap before connecting the water inlet hose for the ice cube maker.

The water quality must conform to the requirements for drinking water in the country in which the appliance is being installed.

This appliance has to be installed in accordance with AS/NZS 3500.1 and AS/NZS 3500.2. Back flow prevention is already integrated in the appliance.

- This appliance meets the requirements of IEC 61770 and EN 61770.
- The water pressure (flow rate) must be between 1.72 bar (172 000 Pa) and 5.0 bar (500 000 Pa).
- Use the hoses supplied with the appliance. Old or used hoses must not be connected to the appliance.

Warning!

If the supply water pressure is greater than 5.0 bar, make sure to install a pressure reducing valve to ensure 5.0 bar is not exceeded. Do not connect the appliance to the water supply or operate the appliance if supply water pressure is greater than 5.0 bar.

- The stainless steel hose is 3 m long. An extension of the stainless steel hose is not permitted.

Replace the stainless steel hose if it is defective. It must only be replaced by an original Miele hose (available from Miele). Please note that this hose is suitable for conveying drinking water.

- A tap must be provided between the stainless steel hose and the household water supply to ensure that the water supply can be disconnected if necessary.

The tap should be easily accessible after the machine has been built in.

Mains water connection

Preparing for plumbing the appliance into the mains water supply

Plumbing connections must be correctly in place before the appliance is built in.

Before making plumbing connections, ensure the appliance is disconnected from the mains electricity supply.

Connection to the mains water supply should incorporate a mains tap with a $\frac{3}{4}$ " thread.

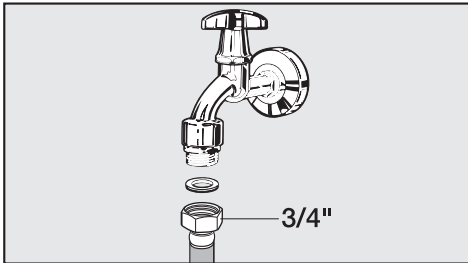

- Connect the stainless steel hose to the tap.
- Ensure that it is screwed into position correctly.

The appliance must only be connected to a cold water pipe that

is directly connected to the fresh water supply in order to ensure circulation of the water in the cold water pipe.

Avoid using a water inlet in which the water is allowed to pool. This can affect the taste of water and ice cubes.

- maintains working pressure.
- meets hygiene regulations.

Mains water connection

Before using the appliance for the first time, the water inlet pipe should be purged of air by a qualified and competent person:

- To do so the stainless steel hose should be filled as much as possible with water before being connected to the appliance.
- Mop up any spillages with a cloth.

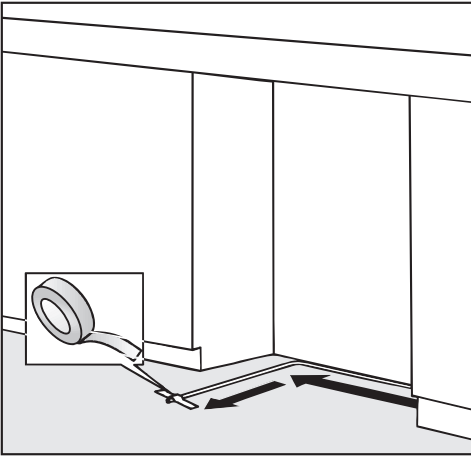

- Place the stainless steel hose in the building-in niche as shown, and secure to the floor with adhesive tape.

This ensures that the hose does not slip or get caught when the appliance is pushed back into the niche.

- The appliance can now be installed in the niche (see "Installation").

On appliances with a feed-through for the water inlet hose,

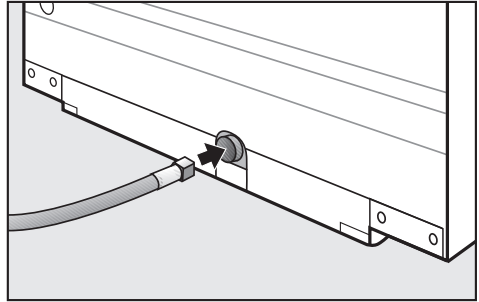

- position the appliance in front of the building-in niche and insert the stainless steel hose into the feed-through at the back of the appliance.

By this time the building-in niche should already have been prepared so that the appliance need only be pushed into it (see "Installation").

- Continue with the installation of the appliance.

Mains water connection

Fitting the stainless steel hose to the appliance

When fitting the stainless steel hose, make sure that it is neither kinked nor damaged.

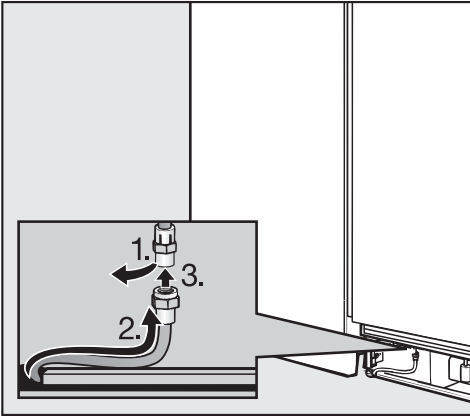

- Remove the cap (1.) from the water connection at the front of the appliance.
- Screw the stainless steel hose coupling nut (2.) onto the threaded union (3.).
- Ensure that all connections are water tight.
- Turn on the tap slowly and check the whole water system for leaks.
- The appliance can then be connected to the electricity supply (see "Electrical connection").

After a maximum of 10 hours, the first ice cubes will drop out of the ice cube maker and collect in the container.

All electrical work should be carried out by a suitably qualified and competent person in strict accordance with current local and national safety regulations.

The appliance is supplied with a mains cable and moulded plug ready for connection to an AC single phase 220 – 240 V 50 Hz supply.

The fuse rating must be at least 10 A.

The voltage and frequency are given on the data plate. Please ensure that these match the household mains supply. Connection should be made via a suitable switched socket which is easily accessible. For extra safety it is advisable to install a suitable residual current device (RCD).

The accessibility of the plug must always be ensured in order to be able to quickly separate the appliance from the mains.

If the mains socket is not accessible after the appliance has been built in, a separator for each terminal must be available. There must be an all-pole contact gap of 3 mm in the switch.

The plug and mains connection cable must not come into contact with the back of the appliance as vibrations can cause damage to these components. This, in turn, could result in a short circuit.

Nor should other appliances be plugged into a socket located directly behind the appliance.

Do not connect the appliance to the mains electricity supply by an extension lead or a plug adapter. Extension leads do not guarantee the required safety of the appliance (e.g. danger of overheating).

Do not connect the appliance to an inverter such as those used with an autonomous energy source e.g. **Solar power**.

When switched on, peak loads in the system can cause the safety switch off mechanism to be triggered. This can damage the electronic unit.

The machine must not be used with so-called **energy-saving devices** either. These reduce the amount of energy supplied to the machine, causing it to overheat.

If the mains connection cable needs to be replaced, this must only be carried out by a qualified electrician.

WARNING
THIS APPLIANCE MUST BE
EARTHED

Installation advice

Location

This appliance should be installed in a dry, well-ventilated room. It should not be installed where it is exposed to direct sunlight or directly adjacent to a heat-producing appliance such as an oven or a radiator. The room temperature should not go above or below the climate range for which the appliance is designed. The higher the ambient temperature of the room, the more energy the appliance requires to operate.

If installation near a heat source is unavoidable, observe the following minimum distances between the appliance and the heat source:

- 3 cm away from an electric oven or range
- 30 cm away from an oil or coal-fired range

Please note the following when installing the appliance:

- The mains connection socket must not be located directly behind the appliance and must be easily accessible.
- The plug and mains connection cable must not come into contact with the rear of the appliance as they may be damaged by vibrations from the appliance.
- Nor should other appliances be plugged into a socket located directly behind this appliance.

Important! tropical / humid environments

During periods of high humidity, some condensation may appear on outside surfaces of the appliance, which may lead to corrosion on the external walls.

For prevention, it is advisable to install the appliance with sufficient ventilation in a dry and/or an air-conditioned room.

Please ensure that doors are closing and sealing properly. Please ensure that the appliance is installed in accordance with these installation instructions and that the handle is fitted correctly. Should you require further assistance, please contact Miele.

Climate range

The appliance is designed for use within a certain climate range (ambient temperatures), and should not be used outside this range. The climate range of the appliance is stated on the data plate inside the appliance.

Climate range	Ambient room temperature
SN	+10 °C to +32 °C
N	+16 °C to +32 °C
ST	+16 °C to +38 °C
T	+16 °C to +43 °C

Operating in a room which is too cold will result in the compressor switching off for too long, causing the internal temperature in the appliance to rise with the risk of food deteriorating and going off.

Safe operation of the appliance is only assured if it has been installed and connected in accordance with these operating and installation instructions.

Warning!

This appliance is very heavy and can tip forwards when the door is open. Keep the door shut until the appliance has been built in and secured within the building-in niche in accordance with these instructions.

Due to the size and weight of the appliance, installation must be carried out by two people.

The weight of the appliance when empty is:

KF 1801 Vi, KF 1811 Vi 206 kg

KF 1901 Vi, KF 1911 Vi 225 kg

Installation advice

Floor

To ensure the safe installation of the appliance and to guarantee its correct functioning, the floor in the niche where the appliance is to be installed must be smooth and even.

It must be made from strong, rigid material.

The appliance is extremely heavy when fully loaded, and for this reason it is imperative that the floor it stands on is able to bear its weight. If necessary, the advice of an architect or structural engineer should be sought.

When fully loaded, the approx. weight of the appliance is:

KF 1801 Vi, KF 1811 Vi 431 kg
KF 1901 Vi, KF 1911 Vi 537 kg

Door hinging

The appliance is supplied with fixed hinges. If you need to change the door hinging to the other side, please contact Miele.
On no account should you attempt to change the door hinging yourself.

Adjoining furniture/units

The appliance is screwed to the adjoining furniture/units at the side and above.

For this reason, it is essential that all furniture/units be fixed to the ground and/or wall.

Ventilation

The air vents must not be covered or blocked in any way.
They should be dusted on a regular basis.

Side-by-side installation

This appliance may be installed "side-by-side" with another suitable refrigerator or freezer.

A side-by-side installation kit, available from Miele, is required. Please contact Miele to find out which appliances are suitable for side-by-side installation with this appliance.
See the instructions supplied with the side-by-side installation kit for how to fix the appliances together.

The side-by-side installation kit will consume additional energy to that stated on the appliance energy label of each individual appliance. The additional rating per appliance will be 25 W or 219 kWhrs per year.

Joining the appliances together without a partition wall using the side-by-side installation kit

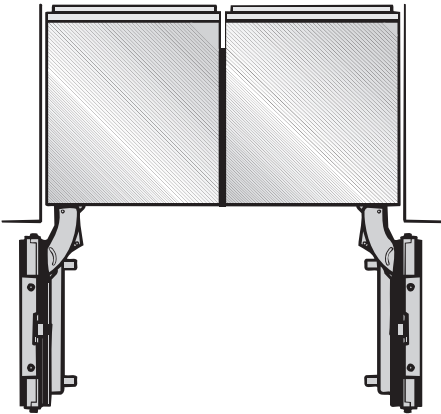

If the appliances are to be installed next to each other without a partition wall between them, they will need to be joined together with the side-by-side installation kit.

If the partition wall between the two appliances is **between 16 mm and 160 mm** thick, each appliance must be built into its own niche using the assembly parts supplied. The side-by-side installation kit is also required.

Installation with a partition wall without the side-by-side installation kit

If the partition wall between the two appliances is **more than 160 mm** thick, each appliance must be built into its own niche using the assembly parts supplied (without using the side-by-side installation kit).

Installation with a partition wall using the side-by-side installation kit

The partition wall must be at least 16 mm thick.

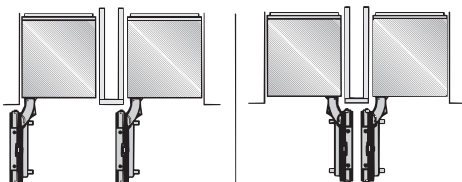
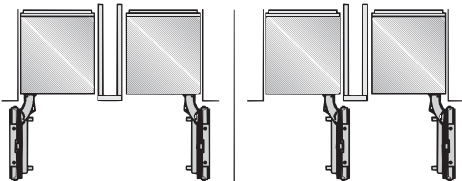

Installation advice

Limiting the opening angle of the door

The door hinges are set at the factory to enable the door to be opened wide.

However, if the appliance door hits an adjacent wall when opened, for example, the opening angle can be limited to 90°.

- Open the appliance door.

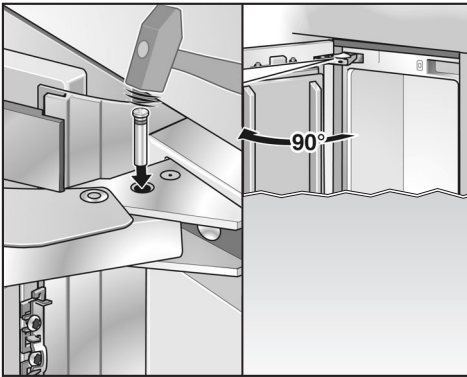

- Insert the pin into the hinge from above, as shown.

The door opening angle is now limited to 90°.

Appliance door dimensions (opening angle 90°)

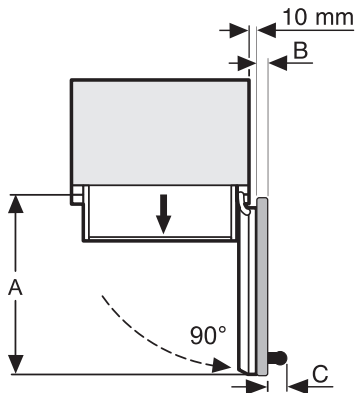

* The dimensions of the door fronts and handles will vary according to the individual kitchen.

	A	B	C
KF 1801 Vi, KF 1811 Vi	829 mm	Door front (max. 38 mm)*	Door handle*
KF 1901 Vi, KF 1911 Vi	982 mm	Door front (max. 38 mm)*	Door handle*

Installation advice

Appliance door dimensions (opening angle 115°)

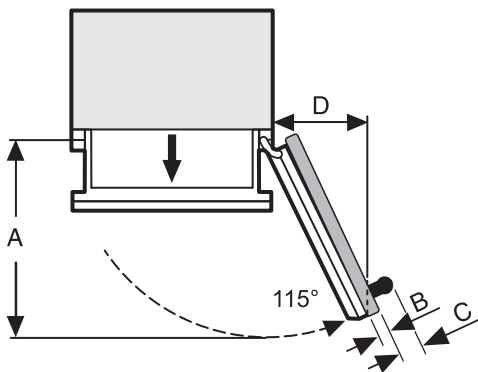

* The dimensions of the door fronts and handles will vary according to the individual kitchen.

	A	B	C	D
KF 1801 Vi, KF 1811 Vi	829 mm	Door front (max. 38 mm)*	Door handle*	363 mm
KF 1901 Vi, KF 1911 Vi	982 mm	Door front (max. 38 mm)*	Door handle*	428 mm

Building-in dimensions

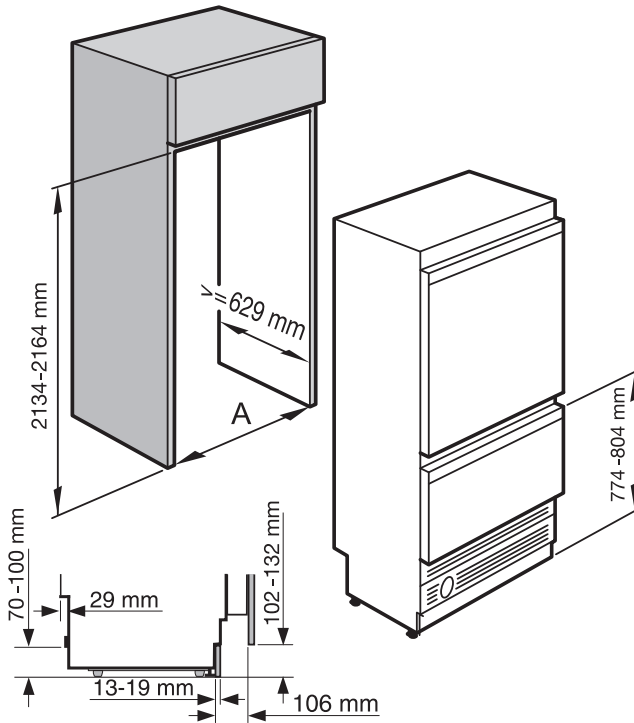

	Niche width A
KF 1801 Vi, KF 1811 Vi	762 – 765 mm
KF 1901 Vi, KF 1911 Vi	915 – 918 mm

Building-in dimensions

Laying the electrical cabling and the pipework for the mains water supply

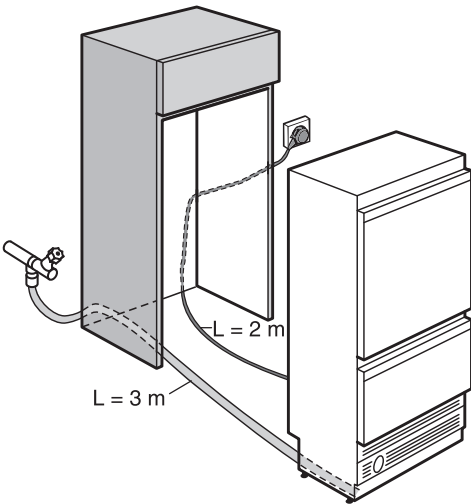

Door/drawer front dimensions

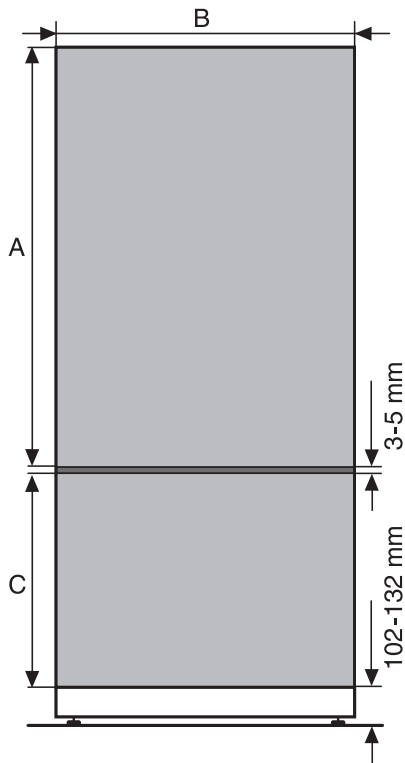

	A	B	C
KF 1801 Vi, KF 1811 Vi	1354 mm	756 mm	672 mm
KF 1901 Vi, KF 1911 Vi	1354 mm	908 mm	672 mm

Due to the size and weight of the appliance, it is essential that installation is carried out by two people.

Tools and accessories required

- Power drill
- TX screwdriver
- Hammer drill
- Drill bits in various sizes, depending on materials
- Hammer
- Socket wrench (Attachment: nut, 8 mm)
- Adhesive tape
- Pipe wrench
- Spirit level
- Try-square

If bolting the housing unit to the wall behind:

- suitable plugs and fixing screws according to the composition of the wall

Other

- Step ladder
- Sack barrow
- Wooden beam (min. 75 mm x 100 mm) if required, to prevent tilting; length depends on width of housing
- Wood screws in various sizes

Optional accessories

- Side-by-side installation kit for side-by-side installation of two appliances

Installation

Stainless steel fronts

Stainless steel fronts and plinth grilles with a stainless steel look are available from Miele.

Weight of the door fronts

Before fitting a furniture door, ensure that the weight of the door does not exceed the maximum permitted.

Appliance	max. weight of upper furniture door in kg	max. weight of lower furniture door in kg
KF 1801 Vi, KF 1811 Vi	47	10
KF 1901 Vi, KF 1911 Vi	38	14

Fitting a door which is heavier than the maximum permitted could damage the hinges.

Building into a peninsular run

When built into a peninsular run, the rear of the building-in niche must be fitted with a kitchen furniture panel.

Building-in at the end of a run of units

If one side of the appliance is visible, a side panel is required.

The side panel must be fixed to the wall, the floor and any furniture/units above before the appliance is placed in the niche.

The size of the side panel must match that of the furniture panel opposite.

Aligning the housing unit

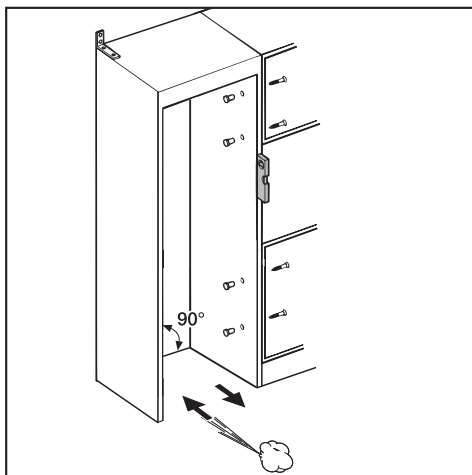

The housing unit must be carefully aligned using a spirit level before installing the appliance. The unit corners must be at right angles, as otherwise the furniture door will not align correctly with the 4 corners of the appliance.

- The side panels of the housing unit must be even.
- The housing unit panels must be at least 16 mm thick.
- The plinth facing must be at least 13 mm thick (preferably 19 mm).

Checking the building-in niche

- The building-in dimensions now need to be checked.
- Check the position of the electrical and plumbing connections (see "Electrical connection" and "Mains water connection").
- Check that all surrounding furniture/units are securely fixed to the wall.
- Check the surrounding furniture/units for possible clashes when opening doors.

Before installation



Warning!

This appliance is very heavy and can tip forwards when the door is open.

- Before installation, take any accessories out of the appliance and/or from the back of the appliance.
- Remove any cable clips from the back of the appliance.
- Check that all parts at the back of the appliance are unhindered. Carefully remove any hindrance.

To protect the floor from damage when installing the appliance,

- secure an off-cut of flooring (e.g. lino) or similar to the floor in front of the installation area.

Installation

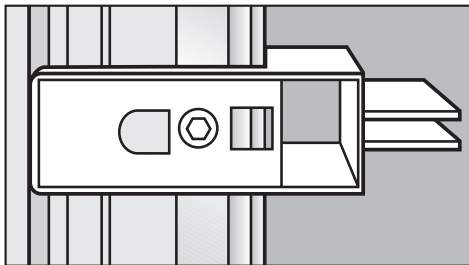

The appliance can be rolled along the floor using the wheels at the back.

Preparing the niche

 Keep the door and drawer to the appliance closed until it is fixed inside the building-in niche.

- Do **not** remove the installation aids from the appliance doors. These will be required later when the appliance is installed in the building-in niche.
- Check the appliance for damage during transportation.

Do not install a damaged appliance!

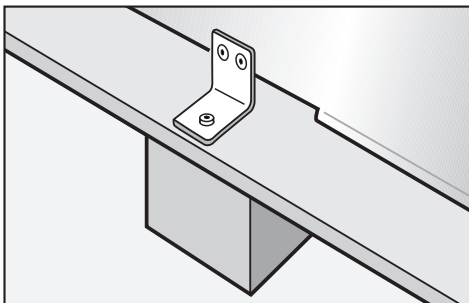

- Unscrew the bracket that is holding the appliance to the delivery pallet.

 **Warning!**
Please bear in mind that the appliance is no longer secured to the pallet!

- With the help of several people as required, carefully lift the appliance from the pallet, starting with the back of the appliance.

Due to the sheer size and weight of the appliance, it needs to be ensured that it cannot tip forwards once it is built into the niche.

Assembly parts

All the fixings required for installation are supplied with the appliance. The plastic bags are marked with letters for easy identification.

Each fitting stage is indicated by the letter on the bag needed for that stage.

Anti-tipping mechanism

The anti-tipping mechanism ① ensures the housing unit ② is securely fixed to the wall and tipping of the appliance is prevented.

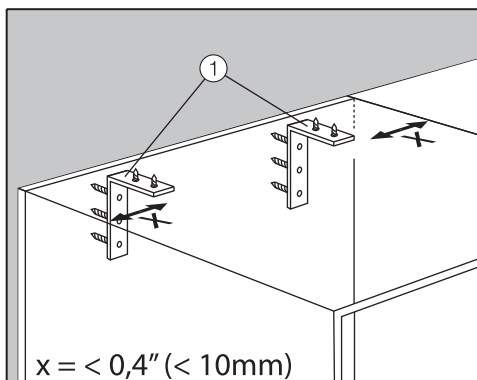

Use two anti-tipping mechanisms for each appliance or four for each side-by-side combination of appliances.



- Position the anti-tipping mechanisms ① at the rear of the housing unit on the left and right, leaving a gap to the wall of no more than 10 mm.
- While holding the anti-tipping mechanisms in place, mark the necessary drill holes at the top and rear of the housing unit.
- Put the anti-tipping mechanisms in a safe place - they will be required later.

Fixing screws for different uses and types of material are supplied in the accompanying pack. If these are not suitable for the anti-tipping mechanism in your installation, you will need to secure it by alternative means.



- Secure the housing unit to the wall.

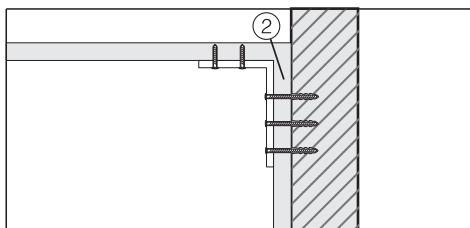

Danger of tipping

The housing unit must be fixed to the wall behind with several screws. Only this can ensure that the appliance will not tip over after being installed.

Installation

An alternative anti-tipping mechanism

If it is not possible to fix the anti-tipping mechanisms securely to the floor of the niche, the appliance can be secured at the top using a wooden beam. If this method is used, then there must not be any gap between the appliance and the wooden beam.

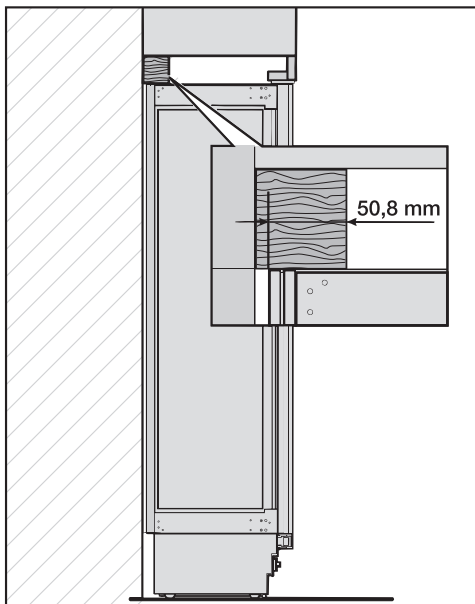

- Mark the position of the lower edge of the wooden beam on the rear wall of the niche.

- Select screws of a length depending on the thickness of the wood.

Use the number of screws appropriate to the housing width to ensure that the wooden beam is securely fixed.

- Check where the upright wall supports are in the back of the niche, and mark the drill holes in the wooden beam accordingly.

- First, drill the holes in the wooden beam.

- Secure the wooden beam to the back wall of the niche.

Now prepare the mains water connection for the appliance (see "Mains water connection").

- The wooden beam must be at least 75 mm x 100 mm thick.
- The length must be the same as the width of the building-in niche.
- If the building-in niche is deeper than the appliance, a thicker wooden beam should be used.
- The wooden beam must cover the appliance to a depth of at least 50.8 mm (see diagram).

Placing the appliance in the niche

If you are installing two appliances side by side, now secure the appliances to one another (see the instructions for the side-by-side installation kit).

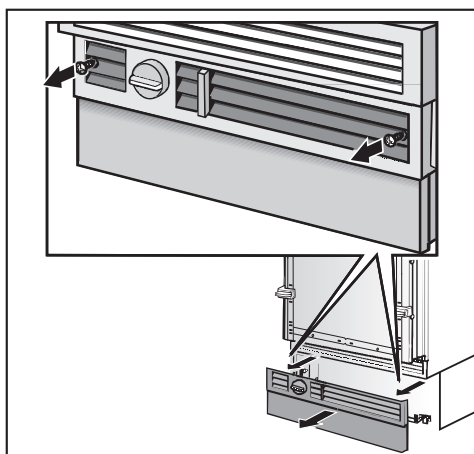

- Unscrew the plinth facing.

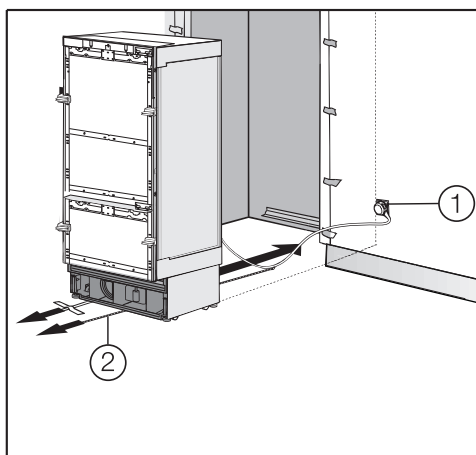

- Affix temporary protection to adjacent furniture fronts.

- Plug in the appliance ①.

Connection should be made via a suitable switched socket. The socket should be close to the appliance and easily accessible.

When installing two appliances side by side, each appliance must have its own separate socket.

- Secure the cable to prevent it becoming caught:
Tie a piece of string to the middle of the cable, and as the appliance is being pushed into the niche, pull the cable forward underneath the appliance ②.
- Carefully slide the appliance into the housing unit.

If the appliance does not slide easily into the niche (e.g. if the floor is uneven),

- screw out the rear feet slightly (see "Aligning the appliance") and slide the appliance into the niche.

Then push the appliance into the niche, taking care not to damage the electrical and mains water connections.

- Remove the temporary protection from the adjacent furniture fronts.

Installation

Aligning the appliance

- Align the appliance with neighbouring furniture fronts.

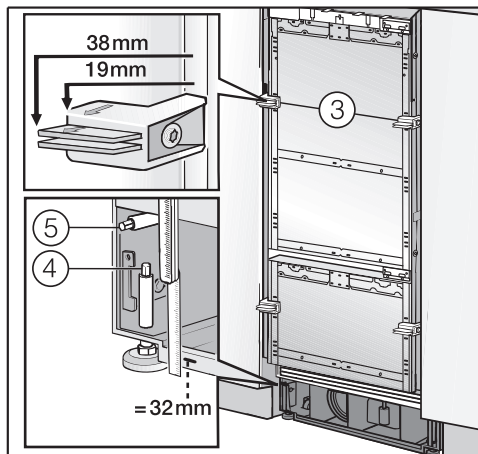

The installation aids ③ on the appliance door are suitable for a thickness of 19 mm or 38 mm.

The adjustable feet at the front and back of the appliance can all be adjusted from the front:

- Front feet:
Adjustment from above with a socket wrench (attachment: nut, 8 mm) ④.
- Back feet:
Adjustment with a power drill or socket wrench (attachment: nut, 8 mm) for fine adjustment ⑤.
- Place a spirit level across the installation aids ③ on the appliance door to check the appliance's alignment.

Important!

Proceed carefully when adjusting the feet, alternating between the left and right feet.

- A mark is located on the appliance base. When adjusting the height, this mark needs to be aligned at 32 mm from the floor. Unscrew the feet until the mark on the base has reached 32 mm. This measurement of 32 mm corresponds to a building-in recess height of 2134 mm.

Important!

Unscrew the feet until the mark is **aligned to a maximum** of 62 mm from the floor (max. building-in recess of 2164 mm). Otherwise the rear feet alignment will be damaged.

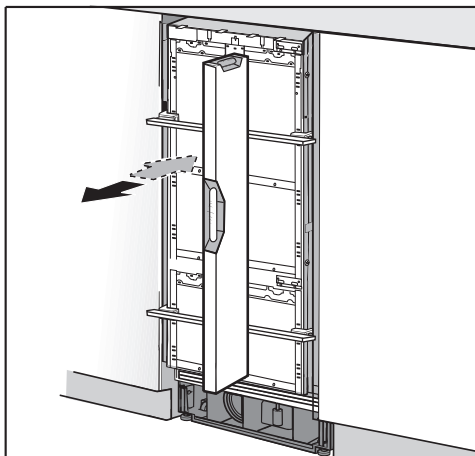

- Check the alignment of the appliance again using the spirit level.

- If a wooden beam has been fitted above the appliance to prevent tipping, the appliance height needs to be adjusted so that the appliance fits snugly under the wooden beam.

Securing the appliance in the niche

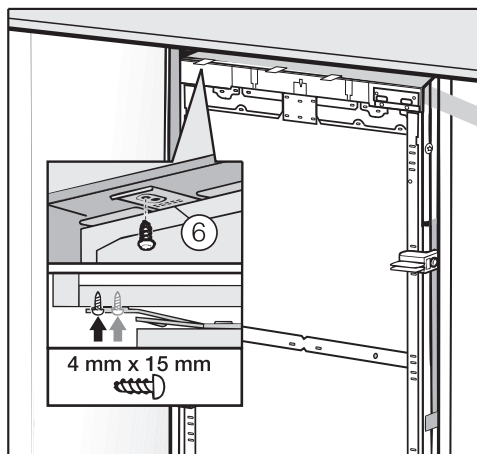

- Screw the lugs for the fixing plate ⑥ into the furniture/units above the appliance.

If it is not possible to secure the appliance above, it can be attached to the housing at the sides only:

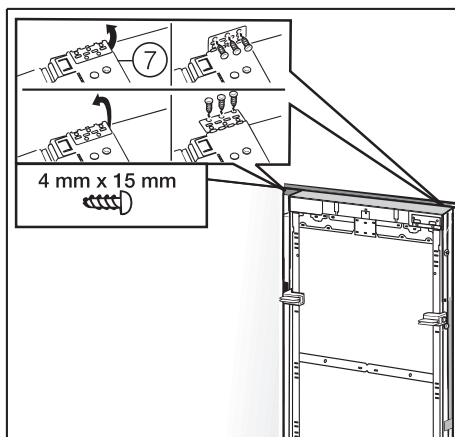

- Pull out the lugs for the side fixing plates ⑦.



- Screw on the lugs for the side plates.

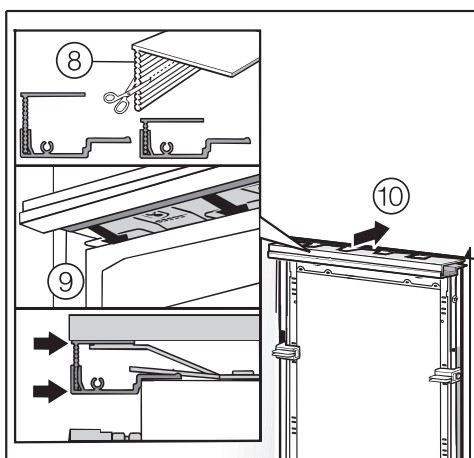

- If necessary, cut the trim ⑧ to the necessary width.
- Join the two bits of trim together ⑨.
- Click them into position ⑩.

Installation

When installing two appliances **side by side**, the trims for the two appliances need to be joined together to form one long strip:

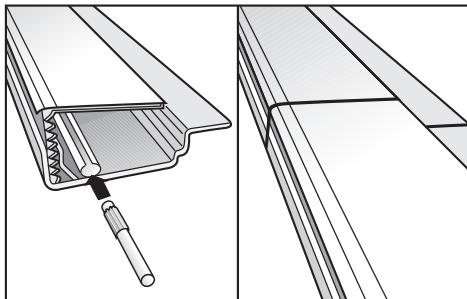

- Insert the joining peg from the side-by-side kit halfway into the channel in the trim for the left-hand appliance.
- Then insert the free half of the joining peg into the channel on the other trim, and press the two trims together.
- Click the two trims into place above the appliances.

- Open both appliance doors.

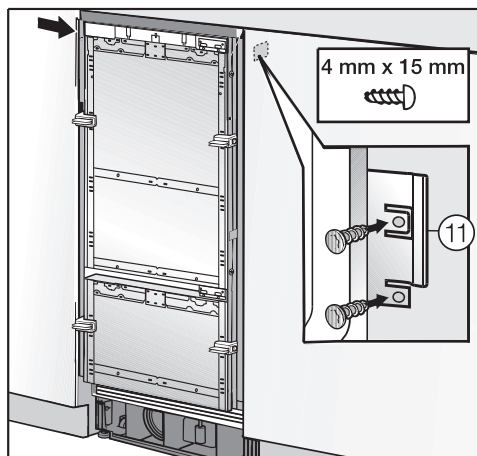
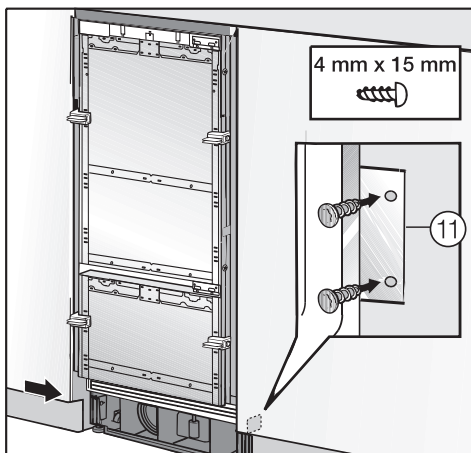

- Screw the lugs for the fixing plates ⑪ at the bottom and top of the furniture/units adjacent to the appliance.

In a side-by-side combination, only the external panels of the two appliances can be secured to the furniture wall.

Connect the water inlet hose to the appliance (see "Mains water connection").

Preparing the furniture fronts

To ensure the correct alignment of the furniture fronts, it is vital to fix the furniture door to the refrigerator before fixing the drawer front to the freezer.

- Load the door shelves in the appliance door.
- Open the appliance door as far as it will go.

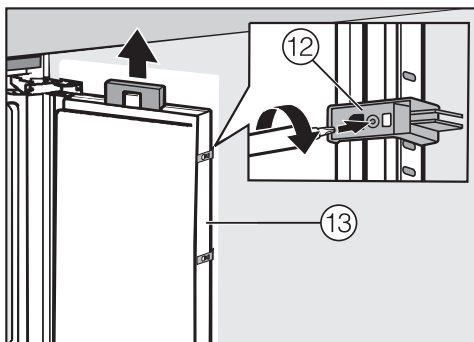

- Unscrew the installation aids ⑫ and angle trim ⑬ from the door.
- Put the angle trim ⑬ and screws in a safe place - they will be required later.
- Remove the cover from the light contact switch.
- Close the appliance door.

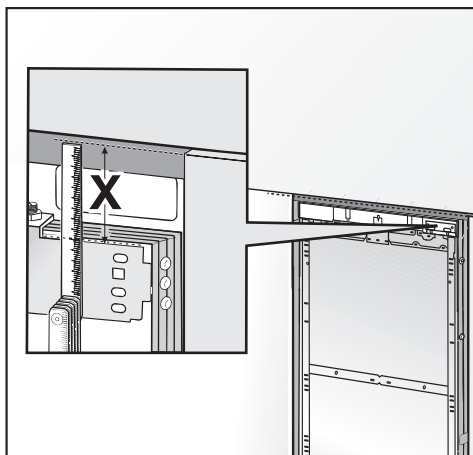

- Measure the gap **X** between the adjusting bar and the upper edge of the adjacent furniture front.
- Remove the two nuts from the appliance door, and place them in a safe place - they will be required later.
- Place the furniture front on a firm surface, with the external side facing downwards (place on a blanket or similar to avoid it becoming scratched).

Installation

- Mark the gap **X** on the inside of the furniture front.

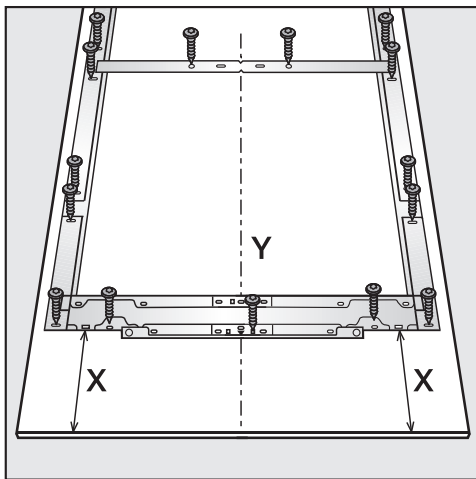

- The mounting frame has several different types of holes to take account of a variety of furniture fronts.
 - When securing the frame, always screw into the strongest part of the furniture door.
 - To do this, select screws which are slightly shorter than the thickness of the furniture door.
- Screw the appliance handle to the furniture door from the inside.

- Similarly, locate and mark the midpoint **Y** on the furniture front.
- Remove the mounting frame from the appliance door and position it according to the markings on the furniture front.
- Pre-drill the holes.
- Screw the mounting frame to the furniture front, using at least one screw for each fixing point.



- Secure the mounting frame to the top of the furniture front, using at least 10 screws:

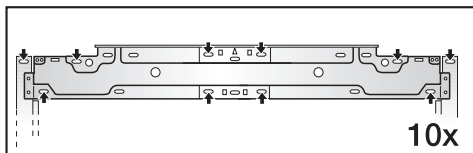

Securing and aligning the furniture door

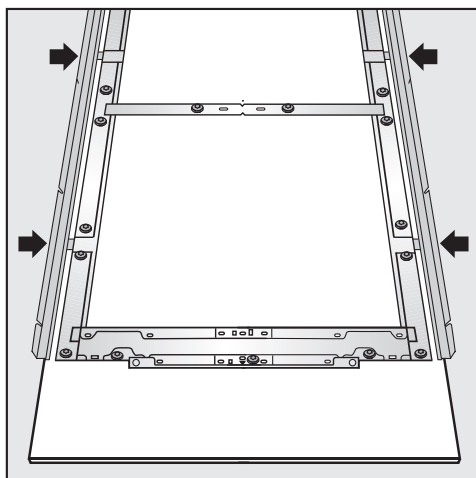

- Insert the angle trim (13) as far as it will go into the spaces in the frame, as shown.

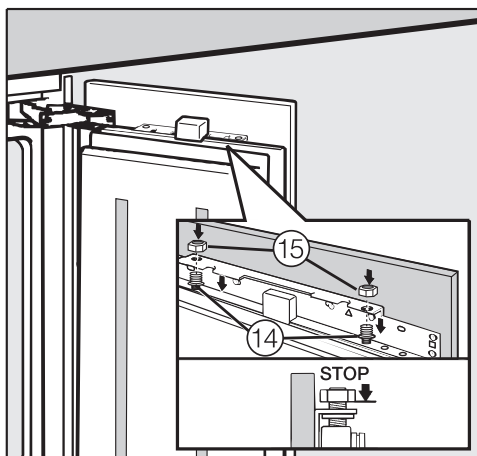

- Open the appliance door and hang the furniture front on its frame onto the threaded bolts, as shown (14).

- Press the pieces of angle trim (13) on both sides into the white plastic frame, and screw them down securely. Spare screws can be found in the plastic bag marked "E".
- Screw the nuts (15) loosely onto the threaded bolts, but do not tighten yet.
- Close the door and check the distance between the door and neighbouring furniture doors.

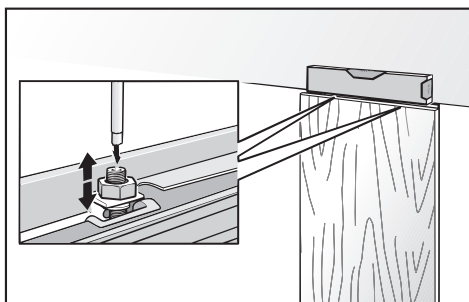

- Align the height of the appliance door by sliding it over the threaded bolts (14).
- Align the depth of the refrigerator door via the gaps in the angle trim (13). Then screw the angle trim into position.
- Now screw on the top nuts (15). The door is now fixed.

Repeat the steps from "Preparing the furniture fronts" to fit the furniture front to the freezer drawer.

The positioning of the freezer drawer front must be aligned to that of the refrigerator door front.

Installation

When fitting the drawer front, bear in mind the gap between the drawer and the refrigerator door front:

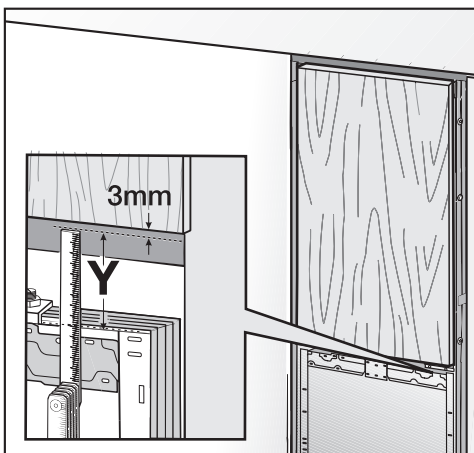

- Measure the gap **Y** between the adjusting bar on the freezer drawer and the refrigerator door.
- A gap of 3 mm needs to be maintained between the drawer and refrigerator door.

Fitting the fixing brackets

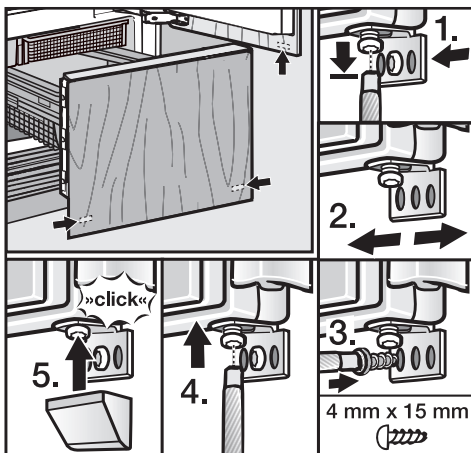

The fixing brackets are used to secure the furniture front to the freezer drawer at the bottom.

- Open the freezer drawer as far as it will go.
- Slightly loosen the screw (1.).
- Position the fixing bracket on the drawer (2.) and pre-drill a hole in the furniture front.



- Screw the fixing bracket securely to the furniture front (3.).
- Then tighten the screw (4.) as shown.
- Fit the cover to the fixing bracket (5.).

The number of fixing brackets required will depend on the material and width of the furniture front.

Securing the covers

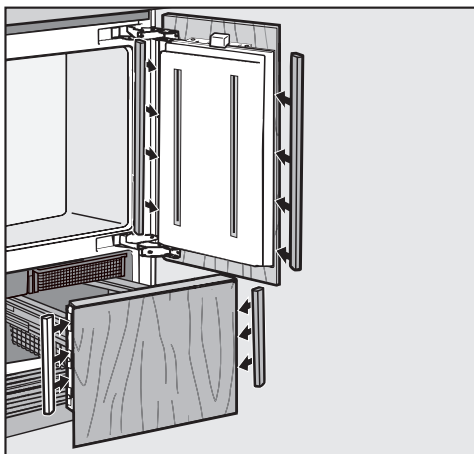

- Fit the two cover strips to both sides of the refrigerator door and freezer drawer, clicking them into the space between the appliance door/drawer and the furniture front, starting at the bottom and working up to the top.

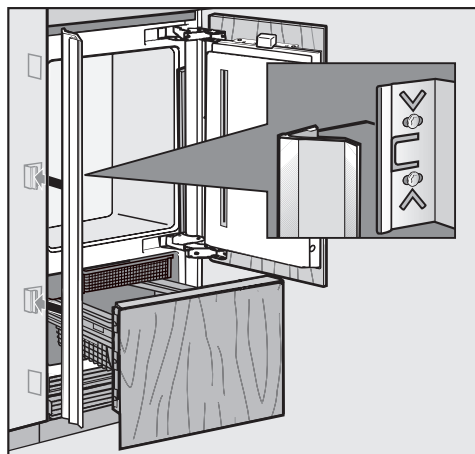

- Now attach the covers onto the retaining clips on both sides. In the case of side-by-side installation, the cover strips are only required on the outer side.

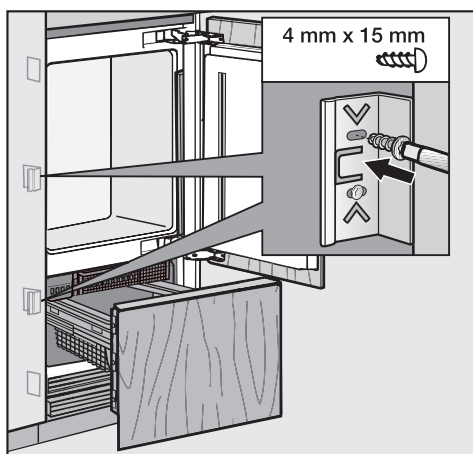

- Secure the retaining clips for the covers on both sides.

Installation

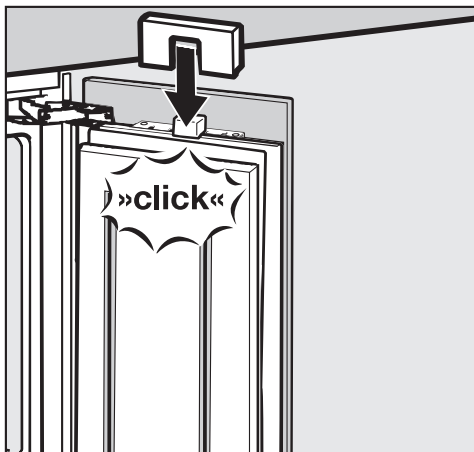

- Fit the cover to the light contact switch so that it clicks into place as shown.

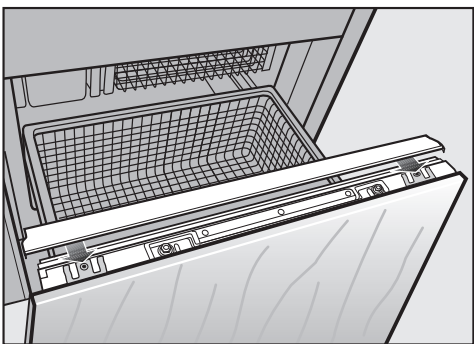

- Fit the cover to the top edge of the freezer drawer as shown.

Fitting the plinth facing

Do not cover the vents in the plinth. This will damage the appliance.

- Trim the plinth facing to the required length and height (cut along the lower edge of the plinth facing where it touches the floor).

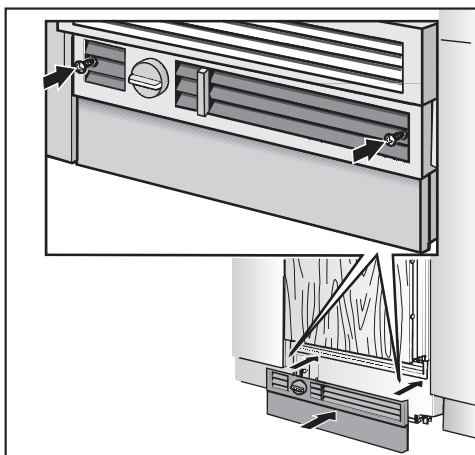

- Secure the plinth to the appliance, and attach the cover discs supplied.

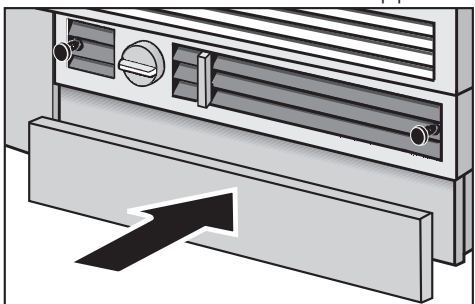

- Now fit the plinth facing.

Fitting the air separator

The air separator in the vent underneath separates air entering the appliance from that leaving it. It also stops warm air flowing into the appliance, which would cause a short circuit.

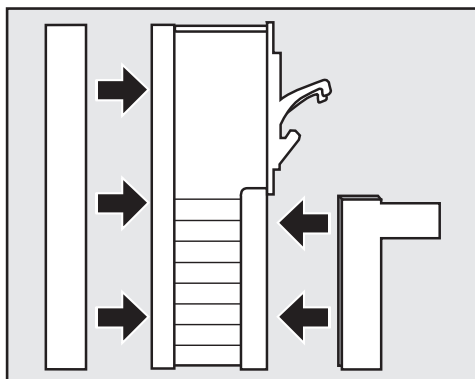

- If necessary, the three parts of the air separator can be shortened to the correct height.
- Refit the foam parts in the sides.

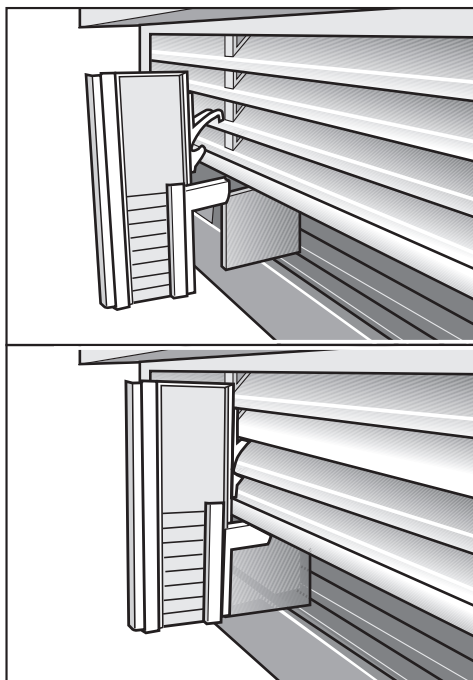

- Clip the air separator to the left and right of the partition in the exhaust grille. Make sure that it clicks into place and that the foam partition is guided under the exhaust grille.

Miele Australia Pty. Ltd.

ACN 005 635 398

ABN 96 005 635 398

Miele**Miele Center and Head Office Melbourne:**1 Gilbert Park Drive
Knoxfield, VIC 3180**Miele Center and Office Melbourne:**206-210 Coventry Street
South Melbourne, VIC 3205**Miele Center and Office Sydney:**3 Skyline Place
Frenchs Forest, NSW 2086**Miele Center and Office Brisbane:**39 Harvey Street North
Eagle Farm, QLD 4009**Miele Center and Office Adelaide:**83-85 Sir Donald Bradman Drive
Hilton, SA 5033**Miele Center and Office Perth:**205-207 Stirling Highway
Claremont, WA 6010**www.miele.com.au****Miele Appliances India Pvt. Ltd.**Ground Floor, Copia Corporate Suites
Plot No. 9, Jasola
New Delhi – 110025
Tel: 011-46 900 000
Fax: 011-46 900 001
E-mail: customercare@miele.in
Internet: www.miele.in**Miele New Zealand Limited**

IRD 98 463 631

Head Office:Level 2, 10 College Hill
Freemans Bay, Auckland 1011**Miele Center Auckland:**8 College Hill
Freemans Bay, Auckland 1011**Telephone:**

0800 4 MIELE (0800 464 353)

www.miele.co.nz**Miele Global Headquarters****Germany****Miele & Cie. KG**Carl-Miele-Straße 29
33332 Gütersloh
Federal Republic of Germany

KF 1801 Vi, KF 1811 Vi
KF 1901 Vi, KF 1911 Vi