

## Operating and installation instructions



### Refrigerator with PerfectFresh zone and DynamicCooling K 14827 SD K 14827 SD ed/cs (-1)

To avoid the risk of accidents or damage to the appliance, it is **essential** to read these instructions before it is installed and used for the first time.

en - AU, NZ

M.-Nr. 09 432 270

# Contents

---

<b>Guide to the appliance</b>	4
<b>Caring for the environment</b>	6
<b>Warning and Safety instructions</b>	7
<b>How to save energy</b>	15
<b>Switching on and off</b>	17
Before using for the first time	17
Cleaning and care	17
Operating the appliance	17
Settings mode	18
Switching the sensor tones on/off	19
Activating or de-activating the safety lock	19
Switching off for longer periods of time	20
<b>The correct temperature</b>	21
... in the refrigerator and the PerfectFresh zone	21
DynamicCooling	21
Setting the temperature	21
Temperature range	22
Setting the temperature in the PerfectFresh zone	22
Temperature display	23
Changing the temperature display brightness	23
<b>Alarm</b>	24
To switch off the door alarm whilst the door is still open	24
To switch on the door alarm	24
<b>SuperCool</b>	25
The SuperCool function	25
<b>Using the refrigerator efficiently</b>	26
Different storage zones	26
Food which should not be stored in a refrigerator	27
When shopping for food	27
Storing food correctly	27
Unpackaged meat and vegetables	27
<b>Using the PerfectFresh zone</b>	28
Storage temperature	28
Humidity level	28
Storing food in the PerfectFresh zone compartments	28
The dry compartment	28
The humidity-controlled compartment	29

<b>Adjusting the interior fittings</b> . . . . .	32
Moving the shelves . . . . .	32
Split shelf . . . . .	32
Adjusting the condiment tray/bottle shelf . . . . .	33
Universal container . . . . .	34
Moving the bottle divider . . . . .	34
<b>Automatic defrost</b> . . . . .	35
Refrigerator section and PerfectFresh zone . . . . .	35
<b>Cleaning and care</b> . . . . .	36
Cleaning the interior and accessories . . . . .	37
Cleaning the door and side panels . . . . .	38
Ventilation gaps . . . . .	39
Door seal . . . . .	39
Rear of appliance - metal grille . . . . .	39
<b>Active charcoal filters</b> . . . . .	40
To change the active charcoal filters . . . . .	40
<b>Problem solving guide</b> . . . . .	42
<b>Noises</b> . . . . .	44
<b>After Sales</b> . . . . .	45
<b>Information for Chartered Agents</b> . . . . .	46
Demonstration mode . . . . .	46
<b>Electrical connection</b> . . . . .	47
<b>Installation</b> . . . . .	48
Side-by-side installation . . . . .	48
Location . . . . .	48
Climate range . . . . .	49
Ventilation . . . . .	49
Appliance with supplied wall spacers . . . . .	49
Installation . . . . .	50
Aligning the appliance . . . . .	50
Supporting the appliance door . . . . .	50
Appliance dimensions . . . . .	51
<b>Changing the door hinging</b> . . . . .	52
<b>Aligning the appliance door</b> . . . . .	61
For appliances with height adjustable doors (stainless steel appliances). . . . .	61
<b>Building in the appliance</b> . . . . .	62

# Guide to the appliance

---

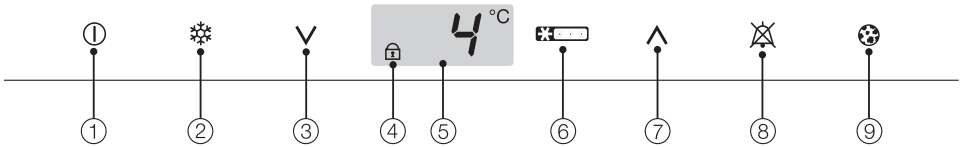

- |   |   |
|---|---|
| ① On/Off sensor   | ⑤ Temperature display   |
| ② SuperCool sensor  | ⑥ "Cooling" symbol  |
| ③ Sensor for setting a lower temperature (V)                                  | ⑦ Sensor for setting a higher temperature (^)   |
| ④ Safety lock indicator light<br>(only visible when Safety lock is activated) | ⑧ Alarm off sensor<br>(only visible when the door alarm sounds)   |
|   | ⑨ Change active charcoal filter indicator<br>(only visible when the active charcoal filters need to be changed) |

- ① DynamicCooling fan
- ② Ceiling lighting
- ③ Butter and cheese compartment
- ④ Universal container
- ⑤ Egg tray/Condiment tray
- ⑥ Bottle rack
- ⑦ Active charcoal filter holder
- ⑧ Adjustable shelves
- ⑨ Bottle shelf
- ⑩ Bottle divider
- ⑪ Condensate channel and drain hole
- ⑫ PerfectFresh zone, dry compartment
- ⑬ Control for setting the moisture level in the humidity controlled compartments
- ⑭ PerfectFresh zone, humidity controlled compartments

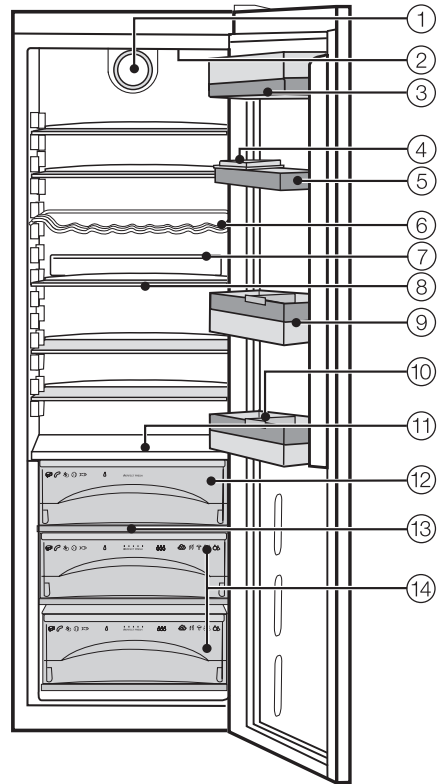

# Caring for the environment

---

## Disposal of the packing material

The transport and protective packing has been selected from materials which are environmentally friendly for disposal and can normally be recycled.

Ensure that any plastic wrappings, bags, etc. are disposed of safely and kept out of the reach of babies and young children. Danger of suffocation.

Rather than just throwing these materials away, please ensure they are offered for recycling.

## Disposing of your old appliance

Electrical and electronic appliances often contain materials which, if handled or disposed of incorrectly, could be potentially hazardous to human health and to the environment. They are, however, essential for the correct functioning of your appliance. Please do not therefore dispose of it with your household waste.

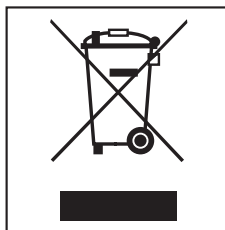

Please dispose of it at your local community waste collection / recycling centre and ensure that it presents no danger to children while being stored for disposal.

The plug must be rendered useless and the cable cut off directly behind the appliance to prevent misuse. Take care not to damage the pipework at the back of it before or during transportation to an authorised collection depot. In this way, refrigerant in the pipework and oil in the compressor will be contained, and will not leak out into the environment.

## Warning and Safety instructions

---

This appliance complies with all relevant local and national safety requirements. Improper use of the appliance can, however, present a risk of both personal injury and material damage.

To avoid the risk of accidents and damage to the appliance, please read these instructions carefully before installation and before using it for the first time. They contain important notes on the installation, safety, operation and care of the appliance. Miele cannot be held liable for damage caused by non-compliance with these Warning and Safety instructions.

Keep these instructions in a safe place and pass them on to any future owner.

### Correct application

► This appliance is designed for domestic use and for use in similar environments by guests in hotel or motel rooms, bed & breakfasts and other typical living quarters. This does not include common/shared facilities or commercial facilities within hotels, motels or bed & breakfasts.

This appliance is not suitable for outdoor use.

► This appliance is intended for the cool storage food and drinks. Any other usage is not supported by the manufacturer and could be dangerous.

## Warning and Safety instructions

---

► This appliance is not suitable for storing and refrigerating medications, blood plasma, laboratory preparations or similar substances or products. Incorrect use of the appliance may result in damage to or spoiling of the food or drinks being stored. Furthermore, the appliance must not be operated in areas where explosions may occur. Miele cannot be held liable for damage resulting from improper or incorrect use of the appliance.

► This appliance is not intended for use by persons (including children) with reduced physical, sensory or mental capabilities, or lack of experience and knowledge, unless they have been given supervision or instruction concerning its use by a person responsible for their safety, and are able to recognise the dangers of misuse.

### Safety with children

► Young children must not be allowed to use this appliance.

► Older children may only use the appliance when its operation has been clearly explained to them and they are able to use it safely, recognising the dangers of misuse.

► Cleaning may only be carried out by older children under the supervision of an adult.

► Children should be supervised to ensure that they do not play with the appliance. Keep small children away from the appliance at all times to avoid the risk of injury.



► Danger of suffocation! Children may be able to wrap themselves in packing material or pull it over their heads with the risk of suffocation. Keep children away from any packing material.

### Technical safety

► The refrigerant circuit has been checked for leaks. This appliance complies with all current local and national safety requirements.

► This appliance contains the coolant Isobutane (R600a), a natural gas which is environmentally friendly. Although it is flammable, it does not damage the ozone layer and does not increase the greenhouse effect.

The use of this coolant has, however, led to a slight increase in the noise level of the appliance. In addition to the noise of the compressor, you might be able to hear the coolant flowing around the system. This is unavoidable, and does not have any adverse effect on the performance of the appliance.

Care must be taken during the transportation and setting up of the appliance that no parts of the cooling system are damaged. Leaking refrigerant can damage the eyes.

In the event of any damage:

- avoid any flames or anything which creates a spark,
- switch off at the mains and unplug the appliance,
- ventilate the room where the appliance is located for several minutes, and
- call Miele.

## Warning and Safety instructions

---

► The more coolant there is in an appliance, the larger the room it should be installed in. In the event of a leakage, if the appliance is in a small room, there is the danger of combustible gases building up. For every 8 g of coolant at least 1 m<sup>3</sup> of room space is required. The amount of coolant in the appliance is stated on the data plate inside the appliance.

► Before connecting the appliance to the mains supply, make sure that the rating on the data plate corresponds to the voltage and frequency of the household supply. This data must correspond in order to avoid risk of damage to the appliance. Consult a qualified electrician if in any doubt.

► The electrical safety of this appliance can only be guaranteed when continuity is complete between it and an effective earthing system which complies with local and national safety regulations. It is most important that this basic safety requirement is present and tested regularly and, where there is any doubt, the household wiring system should be inspected by a qualified electrician.

► If the connection cable is faulty, it must only be replaced by a Miele approved service technician to protect the user from danger.

► Do not connect the appliance to the mains electricity supply by a multi-socket unit or an extension lead. These do not guarantee the required safety of the appliance (e.g. danger of overheating).

► If moisture gets into electrical components, it could cause a short circuit. Therefore, do not operate this appliance in areas which are exposed to moisture.

► This appliance must not be installed and operated in mobile installations (e.g. on a ship).

## Warning and Safety instructions

---

- ▶ A damaged appliance is dangerous. Check your appliance for any visible damage. Never install or attempt to use a damaged appliance.
- ▶ During installation, maintenance and repair work, the appliance must be disconnected from the mains electricity supply. It is only completely isolated from the electricity supply when:
  - the mains fuse has been disconnected, or
  - the screw-out fuse is removed (in countries where this is applicable), or
  - it is switched off at the wall socket and the plug is withdrawn from the socket, or it is switched off at the isolator.
- ▶ Repairs and other work by unqualified persons could be dangerous. Installation work and repairs to electrical appliances must only be carried out by a Miele approved service technician.
- ▶ The manufacturer's warranty will be invalidated if the appliance is not repaired by a Miele approved service technician.
- ▶ Faulty components must only be replaced by genuine Miele Original spare parts. The manufacturer can only guarantee the safety of the appliance when Miele replacement parts are used.

### Correct use

- ▶ The appliance is designed for use within a certain climate range (ambient temperatures), and should not be used outside this range. The climate range of the appliance is stated on the data plate inside the appliance. Installing the appliance in a room with too low an ambient temperature, e.g. a garage, can lead to the appliance switching off for longer periods so that it cannot maintain the required temperature.

## Warning and Safety instructions

---

► To ensure proper air flow in and out of the appliance, the air vents must not be covered or blocked in any way.

Were the air vents to be blocked, it would increase the electricity consumption and could cause damage to the appliance.

► Make sure that any oil, or foods containing oil, do not come into contact with plastic components as this could cause stress cracks.

► Do not store explosive materials in the appliance or any products containing propellants (e.g. spray cans). Flammable gases can ignite if they come into contact with electrical components. Danger of fire and explosion!

► Do not operate any electrical equipment (e.g. an electric ice-cream maker) inside the appliance. Danger of sparking and explosion!

► If storing alcohol with a high percentage proof, make sure it is tightly closed and stored upright in the refrigerator. Danger of explosion!

► Food stored for too long may present a risk of food poisoning. Storage times will depend on several factors, including the freshness and quality of the food, as well as the temperature at which it is stored. Follow the instructions given on the food manufacturer's packaging regarding storage conditions and "use by" dates.

► Use only Miele Original spare parts. If spare parts or accessories from other manufacturers are used, the warranty will be invalidated, and Miele cannot accept liability.

### **The following applies to stainless steel appliances:**

- ▶ Do not place sticky notes, adhesive tape, masking tape or any other adhesive agent on the treated surface of the door. The coating will become damaged and lose its protective properties against soiling.
- ▶ The high quality treated surface of the door is susceptible to scratching and even magnets can cause damage to the surface.

### **Cleaning and care**

- ▶ Do not use any oils or grease on the door seal, as these will cause the seal to deteriorate and become porous with time.
- ▶ Do not use a steam-cleaning appliance to clean this appliance. Pressurised steam could reach the electrical components and cause a short circuit.
- ▶ Do not use sharp edged objects to
  - remove frost and ice,
  - separate frozen foods.

They will damage the evaporator, causing irreversible damage to the appliance.

- ▶ Never place electric heaters or candles in the appliance to defrost it. These can damage the plastic parts.
- ▶ Do not use defrosting sprays or de-icers, as they might contain substances which could damage the plastic parts or which could cause a build-up of gases and pose a danger to health.

## Warning and Safety instructions

---

### Disposal of your old appliance

► Before disposing of an old appliance, first make the door lock unusable.

This way you will prevent children from accidentally locking themselves in and endangering their lives.

► Be careful not to damage any part of the pipework whilst awaiting disposal, e.g. by

- puncturing the refrigerant channels in the condenser,
- bending any pipework, or
- scratching the surface coating.

Splashes of refrigerant can harm the eyes.

# How to save energy

	Normal energy consumption	Increased energy consumption
Installation/Maintenance	In a ventilated room.	In an enclosed, unventilated room.
	Protected from direct sunlight.	In direct sunlight.
	Not situated near a heat source (radiator, oven).	Situated near a heat source (radiator, oven).
	Where the ideal ambient room temperature is approx. 20 °C.	Where the room temperature is high.
	Where the cross-section of the air inlet and outlet is not covered and kept free of dust.	Where the air inlets and outlets are covered or dusty.
	The compressor and the metal grille (heat exchanger) on the rear wall of the appliance must be dusted at least once a year.	Dust deposits on the compressor and metal grille (heat exchanger) increase energy consumption.
Temperature settings	Refrigerator section 4 to 5 °C	The lower the temperature in the appliance, the higher the energy consumption.

# How to save energy

	Normal energy consumption	Increased energy consumption
Use	Do not change the arrangement of the drawers and shelves as when delivered.	
	Only open the door when necessary and for as short a time as possible. Store food in an organised way.	Frequent opening of the door for long periods will cause a loss of coldness. The appliance will try to cool down and the running time of the compressor will increase.
	Take a cooler bag when shopping and load food in the appliance as quickly as possible on your return home. When food is taken out of the refrigerator, be sure to put it back before it becomes warm. Allow hot food and drinks to cool down before placing them in the appliance.	Warm food and food brought in from room temperature add heat to the appliance. The appliance will try to cool down and the running time of the compressor will increase.
	Store food covered or packaged.	The evaporation or condensation of liquids will cause a loss of coldness in the refrigerator.
	Place frozen food in the refrigerator to defrost.	
	Do not overfill the appliance to allow air to circulate.	



## Before using for the first time

### Protective foil

The stainless steel strips and frames have a layer of protective foil to prevent scratching during transportation. The external surfaces of stainless steel appliances are also covered with a protective foil.

- Remove the protective foil only after the appliance has been installed in its intended location.

### Cleaning and care

- Immediately after removing the protective foil, apply the Original Miele care product for stainless steel (available from Miele or at [www.miele.com.au](http://www.miele.com.au)) to stainless steel strips and frames.
- Also apply the Original Miele care product for stainless steel to the side panels after removing the protective foil.

Appliance doors have a special coating that is not susceptible to soiling. Do **not** apply this product to doors.

Important! Each time the Original Miele care product for stainless steel is used, it forms a protective film against dirt and water.

- Clean the inside of the appliance and the accessories with lukewarm water and then dry with a soft cloth.

### Active charcoal filters (Active AirClean filters)

- Place the active charcoal filters supplied in the holder, and place the holder on one of the shelves inside the refrigerator (see "Active charcoal filters").

## Operating the appliance

A light touch of the finger on the sensors is all that is required to operate this appliance.

### Switching on



- Touch the On/Off sensor until the temperature display comes on.

The appliance will start to cool, and the interior lighting will come on when the door is opened.

To enable the temperature to get sufficiently cold inside the appliance, allow the appliance to run for a few hours before placing food in it.

# Switching on and off

## Switching off



- Touch the On/Off sensor until all of the indicators go out.

The interior light will not come on when you open the door and the cooling process will be switched off. (If this does not happen, the safety lock is still activated).

## Settings mode

Certain settings on the appliance can only be selected in the settings mode.

How to select the settings mode and how to change the settings is described in the relevant section of these instructions.

Overview of functions that can be selected in the settings mode:

To enter or leave the settings mode	<i>c</i>
To switch the sensor tones on/off (see "Switching on and off")	<i>b</i>
To confirm that the active charcoal filters have been changed (see "Active charcoal filters")	<i>h</i>
To switch the safety lock on/off (see "Switching on and off")	<i>u</i>
To change the brightness of the temperature display (see "The correct temperature")	<i>d</i>
To adjust the temperature in the PerfectFresh zone (see "The correct temperature")	<i>a</i>

The door alarm is automatically disabled when the appliance is in the settings mode. As soon as the door is closed, the door alarm is activated again.

## Switching the sensor tones on/off

The sensor tone which sounds each time a sensor is touched can be deactivated.



- Touch and leave your finger on the V sensor.



- At the same time, briefly touch the On/Off sensor (without letting go of the V sensor).
- Leave your finger on the V sensor for another 5 seconds until **c** appears in the display.
- Touch the V sensor repeatedly until **b** appears in the display.
- Touch the On/Off sensor again.
- By touching the V sensor, you can now select whether the sensor tones are switched on or off:
  - b 0**: Sensor tones are switched off
  - b 1**: Sensor tones are switched on
  - b -**: Return to menu.

The old setting lights up, and your newly selected setting flashes.

- Touch the On/Off sensor to confirm a new setting.
- Touch the V sensor repeatedly until **c** appears in the display.
- Touch the On/Off sensor.

You have now left the settings mode.

## Activating or de-activating the safety lock

The safety lock can be activated to prevent the appliance being switched off inadvertently.



- Touch and leave your finger on the V sensor.



- At the same time, briefly touch the On/Off sensor (without letting go of the V sensor).
- Leave your finger on the V sensor for another 5 seconds until **c** appears in the display.
- Touch the V sensor repeatedly until **u** appears in the display.
- Touch the On/Off sensor again.
- By touching the V sensor, you can now select whether the safety lock is switched on or off:
  - u 0**: The safety lock is deactivated
  - u 1**: The safety lock is activated
  - u -**: Return to menu.

The old setting lights up, and your newly selected setting flashes.

- Touch the On/Off sensor to confirm a new setting.
- Touch the V sensor repeatedly until **c** appears in the display.
- Touch the On/Off sensor.

# Switching on and off

---

You have now left the settings mode.

The safety lock indicator  will light up in the temperature display when the safety lock has been activated.

## Switching off for longer periods of time

If the appliance is not going to be used for a longer period of time, e.g. whilst on holiday:

- switch the appliance off,
- switch off at the wall and withdraw the plug from the socket, or disconnect the mains fuse or remove the screw-out fuse in countries where this is applicable,
- clean the appliance out and
- leave the door ajar to air the appliance.

If, during a long absence, the appliance is switched off but not cleaned out and the door is left shut, there is a danger of mould and odours building up inside the appliance.

# The correct temperature

It is very important to set the correct temperature for storing food in the appliance. Micro-organisms will cause food which is not stored at the correct temperature to deteriorate rapidly. Temperature influences the growth rate of these micro-organisms. Reducing the temperature reduces their growth rate.

The temperature in the appliance will rise:

- the more often the door is opened and the longer it is kept open,
- the more food that is stored in it,
- the warmer the food is which is being put into it,
- the higher the ambient temperature surrounding the appliance.

The appliance is designed for use in specific ambient temperatures (climate ranges). Do not use in ambient temperatures for which it is not designed.

## ... in the refrigerator and the PerfectFresh zone

We recommend a temperature of **4 °C** in the middle of the refrigerator.

The temperature in the PerfectFresh zone is controlled automatically, and is maintained at **0 to 3 °C**.

## DynamicCooling

The DynamicCooling fan automatically switches on when the cooling system for the refrigerator switches on. It distributes the temperature in the appliance to all areas evenly so that all the food will be chilled to about the same degree.

## Setting the temperature

The temperature inside the appliance can be selected by touching the arrow sensors on either side of the temperature display.

By touching the



∇ sensor: the temperature will get colder

∧ sensor: the temperature will get warmer.

The temperature being set will flash in the display.

When touching the sensors, the following information shows in the display:

- When first touched, the **last temperature selected** flashes.
- Each subsequent touch of a sensor, adjusts the temperature shown in 1 °C steps.

## The correct temperature

- Leaving a finger on the sensor, adjusts the temperature continuously.  
When the highest or lowest temperature in the range is reached, the V or ∧ sensor disappears.

Approx. 5 seconds after taking your finger off the sensor, the **average, current** temperature inside the appliance is automatically shown.

If you have adjusted the temperature, **wait for approx. 6 hours if the appliance is not very full and for approx. 24 hours if the appliance is full** before checking the temperature display, as it will take this long for the display to give an accurate reading. If, after this time, the temperature is still too high or too low, you will need to adjust it again.

### Temperature range

The temperature can be adjusted from 3 °C to 9 °C.

The ambient temperature in the room and the installation location can affect the time it takes for the appliance to reach the lowest temperature. If the ambient temperature is too high, the appliance may not reach the lowest temperature.

### Setting the temperature in the PerfectFresh zone

The temperature in the PerfectFresh zone is automatically held at 0 to 3 °C. It can be raised or lowered, e.g. if you want to use it for storing items like fish.



- Touch and leave your finger on the V sensor.



- At the same time, briefly touch the On/Off sensor (without letting go of the V sensor).
  - Leave your finger on the V sensor for another 5 seconds until **ε** appears in the display.
  - Touch the V sensor repeatedly until **α** appears in the display.
  - Touch the On/Off sensor.
  - You can now adjust the temperature in the PerfectFresh zone by touching the V sensor. You can choose from settings **1** to **9**:
    - α **1**: Lowest temperature,
    - α **9**: Highest temperature.
    - α **–**: Return to menu.
- The old setting lights up, and your newly selected setting flashes.
- Touch the On/Off sensor to confirm a new setting.
  - Touch the V sensor repeatedly until **ε** appears in the display.
  - Touch the On/Off sensor.

You have now left the settings mode.

▫ 5 is the default setting for the PerfectFresh zone. If a setting of ▫ 1 to ▫ 4 is selected, the temperature can fall below 0°C. Food could freeze!

### Temperature display

During normal operation, the temperature display on the control panel shows the average temperature in the refrigerator.

The **temperature display will flash** if

- the temperature is not within the possible temperature range (0 °C to 19 °C),
- a different temperature is being set.

### Changing the temperature display brightness

The temperature display brightness can be adjusted to suit the lighting conditions of the room.



- Touch and leave your finger on the V sensor.



- At the same time, briefly touch the On/Off sensor (without letting go of the V sensor).

- Leave your finger on the V sensor for another 5 seconds until **▫** appears in the display.
- Touch the V sensor repeatedly until **▫** appears in the display.
- Touch the On/Off sensor again.
- The temperature display brightness can now be changed by touching the V sensor:
  - 0**: Maximum brightness
  - 1**: Reduced brightness
  - -**: Return to menu.

The old setting lights up, and your newly selected setting flashes.

- Touch the On/Off sensor to confirm a new setting.
- Touch the V sensor repeatedly until **▫** appears in the display.
- Touch the On/Off sensor.

You have now left the settings mode.

# Alarm

---

Your appliance has been fitted with an alarm to avoid energy being wasted if the door is left open and to prevent stored food becoming too warm.

The alarm will sound if the door is left open for more than approx. 2 minutes.

The Alarm off sensor will light up red and the "Cooling" symbol will flash.

The alarm will stop and the indicators will go out as soon as the door is closed.

## To switch off the door alarm whilst the door is still open

If you want to keep the door open intentionally for more than approx. 2 minutes, you can switch the alarm off.



- Touch the Alarm off sensor.  
The alarm will stop.  
The Alarm off sensor will light up constantly and the "Cooling" symbol will continue to flash until the door has been closed.

## To switch on the door alarm

The alarm system switches back on automatically as soon as the door is closed. It does not have to be switched on manually.



## The SuperCool function

The SuperCool function can be used to rapidly reduce the temperature in the refrigerator to its lowest setting (depending on the room temperature).

### Switching on SuperCool

SuperCool is particularly recommended for the faster chilling of large amounts of fresh food or drink.



- Touch the SuperCool sensor. It will light up yellow.

The appliance will then work at full power to lower the temperature.

### Switching off SuperCool

The SuperCool function will switch itself off automatically after approx. 6 hours. The appliance will then continue to work at normal power.

To save energy, the SuperCool function can be switched off once food and drinks are sufficiently chilled.

- Touch the SuperCool sensor so that the yellow indicator is dimmed.

The appliance will continue running at normal power.

# Using the refrigerator efficiently

---

## Different storage zones

Due to the natural circulation of the air in the appliance, there are different temperature zones in the refrigerator. Cold, heavy air sinks to the lowest section of the appliance. Make use of the different zones when placing food in the appliance.

This appliance has DynamicCooling, which helps to keep an even temperature when the fan is running. When DynamicCooling is switched on, the difference between the various zones is less pronounced.

### Warmest area

The warmest area is in the top section of the door. Use this area for storing butter and cheese.

### Coldest area

The coldest area in the refrigerator is directly above the PerfectFresh zone. However, the PerfectFresh zone is even colder.

Use these areas in the refrigerator and in the PerfectFresh zone for all delicate and highly perishable food, e.g.

- fish, meat, poultry,
- sausage products, ready meals,
- dishes or baked goods containing eggs or cream,
- fresh dough, cake mixtures, pizza or quiche dough,
- soft cheese and other dairy products,

- pre-packed vegetables and other fresh food with a label stating it should be kept at a temperature of approx. 4 °C.

Do not store explosive materials in the appliance or any products containing propellants (e.g. spray cans).

Danger of explosion!

If storing alcohol with a high percentage proof, make sure it is tightly closed, and stored upright.

Do not store cooking oil in the refrigerator door. Traces of oil can cause stress cracks to occur in the plastic components in the door.

Food must not touch the back wall of the refrigerator, as it may freeze to the back wall.

To allow air to circulate efficiently, do not pack food too closely together in the refrigerator. Do not cover the fan in the rear wall of the refrigerator, as this is essential for keeping the appliance cool.

## Food which should not be stored in a refrigerator

Not all food is suitable for refrigeration at temperatures below 5 °C. Cucumbers, for example, become glassy, eggplants bitter and potatoes sweet. Tomatoes and oranges lose their aroma, and the peel on citrus fruits hardens.

Foods which are sensitive to cold include:

- Pineapples, avocados, bananas, pomegranates, mangoes, melons, papayas, passionfruit, citrus fruits such as lemons, oranges, mandarines, grapefruits
- Fruit which is not yet ripe
- Eggplants, cucumbers, potatoes, capiscum, tomatoes, zucchini
- Some hard cheeses, e.g. Parmesan

## When shopping for food

The freshness of food when first placed in the appliance is the most important factor in determining how long it stays fresh, and how long it can be kept in the appliance. Time out of the refrigerator, e.g. during transportation, should be kept to a minimum. For example, do not allow food to stay in a hot car for too long. Once food has started to deteriorate, this process cannot be reversed. As little as two hours outside the refrigerator can cause food to start deteriorating.

## Storing food correctly

Food should generally be stored covered or packaged in the refrigerator section (there are some exceptions to this rule in the PerfectFresh zone - see below). This will prevent food smells from affecting other foods, food from drying out, and also any cross-contamination of bacteria. The growth of bacteria, such as salmonella, can be avoided by setting the correct temperature and maintaining good standards of hygiene.

## Unpackaged meat and vegetables

Unpackaged meat and vegetables should be stored separately. To avoid any microbiological cross-contamination, these foods may only be stored together if they are wrapped.

# Using the PerfectFresh zone

---

Food is stored in the PerfectFresh zone at lower temperature than in the conventional refrigerator section. The humidity in the PerfectFresh zone can be regulated to provide the correct conditions for food stored inside it.

Due to the optimum storage conditions created within the PerfectFresh zone, food remains fresh for longer, and flavour and vitamins are retained.

## Storage temperature

The optimum storage temperature for fresh food which is not sensitive to the cold is 0 - 3 °C. This is the temperature range which is automatically maintained in the PerfectFresh zone. Food can be stored the PerfectFresh zone at this temperature without loss of freshness for considerably longer than in a standard refrigerator, as the deterioration process is decelerated at this temperature.

Remember that the initial freshness of the food when placed in the refrigerator/PerfectFresh zone is crucial for good storage results.

## Humidity level

The humidity level in the PerfectFresh zone depends on:

- moisture content of the stored food, and
- the quantity of food being stored.

The regulator can be used to adjust the humidity level in the PerfectFresh zone.

The closer the storage humidity is to the moisture content of the food, the crisper and fresher the food remains over a longer period, as the water content of the food is largely retained.

## Storing food in the PerfectFresh zone compartments

The PerfectFresh zone is divided into two areas, the dry compartment and the humidity-controlled compartment.

### The dry compartment

The dry compartment has a relatively low humidity level that is approximately the same as that in the refrigerator. Therefore, the main advantage of the dry compartment is the low temperature, rather than the humidity.

- The dry compartment is ideal for storing particularly sensitive foods, such as fresh fish, shellfish, meat, poultry, sausages, dairy products and salads.

Please note that foods rich in protein deteriorate faster than others. Shellfish, for example, deteriorates faster than fish, and fish deteriorates faster than meat.

Always keep these foods **covered or wrapped**.

**Exception: Meat** (The surface of the meat dries out slightly, helping to prevent the growth of bacteria, which results in the meat lasting longer. To prevent the risk of bacterial cross-contamination and meat deteriorating, do not let one type of meat come into direct contact with another type.)

### The humidity-controlled compartment

The humidity-controlled compartment has a regulator which is used to adjust the relative humidity.

Slide the regulator to the relative humidity level required:

Setting **◆◆** = high humidity. The regulator closes the openings to the compartment and the humidity within is retained. The humidity depends heavily on the type and quantity of food being stored.

Please take into account that high humidity is only achieved and effective if the food is stored **unwrapped or loosely wrapped**.

- The high humidity setting **◆◆** is ideal for storing freshly harvested products such as vegetables, salad, herbs, mushrooms and home-grown seasonal fruit.

Setting **◆** = low humidity.

The regulator opens the openings to the compartment and the air within is able to escape.

If the regulator is set to low humidity **◆**, this approximates the humidity level in the refrigerator section. The main advantage with this setting is the low temperature, rather than the humidity.

- At the low humidity setting **◆** the atmosphere inside the humidity-controlled compartment is the same as in the dry compartment.

Take food out of the PerfectFresh zone approx. 30 - 60 minutes before using it. The aroma and taste do not fully develop until the food has reached room temperature.

### Can all types of food be stored together?

Do not place all types of food together in one drawer. Some types of food do not store well together. Aromas and flavours can transfer from one type of food to another (e.g. carrots absorb the smell and flavour of onions very easily). Some food also gives off a natural gas (ethylene) which speeds up the rate at which other food perishes.

# Using the PerfectFresh zone

---

## **Examples of fruit and vegetables which produce a large amount of this natural gas are:**

Apples, apricots, pears, nectarines, peaches, plums, avocados, figs, blueberries, melons and beans.

## **Examples of fruit and vegetables which react strongly to the natural gases given off by other types of fruit and vegetables are:**

Kiwis, broccoli, cauliflower, Brussels sprouts, mangos, honeydew melons, apples, apricots, cucumbers, tomatoes, pears, nectarines and peaches.

**Example:** Broccoli should not be stored with apples, as apples produce a large amount of natural gas to which broccoli is very sensitive. The result is a shorter than expected storage time for the broccoli.

## Using the PerfectFresh zone

---

**If you are not satisfied with the results of your stored food (e.g. food loses firmness and wilts shortly after placing in the appliance), keep in mind the following instructions:**

- Only place fresh food in the appliance as the initial condition of the food is crucial to maintaining freshness.
- Clean the PerfectFresh zone before storing food in it.
- Dry the surface of very moist food before placing it in the PerfectFresh zone.
- Do not store any food in the PerfectFresh zone which is sensitive to cold (see "Food which should not be stored in a refrigerator").
- Please note that not all types of food can be stored together (see "Can all types of food be stored together?").
- Select the correct PerfectFresh compartment according to the type of food being stored (high or low humidity level).
- Store food with a high moisture content unwrapped in the PerfectFresh zone. A high humidity level will be achieved by means of the moisture already contained with the food being stored.  
If the humidity level is not high enough (e.g. too little food is being stored), it can be increased by placing a damp sponge in the drawer.
- If you think that the temperature in the PerfectFresh zone is not correct, trying adjusting it slightly by 1 to 2 °C via the refrigerator section temperature control. To avoid frost damage to food, a higher temperature must be set if ice crystals begin to form on the bottom of the PerfectFresh zone.
- If too much water collects at the bottom of the PerfectFresh zone, dry it with a cloth. If necessary, dry food before placing it in the appliance or place a rack at the bottom of the PerfectFresh zone to allow water to drain off.

# Adjusting the interior fittings

---

## Moving the shelves

The shelves can be adjusted according to the height of the food.

- Raise the shelf, and pull it forwards slightly until the notch at the side is in line with the shelf support. It can then be raised or lowered to the required level.

The raised edge at the back must face upwards to prevent food from touching the back of the appliance and freezing to it.

Stoppers prevent the shelves from being dislodged by mistake.

## Split shelf

In order to accommodate tall items in the appliance, one of the shelves is divided. The front section can be pushed under the rear section.

- Pull the front half of the glass shelf forwards slightly and then push it carefully under the rear half.

To move the split shelf:

- Take both halves of the split glass shelf out,

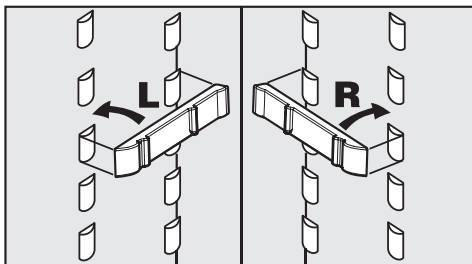

- fit the two brackets onto the supports on either side at the required height,
- and push the glass shelves in one after the other. The shelf with the raised edge must be at the back.



## Adjusting the interior fittings

### PerfectFresh zone compartments

The compartments in the PerfectFresh zone are on telescopic rails, and can be removed for filling, emptying or cleaning purposes.

- Pull out the compartment as far as it will go, and then lift it up and out.

Push the runners back in again to avoid injury or damage.

- Carefully pull out the lid between the compartments slightly, and lift it down and out.
- To replace it, insert the compartment lid from beneath into the holders, and push it back into place.

To replace the compartment,

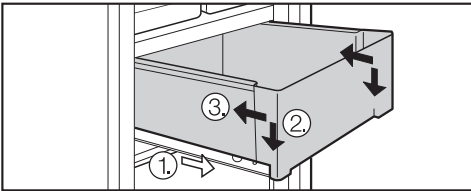

- place it back on the fully extended runners ①. The front of the runners must be right up against the front of the compartment ②.
- Then push the compartment back in ③.

### Adjusting the condiment tray/bottle shelf

- Lift the tray/shelf up and out of the stainless steel frame to remove.
- Push up the stainless steel frame, and remove.
- Replace the frame at the required height. Ensure that it is securely pushed back into position.

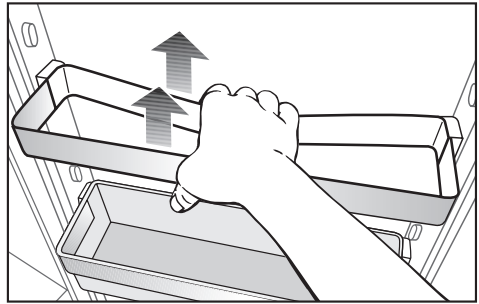

- Some stainless steel frames can be removed and refitted more easily if they are held together with the rear plastic frame and lifted up and out (see picture).
- Replace the tray/shelf in the frame.

The tray/shelf can be removed completely and used as a serving tray at the table.

# Adjusting the interior fittings

---

## Universal container

(depending on model)

The universal container can be used both to store and serve food.

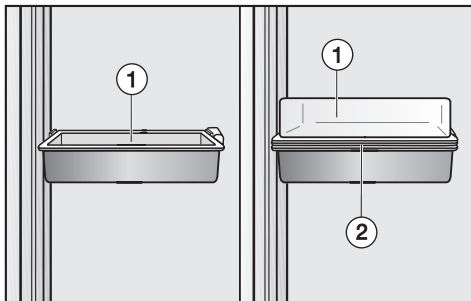

It consists of a deep tray ① and a shallow tray ②. Both trays fit the stainless steel frame.

If you wish to use the universal container to serve food,

- place the shallow tray ② in the stainless steel frame, and use the deep tray as a lid ①.

You can lift the universal container, including contents, out of the frame and take it to the table.

## Moving the bottle divider

The bottle divider can be moved to the left or right to ensure that bottles are held securely in position when the door is opened and shut.

The bottle divider can be removed completely (e.g. for cleaning).

- To do this, push up the front edge of the bottle divider, and disengage it.

### **Refrigerator section and PerfectFresh zone**

The refrigerator section and the PerfectFresh zone defrost automatically.

Condensate and frost can build up on the back wall of the refrigerator section and the PerfectFresh zone whilst in use. You do not need to remove this, as it will defrost and evaporate automatically with the warmth generated by the appliance.

The condensate is drained away via a channel and drain hole into an evaporation system at the back of the appliance.

Ensure that the condensate channel and drain hole are kept clean and are never blocked so that condensate can flow away without hindrance.

# Cleaning and care

---

Make sure that water cannot get into the electronic unit or into the lighting.

Do not let water get into the drainage channel and drain hole when cleaning.

Do not use a steam cleaning apparatus to clean the appliance. Steam could reach the electrical components and cause a short circuit.

The data plate located inside the appliance must not be removed. It contains information which is required in the event of a service call.

The stainless steel doors have a special coating that is not susceptible to soiling. Do **not** apply the Original Miele care product for stainless steel to the doors as visible smearing will occur. The Original Miele care product for stainless steel can, however, be used on other stainless steel surfaces on the appliance (available from Miele or at [www.miele-shop.com](http://www.miele-shop.com)). This product contains substances that are gentle to stainless steel surfaces and, unlike stainless steel cleaners, it does not contain polishing agents. Soiling is gently removed and each time the Original Miele care product for stainless steel is used, it forms a protective film against dirt and water.

## To avoid damaging the outer surfaces of your appliance, do not use:

- cleaning agents containing soda, ammonia, acids or chlorides,
- cleaning agents containing descaling agents,
- abrasive cleaning agents, e.g. powder cleaners and cream cleaners,
- solvent-based cleaning agents,
- stainless steel cleaners,
- dishwasher cleaner,
- oven sprays,
- glass cleaning agents,
- hard, abrasive sponges and brushes, e.g. pot scourers,
- dirt erasers,
- sharp metal scrapers.

## Before cleaning

- Switch off the appliance.
- Disconnect the appliance from the mains. Switch off at the wall and withdraw the plug from the socket, or disconnect the mains fuse or remove the screw-out fuse in countries where this is applicable.
- Take any food out of the appliance and store it in a cool place.
- The serving trays and containers in the door can be removed from their stainless steel frames for cleaning.

To remove the stainless steel panel from the lid of the butter and cheese compartment, proceed as follows:

- Take out the entire butter and cheese compartment.
- Open the lid.

The stainless steel panel is fitted tightly to the plastic lid and needs to be removed firmly.

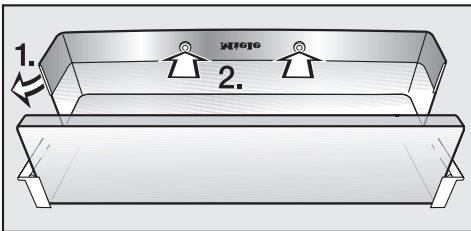

- Disconnect the stainless steel panel from the edge of one side of the lid (1.) first.
- Push the white plastic locating pins out of the holes (2.).
- Remove the PerfectFresh drawers, the drawer lid and the dividing plate.

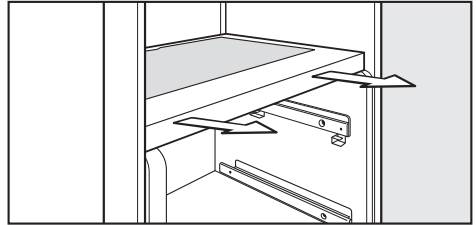

- Take hold of the dividing plate with both hands and slide it out.
- Take out any other removable parts, e.g. shelves, for cleaning.

### Cleaning the interior and accessories

- Clean the appliance at least once a month.

Clean any soiling immediately. Do not allow it to dry first.

Use lukewarm water with a little washing-up liquid.

The following components are all dishwasher safe:

- butter dish, egg tray (available depending on model)
- serving trays and containers in the door (without stainless steel frame)
- butter and cheese compartment (without stainless steel panel)

The stainless steel frames and panel in the door are **not** dishwasher safe.

## Cleaning and care

The temperature of the dishwasher programme must not exceed 55 °C. Plastic components may discolour in the dishwasher if they come into contact with natural dyes from foods such as carrots, tomatoes and tomato sauce.

This discolouration will not affect the stability of the components.

- Clean shelves, drawers, drawer lid and dividing plate by hand. These parts are **not** dishwasher safe.
- Clean the condensate channel and drain hole frequently, so that condensate can drain away unhindered. Use a straw or similar to clear the drain if necessary.
- After cleaning, wipe the outer casing, interior and accessories with a damp cloth and dry with a soft cloth. Leave the door open to air the appliance for a short while.
- Remove any soiling from stainless steel panels or frames with the Original Miele care product for stainless steel.
- Apply the Original Miele care product for stainless steel each time you clean the appliance. This will help to protect stainless steel surfaces and prevent resoiling for a period of time.

### Cleaning the door and side panels

Remove any soiling immediately. If not, it might become impossible to remove and could cause the surface to alter or discolour.

The surfaces of this appliance are all susceptible to scratching. Contact with unsuitable cleaning agents can also alter or discolour the surfaces.

- Clean surfaces using a damp microfibre cloth or with a solution of warm water and a little washing-up liquid applied with a soft sponge.
- After cleaning, wipe the surfaces with a damp cloth and dry with a soft cloth.

### The following also applies to stainless steel appliances:

#### – Appliance door

The appliance door is treated with a high quality surface coating. It protects against soiling and facilitates cleaning and care.

Do **not** use the following on the appliance doors:

- Stainless steel cleaners: The coating will be damaged.
- Miele Original care product for stainless steel: Visible smearing will form on the door.

## – Side panels

- Remove any soiling with the Original Miele care product for stainless steel.
- Apply the Original Miele care product for stainless steel to the side panels **each time after cleaning**.

This product contains substances that are gentle to stainless steel surfaces and, unlike stainless steel cleaners, it does not contain polishing agents. Each time this product is used it forms a protective film against dirt and water. The stainless steel surface will be protected against resoiling for a period of time.

## Ventilation gaps

- The ventilation gaps should be cleaned regularly with a brush or vacuum cleaner. A build-up of dust will increase the energy consumption of the appliance.

## Door seal

Do not use any oils or grease on the door seals as these will cause the seal to deteriorate and become porous over time.

- The door seal should be cleaned regularly with clean water, and then wiped dry with a soft cloth.

## Rear of appliance - metal grille

The metal grille at the back of the appliance (heat exchanger) should be dusted at least once a year. A build-up of dust will increase the energy consumption of the appliance.

When cleaning the grille, make sure that the pipework and other components do not get broken or damaged in any way.

## After cleaning

- Push the dividing plate back in until it clicks into place.
- Replace all shelves and accessories back in the appliance.
- Reconnect the appliance to the electricity supply and switch it on.
- Switch on the SuperCool function for a short time so that the appliance can cool down quickly.
- Place the food back in the appliance and close the door.

## Active charcoal filters

The active charcoal filters should be changed approx. every 6 months.



When the Change active charcoal filter indicator lights up red, the active charcoal filters need to be changed.

### To change the active charcoal filters

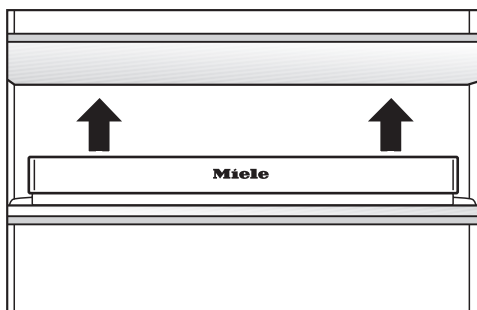

- Pull the active charcoal filter holder upwards to remove it from the shelf.

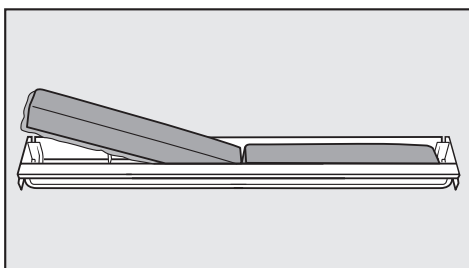

- Take out the two filters and fit the new filters into the holder with the protruding cloth edge facing downwards.
- Place the holder in the middle of the raised edge at the back of the shelf, so that it clicks into position.

To confirm the filters have been changed



- Touch the Change active charcoal filter indicator for approx. 2 seconds.

The indicator light will go out, and the counter will be reset.

### To delay changing the active charcoal filters

If you do not have new active charcoal filters, you can order them from your Miele Chartered Agent or from the Miele Spare Parts Department.

You can switch off the Change active charcoal filter indicator early if you would prefer not to have the red indicator showing.



- Touch the Change active charcoal filter indicator for approx. 2 seconds.

The Change active charcoal filter indicator will go out.



If you have delayed changing the active charcoal filters and the indicator is not lit up, you will need to reset the counter when you replace the active charcoal filters via the settings mode.



- Touch and leave your finger on the V sensor.



- At the same time, briefly touch the On/Off sensor (without letting go of the V sensor).
- Leave your finger on the V sensor for another 5 seconds until **c** appears in the display.
- Touch the V sensor repeatedly until **h** appears in the display.
- Touch the On/Off sensor.
- Touch the V sensor repeatedly until **h 2** appears in the display.
- Touch the On/Off sensor for approx. 2 seconds to confirm.

The counter is now reset.

- Touch the V sensor repeatedly until **c** appears in the display.
- Touch the On/Off sensor.

You have now left the settings mode.

### Useful tip:

When you are storing foods with a strong smell (such as ripe cheeses),

- place the holder containing the active charcoal filters on the shelf where the food is going to be stored,
- change the active charcoal filters early if required (remembering to reset the counter),
- and place more active charcoal filters (in holders) in the appliance.

Active charcoal filters and holders can be obtained from your Miele Chartered Agent or from the Miele Spare Parts Department.

# Problem solving guide

---

Repair work to electrical appliances must only be carried out by a suitably qualified and competent person in strict accordance with current local and national safety regulations. Repairs and other work by unqualified persons could be dangerous. The manufacturer cannot be held liable for unauthorised work.

## What to do if . . .

### . . . the appliance does not get cold.

- Check whether the appliance has been switched on. The temperature display must be lit up.
- Check that the plug is correctly inserted into the socket and switched on.
- Check whether the mains fuse has tripped or whether the fridge, mains voltage or another appliance is faulty.

If this is the case, contact a qualified electrician or Miele.

### . . . the appliance does not get cool but the temperature display lights up.

Demonstration mode is activated. This enables the appliance to be displayed without using the cooling system. Do **not** activate this setting for domestic use.

- Deactivate the demonstration mode (see "Information for Chartered Agents - Demonstration mode").

### . . . the temperature in the refrigerator is too low.

- Select a warmer temperature.
- The SuperCool function is switched on. It switches off automatically after 6 hours.

### . . . the alarm sounds.

Has the appliance door been open for longer than two minutes?

- Close the appliance door.

### . . . the compressor is switching on too frequently and for too long.

- Check whether the ventilation gaps have been covered over or become dusty.
- Check whether the metal grille (heat exchanger) at the back of the appliance has become too dusty.
- The door has been opened too frequently, or a large amount of food has been put in at once.
- Check that the door closes properly.

### . . . the compressor runs continuously.

To save energy, the compressor runs at a lower speed when less cooling is required. In this case, the compressor runs for longer.

## ... the interior lighting is not working.

- Has the appliance door been left open for too long? To avoid overheating, the lighting switches itself off automatically after approx. 15 minutes if the door is left open.

If this is not the case, then the interior lighting is defective.

- Call Miele.

The LED lighting may only be repaired or changed by a Miele service technician because there are live parts under the cover. Danger of injury and damage!

The cover must not be removed. Should the cover be damaged or removed due to damage, **exercise caution**. Never look at the lighting with optical instruments (magnifying glass or similar).

## ... the Change active charcoal filter indicator is red.

- Replace the active charcoal filters.

You can order replacement filters via your Miele Chartered Agent or from Miele.

## ... "F" appears in the temperature display.

There is a fault. Call Miele.

## ... "dn" appears in the temperature display.

The demonstration mode is activated.

- Call Miele.

## ... you cannot switch the appliance off.

The safety lock has been activated.

## ... the floor of the refrigerator is wet.

The condensate drain hole is blocked.

- Clean the condensate channel and drain hole.

If you still cannot remedy the fault, having followed these suggestions, please contact Miele. However, a call-out charge will be applied for unnecessary service visits where the problem could have been rectified as described in these operating instructions.

To prevent unnecessary loss of temperature, it is advisable not to open the door while waiting for the appliance to be serviced.

# Noises

Normal noises	What causes them
Brrrrr ...	Humming noise made by the motor (compressor). This noise can get louder for brief periods when the motor is switching on.
Blubb, blubb....	A gurgling noise can be heard when coolant is circulating through the pipes.
Click ...	Clicking sounds are made when the thermostat switches the motor on and off.
Sssrrrr ...	On multi-zone and frost-free appliances you can sometimes just hear the movement of the fan inside the appliance.
Crack ...	A cracking sound can be heard when materials expand inside the appliance.

Remember that the noise of the compressor and the coolant circulating in the system is unavoidable.

Noises that you can easily rectify	What causes them, and what can you do about them?
Rattling, vibrating	<b>The appliance is uneven:</b> Realign the appliance using a spirit level, by raising or lowering the screw feet underneath the appliance.
	<b>The appliance is touching another appliance or piece of furniture:</b> Move it away.
	<b>Drawers, baskets or shelves are unstable or sticking:</b> Check all removable items and refit them correctly.
	<b>Are any bottles or containers unstable or knocking against each other?</b> Separate them.
	<b>The transport cable clips are hanging loose at the back of the appliance:</b> Remove the clips.

In the event of a fault which you cannot correct yourself, please contact:

- Miele.

You will find the address and telephone number of Miele on the back cover of the manual.

When contacting Miele, please quote the model and serial number of your appliance. This information is given on the data plate inside your appliance.

# Information for Chartered Agents

---

## Demonstration mode

The appliance can be displayed in the demonstration mode. When this is activated, the controls and lighting are functional but the cooling system remains switched off.

### Activating and deactivating the demonstration mode





- Switch on the appliance.

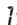

- Touch and leave your finger on the V sensor.

At the same time, briefly touch the On/Off sensor (without letting go of the V sensor).

- Touch the V sensor four times and then leave your finger on the sensor at the fifth touch until *P* appears in the display.
- Touch the V sensor repeatedly until *n* appears in the display.
- Touch the On/Off sensor.
- By touching the V sensor, you can now select whether the demonstration mode is switched on or off:
  - n* : Demonstration mode is deactivated
  - n* : Demonstration mode is activated
  - n* : Return to menu

The old setting lights up, and your newly selected setting flashes.

- Touch the On/Off sensor to confirm the new setting.
- Touch the V sensor repeatedly until *P* appears in the display.
- Touch the On/Off sensor.

You have now left settings mode.

The demonstration mode is activated/deactivated.

All electrical work should be carried out by a suitably qualified and competent person in strict accordance with current local and national safety regulations.

The appliance is supplied with a mains cable and moulded plug ready for connection to an AC single phase 220 – 240 V 50 Hz supply.

The fuse rating must be at least 10 A.

The voltage and frequency are given on the data plate. Please ensure that these match the household mains supply. Connection should be made via a suitable switched socket which is easily accessible. For extra safety it is advisable to install a suitable residual current device (RCD).

The accessibility of the plug must always be ensured in order to be able to quickly separate the appliance from the mains.

If the mains socket is not accessible after the appliance has been built in, a separator for each terminal must be available. There must be an all-pole contact gap of 3 mm in the switch.

The plug and mains connection cable must not come into contact with the back of the appliance as vibrations can cause damage to these components. This, in turn, could result in a short circuit.

Nor should other appliances be plugged into a socket located directly behind the wine conditioning unit.

Do not connect the appliance to the mains electricity supply by an extension lead or a plug adapter. Extension leads do not guarantee the required safety of the appliance (e.g. danger of overheating).

Do not connect the appliance to an inverter such as those used with an autonomous energy source e.g. **Solar power**.

When switched on, peak loads in the system can cause the safety switch off mechanism to be triggered. This can damage the electronic unit.

The machine must not be used with so-called **energy-saving devices** either. These reduce the amount of energy supplied to the machine, causing it to overheat.

If the mains connection cable is damaged, it must be replaced by the manufacturer, its service agent or similarly qualified persons in order to avoid a hazard.

**WARNING**  
**THIS APPLIANCE MUST BE**  
**EARTHED**

# Installation

---

Do not operate any appliance which gives off heat on top of the refrigerator, e.g. toaster, microwave oven. Risk of fire!

## Side-by-side installation

To avoid a build-up of condensation and resultant damage, refrigerators and freezers should not generally be installed side by side next to other such appliances.

However, some appliances have side-wall heating making them suitable for side-by-side installation with this refrigerator.

Miele or your Chartered Agent will be able to advise you on which models are suitable to being installed side-by-side

- Follow the instructions for the other appliance on how to install the two appliances side by side.

## Location

This appliance should be installed in a dry, well-ventilated room. It should not be installed where it is exposed to direct sunlight or directly adjacent to a heat-producing appliance such as an oven or a radiator. The room temperature should not go above or below the climate range for which the appliance is designed. The higher the ambient temperature of the room, the more energy the appliance requires to operate.

Please note the following when installing the appliance:

- The mains connection socket must not be located directly behind the appliance and must be easily accessible.
- The plug and mains connection cable must not come into contact with the rear of the appliance as they may be damaged by vibrations from the appliance.
- Nor should other appliances be plugged into a socket located directly behind the wine conditioning unit.

**Important!** In areas of high humidity, condensate can build up on the external surfaces of the appliance. This condensation can cause corrosion on the outer walls of the appliance.

To prevent this happening, it is recommended that the appliance is installed in a dry, well-ventilated room.

After installation, check that the appliance door closes properly, that the air inlets and outlets are not covered, and that the appliance has been installed as described in these operating and installation instructions.



## Climate range

The appliance is designed for use within certain climate ranges (ambient temperatures), and should not be used outside this range. The climate range of the appliance is stated on the data plate inside the appliance.

Climate range	Ambient room temperature
SN	+10°C to +32°C
N	+16°C to +32°C
ST	+16°C to +38°C
T	+16°C to +43°C
SN-ST	+10°C to +38°C
SN-T	+10°C to +43°C

Operating in a room which is too cold will result in the cooling system switching off for too long, causing the internal temperature in the appliance to rise with the risk of food deteriorating and going off.

## Ventilation

Air at the back of the appliance gets warm. To ensure sufficient ventilation, the ventilation gaps must not be covered over. The air inlet and outlet must not be covered or blocked in any way. They should be dusted on a regular basis.

## Appliance with supplied wall spacers

The wall spacers, which are supplied with some appliances, need to be used for the appliance to achieve its declared energy consumption. When the wall spacers are used, the appliance depth is increased by approx. 35 mm. If the wall spacers are not used, this does not impair the functioning of the appliance. However, the energy consumption of the appliance will increase slightly as a result of the narrow space between the appliance and the wall.

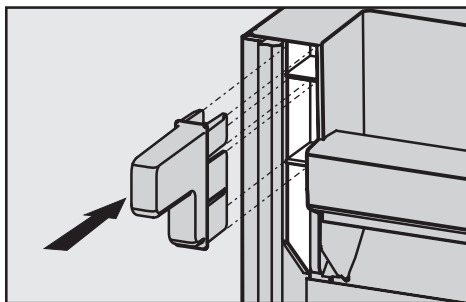

- Fit the wall spacers at the top left and right of the rear of the appliance.

# Installation

## Installation

- Remove the cable clip from the back of the appliance.
- Check that all parts at the back of the appliance are unhindered. Carefully remove any hindrance.
- Carefully push the appliance into position.
- Push the appliance so that the wall spacers (if fitted), or the rear of the appliance, are directly against the wall.

## Aligning the appliance

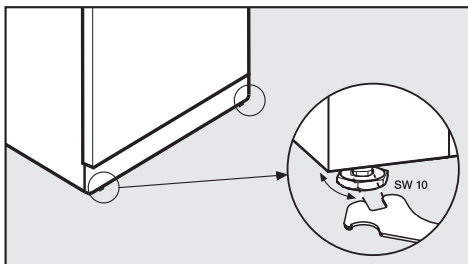

- To align the appliance, adjust the front feet using the spanner supplied.

## On stainless steel appliances

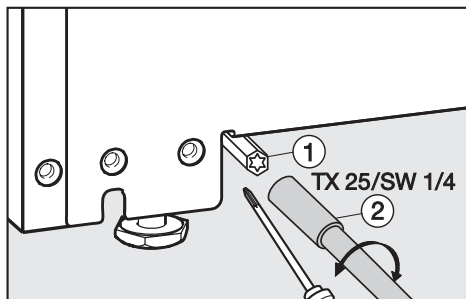

- If necessary, also align the two rear adjusting devices ① using socket wrench ②. Turn the adjusting device clockwise to raise the appliance up at the back.

## Supporting the appliance door

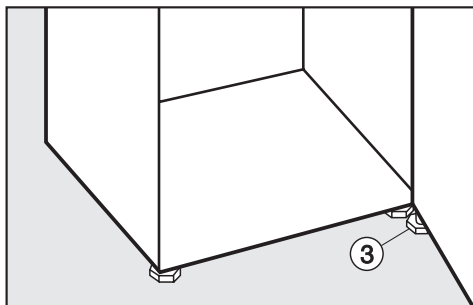

- The foot ③ should **definitely** be unscrewed until it rests on the floor. Then turn it a further 90°.

## Appliance dimensions

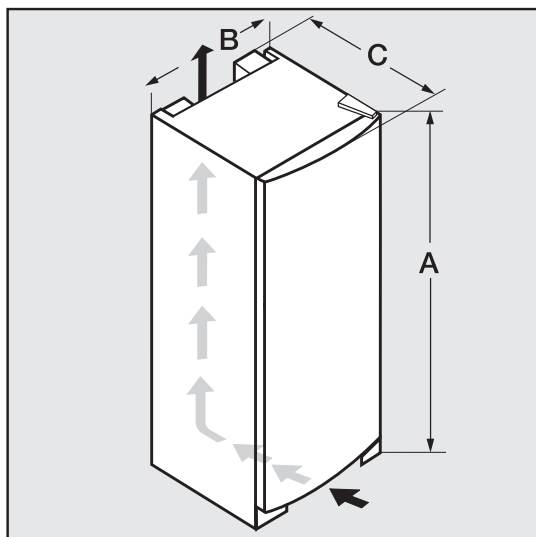

	<b>A</b>	<b>B</b>	<b>C</b>
<b>K 14827 SD</b>	1850 mm	600 mm	630 mm*
<b>K 14827 SD ed/cs (-1)</b>			

\* Depth without wall spacers fitted. If wall spacers are fitted, the appliance depth is increased by approx. 35 mm.

# Changing the door hinging

The appliance is supplied with right-hand door hinging. If left-hand door hinging is required, the hinging must be changed.

**To change the door hinging, you will need the following tools:**

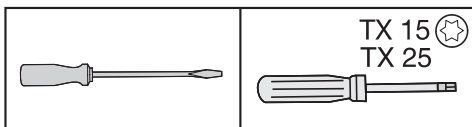

Two people are needed to change the door hinging.

## Removing the door handle

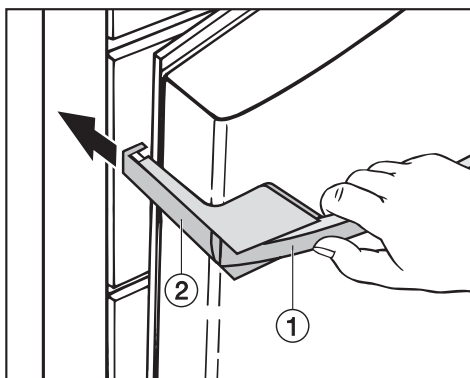

- Pull door handle ① towards you. Side section ② slides back.
- Pull side section ② firmly back out of the guides on the mounting plate (see arrow).
- Undo the 4 (TX 15) screws in the mounting plate, and remove the handle.
- Remove the cover caps from the opposite side, and fit them into the empty holes.

# Changing the door hinging

## Removing the SoftClose door mechanism

The SoftClose door mechanism is at the bottom of the door.

- Open the appliance door.

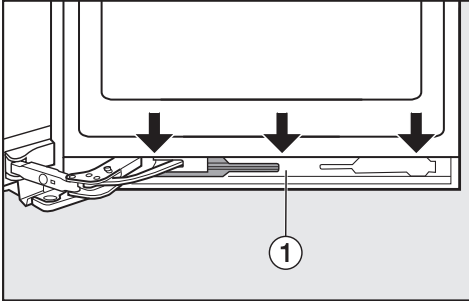

- Prise open panel ① from the SoftClose mechanism: Insert a flat-bladed screwdriver into the gap from below and ease off the panel bit by bit.

Take care not to damage the door seal.

If the door seal becomes damaged, the door will no longer close properly and cooling will be impaired.

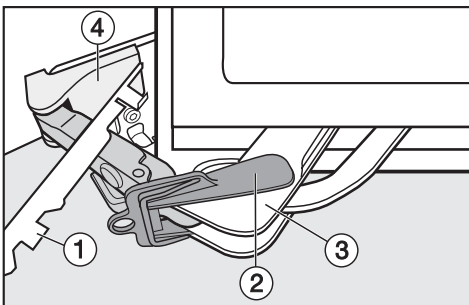

- Slide panel ① towards the appliance, and leave it hanging between the door and the appliance.

- Fit restraining clip ② (supplied with the appliance) onto SoftClose mechanism ③.

The restraining clip stops the hinge from snapping shut. Do not remove the clip until told to do so.

- Carefully remove cover ④ from the side using a flat-bladed screwdriver.
- With the help of another person, tip the appliance back slightly.

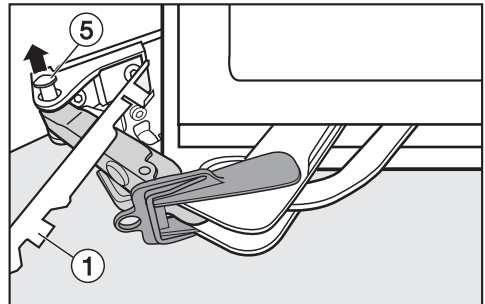

- Push hinge pin ⑤ up and out from underneath.

The SoftClose mechanism is now no longer fixed to the appliance.

- Remove panel ①.

# Changing the door hinging

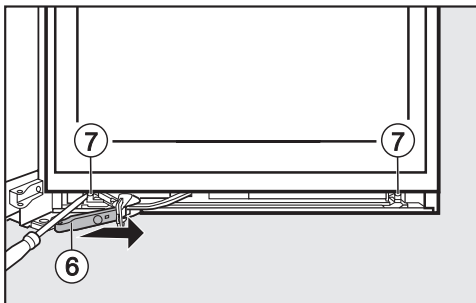

- Slide SoftClose mechanism bracket ⑥ as far as it will go towards the handle side of the door, and undo screws ⑦ on the SoftClose mechanism.
- Using a flat-bladed screwdriver, slide the SoftClose mechanism towards the handle side of the door, and lever it out at the side.
- Then place it to one side.

## Changing over the door

Remove any food from the door shelves.

- Close the appliance door.

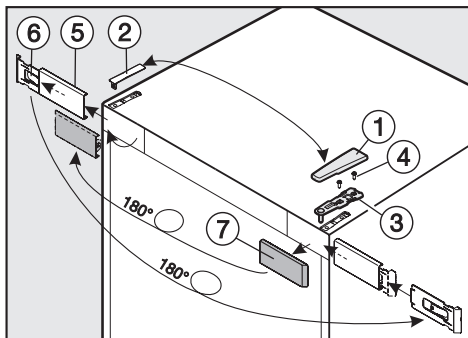

- Remove cover ① by sliding it forwards from the back and then lifting it off.
- Remove cover ② by pulling it upwards.

Caution! The appliance door is not secure once the hinge plate has been removed.

- Loosen screws ④ in upper hinge plate ③ and pull it upwards and off.
- Carefully lift the door off and place it to one side.
- Gently loosen cover ⑤ by carefully inserting a flat-bladed screwdriver into the gap.
- Remove cover ⑤ together with retaining plate ⑥.

## Changing the door hinging

- Then separate retaining plate ⑥ from cover ⑤ by pushing it slightly to the left. Then pull the cover forwards and off.
- Rotate retaining plate ⑥ by 180°.
- Then fit cover ⑤ from the front over retaining plate ⑥, and slide it over to the right. The writing must be visible.
- Remove cover ⑦, then rotate it by 180° and fit it on the opposite side.
- Then fit cover ⑤ together with retaining plate ⑥ on the opposite side.

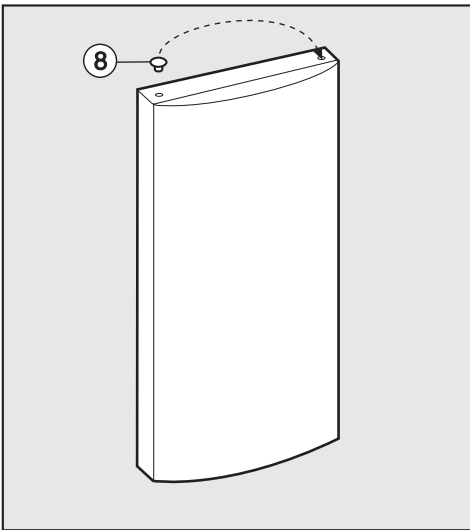

- Remove cap ⑧ from the bearing bush in the door and refit on the opposite side.

# Changing the door hinging

## Changing the bearing

**Important! The height of the appliance door can be adjusted on this stainless steel appliance. Please take note of the different conversion and fitting instructions.**

**From "Fitting the appliance door" onwards, the conversion and fitting instructions are the same for all appliances.**

### A. For appliances without height adjustment (white appliance)

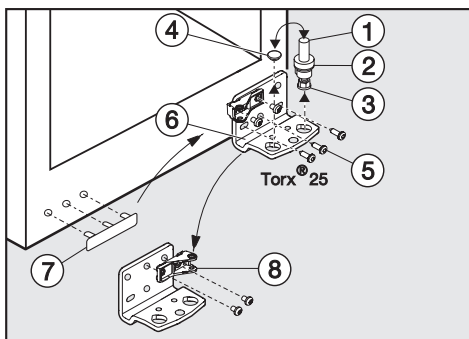

- Pull hinge pin ① with disc ② and foot ③ upwards to remove them.
- Remove cap ④.
- Undo screws ⑤ and take hinge plate ⑥ off.
- Unscrew bearing ⑧ from hinge plate ⑥, rotate it by 180° and refit into the hole on the opposite side of the hinge plate.
- Place cap ④ in the other hole.
- Remove cover ⑦ and fit it into the holes on the opposite side.

- Screw hinge plate ⑥ into position on the opposite side using the two **outer** long slots only. Do not use the **middle** screw because you will not be able to align the door over the outer long slots later on.
- Important! Screw foot ③ into hinge pin ① as far as it will go.
- Reinsert hinge pin ① with disc ② and foot ③. Important! The lug on the hinge pin must face backwards.

### B. For appliances with height adjustment (stainless steel appliance)

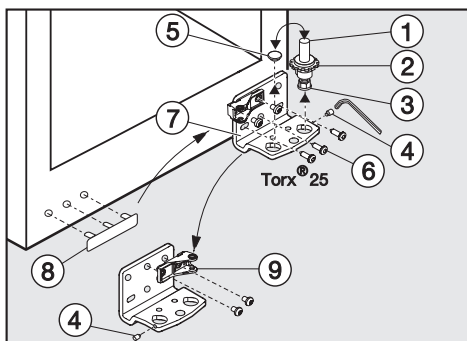

- Undo grub screw ④ with a full turn of the Allen key supplied.
- Unscrew hinge pin ① with disc ② and foot ③ and pull upwards to remove them.
- Remove cap ⑤.
- Undo screws ⑥ and take hinge plate ⑦ off.



## Changing the door hinging

- Unscrew bearing ⑨ from hinge plate ⑦, rotate it by 180° and refit into the hole on the opposite side of the hinge plate.
- Place cap ⑤ in the other hole.
- Remove grub screw ④ using the Allen key supplied.
- Fit grub screw ③ on the hinge plate on the opposite side so that it is flush with the hinge plate on the outside. The end of the grub screw must protrude from the hinge pin hole enough so that it can fit into the groove in the hinge pin (see picture).
- Remove cover ⑧ and fit it into the holes on the opposite side.
- Screw hinge plate ⑦ into position on the opposite side using the two **outer** long slots only. Do not use the **middle** screw because you will not be able to align the door over the outer long slots later on.
- Important! Screw foot ③ into hinge pin ① as far as it will go.

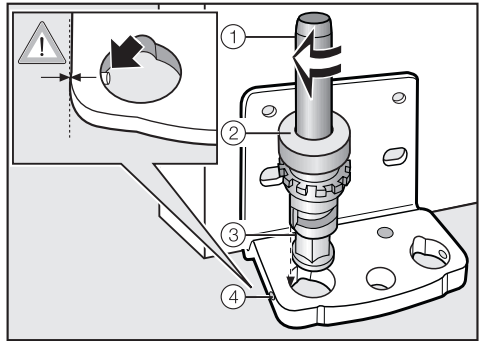

- Place the entire hinge pin ① with the disc ②, foot ③ and groove onto the end of the grub screw and screw in the hinge pin.
- Then tighten grub screw ④.

# Changing the door hinging

## Fitting the appliance door

- Place the door onto hinge pin ③.
- Close the appliance door.

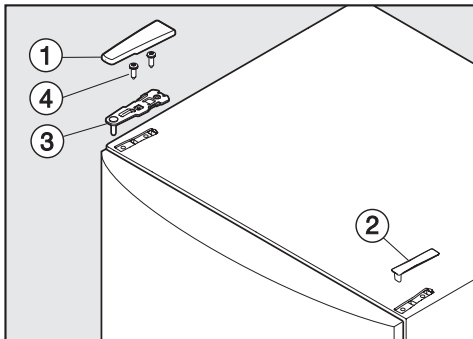

- Fit hinge plate ③ onto the opposite side and secure it with screws ④.
- Fit covers ① and ② to their opposite sides.
- Realign the door with the appliance housing using the outer long slots in the lower hinge plate. Then tighten the screws.

## Replacing the SoftClose door mechanism

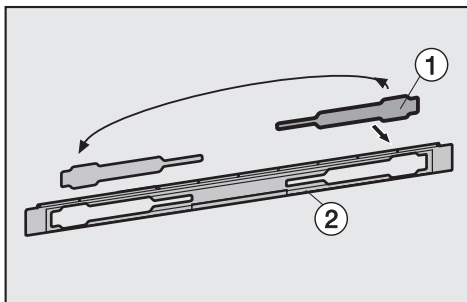

- Remove cover ① from panel ②, rotate it by 180° and refit it on the other side.

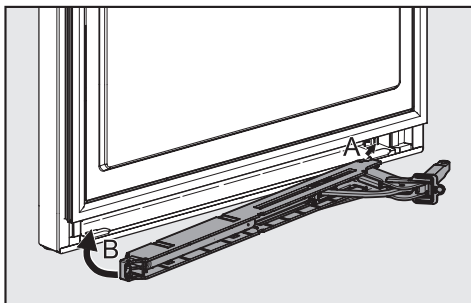

- Insert the SoftClose mechanism back into the door, starting at the right-hand side.

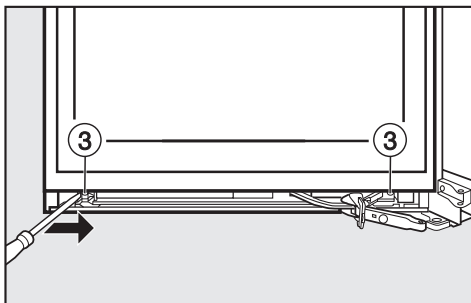

- Using a flat-bladed screwdriver, slide the SoftClose mechanism towards the appliance side of the door.

## Changing the door hinging

The screw holes on the left and right must line up perfectly.

- First screw the SoftClose mechanism onto the appliance side, then onto the handle side ③, pushing it firmly towards the appliance.

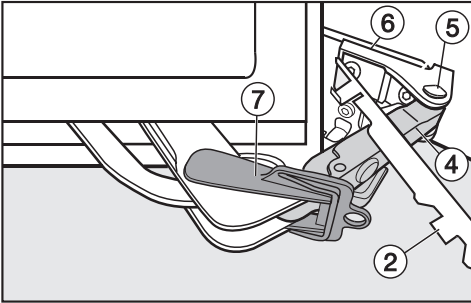

- Attach panel ② to SoftClose mechanism bracket ④.
- Align bracket ④ to the hinge plate, and insert pin ⑤ from above so that the right angle fits into the recess.
- Click cover ⑥ back into place.

Make sure that cover ⑥ fits properly so that the door can be closed without hindrance and the pin is secured.

- Remove retaining clip ⑦.

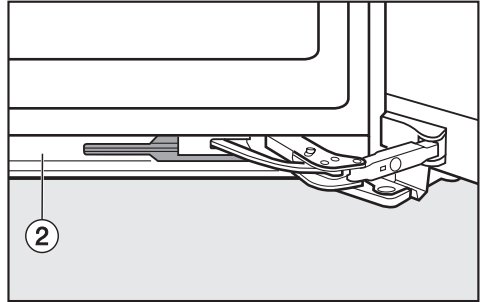

- Replace panel ② onto the SoftClose mechanism from above, clicking it back into place first at the bottom and then at the top.
- Close the appliance door.

# Changing the door hinging

## Refitting the handle

Please make sure you follow the instructions below carefully when you refit the handle. The door seal will be damaged if the handle is fitted incorrectly.

It is important to check that the side section of the handle ④ does not come into contact with the door seal when opening the door as this would damage the door seal permanently.

If, after you have refitted the handle, you find that the side section does touch the door seal when the door is opened:

- Realign mounting plate ③ with grub screws ① until the mounting plate and the side section of the handle ④ are at the correct angle and the side section does not touch the door seal when the door is opened.

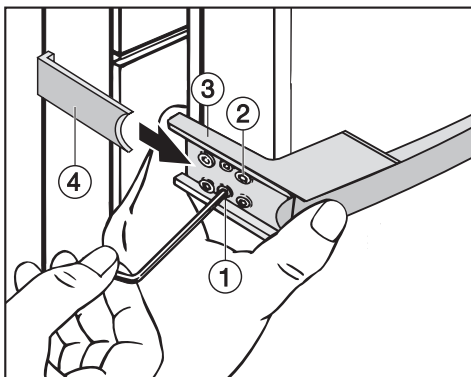

- Loosely attach the handle to the opposite side of the door with the two front screws ②.

Mounting plate ③ must be positioned on the side of the door so that when the door is **closed**, it is flush with the side of the appliance.

If this is not the case,

- tighten both grub screws ① with an Allen key until mounting plate ③ lines up correctly.
- Then tighten all 4 fixing screws ②.
- Slide the side section of the handle ④ into the guides on the mounting plate until it clicks into place.

## Aligning the appliance door

The appliance door can be retrospectively aligned to the housing using the outer long slots in the lower hinge plate.

In the following illustration the door is not shown in the closed position to make it easier to see what happens next.

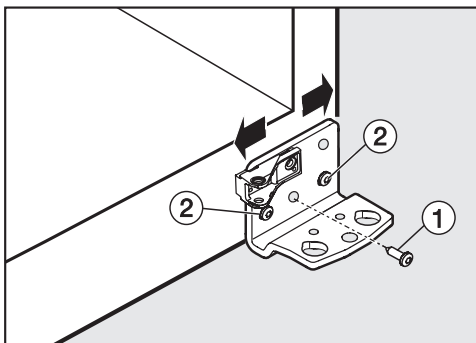

- Remove centre screw ① from the hinge plate.
- Slightly loosen both outer screws ②.
- Align the door by sliding the hinge plate to the left or right.
- Then tighten screws ② again. Screw ① does not need to be refitted.

### For appliances with height adjustable doors (stainless steel appliances)

The height of the appliance door can be retrospectively adjusted on the outer, lower hinge plate.

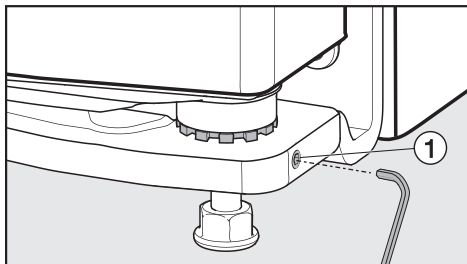

- Undo grub screw ① with a full turn of the Allen key supplied.

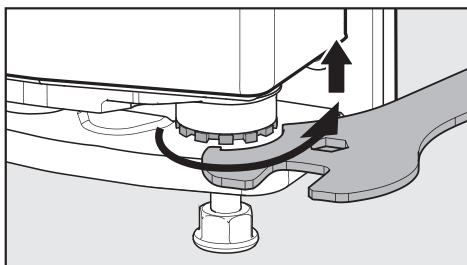

- Adjust the height of the hinge pin using the spanner supplied.  
To lift the door:  
turn the spanner to the right.  
To lower the door:  
turn the spanner to the left.
- Tighten the grub screw.  
The hinge pin is now secure again.

## Building in the appliance

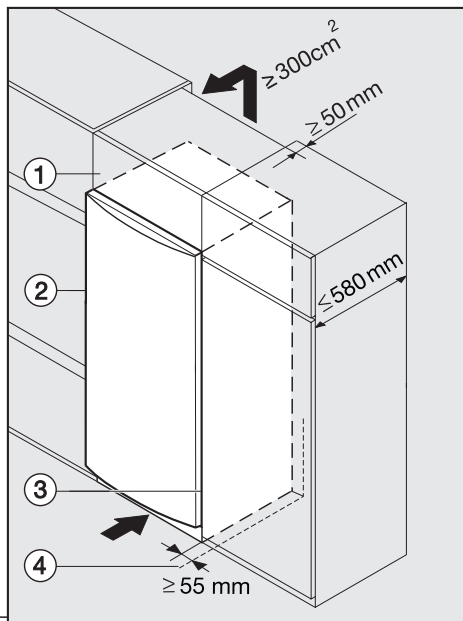

\* The depth of appliances with wall spacers is increased by approx. 35 mm.

- ① Top box
- ② Appliance
- ③ Housing unit
- ④ Wall

The appliance can be installed in a kitchen run. To match the height of the rest of the kitchen, the appliance can be fitted with a suitable top box ①.

A ventilation gap of at least 50 mm depth must be allowed for behind the appliance across the entire width of the top box for air to circulate.

The cross section of the air outlet under the room ceiling must be at least 300 cm<sup>2</sup> to ensure that air can circulate without hindrance. Otherwise the appliance has to work harder, resulting in an increase in electricity consumption.

The air inlet and outlet must not be covered or blocked in any way. They should be dusted on a regular basis.

When built into a kitchen run (max. depth 580 mm), the appliance can be installed directly next to a kitchen furniture housing unit. The appliance door will protrude in front of furniture fronts at the sides by 34 mm\* and by 55 mm\* in the middle of the door. This enables the doors to be opened and shut without being obstructed.

When installed **next to a wall** ④, a distance of approx. 55 mm must be maintained on the hinge side between the wall ④ and the appliance ② so that the doors and the handles have sufficient space for opening.



## **Miele Australia Pty. Ltd.**

ABN 96 005 635 398

### **Head Office Melbourne:**

1 Gilbert Park Drive  
Knoxfield, VIC 3180

### **Miele Gallery and Office Melbourne:**

208-210 Coventry Street  
South Melbourne, VIC 3205

### **Miele Gallery and Office Sydney:**

3 Skyline Place  
Frenchs Forest, NSW 2086

### **Miele Gallery and Office Brisbane:**

39 Harvey Street North  
Eagle Farm, QLD 4009

### **Miele Gallery and Office Adelaide:**

83-85 Sir Donald Bradman Drive  
Hilton, SA 5033

### **Miele Gallery and Office Perth:**

205-207 Stirling Highway  
Claremont, WA 6010



**[www.miele.com.au](http://www.miele.com.au)**



## **Miele New Zealand Limited Miele Gallery and Head Office**

Unit L, 10-20 Sylvia Park Road  
Mt. Wellington, 1060, Auckland  
New Zealand

Telephone: 0800 264 353

[www.miele.co.nz](http://www.miele.co.nz)

## **Miele Global Headquarters Germany**

### **Miele & Cie. KG**

Carl-Miele-Straße 29

33332 Gütersloh

Federal Republic of Germany