

Operating and installation instructions

Frost free freezer



To avoid the risk of accidents or damage to the appliance, it is **essential** to read these instructions before it is installed and used for the first time.

Contents

Guide to the appliance	5
Caring for the environment	7
Warning and Safety instructions	8
How to save energy	14
Switching on and off	15
Operation	15
Switching off	16
Further settings	16
Switching off for longer periods of time	18
The correct temperature	19
Setting the temperature in the freezer	19
Temperature range	20
Temperature (Fahrenheit/Celsius)	20
Temperature display	21
Alarms	22
SuperFreeze	24
Adjusting the interior fittings	25
Moving the shelves	25
Top shelf	25
Moving the door shelf	25
Freezer baskets	26
Freezing and storing food	27
Freezing fresh food	27
Storing frozen food	27
Home freezing	28
Defrosting	29
Cooling drinks	29
Ice/water dispenser	30
Using the ice/water dispenser for the first time	30
Rinsing the ice/water dispenser pipework	30
Switching on the ice/water dispenser	31
Chilled water	32
Ice cubes and crushed ice	32
System lock	33
Lighting	33
Switching off the ice/water dispenser	34
Ice/water dispenser settings mode	34

Automatic defrost	36
Cleaning and care	37
Before cleaning	38
Cleaning the interior and accessories	38
Ice cube container	38
Drip tray	39
Ventilation gaps	39
Door seals	39
Problem solving guide	40
Water filter	46
Reminder to change the water filter	46
To change the water filter	47
To confirm the water filter has been changed	48
Using an external water filter	48
Noises	49
After Sales / Warranty	50
Warranty	50
Information for test institutes	51
Mains water connection	52
Notes on connecting to the mains water supply	52
Preparing for plumbing the appliance into the mains water supply	53
Fitting the stainless steel hose to the appliance	55
Electrical connection	56
Installation advice	57
Location	57
Floor	58
Door hinging	58
Adjoining furniture/units	58
Ventilation	58
Side-by-side installation	59
Appliance door dimensions (opening angle 115°)	60
Building-in dimensions	61
Laying the electrical cabling and the pipework for the mains water supply	62
Door front dimensions	62

Contents

Installation	63
Tools and accessories required	63
Weight of the furniture door front	64
Building into a peninsular run	64
Building-in at the end of a run of units	64
Aligning the housing unit	65
Checking the building-in niche	65
Before installation	65
Preparing the niche	66
Assembly parts	66
Anti-tipping mechanism	67
An alternative anti-tipping mechanism	68
Placing the appliance in the niche	69
Aligning the appliance	70
Securing the appliance in the niche	71
Preparing the furniture fronts	73
Securing and aligning the furniture door	75
Securing the covers	76
Fitting the plinth facing	77
Fitting the air separator	77
Aligning the ice/water dispenser	78
Securing the ice/water dispenser frame	80
Contact details	83

Control panel for the freezer

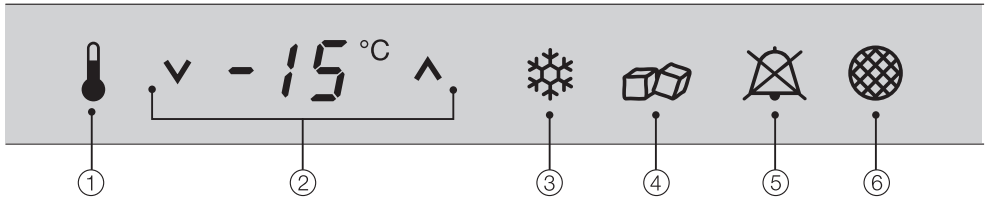

- ① Access sensor
- ② Sensor for selecting the temperature in the freezer (V for colder; ^ for warmer)
- ③ On/Off sensor for the SuperFreeze function
- ④ On/Off sensor for the ice/water dispenser
- ⑤ Sensor for switching off the temperature or door alarm (only visible when the temperature or door alarm is sounding)
- ⑥ Reminder to change the water filter

Control panel for the ice/water dispenser

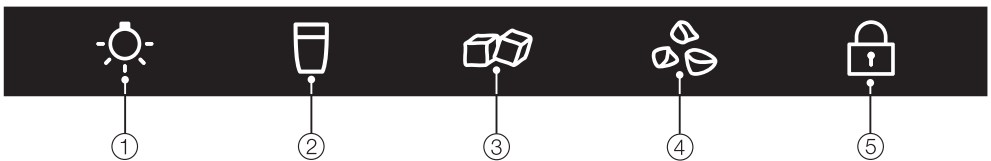

- ① On/Off sensor for the lighting
- ② Chilled water sensor
- ③ Ice cube sensor
- ④ Sensor for crushed ice
- ⑤ On/Off sensor for the system lock

Guide to the appliance

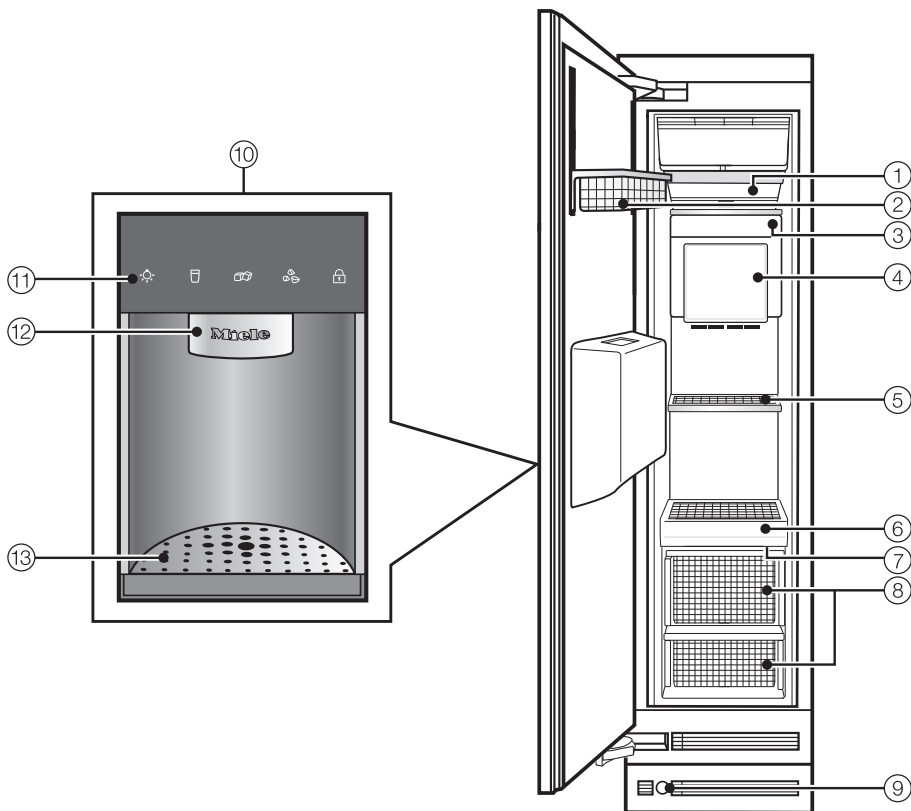

- ① Interior lighting
- ② Door basket
- ③ Ice cube maker
- ④ Ice cube container
- ⑤ Adjustable shelf
- ⑥ Control panel for the freezer
- ⑦ Rocker switch for switching the whole appliance on and off
- ⑧ Freezer baskets
- ⑨ Water filter
- ⑩ Ice/water dispenser located in the door
- ⑪ Control panel for the ice/water dispenser
- ⑫ Ice/water dispenser spout
- ⑬ Drip tray cover with grille

Disposal of the packing material

The transport and protective packing has been selected from materials which are environmentally friendly for disposal and can normally be recycled.

Ensure that any plastic wrappings, bags, etc. are disposed of safely and kept out of the reach of babies and young children. Danger of suffocation.

Rather than just throwing these materials away, please ensure they are offered for recycling.

Disposing of your old appliance

Electrical and electronic appliances often contain materials which, if handled or disposed of incorrectly, could be potentially hazardous to human health and to the environment. They are, however, essential for the correct functioning of your appliance. Please do not therefore dispose of it with your household waste.

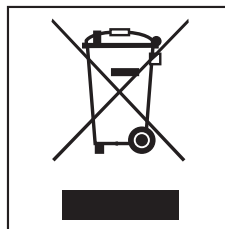

Please dispose of it at your local community waste collection / recycling centre and ensure that it presents no danger to children while being stored for disposal.

The plug must be rendered useless and the cable cut off directly behind the appliance to prevent misuse. Take care not to damage the pipework at the back of it before or during transportation to an authorised collection depot. In this way, refrigerant in the pipework and oil in the compressor will be contained, and will not leak out into the environment.

Warning and Safety instructions

This appliance complies with all relevant local and national safety requirements. Improper use of the appliance can, however, present a risk of both personal injury and material damage.

To avoid the risk of accidents and damage to the appliance, please read these instructions carefully before installation and before using it for the first time. They contain important notes on the installation, safety, operation and care of the appliance.

Keep these instructions in a safe place and ensure that all users are familiar with the contents. Pass them on to any future owner of the appliance.



Warning!

This appliance is very heavy and can tip forwards when the door is open. Keep the appliance door shut until the appliance has been built in and secured in its housing in accordance with these operating and installation instructions.

Correct application

► This appliance is designed for domestic use and for use in similar environments by guests in hotel or motel rooms, bed & breakfasts and other typical living quarters. This does not include common/shared facilities or commercial facilities within hotels, motels or bed & breakfasts.

The appliance is not suitable for outdoor use.

This appliance is intended to store deep frozen food, freeze fresh food, and to make ice.

Any other usage is not supported by the manufacturer and could be dangerous. The manufacturer cannot be held liable for damage resulting from incorrect or improper use or operation.

► This appliance is not intended for use by persons (including children) with reduced physical, sensory or mental capabilities, or lack of experience and knowledge, unless they have been given supervision or instruction concerning its use by a person responsible for their safety.

Safety with children

► This appliance can be used by children aged from 8 years and above and persons with reduced physical, sensory or mental capabilities or lack of experience and knowledge if they have been given supervision or instruction concerning use of the appliance in a safe way and understand the hazards involved. Children shall not play with the appliance. Cleaning and user maintenance shall not be made by children without supervision.

► Older children may only use the appliance when its operation has been clearly explained to them and they are able to use it safely, recognising the dangers of misuse.

► Children should be supervised to ensure that they do not play with the appliance. Keep children away from the appliance at all times to avoid the risk of injury, e.g. as a result of climbing into the freezer baskets or hanging from the door.

► The door hinges can cause injury. Keep children well away from the hinges at all times.

Technical safety

► Before installation, check the appliance for visible signs of damage. Do not install and use a damaged appliance.

A damaged appliance is dangerous.

► If the connection cable is faulty, it must only be replaced by a service technician authorised by the manufacturer to protect the user from danger.

► This appliance contains the coolant Isobutane (R600a), a natural gas which is environmentally friendly. Although it is flammable, it does not damage the ozone layer and does not increase the greenhouse effect. The use of this coolant has, however, led to a slight increase in the noise level of the appliance. In addition to the noise of the compressor, you might be able to hear the coolant flowing around the system. This is unavoidable, and does not have any adverse effect on the performance of the appliance. Care must be taken during the transportation and setting up of the appliance that no parts of the cooling system are damaged. Leaking refrigerant can damage the eyes. In the event of any damage:

- avoid any flames or anything which creates a spark,
- switch off at the wall socket and withdraw the plug,
- ventilate the room where the appliance is located for several minutes, and
- contact Miele for advice.

Warning and Safety instructions

► The more coolant there is in an appliance, the larger the room it should be installed in. In the event of a leakage, if the appliance is in a small room, there is the danger of combustible gases building up. For every 8 g of coolant at least 1 m³ of room space is required. The amount of coolant in the appliance is stated on the data plate inside the appliance.

► Safe operation of the appliance is only assured if it has been installed and connected in accordance with these operating and installation instructions.

► Before connecting the appliance, make sure that the connection data on the data plate (voltage and rated load) match the mains electricity supply. This data must correspond in order to avoid the risk of damage to the appliance. Consult a qualified electrician if in any doubt.

► Do not connect the appliance to the mains electricity supply by a multi-socket unit or an extension lead. These do not guarantee the required safety of the appliance (e.g. danger of overheating).

► The electrical safety of this appliance can only be guaranteed when continuity is complete between it and an effective earthing system which complies with local and national safety regulations. It is most important that this basic safety requirement is present and tested regularly and, where there is any doubt, the household wiring system should be inspected by a qualified electrician.

The manufacturer cannot be held liable

for the consequences of an inadequate earthing system (e.g. electric shock).

► Installation, maintenance and repairs may only be carried out by a suitably qualified and competent person in strict accordance with current national and local safety regulations. Repairs and other work by unqualified persons could be dangerous. The manufacturer cannot be held liable for unauthorised work.

► While the appliance is under warranty, repairs should only be undertaken by a service technician authorised by the manufacturer. Otherwise the warranty will be invalidated.

► Miele cannot be held liable for damage caused by a faulty connection to the mains water supply.

► Connection to the mains water supply and any repairs to the ice cube maker must only be carried out by a suitably qualified and competent person.

► The ice/water dispenser is not suitable for connection to hot water.

► Connect the appliance to a potable water supply only.

► Before making plumbing connections, ensure the appliance is disconnected from the mains electricity supply.

► Never tamper with the movable components on the ice cube maker or the element on the ice cube maker.

Warning and Safety instructions

► The appliance must be isolated from the electricity supply during installation, maintenance and repair work.

The appliance is only completely isolated from the electricity supply when:

- it has been switched off at the wall socket and the plug has been withdrawn, or
- the mains fuse has been disconnected, or
- the screw-out fuse is removed (in countries where this is applicable).

► Faulty components must only be replaced by genuine Miele original spare parts. The manufacturer can only guarantee the safety of the appliance when Miele replacement parts are used.

► This appliance must not be installed and operated in mobile installations (e.g. on a ship).

Correct use

► Before using the ice/water dispenser for the first time, rinse through the ice/water dispenser pipework.

► Never handle frozen food or the metal parts of the appliance with wet hands. Your hands may freeze to the frozen food or to the metal. Danger of injury!

► Do not operate any electrical equipment (e.g. an electric ice-cream maker) inside the appliance. Danger of sparking and explosion!

► Do not take ice cubes out with your bare hands and never place ice cubes or ice lollies in your mouth straight from the freezer.

The very low temperature of the frozen ice or lollies can cause frost burn to the lips and tongue. Danger of injury!

► Do not refreeze thawed or partially thawed food.

Defrosted food should be used up as quickly as possible as food soon loses its nutritional value and goes off.

Defrosted food may only be refrozen after it has been cooked.

► Do not store explosive materials in the appliance or any products containing propellants (e.g. spray cans). Thermostats switching on may produce sparks which could lead to flammable compounds exploding.

Warning and Safety instructions

► Do not store cans or bottles containing carbonated drinks or liquids which could freeze in the freezer. The cans or bottles could explode. Danger of injury and damage to the appliance.

► When cooling drinks quickly in the freezer, make sure bottles are not left in for more than one hour; otherwise they could burst, causing injury and damage.

► Observe the "use-by" dates given on food to avoid the risk of food poisoning. Storage times will depend on several factors, including the freshness and quality of the food as well as the temperature at which it is stored. Follow the instructions given on the food manufacturer's packaging regarding storage conditions and "use-by" dates.

► Do not use sharp edged objects to

- remove frost and ice,
- separate frozen foods and remove ice trays.

They will damage the evaporator, causing irreversible damage to the appliance.

► Never place electric heaters or candles in the appliance to defrost it. These can damage the plastic parts.

► Do not use defrosting sprays or de-icers, as they might contain substances which could damage the plastic parts or which could cause a build-up of gases and pose a danger to health.

► Never use a steam-cleaning appliance to defrost or clean this appliance. Steam could reach the electrical components and cause a short circuit.

► To avoid the risk of any potential illness, do not deactivate the reminder to change the water filter.

► Do not use any oils or grease on the door seal, as these will cause the seal to deteriorate and become porous with time.

► Do not cover or block the air vents in the plinth as this would impair the efficiency of the appliance, increase electricity consumption and could cause damage to the appliance.

► The appliance is designed for use within certain climate ranges (ambient temperatures), and should not be used outside this range. The climate range for your appliance is stated on the data plate inside the appliance. Installing it in a room with too low an ambient temperature, e.g. a garage, can lead to the appliance switching off for longer periods so that it cannot maintain the required temperature.

Disposal of your old appliance

► Before disposing of an old appliance, first make the door latches or locks unusable.

This way you will prevent children from accidentally locking themselves in and endangering their lives.

► Be careful not to damage any part of the pipework whilst awaiting disposal, e.g. by

- puncturing the refrigerant channels in the evaporator.
- bending any pipework.
- scratching the surface coating.

Splashes of refrigerant can damage the eyes.

The manufacturer cannot be held liable for damage caused by non-compliance with these Warning and Safety instructions.

How to save energy

	Normal energy consumption	Increased energy consumption
Installation/Maintenance	In a ventilated room.	In an enclosed, unventilated room.
	Protected from direct sunlight.	In direct sunlight.
	Not situated near a heat source (radiator, oven).	Situated near a heat source (radiator, oven).
	Where the ideal ambient room temperature is approx. 20°C.	Where there is a high room temperature.
	Where the cross-section of the air inlet and outlet is not covered and kept free of dust.	Where the air inlets and outlets are covered or dusty.
Temperature settings	Freezer section -18 °C	With a low temperature setting: The lower the temperature in the appliance, the higher the energy consumption.

How to save energy

	Normal energy consumption	Increased energy consumption
Use	Do not change the arrangement of the drawers and shelves as when delivered.	
	Only open the door when necessary and for as short a time as possible. Store food in an organised way.	Frequent opening of the door for long periods will cause a loss of coldness. The appliance will try to cool down and the running time of the compressor will increase.
	Take a cooler bag when shopping and load food in the appliance as quickly as possible on your return home. When food is taken out of the refrigerator, be sure to put it back before it becomes warm. Allow hot food and drinks to cool down before placing them in the appliance.	Warm food and food brought in from room temperature add heat to the appliance. The appliance will try to cool down and the running time of the compressor will increase.
	Store food covered or packaged.	The evaporation or condensation of liquids will cause a loss of coldness in the refrigerator.
	Place frozen food in the refrigerator to defrost.	
	Do not overfill the appliance to allow air to circulate.	

Switching on and off

Before using for the first time

- Clean the inside of the appliance and the accessories with lukewarm water and a little washing-up liquid, and then dry with a soft cloth.

Important: To ensure the correct functioning of the appliance, and especially if it has been transported horizontally, let it stand for 8 hours after transporting it to its final location before connecting it to the mains.

To enable the temperature to get sufficiently cold inside the appliance, allow the appliance to run for a few hours before placing food in it.

Do not place food in the freezer section until the temperature is at least -18° C.

Please note: switching off with the rocker switch does not disconnect the appliance from the mains.

Switching on

- Open the appliance door.



- Press the rocker switch on the right-hand side underneath the control panel.

The appliance will start to cool, and the interior lighting will come on when the door is opened.



The access sensor in the control panel will also light up.

Operation

A light touch of the finger on the sensors is all that is required to operate this appliance.

Please note:

- A sensor that is **available for selection** is always highlighted in **white**.
- A sensor that is **selected** is always highlighted in **yellow**.



- Touch the access sensor so that it is highlighted in yellow.

Other sensors that are available for selection will appear in the control panel.

You can now

- adjust the temperature,
- select the SuperFreeze function or
- switch the ice/water dispenser on or off.

Please refer to the relevant section for more information.

To leave settings mode,



- touch the access sensor so that it is highlighted in white.

Your last selected settings will now be saved to memory.

If you do not touch the access sensor, the electronics for accessing the settings will switch off after a period.

Switching off



- Press the rocker switch.

The cooling system and the lighting are now switched off.

Further settings

Further settings can be selected in the settings mode.

In settings mode, you can select certain appliance functions via the control panel and adjust the settings. The settings for the different functions are described in more detail in the relevant section of these instructions.

Overview of functions that can be selected in the settings mode:

Function	Symbol displayed
To enter or leave settings mode	<i>c</i>
To select the temperature unit (see "The correct temperature")	<i>f</i>
No function selected	<i>r</i>
To switch the sensor tone on/off (see "Switching on and off")	<i>b</i>
No function selected	<i>h</i>

Switching on and off

To switch the sensor tone on/off

The tone which sounds each time a sensor is touched can be deactivated.



- Touch the access sensor so that it is highlighted in yellow.
- Take note of the position of the √ sensor (but do not touch it!).
- Touch the access sensor until it is highlighted in white and all of the other sensors are no longer lit up.
- Place your finger in the position of the √ sensor, and leave it there.
- At the same time, briefly touch the access sensor (without letting go of the √ sensor).
- Leave your finger on the √ sensor for another 4 seconds until ⚡ and the ^ sensor also appear in the display.



- Now touch the √ sensor repeatedly until b appears in the display.
- Touch the access sensor again.

- By touching the √ sensor, you can now select whether the sensor tone is to be switched on or off:
b 0: Sensor tone switched off
b 1: Sensor tone switched on
b -: Return to menu
- After selecting a new setting, touch the access sensor to confirm your choice.
- Touch the √ sensor repeatedly until ⚡ appears in the display.



- Touch the access sensor.

You have now left settings mode.

The door alarm is automatically disabled when the appliance is in settings mode. As soon as the door is closed, the door alarm is activated again.

Switching off for longer periods of time

If the appliance is not going to be used for a longer period of time, e.g. whilst on holiday:

- turn off the tap to the water supply (a few hours before you switch off the appliance),
- switch the appliance off,
- switch off at the wall and withdraw the plug from the socket, or disconnect the mains fuse or remove the screw-out fuse in countries where this is applicable,
- empty the ice cube container,
- clean the appliance out,
- replace the water filter and
- leave the door ajar to air the appliance.

If, during a long absence, the appliance is switched off but not cleaned out and the doors are left shut, there is a danger of mould and odours building up inside the appliance.

The correct temperature

It is very important to set the correct temperature for storing food in the appliance. Micro-organisms will cause food which is not stored at the correct temperature to deteriorate rapidly. Temperature influences the growth rate of these micro-organisms. Reducing the temperature reduces their growth rate.

To freeze fresh food and to store frozen food for a long time, a temperature of **-18 °C** is required. At this temperature the growth of micro-organisms is generally halted. As soon as the temperature rises above -10 °C, the micro-organisms become active in the food again so that it cannot be kept as long. For this reason, partially defrosted or defrosted food must not be refrozen. Food may be refrozen once it has been cooked, as the high temperatures achieved when cooking destroy most micro-organisms.

The temperature in the appliance will rise:

- the more often the door is opened and the longer it is kept open,
 - the more food that is stored in it,
 - the warmer the food is which is being put into it,
 - the higher the ambient temperature surrounding the appliance.
- The appliance is designed for use in specific ambient temperatures (climate ranges). Do not use in ambient temperatures for which it is not designed.

Setting the temperature in the freezer



- Touch the access sensor so that it is highlighted in yellow.



- The temperature inside the appliance can be selected by touching the arrow sensors on either side of the temperature display.

By touching the

- ∨ sensor: the temperature will get colder
- ∧ sensor: the temperature will get warmer.

The temperature range being set will flash in the display as you do this.

- Touching the sensor once: the temperature is adjusted in 1 °C steps.
- Keeping your finger on the sensor: changes the temperature continuously.

If the highest or lowest temperature that it is possible to set is reached, the ∨ or ∧ sensor will disappear from the display.

The temperature display on the control panel always shows the **selected** temperature.

The correct temperature

When you have adjusted the temperature, **wait for approx. 6 hours if the appliance is not very full and for approx. 24 hours if the appliance is full** before checking the temperature display, as it will take this long for the appliance to reach the temperature. If, after this time, the temperature is still too high or too low, you will need to adjust it again.

Temperature range

The temperature in the freezer section can be adjusted:

- from -14 °C to -24 °C if the ice/water dispenser is switched off
- from -18 °C to -24 °C if the ice/water dispenser is switched on

The ambient temperature in the room and the installation location can affect the time it takes for the appliance to reach the lowest temperature. If the ambient temperature is too high, the appliance may not reach the lowest temperature.

Temperature (Fahrenheit/Celsius)

The temperature can be displayed in degrees Celsius or degrees Fahrenheit.



- Touch the access sensor so that it is highlighted in yellow.
- Take note of the position of the ∇ sensor (but do not touch it!).
- Touch the access sensor until it is highlighted in white and all of the other sensors are no longer lit up.
- Place your finger in the position of the ∇ sensor, and leave it there.
- At the same time, briefly touch the access sensor (without letting go of the ∇ sensor).
- Leave your finger on the ∇ sensor for another 4 seconds until ϵ and the \wedge sensor also appear in the display.



- Now touch the ∇ sensor repeatedly until ϵ appears in the display.
- Touch the access sensor again.

The correct temperature

- By touching the ∇ sensor, you can now set the temperature to be displayed in Fahrenheit or Celsius.
 °F : Temperature in Fahrenheit
 °C : Temperature in Celsius
 — : Return to menu
- After selecting a new setting, touch the access sensor to confirm your choice.
- Now touch the ∇ sensor repeatedly until °C appears in the display.



- Touch the access sensor again.

You have now left settings mode.

The door alarm is automatically disabled when the appliance is in settings mode. As soon as the door is closed, the door alarm is activated again.

Temperature display

The temperature display on the control panel always shows the **selected** temperature.

The **temperature display will flash** if

- a different temperature is being set,
- the temperature in the appliance has risen by several degrees, indicating that the appliance is warming up too much.

This loss of coldness is no cause for concern in the following circumstances:

- when the door has been left open for a while, e.g. for removing or storing a large amount of food,
- when fresh food is being frozen.

However, if the temperature in the freezer remains above -18°C for a long time, check that the frozen food has not started to defrost. If it has, check that the food is safe to use and if it is, then use it as soon as possible.

Your appliance has been fitted with a warning system which ensures that the temperature in the appliance cannot rise unnoticed and to avoid energy being wasted if the door is left open.

Activating the alarm system

The alarm system is always active. It does not have to be switched on manually.

Temperature alarm

If the temperature in the appliance gets too warm, the alarm sensor will flash in the control panel.

An audible alarm will also sound.

The temperature display will show the highest temperature that was reached during the time the temperature in the freezer rose.

The alarm will sound and the relevant symbol will flash, for example:

- if the freezer door has been left open for a while, e.g. in order to load, rearrange or take food out.
- when freezing large amounts of food at once.
- in the event of a power cut.

The alarm will stop and the "Alarm off" sensor in the display will go out again as soon as the temperature has dropped down to the correct level again.

Switching the temperature alarm off early

If the noise disturbs you, you can switch the alarm off early if you wish.



- Touch the "Alarm off" sensor.
The alarm will stop.
The "Alarm off" sensor will continue to be lit up until the temperature has dropped down to the correct level again.

However, if the temperature in the freezer remains above -18 °C for a long time, check that the frozen food has not started to defrost. If it has, check that the food is safe to use and if it is, then use it as soon as possible.

Alarms

Door alarm

The alarm will sound if the door is left open for more than 5 minutes.
The "Alarm off" sensor will also light up.

The alarm will stop and the "Alarm off" sensor in the display will go out as soon as the door has been shut.

Switching the door alarm off early

If the noise disturbs you, you can switch the alarm off early if you wish.



- Touch the "Alarm off" sensor.

The "Alarm off" sensor in the display will go out and the alarm will stop.

SuperFreeze

Switch the SuperFreeze function on before putting fresh food into the freezer.

This helps food to freeze quickly and retain its nutrients, vitamins, flavours and appearance.

Exceptions:

- When placing food in the freezer that is already frozen.
- When freezing less than 2 kg of fresh food in any one day.

Switching on SuperFreeze

When freezing small quantities of food in the freezer, the SuperFreeze function should be switched on **4-6 hours beforehand**. When freezing the **maximum load of food**, the SuperFreeze function should be switched on **24 hours beforehand**.



- Touch the On/Off sensor for the SuperFreeze function so that it is highlighted in yellow.

The appliance will now operate at full power to lower the temperature in the freezer, and the newly set temperature of -30 °C will appear in the temperature display.

Switching off SuperFreeze

Depending on the amount of food placed in the freezer, the SuperFreeze function will switch off automatically after approx. 52 hours. The sensor is highlighted in white and the appliance continues running at normal power.

To save energy, the SuperFreeze function can be switched off once the temperature in the freezer is low enough.



- Touch the On/Off sensor for the SuperFreeze function so that it is highlighted in white.

The original temperature will now appear in the temperature display.

The appliance will continue to operate at normal power.

Adjusting the interior fittings

Moving the shelves

The shelves can be adjusted according to the height of the food:

- Hold the shelf on both sides and raise it slightly so that it can be lifted over the catches at the back.
- Pull the shelf forwards.
- Place the shelf at the required level, ensuring that it has engaged in the catches at the back.
- Make sure that the shelf is on straight.

Top shelf

The top shelf can be removed for cleaning:

- Lift the shelf up and out.
- When replacing the shelf, make sure that the lugs on the corners at the back are correctly engaged.

Moving the door shelf

The door shelf can be moved when loading and unloading it and for cleaning, or it can be removed completely:

- Hold the door shelf by its frame with both hands, raise it a little and then tip it forwards slightly.
- Slide the shelf in its angled frame up or down in the side runners as required, and engage it in its new position.
- Make sure that the shelf is straight.

To remove the door shelf altogether,

- Slide it up the side runners to the very top, then lift it out.

To replace the door shelf

- Engage the door shelf in the runners at the top, and push it down to the position required.

Freezer baskets

The freezer baskets can also be removed for cleaning.

- Pull the freezer basket out as far as it will go.

To prevent children from hurting themselves, there is a pin on the door opening side which needs to be turned to a horizontal position in order to remove the drawer.

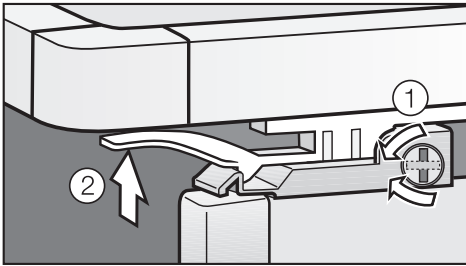

- Use a screwdriver or similar to turn the pin so that the slot in the head is horizontal ①.
- Raise the snap fittings on both sides ② and lift the basket out.

To replace the freezer basket

- Pull the telescopic rails out as far as they will go.
- Place the freezer basket on the rails so that it engages at the back and front.
- Turn the slot on the pin to its vertical position.
- Push the freezer basket back in.

Freezing and storing food

Freezing fresh food

Fresh food should be frozen as quickly as possible so that the nutritional value of the food, its vitamin content, appearance and taste are not impaired.

Food which takes a long time to freeze will lose more water from its cells, which then shrink.

During the defrosting process, only some of this water is reabsorbed by the cells.

This means that a greater moisture loss in food occurs. This can be seen in the water that collects around the food.

If food is frozen quickly, the cells have less time to lose moisture, so they shrink less. As there is not so much moisture loss, it is easier for the food to reabsorb it during the defrosting process, and very little water collects around the defrosted food.

Storing frozen food

When buying frozen food to store in your freezer, check

- that the packaging is not damaged,
- the use-by date,
- the temperature at which the frozen food is being stored in the shop. The length of time it can be kept is reduced if it has been stored at a temperature warmer than -18°C .

- Buy frozen food once you have finished the rest of your shopping, and wrap it in newspaper or use a cool bag or cool box to transport it.
- Place it in the freezer as soon as possible.

Never refreeze partially or fully defrosted food. Consume defrosted food as soon as possible as it will lose its nutritional value and spoil if left for too long. Defrosted food may only be refrozen after it has been cooked.

Home freezing

Only freeze fresh food which is in a good condition.

Tips on home freezing

- The following types of food **are suitable** for freezing:
Fresh meat, poultry, game, fish, vegetables, herbs, fresh fruit, dairy products, pastry, leftovers, egg yolks, egg whites and a range of pre-cooked meals.
- The following types of food **are not suitable** for freezing:
Grapes, lettuce, radishes, sour cream, mayonnaise, eggs in their shells, onions, whole raw apples and pears.
- To retain colour, taste and vitamin C, vegetables should be blanched after they have been trimmed and washed. To blanch: bring a large saucepan of water to the boil, immerse the vegetables in the fast boiling water for 2 – 3 minutes, depending on variety. Remove, and plunge into ice-cold water to cool quickly. Drain and pack ready for freezing.
- Lean meat freezes better than fatty meat, and can be stored for considerably longer.
- To prevent chops, steaks, cutlets or rolled meat from freezing together in solid blocks when packed, separate with a sheet of plastic freezer film.
- Do not season fresh foods or blanched vegetables before freezing. Only season cooked food

lightly before freezing, but care should be taken as the taste of some spices alters when frozen.

- Do not place hot food or drinks in the freezer. This causes already frozen food to thaw, and increases the energy consumption considerably. Allow hot food and drinks to cool down before placing them in the freezer.

Packing

- Freeze food in portions.

Unsuitable packing material

- wrapping paper
- grease-proof paper
- cellophane
- bin bags
- plastic carrier bags

Suitable packing material

- plastic freezer film
- freezer bags
- aluminium foil
- freezer containers

- Expel as much air as possible from bags etc. before sealing them to prevent freezer-burn on food.
- Close the packaging tightly with
 - rubber bands
 - plastic clips
 - string or bag ties
 - freezer tape.

Freezer bags may also be sealed using home heat sealing kits.

- Make a note of the contents and the date of freezing on the packaging.

Freezing and storing food

Before placing food in the freezer

- When freezing more than 2 kg of fresh food, switch on the SuperFreeze function for some time before placing the food in the freezer (see "SuperFreeze"). This also helps to prevent food that is already in the freezer from starting to defrost.

Placing food in the freezer

Food to be frozen can be placed anywhere in the freezer. Place large quantities of food in the large freezer basket.

Please follow the guidelines in the table below regarding recommended weights for the baskets:

	Upper basket	Lower basket
F 1471 Vi	16 kg	16 kg

- Place the food flat in the bottom of the basket so that it freezes through to the core as quickly as possible.
- Make sure that the packaging and containers are dry to prevent them sticking together when frozen.

When freezing, make sure that food already frozen does not come into contact with fresh food being frozen as this could cause the frozen food to begin to defrost.

Defrosting

Frozen food can be defrosted in different ways:

- in a microwave oven,
- in an oven using the "Fan" or "Defrost" setting,
- at room temperature,
- in the refrigerator (the cold given off by the frozen food helps to keep the other food cold),
- in a steam oven.

Partially thawed **thin pieces of meat or fish** can be placed in a hot pan.

Fruit can be defrosted at room temperature in its packaging, or in a covered bowl.

Most vegetables can be cooked while still frozen. Just put straight into boiling water or hot fat. The cooking time is slightly less than that of fresh vegetables due to changes in the cell structure.

Never refreeze partially or fully defrosted food. Consume defrosted food as soon as possible as it will lose its nutritional value and spoil if left for too long. Defrosted food may only be refrozen after it has been cooked.

Cooling drinks

When cooling drinks quickly, make sure bottles are **not left in the freezer for more than one hour**, as they could burst.

For the ice/water dispenser to operate, it must be connected to the mains water supply (see "Mains water connection").

Use a suitable glass or jug to dispense water and ice cubes into.
Danger of glass splinters.

Do not hold your hand under the dispenser spout. Danger of injury!

After opening and closing the appliance door, it may take a few seconds before the ice/water dispenser can be used again.

The sensor for chilled water will flash white in the ice/water dispenser control panel.

- Place a large container on the drip tray cover.



- Touch the sensor for chilled water until it flashes yellow.
- Touch and keep your finger on the sensor for chilled water again.

This will activate the rinsing function and approx. 6 litres of water will now be pumped through the pipework.

You can interrupt the rinsing process at any time to allow you to empty the container by taking your finger off the sensor for chilled water.

The sensor will continue to flash yellow while you empty the container.

A beep will sound when the rinsing process is complete and the sensors in the ice/water dispenser control panel will now be highlighted in white.

The ice/water dispenser is now ready for use.

Using the ice/water dispenser for the first time

Before it is used for the first time, the ice/water dispenser pipework must be rinsed through and filled with water.

Rinsing the ice/water dispenser pipework

- Open the appliance door.



- Touch the access sensor so that it is highlighted in yellow.



- Touch the On/Off sensor for the ice/water dispenser so that it is highlighted in yellow.
- Close the appliance door.

Ice/water dispenser

Switching on the ice/water dispenser

Before using the ice/water dispenser for the first time, rinse through the ice/water dispenser pipework.

- Open the appliance door.
- Make sure that the ice cube container is correctly located underneath the ice cube maker.

The container must be completely shut for ice cubes to be produced.



- Touch the On/Off sensor for the ice/water dispenser so that it is highlighted in yellow.
- Close the appliance door.

The ice/water dispenser is now ready to use.

After opening and closing the appliance door, it may take a few seconds before the ice/water dispenser can be used again and the sensors can be selected.



- To activate the ice/water dispenser, touch one of the sensors or place your hand briefly under the dispenser spout. A light sensor below the spout will register this movement.

All the sensors in the ice/water dispenser control panel should now be highlighted in white.

If this is not the case, the system lock has been activated (the  sensor will be highlighted in yellow - see "System lock").

If the  sensor is flashing, the drip tray needs to be emptied (see "Cleaning and care").

Once the freezer has cooled down to its set temperature, the ice cube maker will fill with water.

Do not place bottles or other items in the ice cube maker to chill them quickly. The ice cube maker could become blocked and, as a result, be damaged.

Discard the ice cubes produced during the first 24 hours and do not consume any chilled water or crushed ice during this period as the water will have been used to rinse through the pipework.

This also applies when using the appliance again after not having used it for a while.

Chilled water

- Place a large container on the drip tray cover.



- Touch and keep your finger on the chilled water sensor.

Chilled water will be dispensed from the spout as long as the sensor is being touched.

After a while, dispensing will stop automatically. Press the sensor again if you wish to dispense more water.

Fill the container with ice cubes beforehand if you want it to be colder.

Take your finger off the sensor when the glass or jug is almost full. Otherwise it will overflow or the ice will block the dispensing spout.

The ice cube maker can make up to 150 ice cubes in 24 hours.

The amount of ice cubes which the appliance makes depends on the temperature in the freezer. The lower the temperature, the more ice cubes are produced within a certain time frame.

If the  sensor is flashing, the drip tray needs to be emptied and dispensing is stopped automatically. Mop out the drip tray with a sponge or cloth.

Ice cubes and crushed ice

Remember it can take up to 24 hours to produce the first ice cubes after switching on for the first time.

- Place a large container on the drip tray cover.



- Touch and keep your finger on the sensor for ice cubes or crushed ice.

Ice cubes will be dispensed from the spout as long as the sensor is being touched.

After a while, dispensing will stop automatically. Press the sensor again if you wish to dispense more ice.

If the appliance has been switched off for a long period of time, discard the chilled water and ice that is produced in the 24 hours after the appliance has been switched on again.

Ice/water dispenser

If the ice/water dispenser is not used again within 2 minutes or if the door is opened, the ice/water dispenser will switch to standby mode automatically and the lighting will go out.

After it has been activated again, it can take a few seconds before chilled water and ice is dispensed again.

System lock

You can use the system lock to prevent the ice/water dispenser from being used without your knowledge, e.g. by children.



- Touch the  sensor so that it is highlighted in yellow.

The ice/water dispenser sensors are now locked. To deactivate the system lock,

- touch the  sensor so that it is highlighted in white.

Lighting

To switch the ice/water dispenser lighting on or off,



- touch the lighting sensor until it is highlighted in yellow (lighting on) or white (lighting off).

Switching off the ice/water dispenser

The appliance must be disconnected from the mains water supply a few hours before the ice/water dispenser is switched off.

- Open the appliance door.



- Touch the On/Off sensor for the ice/water dispenser so that it is highlighted in white.



Ice/water dispenser settings mode

To enter settings mode





- Touch the  sensor so that it is highlighted in white.



- At the same time, briefly touch the lighting sensor (without moving your finger from the  sensor).
- Leave your finger on the  sensor for another 4 seconds until both sensors light up yellow.

The colour of the other sensors shows whether that sensor is switched on (yellow) or switched off (white):

-  De-misting function
-  Ice cube separation
-  Keypad tones

- Let go of both sensors.

De-misting function

A heater element behind the ice/water dispenser control panel stops it misting up.

You can deactivate this function to save energy.

The appliance is delivered with this function deactivated.

To activate this function,



- touch the sensor for chilled water so that it is highlighted in yellow.

Ice/water dispenser

Ice cube separation

To prevent the ice cubes and crushed ice from freezing together and blocking the dispensing spout, the spindle in the ice cube container moves at regular intervals to separate them.

You can deactivate this function if the noise disturbs you.

Note: If you deactivate this function, the ice/water dispenser spout can become blocked with ice.

The appliance is delivered with this function activated.

To deactivate this function,



- touch the ice cube sensor so that it is highlighted in white.

Keypad tones

The tone which sounds each time a sensor is touched can be deactivated.

The appliance is delivered with this function activated.

To deactivate this function,



- touch the crushed ice sensor so that it is highlighted in white.

To leave settings mode



- Touch the lighting sensor or do not touch any of the sensors for one minute.

This freezer is equipped with a frost free system. The freezer defrosts automatically.

The moisture generated by defrosting collects in the condensor and is automatically dissipated by the condensor from time to time.

This automatic defrosting system enables the freezer to remain permanently ice-free. However, the food stored in the freezer will not defrost.

Cleaning and care

Make sure that water cannot get into the electronic unit or the lighting.

Do not use a steam cleaner. Steam could reach electrical components and cause a short circuit.

The data plate inside the appliance must not be removed. It contains information which is required in the event of a service call.

To avoid damaging the outer surfaces of your appliance, do not use:

- cleaning agents containing soda, ammonia, acids or chlorides,
- cleaning agents containing descaling agents,
- abrasive cleaning agents, e.g. powder cleaners and cream cleaners,
- solvent-based cleaning agents,
- stainless steel cleaning agents,
- dishwasher cleaner,
- oven sprays,
- glass cleaning agents,
- hard, abrasive sponges and brushes, e.g. pot scourers,
- dirt erasers,
- sharp metal scrapers.

The drip tray cover, dispenser spout, back and frame of the ice/water dispenser are finished with a high quality surface coating. They prevent soiling and make cleaning easier.

Do **not** use the following on the drip tray cover, the dispenser spout, or the back and the frame of the ice/water dispenser:

- stainless steel cleaning agent: this will damage the surface.
- Original Miele care product for stainless steel: this will cause noticeable smearing.

Do not clean the drip tray cover or the ice/water dispenser spout in a dishwasher. This will damage the surface.

Do not attach magnets to the surface as it is susceptible to scratching.

Do not use sticky notes, transparent adhesive tape, masking tape or other types of adhesive on treated surfaces. These will damage the surface, causing it to lose its dirt repellent protective coating.

Remove any soiling immediately. If this is not done, it might become impossible to remove and could cause the surface to alter or discolour.

Before cleaning



- Switch the appliance off by pressing the On/Off rocker switch.

The rocker switch is located on the right-hand side, below the control panel.

- Disconnect the appliance from the mains. Switch off at the wall and withdraw the plug from the socket, or disconnect the mains fuse or remove the screw-out fuse in countries where this is applicable.
- Take any frozen food out of the appliance and store it in a cool place.
- Take out any removable parts, e.g. shelves, for cleaning.

Cleaning the interior and accessories

- Clean the appliance at least once a month.
- Clean with lukewarm water and a little washing-up liquid.
Wash all accessories and drawers by hand only. Do not wash in a dishwasher.
- After cleaning, wipe the interior and accessories with a damp cloth and dry with a soft cloth. Leave the door open to air the appliance for a short while.

Aluminium frames

The frames to the shelves inside the appliance and the door basket are made from aluminium.

The appearance of aluminium is affected by the way that light falls on it, by the surrounding environment and by the angle you observe it from. It is also susceptible to scratching.

The aluminium frames may suffer discolouration or damage if soiling is left on for too long. Remove any soiling immediately.

Ice cube container

- Pull the ice cube container out of the appliance.
- Empty it and rinse it with warm water.
- Dry the container and spindle thoroughly so that new ice cubes will not freeze onto the surfaces.

To replace the ice cube container:

- Push the container back into the appliance until it clicks into position.
- If you cannot push the container back in all the way, turn the spindle inside a little.

Cleaning and care

Drip tray

The drip tray catches excess water.



When the drip tray is full, the  symbol in the ice/water dispenser control panel will flash and dispensing will stop. There are sensors in the drip tray which measure when the drip tray needs to be emptied.

To avoid a build-up of odour, the drip tray should be cleaned every day.

When the  symbol flashes:

- Remove the drip tray cover and the grille.
- Mop out the drip tray using a sponge or tea towel and then clean it.
- Clean the drip tray cover and the grille.
- Replace the grille and the drip tray cover.

The  symbol will now be highlighted in white again.

Ventilation gaps

- The ventilation gaps should be cleaned on a regular basis with a brush or vacuum cleaner. A build-up of dust will increase the energy consumption of the appliance.

Door seals

Do not use any oils or grease on the door seals as these will cause the seals to deteriorate and become porous over time.

- The door seals should be cleaned regularly with clean water, and then wiped dry with a soft cloth.

After cleaning

- Refit all shelves and accessories in the appliance.
- Reconnect the appliance to the electricity supply and switch it on.
- Switch on the SuperFreeze function so that the freezer section can cool down quickly.
- Once the freezer has reached the required temperature, place the food back in the freezer baskets.
- Switch off the SuperFreeze function as soon as the temperature in the freezer is a constant -18°C or colder.

Repair work to electrical appliances must only be carried out by a suitably qualified and competent person in strict accordance with current local and national safety regulations. Repairs and other work by unqualified persons could be dangerous. The manufacturer cannot be held liable for unauthorised work.

What to do if . . .

. . . the appliance does not get cold.

- Check whether the appliance has been switched on. If it is switched on, the access sensor will light up in the display.
- Check that the plug is correctly inserted into the socket and switched on.
- Check whether the mains fuse has tripped or whether the fridge freezer, mains voltage or another appliance is faulty.
Contact a qualified electrician or Miele.
- Check the temperature settings.

. . . the temperature in the freezer is too low.

- Increase the temperature.
- Switch off the SuperFreeze function if this is switched on.
- Check that the appliance door has been closed properly.

- Has a large amount of fresh food been put in at the same time for freezing?
This makes the compressor run for longer, causing the temperature to fall automatically.

. . . the door will not open because it has been opened and closed too many times in succession.

- This is not a fault. The suction caused by opening and closing the door is preventing the door from opening. Wait a few minutes and then try again. It should now open without force.

. . . the compressor is switching on too frequently and for too long.

- Check whether the ventilation gaps in the plinth and in the housing unit at the top have been covered over or become too dusty.
- The door has been opened too frequently, or a large amount of food has been put in at once.
- Check that the appliance door has been closed properly.

. . . the compressor runs continuously.

To save energy, the compressor runs at a lower speed when less cooling is required. In this case, the compressor runs for longer.

Problem solving guide

... the temperature display for the freezer section shows -18 °C even though a higher temperature has been set.

This is not a fault. If the ice cube maker is switched on and the room temperature is low ($< +18\text{ °C}$), the temperature will automatically switch to -18 °C .

This ensures that the ice cube maker functions properly.

... frozen food is thawing because the freezer is too warm.

- Is the room temperature lower than the ambient temperature for which the appliance is designed?

If so, raise the temperature of the room.

Operating in a room which is too cold will cause the cooling system to switch off for too long, causing the freezer to become too warm.

... food has frozen together.

- Use a blunt instrument, e.g. a spoon handle or plastic scraper, to prise it apart carefully.

... the alarm sounds.

Has the appliance door been open for longer than 5 minutes?

- Close the appliance door.

... the alarm sounds and the "Alarm off" sensor lights up or is flashing.

- The door is open, or
- the temperature in the appliance has risen significantly because
 - too much warm air from the room has entered the appliance,
 - large quantities of food have recently been placed in the freezer,
 - there has been a power cut.

The alarm will stop and the "Alarm off" sensor in the display will go out again as soon as the temperature has dropped down to the correct level again.

The temperature display will show the highest temperature that was reached during the time the temperature in the freezer rose.

Check the condition of the food in the freezer. If it has defrosted or started to defrost, check that it is still safe to use and, if so, use it as soon as possible. Defrosted food may only be refrozen after it has been cooked.

... the reminder to change the water filter indicator lights up red.

The water filter will soon need to be changed.

- You can order a replacement filter from your Miele Chartered Agent or from Miele.

... the reminder to change the water filter indicator flashes red.

- Replace the water filter.

... the symbol flashes in the control panel of the ice/water dispenser.

The drip tray of the ice/water dispenser is full.

- Empty the drip tray.

... the control panel is misted up.

The heater element behind the control panel is switched off.

- Switch the de-misting function back on again (see "Ice/Water dispenser").

... the ice/water dispenser doesn't switch on.

- Check whether the appliance is connected to the electricity supply.

... the ice/water dispenser is not immediately ready for use after the appliance has been switched on.

This is not a fault.

After opening and closing the appliance door, it may take a few seconds before the ice/water dispenser can be used again.

... the ice/water dispenser doesn't produce ice cubes or chilled water.

- Check whether the appliance has been switched on.
- Check whether the ice/water dispenser is switched on.
- Check whether the system lock for the ice/water dispenser has been activated (the  symbol is highlighted yellow in the control panel).

- Check whether the appliance is correctly connected to the mains water supply.
- Was the water inlet pipe purged of air by a qualified and competent person before the appliance was used for the first time?
- Check whether the water inlet is open.
- Check that the ice cube container is positioned correctly.
- Check that the temperature in the freezer section is low enough.
- Check whether there is sufficient water pressure. The water pressure (flow rate) must be between 1.7 and 5.5 bar.
- Check that the correct valve was installed; an incorrect valve may cause a drop in water pressure.
- Check whether the ice cube separating function is switched on. If the ice is not separated by the spindle in the ice cube container at regular intervals, it may freeze together and block the dispensing spout (see "Ice/Water dispenser").

Remember it can take up to 10 hours to produce the first ice cubes.

Problem solving guide

... the ice/water dispenser only produces small ice cubes.

- Are other appliances that are connected to the mains water supply being used at the same time?
Avoid using the dishwasher, washing machine etc. at the same time.
- Check whether the water filter needs to be changed.
- Check whether there is sufficient water pressure. The water pressure (flow rate) must be between 1.7 and 5.5 bar.
- Check that the correct valve was installed; an incorrect valve may cause a drop in water pressure.

Remember it can take up to 10 hours to produce the first ice cubes.

- Check that the ice cube container is clean and wash it if necessary.

... the ice/water dispenser is producing too few or misshapen ice cubes or is only dispensing a very little amount of water.

- Check whether there is sufficient water pressure. The water pressure (flow rate) must be between 1.7 and 5.5 bar.
- Check that the temperature in the freezer section is low enough.
- Replace the water filter.

... the ice cubes taste or smell odd.

- How often do you use the ice cube maker?
If you do not use it very often, ice cubes that are stored for a long period can absorb the taste and smell of other items.
- Are you storing unwrapped food in the freezer?
Ice can absorb the taste and smell of unwrapped food.

... noises from the ice/water dispenser can be regularly heard.

This is not a fault.
The ice cube separating function is active. The spindle in the ice cube container moves at regular intervals to separate the ice cubes and prevent them from freezing together and blocking the dispensing spout.

... water is pouring out of the appliance.

- Turn off the tap immediately.
- Check whether the water pipework inside the appliance is damaged.
Call Miele.
- Check whether there is sufficient water pressure.
- Check whether the correct valve was fitted.

... "_F" and "121" appear alternately in the temperature display.

There is no water coming into the ice cube maker.

- Check whether the appliance is correctly connected to the mains water supply.
- Check whether the water inlet is open.

... a fault message with "_F" appears in the temperature display.

There is a fault. Call Miele.

... the interior lighting is not working.

Has the appliance door been left open for too long? To avoid overheating, the lighting switches itself off automatically after approx. 5 minutes if the door is left open. It will come on again after it has cooled down sufficiently.

If the lighting does not come on when the door is opened briefly, then the lighting is defective.

- Switch the appliance off by pressing the On/Off rocker switch.
- Disconnect the appliance from the mains. Switch off at the wall and withdraw the plug from the socket, or disconnect the mains fuse or remove the screw-out fuse in countries where this is applicable.

Top lighting:

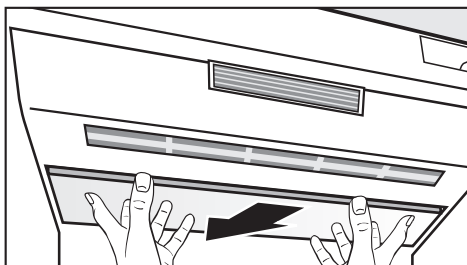

- Hold the lamp cover at the front with both hands and push it back.
- Then lift the lamp cover forwards to remove.

Do not touch halogen lamps with your bare fingers. Use a soft cloth when changing a halogen lamp.

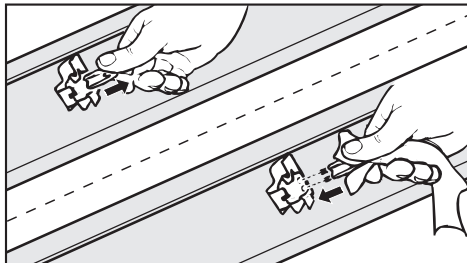

- Pull the defective halogen lamp out.
- Fit the new lamp into the holder. The following type of halogen lamp is required:
20 W/12 V/ GY 6.35 cap.
- Engage the lamp cover at the back, then pull it forward and click it into place at the front.

Problem solving guide

Side lighting:

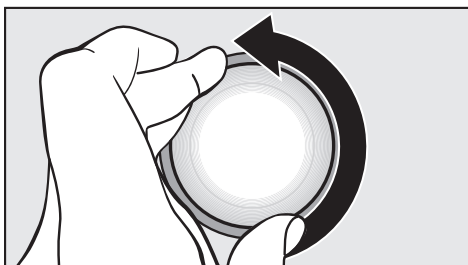

- Turn the lamp cover anti-clockwise to remove it.

Do not touch halogen lamps with your bare fingers.
Use a soft cloth when changing a halogen lamp.

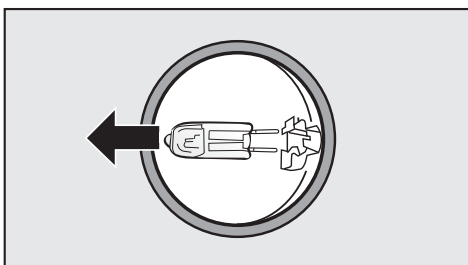

- Pull the defective halogen lamp out.
- Fit the new lamp into the holder.
The following type of halogen lamp is required:
5 W/12 V/ G 4 cap.
- Replace the lamp cover, turning it clockwise as far as it will go.
- Reconnect the appliance to the electricity supply and switch it on.

If you still cannot remedy the fault having followed these suggestions, please contact Miele. However, a call-out charge will be applied for unnecessary service visits where the problem could have been rectified as described in these operating instructions.

To prevent unnecessary loss of temperature, it is advisable not to open the door while waiting for the appliance to be serviced.

The appliance is supplied with a standard water filter that filters mains water for making ice cubes.

The installed water filter (bypass filter) can be replaced by a water filter with active charcoal particles. The water filter with active charcoal particles filters out chlorine and other distasteful substances from tap water so that only high quality water is used for producing ice cubes.

New water filters (bypass and active charcoal filter) can be obtained from your Miele Chartered Agent or Miele.

To ensure the quality of the ice cubes remains high, it is essential to change the water filter regularly.

Please note:

- All ice cubes that are produced in the 24 hours after you have changed the water filter should be discarded.
- If you have not used the appliance or the ice cube maker much in the last few weeks, or if the ice cubes smell unpleasant, fit a new water filter.

Reminder to change the water filter

Depending on the amount of ice cubes being made, the water filter will need to be changed approx. every six months.



- When the reminder to change the water filter **lights up** red, this indicates that the filter will soon need to be changed.
- Make sure that you have a spare water filter ready to fit.

New water filters (bypass and active charcoal filter) can be obtained from your Miele Chartered Agent or Miele.

- When the reminder to change the water filter **flashes** red, this indicates that the filter needs to be changed now.

Water filter

To change the water filter

Air in the system can cause water to gush out and the filter to spring out when it is removed.

Take great care, therefore, when changing the filter.

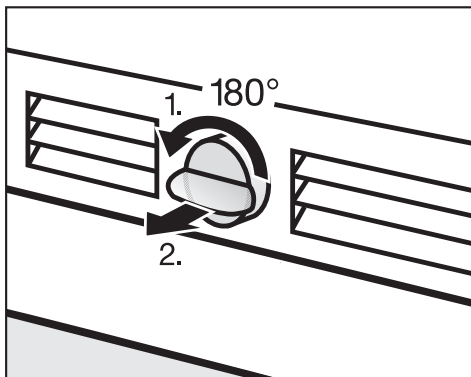

- Press the cap in and turn it 180° in an anti-clockwise direction (1).
- Remove the old filter cartridge (2).

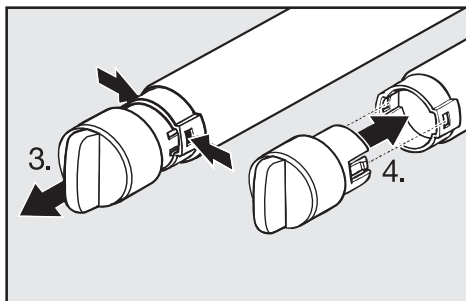

- Remove the cap from the old filter cartridge (3).
- Take the new filter cartridge from its packaging, and remove the protective cover.
- Fit the cap on the new filter cartridge (4).

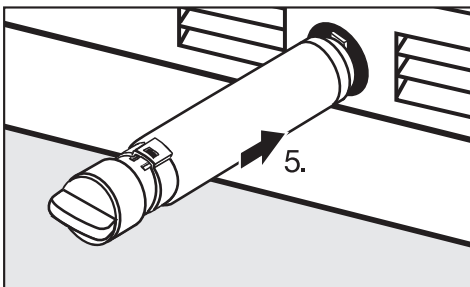

- Push the filter cartridge back into the opening, ensuring that it is straight (5).
- Turn the cap 180° in a clockwise direction until it is horizontal (6).



- After the filter has been changed, the reminder to change the filter will continue to flash in the control panel. Confirm that the filter has been changed (see "To confirm the water filter has been changed").

To confirm the water filter has been changed



- Touch and keep your finger on the symbol that reminds you to change the water filter.



- Then place another finger on the access sensor (without moving your finger from the water filter symbol) and leave both fingers there for approx. 5 seconds until you hear a tone.

The replacement of the water filter has now been confirmed and the prompt to remind you of the next water filter change has been activated.

The reminder to change the filter will now go out in the control panel.

- Close the appliance door.

All ice cubes that are produced in the 24 hours after you have changed the water filter should be discarded.

Using an external water filter

If you have already installed an external water filter in your home, still leave the water filter (bypass filter) in place that is supplied with the appliance.

Noises

Normal noises	What causes them
Brrrrr ...	A humming noise is made by the motor (compressor). This noise can get louder for brief periods when the motor switches on.
Blubb, blubb ...	A gurgling noise can be heard when coolant is circulating through the pipes.
Click ...	Clicking sounds are made when the thermostat switches the motor on and off.
Sssrrrrr ...	On multi-zone and frost-free appliances you can sometimes just hear the movement of the fan inside the appliance.
	On appliances with a water tank a buzzing sound can be heard when water is being pumped out of the water tank.
Crack ...	A cracking sound can be heard when materials expand inside the appliance.

Remember that the noise of the compressor and the coolant circulating in the system is unavoidable.

Noises that you can easily rectify	Possible cause	Remedy
Rattling, vibrating	The appliance is uneven.	Realign the appliance using a spirit level, by raising or lowering the screw feet underneath the appliance.
	The appliance is touching another appliance or piece of furniture.	Move it away.
	Drawers, baskets or shelves are unstable or sticking.	Check all removable items and refit them correctly.
	Are any bottles or containers unstable or knocking against each other?	Separate them.
	The transport cable clips are hanging loose at the back of the appliance:	Remove the cable clips.

In the event of a fault which you cannot correct yourself, please contact:

- Miele

See back cover for contact details.

When contacting Miele, please quote the model and serial number of your appliance.

This information is given on the data plate inside your appliance.

Warranty

The manufacturer's warranty for this appliance is 2 years.

For more information on the manufacturer's warranty specific to your country, please contact Miele.

See the end of this booklet for contact details.

Information for test institutes

All tests must be carried out according to **the applicable standards and regulations**.

In addition, the following information provided by the manufacturer must be observed:

- **Loading instructions,**
- Information contained in the **Operating and installation instructions.**

Notes on connecting to the mains water supply

Connection to the mains water supply should only be carried out by a qualified and competent person in accordance with national and local regulations.

Before plumbing the appliance in, ensure that it is disconnected from the mains electricity supply.

Turn off the water supply at the tap before connecting the water inlet hose for the ice cube maker.

The water quality must conform to the requirements for drinking water in the country in which the appliance is being installed.

This appliance has to be installed in accordance with AS/NZS 3500.1 and AS/NZS 3500.2. Back flow prevention is already integrated in the appliance.

- This appliance meets the requirements of IEC 61770 and EN 61770.
- The water pressure (flow rate) must be between 1.7 bar (170 000 Pa) and 5.5 bar (550 000 Pa).
- Use the hoses supplied with the appliance. Old or used hoses must not be connected to the appliance.

Warning!

If the supply water pressure is greater than 5.5 bar, make sure to install a pressure reducing valve to ensure 5.5 bar is not exceeded. Do not connect the appliance to the water supply or operate the appliance if supply water pressure is greater than 5.5 bar.

- The stainless steel hose is 3 m long. An extension of the stainless steel hose is not permitted.

Replace the stainless steel hose if it is defective. It must only be replaced by an original Miele hose (available from Miele). Please note that this hose is suitable for conveying drinking water.

- A tap must be provided between the stainless steel hose and the household water supply to ensure that the water supply can be disconnected if necessary.

The tap should be easily accessible after the machine has been built in.

Mains water connection

Preparing for plumbing the appliance into the mains water supply

Plumbing connections must be correctly in place before the appliance is built in.

Before making plumbing connections, ensure the appliance is disconnected from the mains electricity supply.

Connection to the mains water supply should incorporate a mains tap with a $\frac{3}{4}$ " thread.

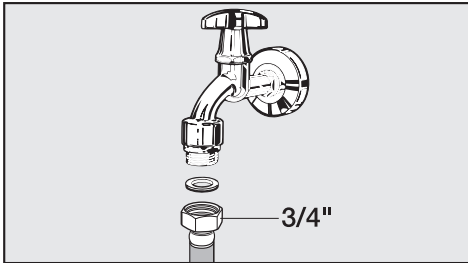

- Connect the stainless steel hose to the tap.
- Ensure that it is screwed into position correctly.

The appliance must only be connected to a cold water pipe that

is directly connected to the fresh water supply in order to ensure circulation of the water in the cold water pipe.

Avoid using a water inlet in which the water is allowed to pool. This can affect the taste of water and ice cubes.

- maintains working pressure.
- meets hygiene regulations.

Mains water connection

Before using the appliance for the first time, the water inlet pipe should be purged of air by a qualified and competent person:

- To do so the stainless steel hose should be filled as much as possible with water before being connected to the appliance.
- Mop up any spillages with a cloth.

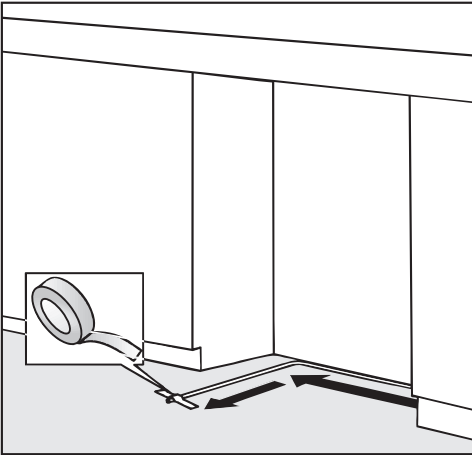

- Place the stainless steel hose in the building-in niche as shown, and secure to the floor with adhesive tape.

This ensures that the hose does not slip or get caught when the appliance is pushed back into the niche.

- The appliance can now be installed in the niche (see "Installation").

On appliances with a feed-through for the water inlet hose,

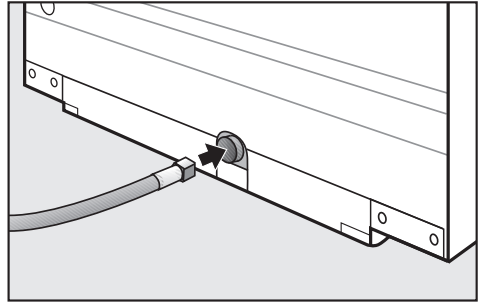

- position the appliance in front of the building-in niche and insert the stainless steel hose into the feed-through at the back of the appliance.

By this time the building-in niche should already have been prepared so that the appliance need only be pushed into it (see "Installation").

- Continue with the installation of the appliance.

Mains water connection

Fitting the stainless steel hose to the appliance

When fitting the stainless steel hose, make sure that it is neither kinked nor damaged.

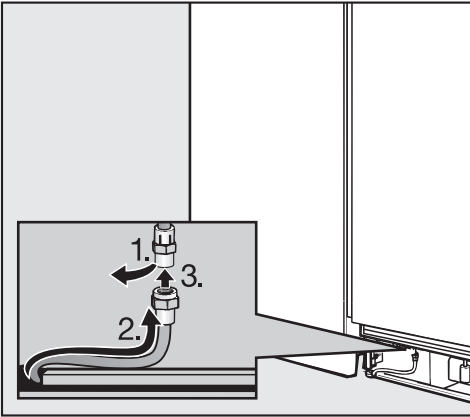

- Remove the cap (1.) from the water connection at the front of the appliance.
- Screw the stainless steel hose coupling nut (2.) onto the threaded union (3.).
- Ensure that all connections are water tight.
- Turn on the tap slowly and check the whole water system for leaks.
- The appliance can then be connected to the electricity supply (see "Electrical connection").

After a maximum of 10 hours, the first ice cubes will drop out of the ice cube maker and collect in the container.

All electrical work should be carried out by a suitably qualified and competent person in strict accordance with current local and national safety regulations.

The appliance is supplied with a mains cable and moulded plug ready for connection to an AC single phase 220 – 240 V 50 Hz supply.

The fuse rating must be at least 10 A.

The voltage and frequency are given on the data plate. Please ensure that these match the household mains supply. Connection should be made via a suitable switched socket which is easily accessible. For extra safety it is advisable to install a suitable residual current device (RCD).

The accessibility of the plug must always be ensured in order to be able to quickly separate the appliance from the mains.

If the mains socket is not accessible after the appliance has been built in, a separator for each terminal must be available. There must be an all-pole contact gap of 3 mm in the switch.

The plug and mains connection cable must not come into contact with the back of the appliance as vibrations can cause damage to these components. This, in turn, could result in a short circuit.

Nor should other appliances be plugged into a socket located directly behind the appliance.

Do not connect the appliance to the mains electricity supply by an extension lead or a plug adapter. Extension leads do not guarantee the required safety of the appliance (e.g. danger of overheating).

Do not connect the appliance to an inverter such as those used with an autonomous energy source e.g. **Solar power**.

When switched on, peak loads in the system can cause the safety switch off mechanism to be triggered. This can damage the electronic unit.

The machine must not be used with so-called **energy-saving devices** either. These reduce the amount of energy supplied to the machine, causing it to overheat.

If the mains connection cable needs to be replaced, this must only be carried out by a qualified electrician.

WARNING
THIS APPLIANCE MUST BE
EARTHED

Installation advice

Location

This appliance should be installed in a dry, well-ventilated room. It should not be installed where it is exposed to direct sunlight or directly adjacent to a heat-producing appliance such as an oven or a radiator. The room temperature should not go above or below the climate range for which the appliance is designed.

The higher the ambient temperature of the room, the more energy the appliance requires to operate.

If installation near a heat source is unavoidable, observe the following minimum distances between the appliance and the heat source:

- 3 cm away from an electric oven or cooker
- 30 cm away from an oil or coal-fired range.

Please note the following when installing the appliance:

- The mains connection socket must not be located directly behind the appliance and must be easily accessible.
- The plug and mains connection cable must not come into contact with the rear of the appliance as they may be damaged by vibrations from the appliance.
- Nor should other appliances be plugged into a socket located directly behind this appliance.

Important: tropical / humid environments

During periods of high humidity, some condensation may appear on outside surfaces of cooling appliances. This condensation will disappear when humidity levels drop. For prevention, it is advisable to install the appliance with sufficient ventilation in a dry and/or an air-conditioned room.

Please ensure that doors are closing and sealing properly.

Please ensure that the appliance is installed in accordance with these installation instructions and that the handle is fitted correctly. Should you require further assistance please contact Miele.

Climate range

The appliance is designed for use within certain climate ranges (ambient temperatures), and should not be used outside this range. The climate range of the appliance is stated on the data plate inside the appliance.

Climate range	Ambient room temperature
SN	+10 °C to +32 °C
N	+16 °C to +32 °C
ST	+16 °C to +38 °C
T	+16 °C to +43 °C

Operating in a room which is too cold will result in the cooling system switching off for too long, causing the internal temperature in the appliance to rise with the risk of food deteriorating and going off or frozen food defrosting.

Safe operation of the appliance is only assured if it has been installed and connected in accordance with these operating and installation instructions.

Warning!

This appliance is very heavy and can tip forwards when the door is open. Keep the door shut until the appliance has been built in and secured within the building-in niche in accordance with these instructions.

Due to the size and weight of the appliance, installation must be carried out by two people.

The weight of the appliance when empty is:

F 1471 Vi 139 kg

Floor

To ensure the safe installation of the appliance and to guarantee its correct functioning, the floor in the niche where the appliance is to be installed must be smooth and even.

It must be made from strong, rigid material.

The appliance is extremely heavy when fully loaded, and for this reason it is imperative that the floor it stands on is able to bear its weight. If necessary, the advice of an architect or structural engineer should be sought.

When fully loaded, the approx. weight of the appliance is:

F 1471 Vi 228 kg

Door hinging

The appliance is supplied with fixed hinges. It is not possible to change the door hinging to the other side.

Adjoining furniture/units

The appliance is screwed to the adjoining furniture/units to the side and above.

For this reason, it is essential that all furniture/units be fixed to the ground and/or wall.

Ventilation

The air vents must not be covered or blocked in any way.
They should be dusted on a regular basis.

Installation advice

Side-by-side installation

This appliance may be installed "side-by-side" with another suitable refrigerator or freezer.

A side-by-side installation kit, available from Miele, is required. Ask your Miele Chartered Agent which appliances are suitable for side-by-side installation with this appliance.

See the instructions supplied with the side-by-side installation kit for how to fix the appliances together.

The side-by-side installation kit will consume additional energy to that stated on the appliance energy label of each individual appliance. The additional rating per appliance will be 25 W or 219 kWhrs per year.

Joining the appliances together without a partition wall using the side-by-side installation kit

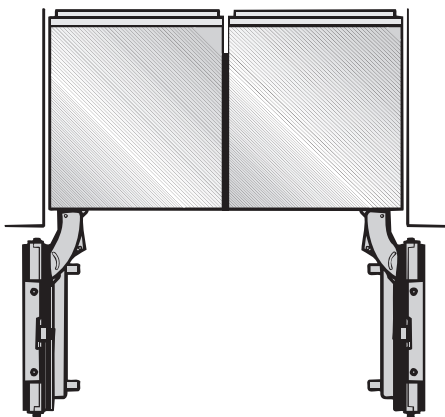

If the appliances are to be installed next to each other without a partition

wall between them, they will need to be joined together with the side-by-side installation kit.

Installation with a partition wall using the side-by-side installation kit

The partition wall must be at least 16 mm thick.

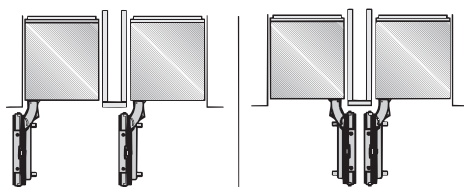
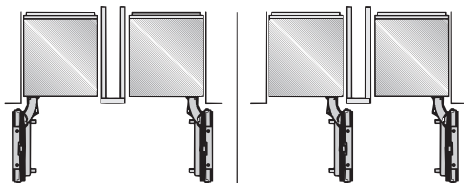

If the partition wall between the two appliances is **between 16 mm and 160 mm** thick, each appliance must be built into its own niche using the assembly parts supplied. The side-by-side installation kit is also required.

Installation with a partition wall without the side-by-side installation kit

If the partition wall between the two appliances is **more than 160 mm** thick, each appliance must be built into its own niche using the assembly parts supplied (without using the side-by-side installation kit).

Appliance door dimensions (opening angle 115°)

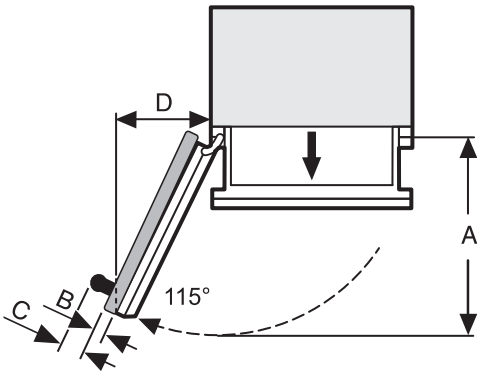

	A	B	C	D
F 1471 Vi	525 mm	Door front (max. 38 mm)*	Door handle*	234 mm

* The dimensions of the door fronts and handles will vary according to the individual kitchen.

Miele recommends using the complete door opening angle of 115° with this freezer.

Building-in dimensions

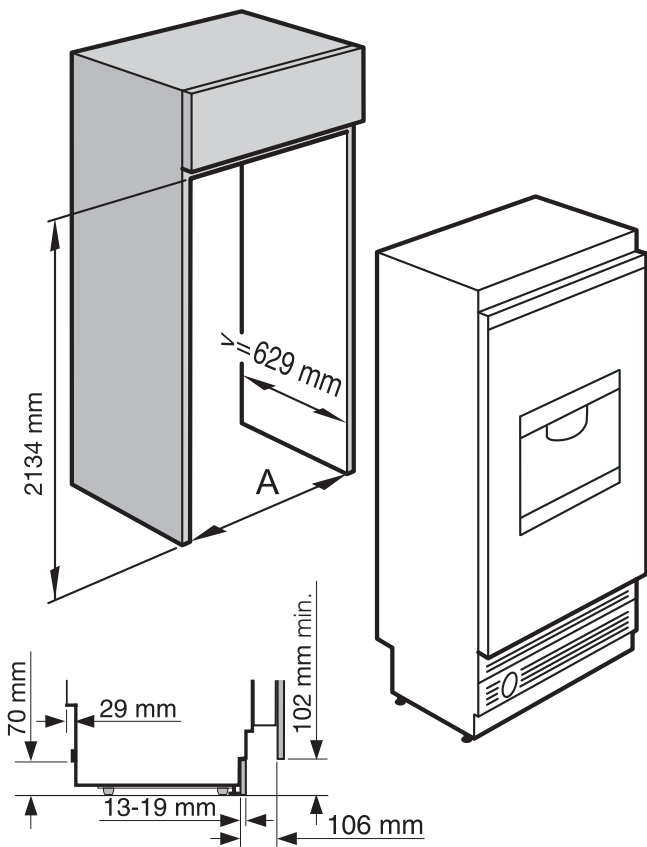

	Niche width A
F 1471 Vi	457 mm – 460 mm

Laying the electrical cabling and the pipework for the mains water supply

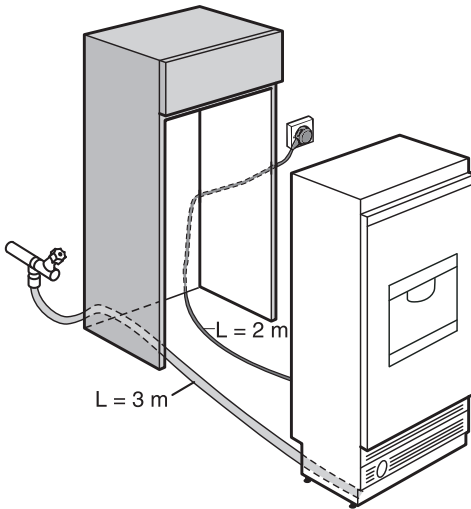

Door front dimensions

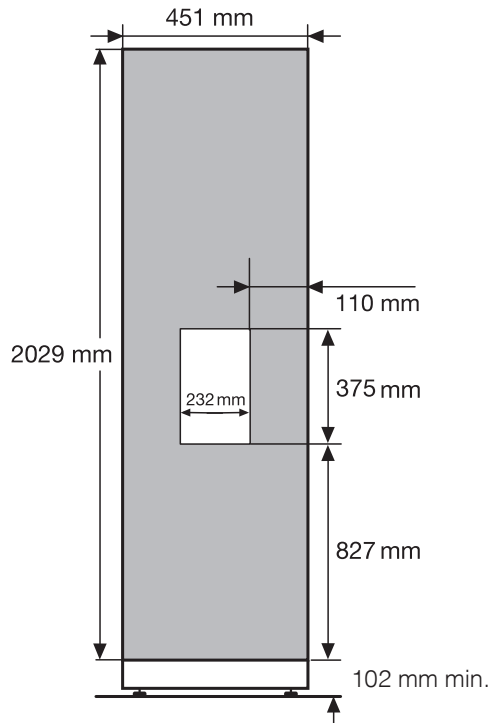

Installation

Due to the size and weight of the appliance, it is essential that installation is carried out by two people.

Tools and accessories required

- Power drill
- TX screwdriver
- Hammer drill
- Drill bits in various sizes, depending on materials
- Hammer
- Socket wrench (Attachment: nut, 8 mm)
- Adhesive tape
- Pipe wrench
- Spirit level
- Try-square

If bolting the housing unit to the wall behind:

- suitable plugs and fixing screws according to the composition of the wall
- several fixing brackets, if required

Other

- Step ladder
- Sack barrow
- Wooden beam (min. 75 mm x 100 mm) if required, to prevent tipping; length depends on width of building-in niche
- Wood screws in various sizes

Optional accessories

- Side-by-side installation kit for side-by-side installation of two appliances

Stainless steel fronts

Stainless steel fronts and plinth grilles with a stainless steel look are available from Miele.

Weight of the furniture door front

Before fitting a furniture door front, ensure that the weight of the door does not exceed the maximum permitted.

Appliance	Max. weight of door front in kg
F 1471 Vi	65

Fitting a door which is heavier than the maximum permitted could damage the hinges.

Building into a peninsular run

When built into a peninsular run, the rear of the building-in niche must be fitted with a kitchen furniture panel.

Building-in at the end of a run of units

If one side of the appliance is visible, a side panel is required.

The side panel must be fixed to the wall, the floor and any furniture/units above before the appliance is placed in the niche.

The size of the side panel must match that of the furniture panel opposite.

Installation

Aligning the housing unit

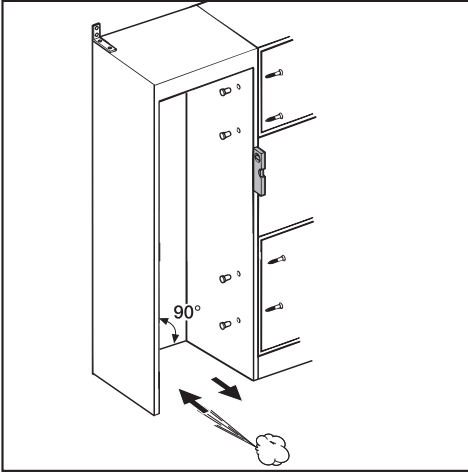

The housing unit must be carefully aligned using a spirit level before installing the appliance. The unit corners must be at right angles, as otherwise the furniture door will not align correctly with the 4 corners of the appliance.

- The side panels of the housing unit must be even.
- The housing unit panels must be at least 16 mm thick.
- The plinth facing must be at least 13 mm thick (or preferably 19 mm).

Checking the building-in niche

- The building-in dimensions now need to be checked.
- Check the position of the electrical and plumbing connections (see "Electrical connection" and "Mains water connection").
- Check that all surrounding furniture/units are securely fixed to the wall.
- Check the surrounding furniture/units for possible clashes when opening doors.

Before installation



Warning!

This appliance is very heavy and can tip forwards when the door is open.

- Before installation, take any accessories out of the appliance and/or from the back of the appliance.
- Remove any cable clips from the back of the appliance.
- Check that all parts at the back of the appliance are unhindered. Carefully remove any hindrance.

To protect the floor from damage when installing the appliance,

- secure an off-cut of flooring (e.g. lino) or similar to the floor in front of the installation area.

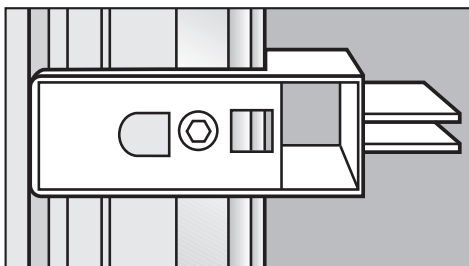

The appliance can be rolled along the floor using the wheels at the back.

Preparing the niche

 Keep the door to the appliance closed until it is fixed inside the building-in niche.

Due to the sheer size and weight of the appliance, it needs to be ensured that it cannot tip forwards once it is built into the niche.

Assembly parts

All the fixings required for installation are supplied with the appliance. The plastic packets are marked with letters for easy identification.

Each fitting stage is indicated by the letter on the bag needed for that stage.

- Do **not** remove the installation aids from the appliance door. These will be required later when the appliance is installed in the building-in niche.
- Check the appliance for damage during transportation.

Do not install a damaged appliance!

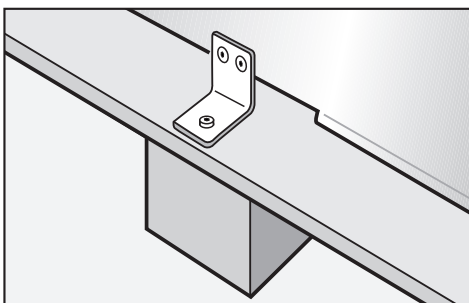

- Unscrew the bracket that is holding the appliance to the delivery pallet.

 **Warning!**
Please bear in mind that the appliance is no longer secured to the pallet!

- With the help of several people as required, carefully lift the appliance from the pallet, starting with the back of the appliance.

Installation

Anti-tipping mechanism

The anti-tipping mechanism ① ensures the housing unit ② is securely fixed to the wall and tipping of the appliance is prevented.

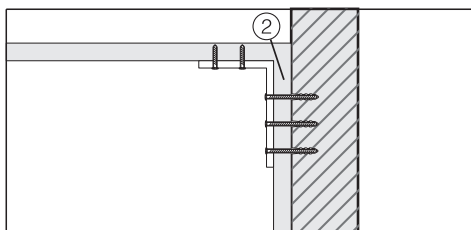
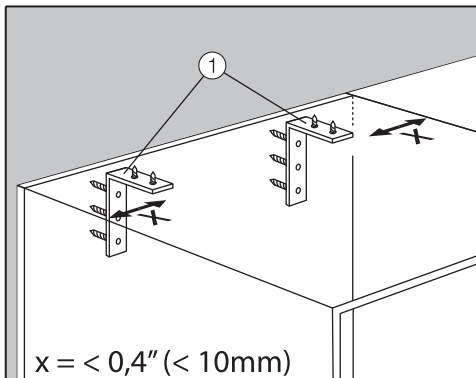

Danger of tipping

The housing unit must be fixed to the wall behind with several screws. Only this can ensure that the appliance will not tip over after being installed.



- Position the anti-tipping mechanisms ① at the rear of the housing unit on the left and right, leaving a gap to the wall of no more than 10 mm.
- While holding the anti-tipping mechanisms in place, mark the necessary drill holes at the top and rear of the housing unit.
- Put the anti-tipping mechanisms in a safe place - they will be required later.

Fixing screws for different uses and types of material are supplied in the accompanying pack.

If these are not suitable for the anti-tipping mechanism in your installation, you will need to secure it by alternative means.



- Secure the housing unit to the wall.

Use two anti-tipping mechanisms for each appliance or four for each side-by-side combination of appliances.

An alternative anti-tipping mechanism

If it is not possible to fix the anti-tipping mechanisms securely to the floor of the niche, the appliance can be secured at the top using a wooden beam. If this method is used, then there must not be any gap between the appliance and the wooden beam.

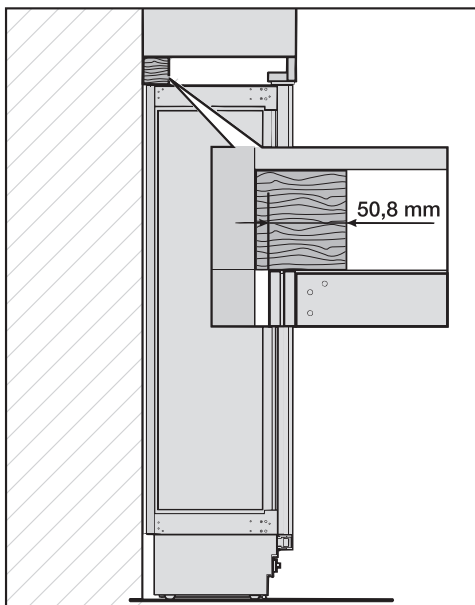

- Mark the position of the lower edge of the wooden beam on the rear wall of the niche.
- Select screws of a length depending on the thickness of the wood.

Use the number of screws appropriate to the housing width to ensure that the wooden beam is securely fixed.

- Check where the upright wall supports are in the back of the niche, and mark the drill holes in the wooden beam accordingly.
- First, drill the holes in the wooden beam.
- Secure the wooden beam to the back wall of the niche.

Now prepare the mains water connection for the appliance (see "Mains water connection").

- The wooden beam must be at least 75 mm x 100 mm thick.
- The length of the beam must be the same as the width of the building-in niche.
- If the building-in niche is deeper than the appliance, a thicker wooden beam should be used.
- The wooden beam must cover the appliance to a depth of at least 50.8 mm (see diagram).

Installation

Placing the appliance in the niche

If you are installing two appliances side by side, now secure the appliances to one another (see the instructions for the side-by-side installation kit).

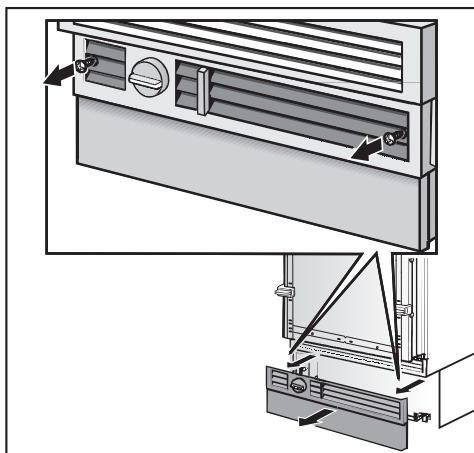

- Unscrew the plinth facing.

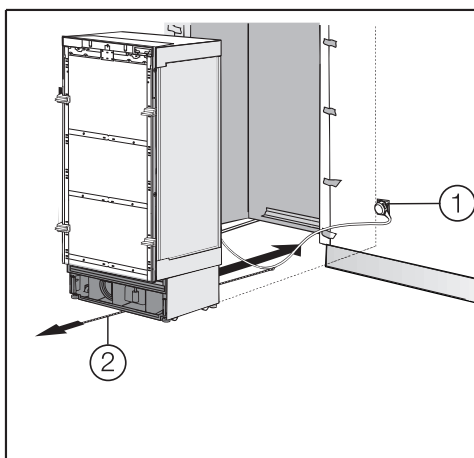

- Affix temporary protection to adjacent furniture fronts.

- Plug in the appliance ①.

Connection should be made via a suitable switched socket. The socket should be close to the appliance and easily accessible.

When installing two appliances side by side, each appliance must have its own separate socket.

- Secure the cable to prevent it becoming caught:
Tie a piece of string to the middle of the cable, and as the appliance is being pushed into the niche, pull the cable forward underneath the appliance ②.
- Carefully slide the appliance into the housing unit.

If the appliance does not slide easily into the niche (e.g. if the floor is uneven),

- screw out the rear feet slightly (see "Aligning the appliance") and slide the appliance into the niche.

Then push the appliance into the niche, taking care not to damage the electrical and mains water connections.

- Remove the temporary protection from the adjacent furniture fronts.

Aligning the appliance

- Align the appliance with neighbouring furniture fronts.

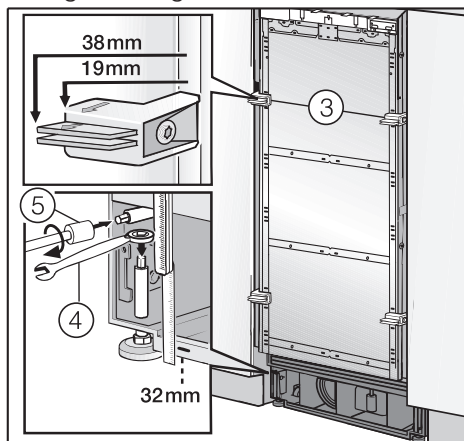

The installation aids ③ on the appliance door are suitable for a thickness of 19 mm or 38 mm.

The adjustable feet at the front and back of the appliance can all be adjusted from the front:

- Front feet:
Adjustment from above with a socket wrench (attachment: nut, 8 mm) ④
- Back feet:
Adjustment with a power drill or socket wrench (attachment: nut, 8 mm) for fine adjustment ⑤

- Place a spirit level across the installation aids ③ on the appliance door to check the appliance's alignment.

Important!

Proceed carefully when adjusting the feet, alternating between the left and right feet.

- A mark is located on the appliance base. When adjusting the height, this mark needs to be aligned at 32 mm from the floor. Unscrew the feet until the mark on the base has reached 32 mm. This measurement of 32 mm corresponds to a building-in recess height of 2134 mm.

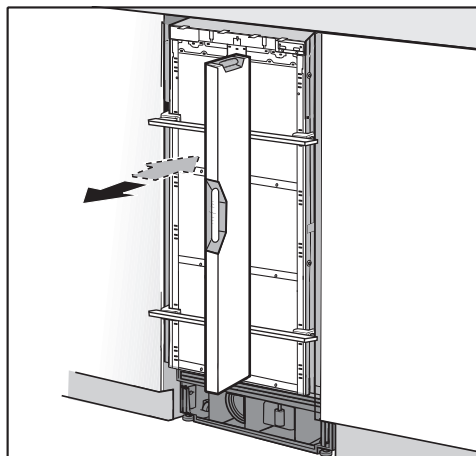

- Check the alignment of the appliance again using the spirit level.
- If a wooden beam has been fitted above the appliance to prevent tipping, the appliance height needs to be adjusted so that the appliance fits snugly under the wooden beam.

Installation

Securing the appliance in the niche

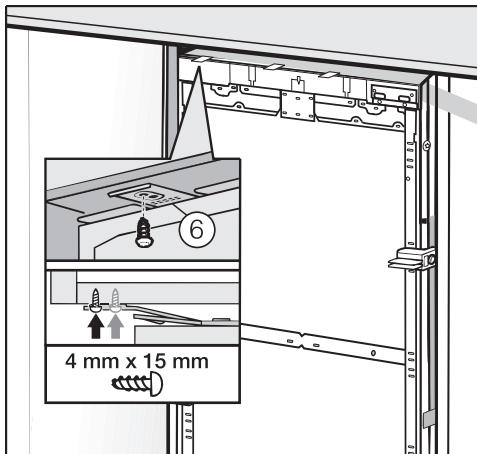

- Screw the lugs for the fixing plate ⑥ into the furniture/units above the appliance.

If it is not possible to secure the appliance above, it can be attached to the housing at the sides only:

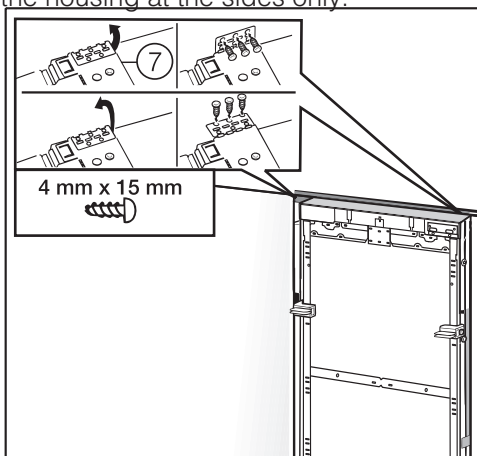

- Pull out the lugs for the side fixing plates ⑦.



- Screw on the lugs for the side plates.

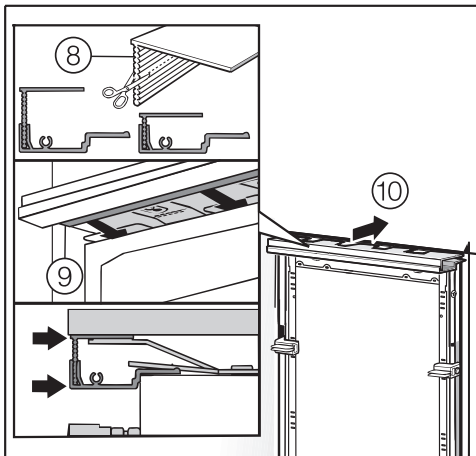

- If necessary, cut the trim ⑧ to the necessary width.
- Join the two bits of trim together ⑨
- Click them into position ⑩

When installing two appliances **side by side**, the trims for the two appliances need to be joined together to form one long strip:

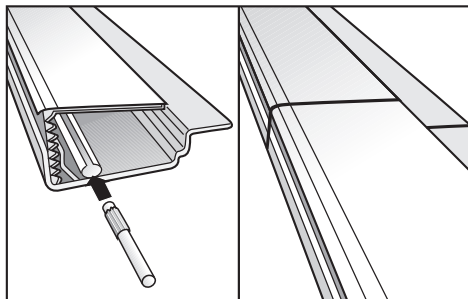

- Insert the joining peg from the side-by-side kit halfway into the channel in the trim for the left-hand appliance.
- Then insert the free half of the joining peg into the channel on the other trim, and press the two trims together.
- Click the two trims into place above the appliances.

- Open the appliance door.

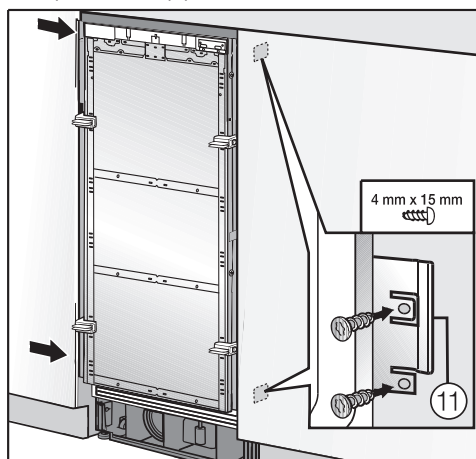

- Screw the lugs for the fixing plates ⑪ at the bottom and top of the furniture/units adjacent to the appliance.

In a side-by-side combination, only the external panels of the two appliances can be secured to the furniture wall.

Connect the water inlet hose to the appliance (see "Mains water connection").

Installation

Preparing the furniture fronts

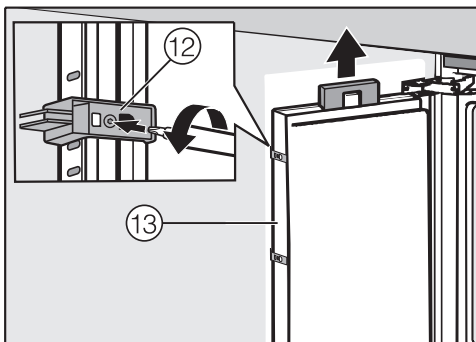

- Load the door basket.
- Open the appliance door as far as it will go.
- Unscrew the installation aids ⑫ and the angle trim ⑬ from the appliance door.
- Put the angle trim ⑬ and screws in a safe place - they will be required later.
- Remove the cover from the light contact switch.
- Close the appliance door.

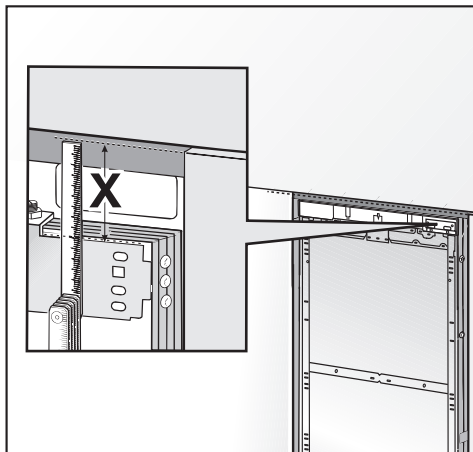

- Measure the gap **X** between the adjusting bar and the upper edge of the adjacent furniture front.
- Remove the two nuts from the appliance door, and place them in a safe place - they will be required later.
- Place the furniture front on a firm surface, with the external side facing downwards (place on a blanket or similar to avoid it becoming scratched).

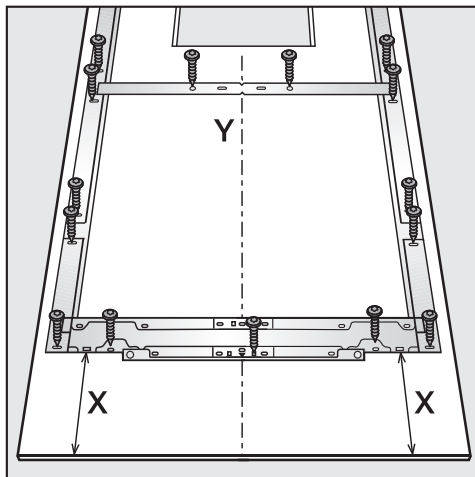

- The mounting frame has several different types of holes to take account of a variety of furniture fronts.
- When securing the frame, always screw into the strongest part of the furniture door.
- To do this, select screws which are slightly shorter than the thickness of the furniture door.
- Screw the appliance handle to the furniture door from the inside.

- Mark the gap **X** on the inside of the furniture front.
- Similarly, locate and mark the midpoint **Y** on the furniture front.
- Remove the mounting frame from the appliance door and position it according to the markings on the furniture front.
- Pre-drill the holes.
- Screw the mounting frame to the furniture front, using at least one screw for each fixing point.



- Secure the fixing frame to the top of the furniture front, using at least 6 screws:

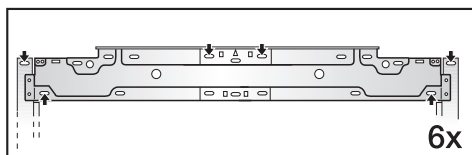

Installation

Securing and aligning the furniture door

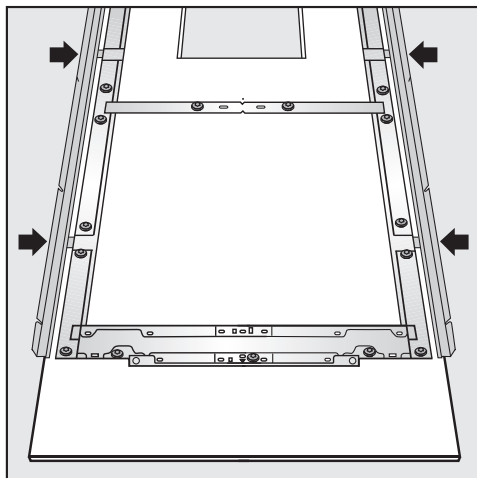

- Insert the angle trim (13) as far as it will go into the spaces in the frame, as shown.

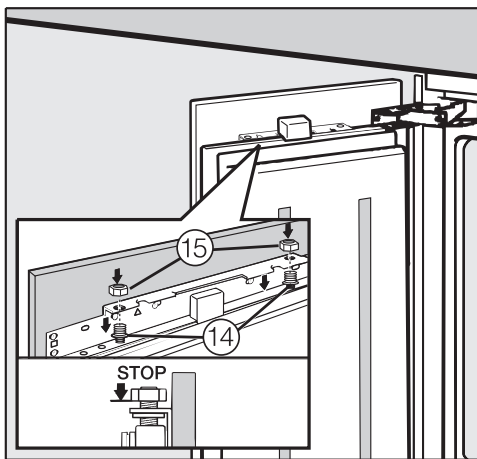

- Open the appliance door and hang the furniture front on its frame onto the threaded bolts, as shown (14).



- Press the angle trim (13) on both sides into the white plastic frame, and screw them down securely. Spare screws can be found in the plastic bag marked "E".
- Screw the nuts (15) loosely onto the threaded bolts, but do not tighten yet.
- Close the door and check the distance between the door and neighbouring furniture doors.

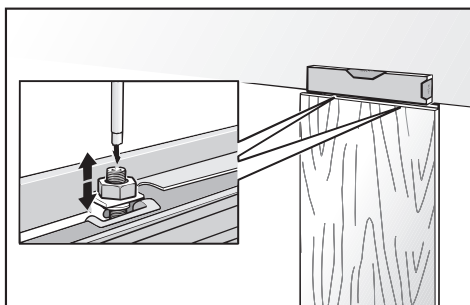

- Align the height of the appliance door by sliding it over the threaded bolts (14).
- Align the depth of the appliance door via the gaps in the angle trim (13). Then screw the angle trim into position.
- Now screw on the top nuts (15). The door is now fixed.

Securing the covers

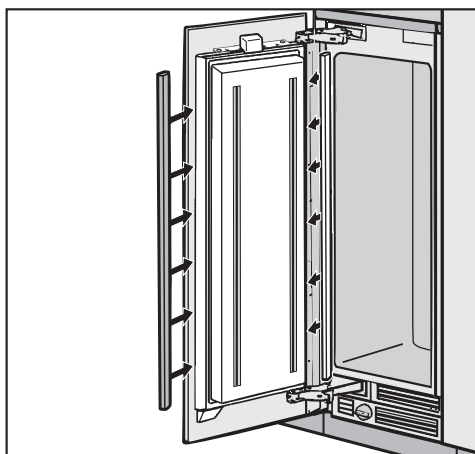

- Fit the two cover strips to both sides of the appliance door, clicking them into the space between the appliance door and the furniture front, starting at the bottom and working up to the top.

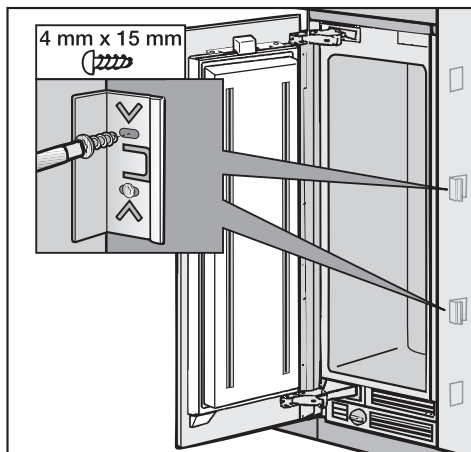

- Now attach the covers onto the retaining clips on both sides. In the case of side-by-side installation, the cover strips are only required on the outer side.

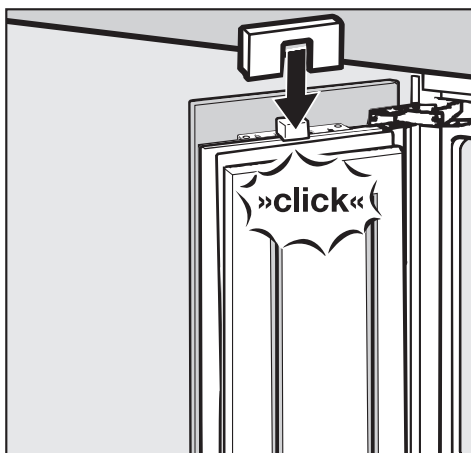
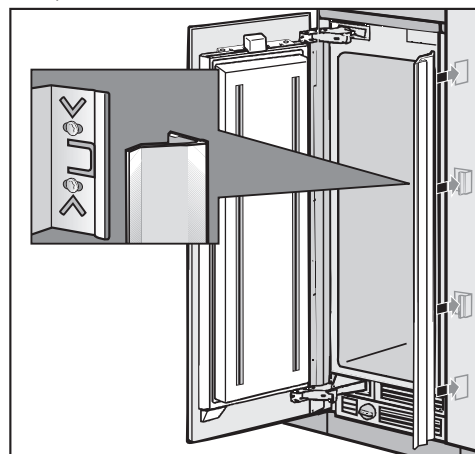

- Fit the cover to the light contact switch so that it clicks into place as shown.



- Secure the retaining clips for the covers on both sides.

Installation

Fitting the plinth facing

Do not cover the vents in the plinth. This will damage the appliance.

- Trim the plinth facing to the required length and height (cut along the lower edge of the plinth facing where it touches the floor).

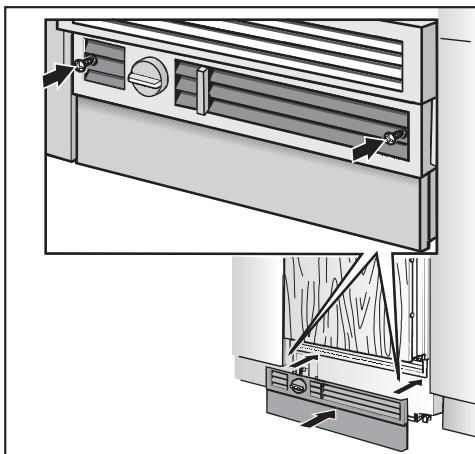

- Secure the plinth to the appliance, and attach the cover discs supplied.

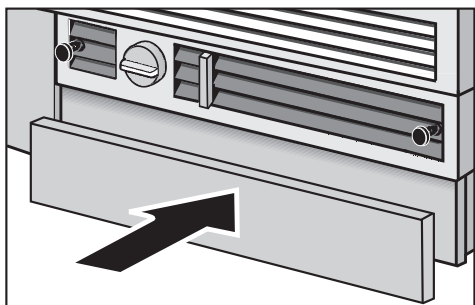

- Now fit the plinth facing.

Fitting the air separator

The air separator in the vent underneath separates air entering the appliance from that leaving it. It also stops warm air flowing into the appliance, which would cause a short circuit.

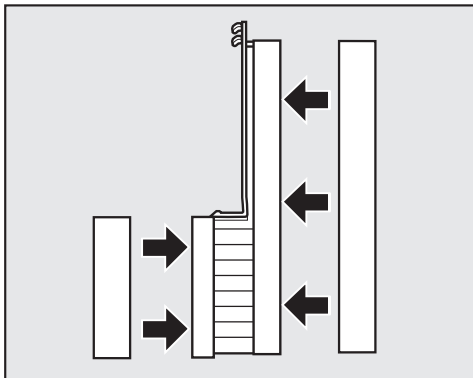

- If necessary, the three parts of the air separator can be shortened to the correct height.
- Refit the foam parts in the sides.
- Open the appliance door.

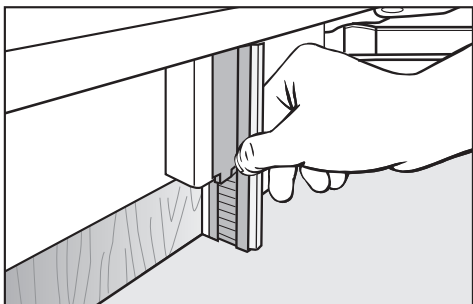

- Clip the air separator to the appliance door from below, making sure it clicks into position.

Aligning the ice/water dispenser

If necessary, the depth of the ice/water dispenser can be aligned to line up with the furniture front.

Disconnect the appliance from the mains. Switch off at the wall and withdraw the plug from the socket, or disconnect the mains fuse or remove the screw-out fuse in countries where this is applicable.

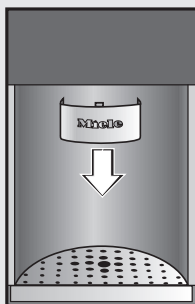

- Push the spout back and then pull it downwards to remove.

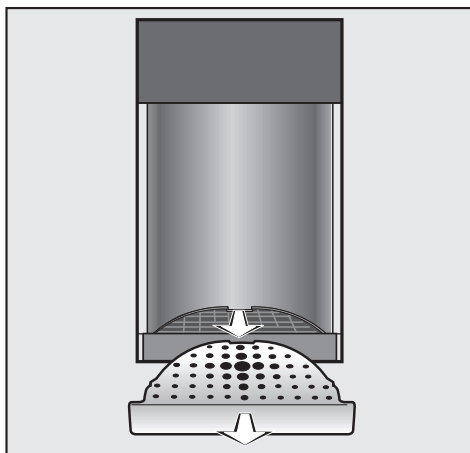

- Remove the drip tray cover and the grille.

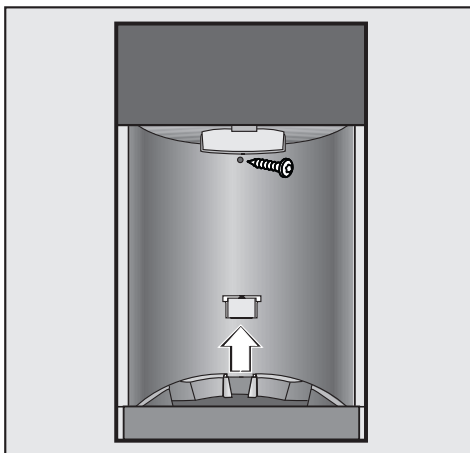

- Loosen the screw in the back cover.
- Pull the locking device up out of the drip tray.

Installation

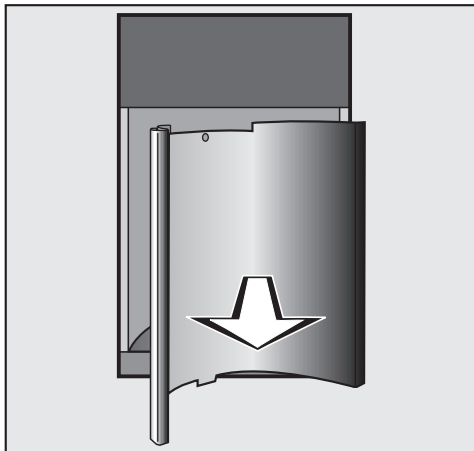

- Remove the back cover.

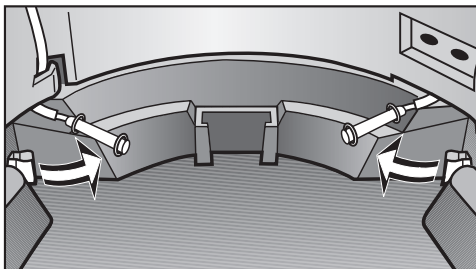

- Loosen the level sensors and carefully bend them upwards.

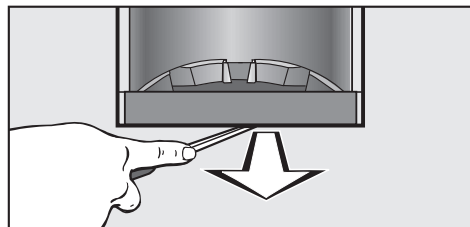

- Remove the drip tray. If necessary, use a screwdriver to gently lever it out.

Once the drip tray has been removed, you can align the position of the ice/water dispenser using the four metal strips.

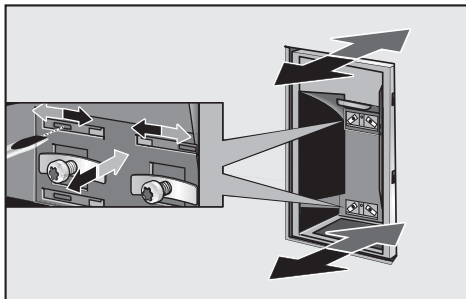

- Loosen the screws in the four metal strips.
- Then insert a screwdriver into one of the four slits and push the ice/water dispenser sideways until it is correctly aligned with the furniture front. The grey arrows indicate alignment to the rear and the black arrows show the alignment to the front.
- Tighten the screws in the four metal strips.
- Replace the drip tray and clip the level sensors back into position.
- Refit the rear cover and the locking device and then screw the rear cover back on.
- Replace the grille and the drip tray cover.
- Replace the dispenser spout.

Securing the ice/water dispenser frame

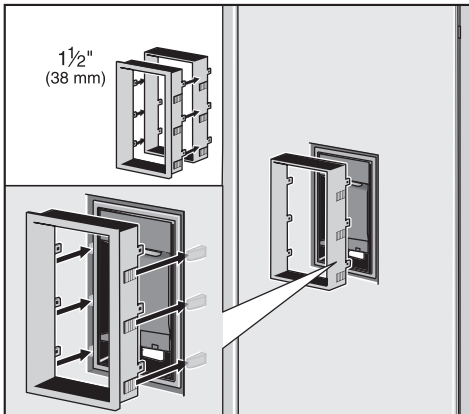

The word "TOP" is marked on the rear of the frame at the top.

With 19 mm thick furniture fronts:

- Fit the frame onto the ice/water dispenser and press it firmly into position so that it sits evenly with the furniture front.

With 38 mm thick furniture fronts:

- Fit the secondary trim to the frame.
- Fit the frame onto the ice/water dispenser and press it firmly into position so that it sits evenly with the furniture front.

Miele Australia Pty. Ltd.

ACN 005 635 398

ABN 96 005 635 398

**Miele Center and Head Office Melbourne:**

1 Gilbert Park Drive

Knoxfield, VIC 3180

Miele Center and Office Melbourne:

206-210 Coventry Street

South Melbourne, VIC 3205

Miele Center and Office Sydney:

3 Skyline Place

Frenchs Forest, NSW 2086

Miele Center and Office Brisbane:

39 Harvey Street North

Eagle Farm, QLD 4009

Miele Center and Office Adelaide:

83-85 Sir Donald Bradman Drive

Hilton, SA 5033

Miele Center and Office Perth:

205-207 Stirling Highway

Claremont, WA 6010

www.miele.com.au**Miele Appliances India Pvt. Ltd.**

Ground Floor, Copia Corporate Suites

Plot No. 9, Jasola

New Delhi – 110025

Tel: 011-46 900 000

Fax: 011-46 900 001

E-mail: customercare@miele.inInternet: www.miele.in**Miele New Zealand Limited**

IRD 98 463 631

Head Office:

Level 2, 10 College Hill

Freemans Bay, Auckland 1011

Miele Center Auckland:

8 College Hill

Freemans Bay, Auckland 1011

Telephone:

0800 4 MIELE (0800 464 353)

www.miele.co.nz**Miele Global Headquarters****Germany****Miele & Cie. KG**

Carl-Miele-Straße 29

33332 Gütersloh

Federal Republic of Germany

F 1471 Vi



en - AU, IN

M.-Nr. 10 083 160 / 02