

DGC 6660

XXL steam combination oven with fully-fledged oven operating mode – with motorised control panel and MultiSteam for discerning cooks.



- Perfect results thanks to MultiSteam technology
- It doesn't get bigger than this – the XXL cooking compartment
- Convenient – water container is behind a motorised control panel
- Custom & precise temperature control – cook with the food probe
- A plus for convenience – SensorTronic

Construction type	
Steam combination oven	•
Design	
PureLine	•
Colour	Stainless steel/Clean Steel
Display	SensorTronic
Convenience features	
Electronic oven temperature regulation in °C	30 - 225
Electronic steam oven temperature regulation in °C	40 - 100
External steam generation	•
Oxygen sensor	•
Individual humidity settings in combination cooking	•
Menu cooking without transfer of taste	•
Food probe	•
Automatic programmes with programmable settings for cooking results	•
Keeping warm	•
Operating modes	
Defrosting	•
Automatic programmes	More than 200
Combination cooking	•
Steam cooking	•
Sous-vide	•
Reheat	•
Economy grill	•
Fan plus	•
Intensive bake	•
Cake plus	•
Conventional heat	•
Top heat	•
Bottom heat	•
Fan grill	•
Special applications	•

DGC 6660

XXL steam combination oven with fully-fledged oven operating mode
– with motorised control panel and MultiSteam for discerning cooks.



User convenience	
MultiLingua	•
Motorised opening and closing Lift panel	•
Steam cooking on up to 4 levels at the same time	•
Automatic menu cooking with steam	•
Quantity-independent cooking	•
Steam reduction before end of programme	•
Time of day display	•
Date display	•
Minute minder	•
Clock buffer in h	200
Start-stop programming	•
Safety switch-off	•
Value entry via number pad	•
Actual temperature display	•
Recommended temperature	•
Buzzer when desired temperature is reached	•
User programmes	20
Sabbath programme	•
Individual settings	•
Door	
CleanGlass door	•
Door with viewing screen	•
Door hinge	Bottom
Oven compartment	
XXL oven compartment	•
Oven compartment volume in l	68
PerfectClean stainless-steel oven compartment	•
No. of shelf levels	4
Numbered shelf levels	•
Removable side racks with PerfectClean	•
No. of halogen lamps	double
Cleaning convenience	
Stainless steel front with CleanSteel finish	•
Oven compartment with PerfectClean	•
External steam generator	•
Soak programme	•
Rinse programme	•
Oven compartment drying programme	•
Quick-release side racks	•
Automatic descaling	•
Steam technology and water supply	
MultiSteam	•
Water reserve for approx. 90 min cooking	•
Fresh water container	•
Condensate container behind motorised fascia panel	•
Drain filter	•
Efficiency and sustainability	
Energy-saving lighting	•
Rapid heat-up	•

DGC 6660

XXL steam combination oven with fully-fledged oven operating mode
– with motorised control panel and MultiSteam for discerning cooks.



Safety	
Appliance cooling system and touch-cool fronts	•
Safety switch-off	•
System lock	•
Vapour cooling system	•
Door contact switch	•
Technical data	
Niche width in mm	560
Niche height in mm	593
Niche depth in mm	555
Appliance width in mm	595
Appliance height in mm	595
Appliance depth in mm	573
Weight in kg	52.0
Total rated load in kW	3.5
Voltage in V	230
Fuse rating in A	16
Number of phases	1
Standard accessories	
Number of universal trays with PerfectClean	1
Combi rack with PerfectClean	1
Side racks with PerfectClean	•
No. of perforated stainless-steel cooking containers	2
No. of solid stainless-steel cooking containers	1
Grease filter	•
Cookbook	•
Mains plug	•
Descaling tablets	•

DGC 6660

XXL steam combination oven with fully-fledged oven operating mode
– with motorised control panel and MultiSteam for discerning cooks.

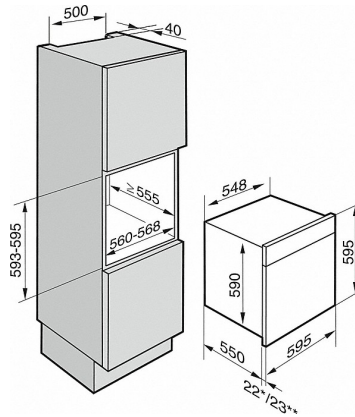

DGC 6000 built in wall unit, CLST (Installation drawing)

* Appliances with glass front
** Appliances with metal front

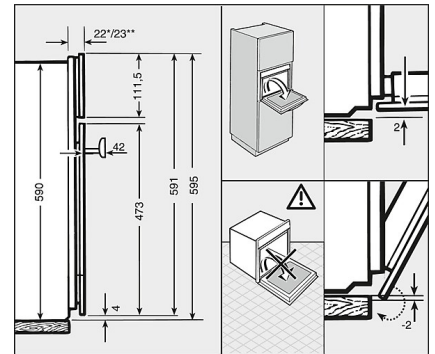

DGC 6000 XXL PureLine (detailed installation drawing)

* Appliances with glass front
** Appliances with metal front