

Installation instructions

External motor

Roof installation



To prevent the risk of accidents or damage to the appliance, it is **essential** to read these instructions before it is installed and used for the first time.

Contents

Warning and Safety instructions	3
Caring for the environment	9
Installation	10
Before installation	10
Installation recommendations	10
AWG 102	11
DDG 102	14
ABLG 202	17
DDF 125/150	19
Connection for air extraction	20
Silencer	21
After sales service and warranty	22
Position of the data plate	22
Warranty: Other countries	22
Electrical connection	23
Technical data	24
AWG 102	24
ABLG 202	25
DDG 102	26

Warning and Safety instructions

This external motor complies with all relevant local and national safety requirements. Inappropriate use can, however, lead to personal injury and damage to property.

Please read these operating and installation instructions carefully before using the appliance for the first time. They contain important information on the safety, installation, use and maintenance of the appliance. This prevents both personal injury and damage to the external motor. Miele cannot be held liable for damage caused by non-compliance with these instructions.

Keep these instructions in a safe place and pass them on to any future owner.

Correct application

- ▶ This external motor is intended for use in domestic households and similar working and residential environments.
 - ▶ This external motor must only be used in conjunction with a Miele "... EXT" model rangehood.
 - ▶ It must only be used to extract vapours and remove odours from cooking.
- All other types of use are not permitted.

Warning and Safety instructions

Technical safety

- ▶ Repairs and other work by unqualified persons could be dangerous. Installation, maintenance work and repairs to electrical appliances must only be carried out by a Miele approved service technician.
- ▶ A damaged external motor could be dangerous. Check the appliance for visible signs of damage. Do not use the external motor if it is damaged.
- ▶ The electrical safety of this appliance can only be guaranteed when continuity is complete between it and an effective earthing system. It is essential that this basic safety requirement is present and tested regularly. If in doubt, consult a suitably qualified electrician.
- ▶ Reliable and safe operation of this external motor can only be assured if it has been connected to the mains electricity supply.
- ▶ The connection data (voltage and frequency) on the data plate must match the mains electricity supply in order to avoid the risk of damage to the motor.
Compare this data before connecting the appliance to the mains. If in doubt, consult a suitably qualified electrician.
- ▶ Do not connect the downdraft extractor to the mains electrical supply by a multi-socket adapter or extension lead. These are a fire hazard and do not guarantee the required safety of the appliance.

Warning and Safety instructions

- ▶ For safety reasons, the external motor may only be used when it has been fully installed.
- ▶ This appliance must not be installed and operated in mobile installations (e.g. on a ship).
- ▶ Any contact with live connections or tampering with the electrical or mechanical components of the external motor will endanger your safety and may lead to appliance malfunctions.
Only open the housing as described in the installation instructions and in the "Cleaning and care" section of this booklet. Under no circumstances should any other parts of the housing be opened.
- ▶ The manufacturer's warranty will be invalidated if the appliance is not repaired by a Miele approved service technician.
- ▶ Faulty components must only be replaced by genuine Miele spare parts. The manufacturer can only guarantee the safety of the appliance when Miele replacement parts are used.
- ▶ If the mains connection cable is damaged, it must only be replaced by a Miele authorised service technician or suitably qualified electrician in order to avoid a hazard.
- ▶ During installation, maintenance and repair work, the appliance must be disconnected from the mains electricity supply. It is only completely isolated from the electricity supply when:
 - the mains circuit breaker is switched off, or
 - the screw-out fuse is removed (in countries where this is applicable), or
 - the plug is withdrawn from the socket. Do not pull on the cable, but pull the plug to do this.

Warning and Safety instructions

Using at the same time as another heating appliance that depends on the air from the room

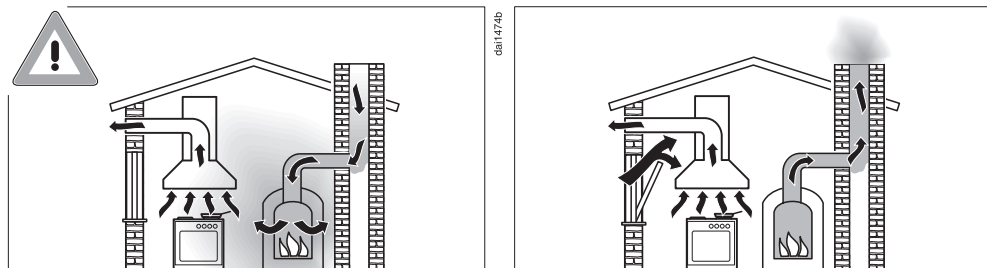

⚠ Danger of toxic fumes!

Great care should be taken when using the external motor in the same room or the same area of the house as another heating appliance that depends on the air from the room.

Such heating appliances draw in air from the room and duct exhaust gases out through a chimney or extraction ducting. They include gas, oil, wood and coal-fired boilers and heaters, continuous flow or other water heaters, gas cooktops and ovens.

The external motor draws in air from the kitchen and from neighbouring rooms.

If there is insufficient air, an underpressure will occur. The heating appliance may be starved of oxygen. This impairs combustion.

Harmful gases could be drawn from the chimney or extraction ducting back into the room, with potentially fatal consequences.

Risk of death!

Warning and Safety instructions

In order to ensure safe operation and to prevent gases given off by the heating appliance from being drawn back into the room, when the external motor and the heater are both operated simultaneously, an underpressure in the room of 0.04 mbar (4 Pa) is the maximum permissible.

Sufficient ventilation can be maintained by air inlets which cannot be blocked, e.g. in windows, doors and outside wall vents. The diameter of the inlet openings must enable sufficient ventilation. A ventilation brick alone is not generally sufficient to ensure safe ventilation.

The overall ventilation condition of the dwelling must be taken into account. If in any doubt, the advice of a competent builder, or for gas, a qualified gas fitter should be sought.

Warning and Safety instructions

Correct installation

- ▶ All ducting, pipework and fittings must be of non-flammable material. These can be obtained from builders' merchants.
- ▶ The appliance must not be connected to a chimney or vent flue which is in current use for exhausting fumes from appliances burning gas or other fuels. Neither should it be connected to ducting which ventilates rooms with fireplaces.

Disposal of the packing material

The transport and protective packaging has been selected from materials which are environmentally friendly for disposal, and can normally be recycled.

Recycling the packaging reduces the use of raw materials in the manufacturing process and also reduces the amount of waste in landfill sites. Ensure that any plastic wrappings, bags etc. are disposed of safely and kept out of the reach of babies and young children. Danger of suffocation.

Disposing of your old appliance

Electrical and electronic appliances often contain valuable materials. They also contain specific materials, compounds and components, which were essential for their correct function and safety. These could be hazardous to human health and to the environment if disposed of with your domestic waste or if handled incorrectly. Please do not, therefore, dispose of your old appliance with your household waste.



Please dispose of it at your local community waste collection / recycling centre for electrical and electronic appliances. You are also responsible for deleting any personal data that may be stored on the appliance prior to disposal. Please ensure that your old appliance poses no risk to children while being stored prior to disposal.

Installation

Before installation



Before installation, it is important to read the information given on the following pages as well as the "Warning and Safety instructions" at the beginning of this booklet.

Installation recommendations

- Make sure that the installation location is easily accessible. Installation work must be able to be carried out without danger. This is also important if the appliance needs to be serviced.

AWG 102

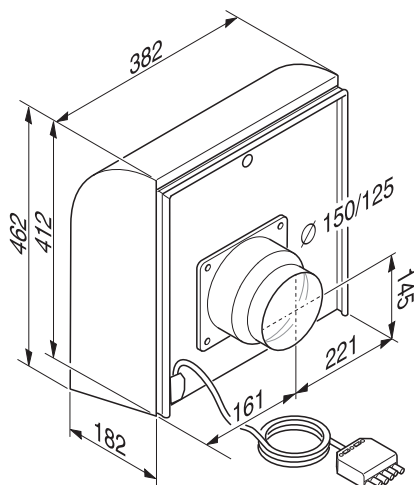

The AWG 102 external motor is designed to be installed on an outside wall.

The external motor must be installed vertically on the outside wall. The extraction outlet must face downwards.

The external motor is connected to the rangehood by means of a control cable and is operated by the controls on the rangehood.

Please refer to the operating and installation instructions for the rangehood before installing the external motor and ducting.

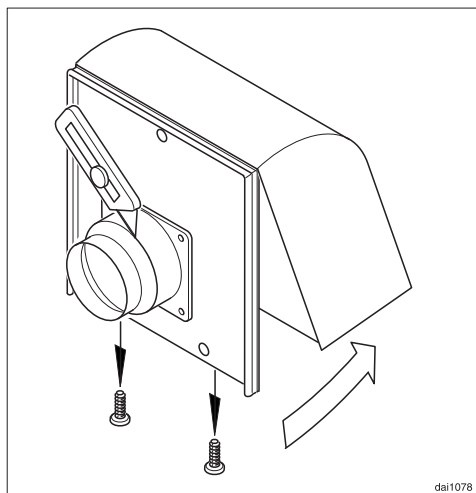

- Unscrew the two fixing screws on the underside of the external motor and take the motor unit off its fixing bracket.

The ducting collar on the motor unit has a diameter of 125 mm when the appliance is supplied.

- If exhaust ducting with a diameter of \varnothing 150 mm is required, the front ring of the collar must be cut at the join with a sharp knife.

Installation

- Make a \varnothing 185 mm hole in the wall.

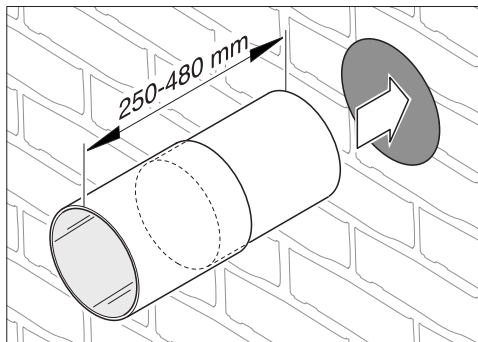

- Push the telescopic wall pipe into the hole so that it is sitting flush.

The telescopic wall pipe will make it easier to feed the control cable and the flexible ducting through later on.

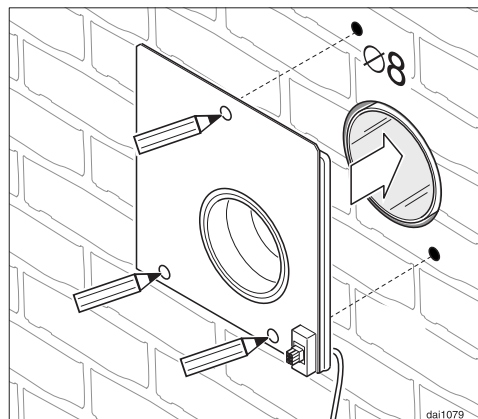

- Position the motor unit fixing bracket on the outside wall. The control cable connection must be at the bottom.
- Mark the position of the three holes to be drilled.
- Drill three \varnothing 8 mm holes and insert S8 wall anchors in the holes.

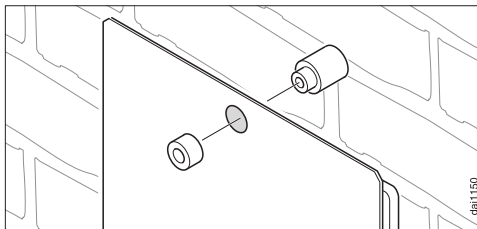

- Connect the three mountings through the fixing holes in the bracket as illustrated.

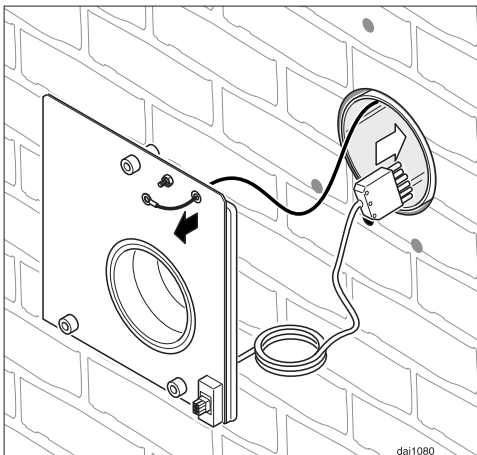

- Position the bracket onto the outside wall again and feed the control cable with the six-pole connectors through the telescopic wall pipe into the house.
- If equipotential bonding is required, pull the earth cable through the hole provided.

Equipotential bonding is required if the control cable is to be extended by more than the length of the extension cable supplied (see "Electrical connection").

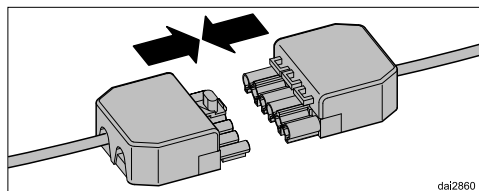
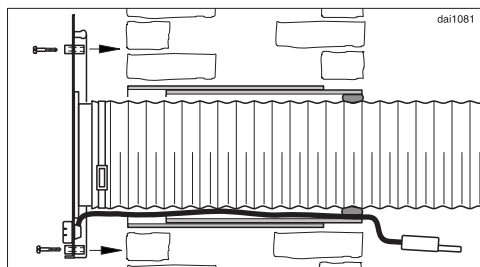

- Feed the flexible ducting through the telescopic wall pipe and secure it to the collar on the motor unit fixing bracket with a hose clip.
- Secure the bracket to the external wall with three screws.
- Extend the flexible ducting from the inside of the wall along the wall pipe and seal the gap between the ducting and the wall pipe with jointing compound.
- Connect the control cable plug connectors.
- Use the extension cable supplied to lengthen the control cable if necessary.

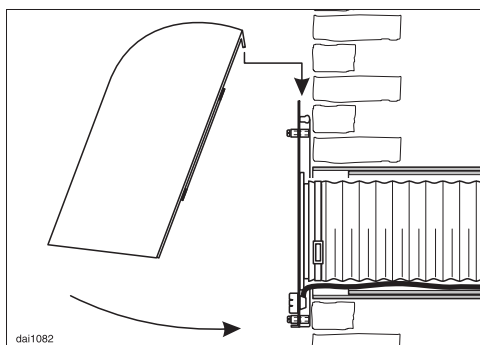

- Refit the motor unit and secure it on the underside of the external motor with the two fixing screws.

Installation

DDG 102

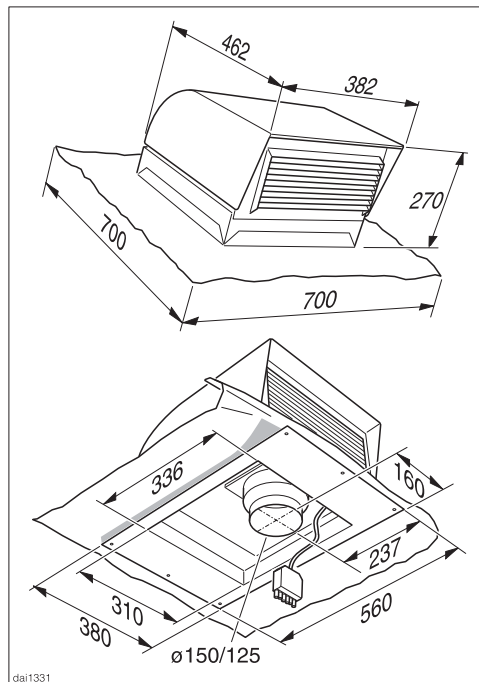

The DDG 102 is designed for installation on an angled tile, slate or shingle roof. The slope of the roof must be at least 22° to prevent the ingress of the elements, such as rain or snow.

Consult a roof tiler or roof plumber for advice regarding other types of roofing.

Installation on a flat roof is not possible.

Installation must only be carried out by a qualified and competent person.

The external motor is connected to the rangehood by means of a control cable and is operated by the controls on the rangehood.

Please refer to the operating and installation instructions for the rangehood before installing the external motor and ducting.

The ducting collar on the external motor has a diameter of 125 mm when the appliance is supplied.

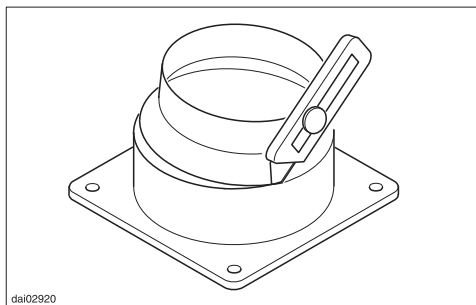

- If exhaust ducting with a diameter of $\varnothing 150$ mm is required, the front ring of the collar must be cut at the join with a sharp knife.

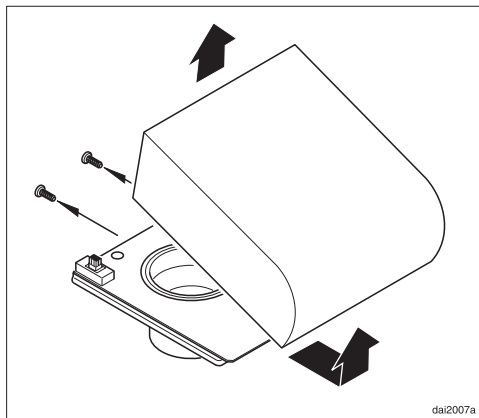

- Unscrew the two fixing screws and remove the motor unit from the base plate.

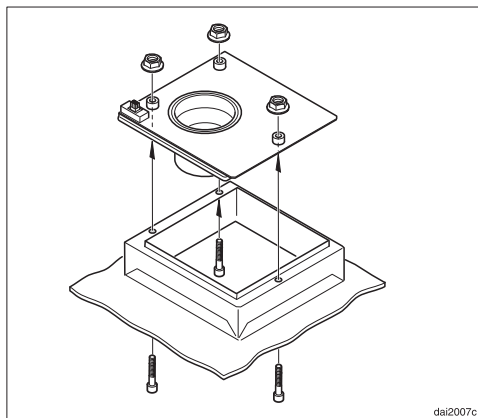

- Secure the base plate to the mounting frame with the screws and nuts supplied.

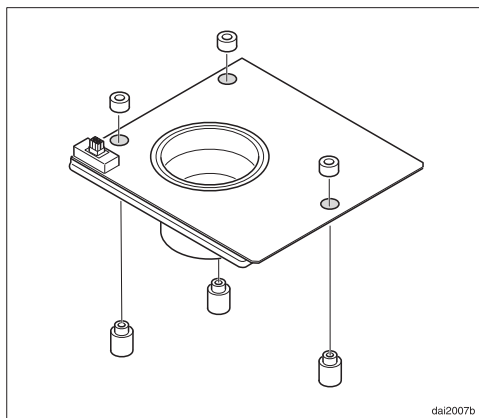

- Fit the three distance bushes to the base plate.

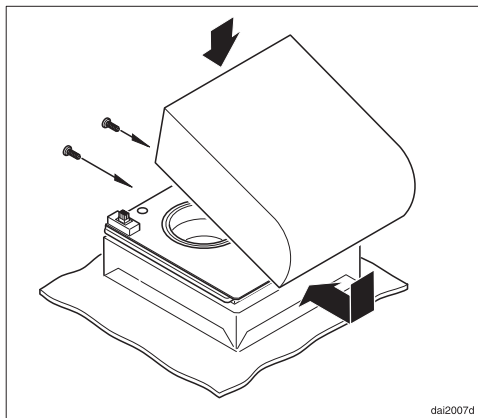

- Refit the motor unit.

Installation

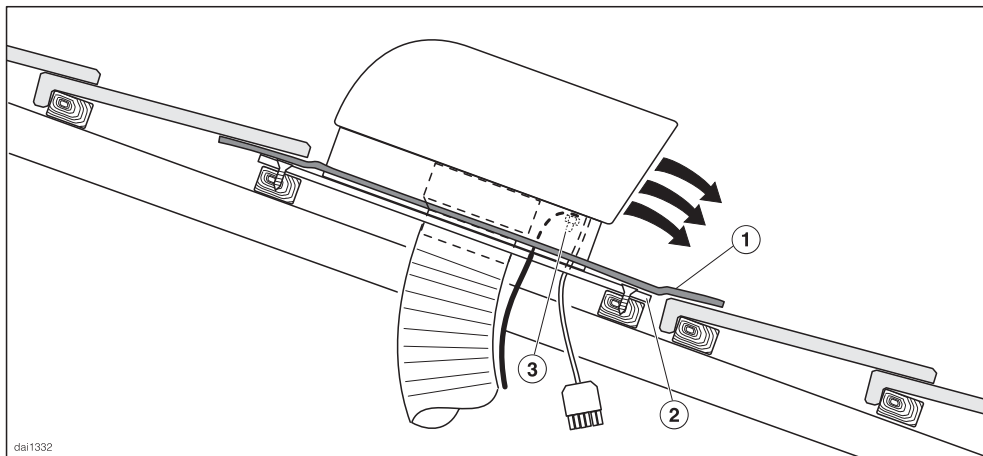

- Remove the roofing around the installation area.
- Bend the flashing ① upwards.
- Position the motor unit on the roof with the air outlet directed down the roof.
- Secure the motor unit to the roof substructure with the fixing plate ②.
- Replace the roofing. Press down on the flashing to ensure that it creates a proper seal. The flashing should be fitted under the roofing at the top of the motor unit and above the roofing at the sides and bottom of the motor unit.
- If equipotential bonding is required, connect the earth lead to the earthed connection point ③ in the housing.

- Push the flexible ducting onto the connection on the motor unit and secure it with a hose clip.

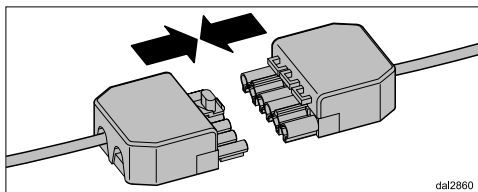

- Connect the control cable plug connectors.
- Use the extension cable supplied to lengthen the control cable if necessary.

When feeding the cable and the exhaust ducting through the substructure of the roof, be careful to ensure that any gaps are sealed properly afterwards.

Equipotential bonding is required if the control cable is to be extended by more than the length of the extension cable supplied (see "Electrical connection").

ABLG 202

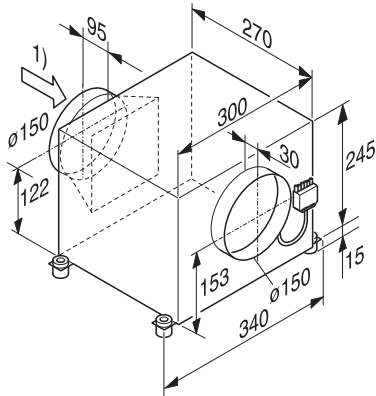

1) Suction side

The ABLG 202 external motor is designed for installation inside the house. Possible locations:

- In the attic or ceiling space
- In an adjoining room, e.g. a pantry or garage
- In the kitchen, if sufficient insulation is used

It can be installed in a vertical or horizontal position.

If installing vertically please refer to the installation instructions on the next page.

The external motor is connected to the rangehood by means of a control cable and is operated by the controls on the rangehood.

Please refer to the operating and installation instructions for the rangehood before installing the external motor and ducting.

- Position the external motor in a suitable location.

Pay particular attention to the direction of the ducting.

- Mark the positions for the four motor base plate holes on the installation surface.
- Place the motor to one side.

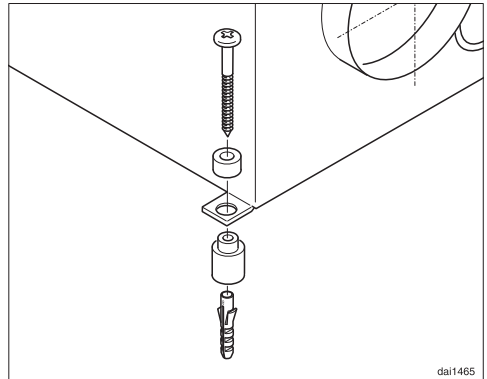

- Drill four $\varnothing 8$ mm holes in the positions marked to a depth of 40 mm for securing the external motor.
- Press S8 anchors into the drill holes so that they are flush.
- Connect the installation mountings through the fixing holes in the motor unit base plate.
- Secure the motor with the screws supplied.

Installation

The ducting collar on the motor unit has a diameter of 150 mm as standard. If a diameter of 125 mm is required a reducing collar must be used.

This is available to order from Miele.

- Push the flexible ducting onto the collar and secure it with a hose clip.
- Ducting with a diameter of 150 mm is then connected to the exhaust side.

If the exhaust air is to be ducted into the open air, a telescopic wall vent kit can be used. This is available to order from Miele.

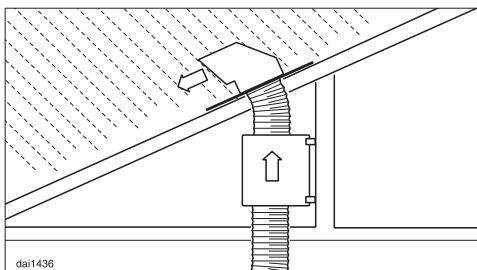

If the motor is installed vertically with the exhaust ducting venting over a roof, a roof vent kit DDF 125/150 or similar must be used to prevent rainwater from penetrating the exhaust opening.

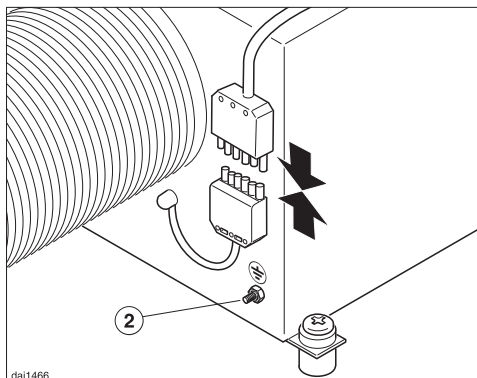

- Connect the control cable plug connectors.
- Use the extension cable supplied to lengthen the control cable if necessary.
- If equipotential bonding is required, connect the earth lead to the earthed connection point ② in the housing.

Equipotential bonding is required if the control cable is to be extended by more than the length of the extension cable supplied (see "Electrical connection").

DDF 125/150

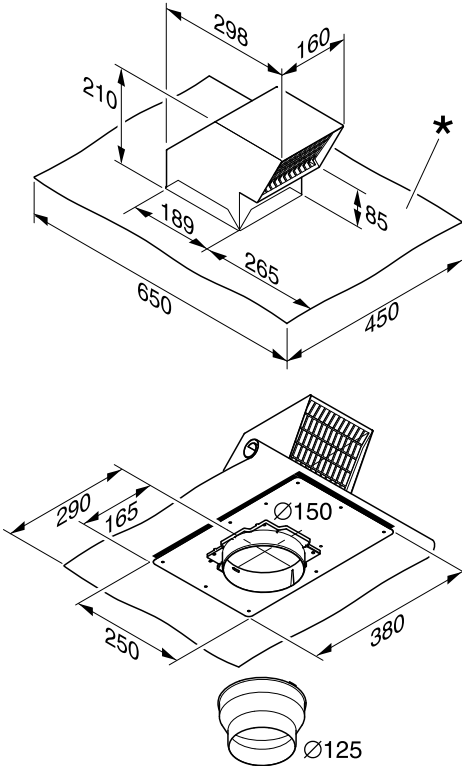

* Flashing

The DDF 125/150 roof vent is designed for installing ducting through an angled tile, slate or shingle roof. The slope of the roof must be at least 22° to prevent the ingress of the elements, such as rain or snow.

Consult a roof tiler or roof plumber for advice regarding other types of roofing.

- Remove the roofing around the installation area.
- Bend the flashing * upwards.
- Position the roof vent on the roof with the air outlet directed down the roof.
- Secure the roof vent to the roof substructure with the fixing plate.
- Replace the roofing. Press down on the flashing to ensure that it creates a proper seal.
The flashing should be fitted under the roofing at the top of the roof vent and above the roofing at the sides and the bottom of the roof vent.

The roof vent collar has a diameter of 150 mm as standard.

If a diameter of 125 mm is required a reducing collar must be used.

- Push the flexible ducting onto the collar and secure it with a hose clip.

It has an integrated non-return flap.

When feeding the exhaust ducting through the substructure of the roof, be careful to ensure that any gaps are sealed up properly afterwards.

Installation on a flat roof is not possible.

Installation must only be carried out by a qualified and competent person.

Connection for air extraction

- Only use smooth pipes or flexible hoses made from non-flammable materials for the extraction ducting.
- To achieve the greatest possible air extraction with the lowest noise level, please note the following:
 - The cross-section of the exhaust ducting must not be smaller than the cross-section of the exhaust connection (see "Appliance dimensions").
 - The exhaust ducting should be as short and straight as possible.
 - Only use wide radius bends.
 - The exhaust ducting should not be kinked or compressed.
 - Ensure that all connections are strong and airtight.
- When ducting is horizontal it must be laid to slope away at at least 1 cm per metre. This is to ensure that condensate cannot drain back into the downdraft extractor.
- If the exhaust ducting is to run through rooms, ceiling space etc. where there may be great variations in temperature between the different areas, the problem of condensation will need to be addressed. The exhaust ducting will need to be suitably insulated.

Remember that any constriction of the airflow will reduce extraction performance and increase operating noise.

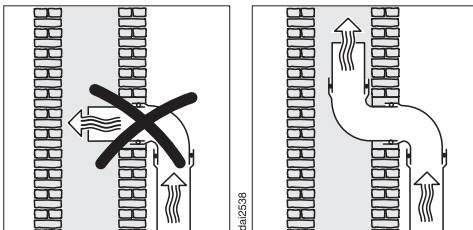

- If the exhaust air is to be ducted into a vent flue, the ducting must be directed in the flow direction of the flue.

Silencer

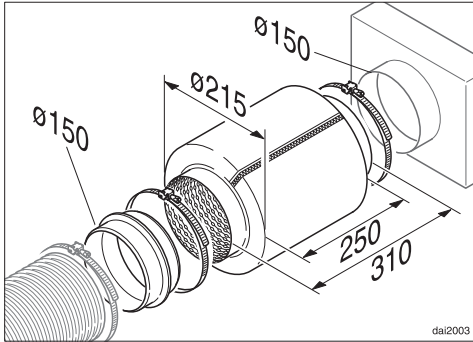

To achieve even further reductions in noise levels, a special silencer (optional accessory) can be fitted in the ducting system.

Air extraction with external motor

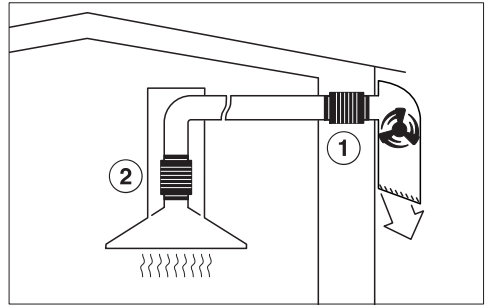

dal2341k

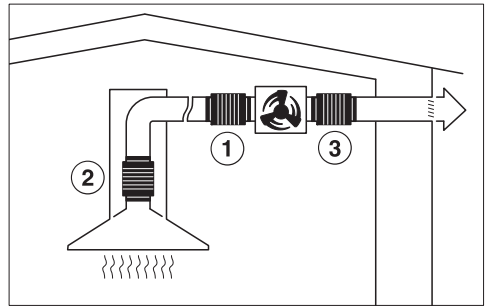

To minimise noise from the motor in the kitchen, the silencer should be positioned in front of the external motor ① if possible, or if the ducting is long, then in the ducting above the rangehood itself ②. In the case of an external motor that is placed inside the house (ABLG 202), fitting a silencer behind the external motor ③ reduces the noise of the motor outside the house.

After sales service and warranty

In the event of a fault which you cannot remedy yourself, please contact Miele.

The contact details for Miele are given at the back of these instructions.

When contacting Miele, please quote the model and serial number of your appliance.

These can be found on the data plate.

Position of the data plate

The data plate is located on the housing.

Warranty: AU, NZ

The manufacturer's warranty for this appliance is 2 years.

For further information, please refer to your warranty booklet.

Warranty: Other countries

For information on the appliance warranty specific to your country please contact Miele. See end of this booklet for contact details.

The external motor is connected to the rangehood by means of a special control cable and is operated by the touch controls on the rangehood.

The electrical system and connection of this appliance must comply with national and local safety regulations.

For extra safety, it is advisable to protect the appliance with a suitable residual current device (RCD) with a trip current of 30 mA.

The relevant connection data can be found on the data plate (see "After sales service and warranty"). Ensure that this data matches the voltage and frequency of your household mains supply.

The external motor is supplied with a 5 m extension cable. If the control cable needs to be extended further by means of an additional extension cable or a hardwired connection cable (at least $6 \times 1.5 \text{ mm}^2$), the installation must be carried out in strict accordance with local and national safety regulations. Equipotential bonding is required in this case.

The external motor is supplied with an earthed connection point .

This external motor has been designed to be connected to a Miele rangehood only and must not be connected to a rangehood made by another manufacturer.

Technical data

AWG 102

Total rated load	200 W
Voltage, frequency	AC 230 V, 50 Hz
Fuse rating	10 A
Control cable length	0.75 m
Connection cable length	5 m
Weight	14.1 kg
Operating temperature	up to - 20 °C
Fan power according to EN61591*	
Level 1	320 m ³ /h
Level 2	460 m ³ /h
Level 3	580 m ³ /h
Booster setting (intensive setting)	760 m ³ /h

*For example in combination with a DA 429-6 EXT rangehood

ABLG 202

Total rated load	290 W
Voltage, frequency	AC 230 V, 50 Hz
Fuse rating	10 A
Connection cable length	5 m
Weight	8 kg
Operating temperature	up to - 20 °C
Fan power according to EN61591*	
Level 1	300 m ³ /h
Level 2	460 m ³ /h
Level 3	600 m ³ /h
Booster setting (intensive setting)	820 m ³ /h

*For example in combination with a DA 429-6 EXT rangehood

Technical data

DDG 102

Total rated load	200 W
Voltage, frequency	AC 230 V, 50 Hz
Fuse rating	10 A
Control cable length	0.75 m
Connection cable length	5 m
Weight	15.2 kg
Operating temperature	up to - 20 °C
Fan power according to EN61591*	
Level 1	320 m ³ /h
Level 2	460 m ³ /h
Level 3	580 m ³ /h
Booster setting (intensive setting)	760 m ³ /h

*For example in combination with a DA 429-6 EXT rangehood

Miele Australia Pty. Ltd.

ACN 005 635 398

ABN 96 005 635 398

**Miele Experience Centre and
Head Office Melbourne:**1 Gilbert Park Drive
Knoxfield, VIC 3180**Miele Experience Centre South Melbourne:**206-210 Coventry Street
South Melbourne, VIC 3205**Miele Experience Centre and Office Sydney:**3 Skyline Place
Frenchs Forest, NSW 2086**Miele Experience Centre and Office Brisbane:**39 Harvey Street North
Eagle Farm, QLD 4009**Miele Experience Centre Gold Coast:**131 Ferry Road
Southport, QLD 4215**Miele Experience Centre and Office Adelaide:**83-85 Sir Donald Bradman Drive
Hilton, SA 5033**Miele Experience Centre and Office Perth:**205-207 Stirling Highway
Claremont, WA 6010**Miele****Miele New Zealand Limited**

IRD 98 463 631

Head Office:Level 2, 10 College Hill
Freemans Bay, Auckland 1011**Miele Experience Centre
Auckland:**8 College Hill
Freemans Bay, Auckland 1011
Telephone:
0800 464 353 (0800 4 MIELE)
www.miele.co.nz**Miele Global Headquarters
Germany****Miele & Cie. KG**Carl-Miele-Straße 29
33332 Gütersloh
Federal Republic of Germanywww.miele.com.au

AWG 102
DDG 102
ABLG 202
DDF 125/150



en - AU, NZ

M.-Nr. 10 695 670 / 01