



Refrigerator user manual

imagine the possibilities

Thank you for purchasing this Samsung product.

Free Standing Appliance

SAMSUNG

Contents

SAFETY INFORMATION.....	2
SETTING UP YOUR FRENCH DOOR REFRIGERATOR	16
OPERATING YOUR FRENCH DOOR REFRIGERATOR	28
TROUBLESHOOTING.....	52

Safety information

SAFETY INFORMATION

- Before operating the appliance, please read this manual thoroughly and retain it in a safe place near the appliance for your future reference.

- Use this appliance only for its intended purpose as described in this instruction manual.

This appliance is not intended for use by persons (including children) with reduced physical, sensory or mental capabilities, or lack of experience and knowledge, unless they have been given supervision or instruction concerning use

of the appliance by a person responsible for their safety.









- This appliance can be used by children aged from 8 years and above and persons with reduced physical, sensory or mental capabilities or lack of experience and knowledge if they have been given supervision or instruction concerning use of the appliance in a safe way and understand the hazards involved.

Children shall not play with the appliance.

Cleaning and user maintenance shall not be made by children without supervision.

- Warnings and Important Safety Instructions in this manual do not cover all possible conditions and situations that may occur. It is your responsibility to use common sense, caution, and care when installing, maintaining, and operating your appliance.
- Because the following operating instructions cover various models, the characteristics of your refrigerator may differ slightly from those described in this manual and not all warning signs may be applicable. If you have any questions or concerns, contact your nearest service center or find help and information online at www.samsung.com.
- It is hazardous for anyone other than an Authorised Service Person to service this appliance. In Queensland – the authorized Service Person MUST hold a Gas Work Authorisation or Licence for hydrocarbon refrigerants, to carry out Servicing or repairs which involve the removal of covers. (For Australia only)

Important safety symbols and precautions:

	Hazards or unsafe practices that may result in severe personal injury or death.
	Hazards or unsafe practices that may result in minor personal injury or property damage.
	Do NOT attempt.
	Do NOT disassemble.
	Do NOT touch.
	Follow directions carefully.
	Unplug the power plug from the wall socket.
	Make sure the machine is grounded to prevent electric shock.
	Call the contact center for help.
	Note.

These warning signs are here to prevent injury to you and others.

Please follow them carefully. After reading this section, keep it in a safe place for future reference.

CE Notice

This product has been determined to be in compliance with the Low Voltage Directive (2006/95/EC), the Electromagnetic Compatibility Directive (2004/108/EC), RoHS Directive (2011/65/EU), Commission Delegated Regulation (EU) No 1060/2010 and the Eco-Design Directive (2009/125/EC) implemented by Regulation (EC) No 643/2009 of the European Union. (For products sold in European Countries only)



SEVERE WARNING SIGNS FOR TRANSPORTATION AND SITE



- When transporting and installing the appliance, care should be taken to ensure that no parts of the refrigerating circuit are damaged.
- R-600a or R-134a is used as a refrigerant.
Check the compressor label on the rear of the appliance or the rating label inside the refrigerator to see which refrigerant is used for your refrigerator.
- When this product contains flammable gas (Refrigerant R-600a),
 - Refrigerant leaking from the pipe work could ignite or cause an eye injury.
If a leak is detected, avoid any naked flames or potential sources of ignition and air the room in which the appliance is standing for several minutes.
 - In order to avoid the creation of a flammable gas-air mixture if a leak in the

refrigerating circuit occurs, the size of the room in which the appliance may be sited depends on the amount of refrigerant used.

- Never start up an appliance showing any signs of damage. If in doubt, consult your dealer.

The room where the refrigerator will be sited must be 1 m³ in size for every 8 g of R-600a refrigerant inside the appliance.

The amount of refrigerant in your particular appliance is shown on the identification plate inside the appliance.

- Refrigerant squirting out of the pipes could ignite or cause an eye injury. When refrigerant leaks from the pipe, avoid any naked flames and move anything flammable away from the product and ventilate the room immediately.
- Failing to do so may result in fire or explosion.
- If the appliance contains isobutane refrigerant (R-600a), a natural gas with high environmental compatibility that is, however,

also combustible.

When transporting and installing the appliance, care should be taken to ensure that no parts of the refrigerating circuit are damaged.



SEVERE WARNING SIGNS FOR INSTALLATION



- Do not install this appliance in a humid, oily or dusty location, in a location exposed to direct sunlight and water (rain drops).
- Deteriorated insulation of electrical parts may cause an electric shock or fire.
- Do not place this refrigerator in direct sunlight or expose to the heat from stoves, room heaters or other appliances.
- Do not plug several appliances into the same multiple power board. The refrigerator should always be plugged into its own individual electrical outlet which has a voltage rating

that matched the rating plate.

- This provides the best performance and also prevents overloading house wiring circuits, which could cause a fire hazard from overheated wires.
If the wall socket is loose, do not insert the power plug.
- There is a risk of electric shock or fire.
- Do not use a cord that shows cracks or abrasion damage along its length or at either end.
- Do not bend the power cord excessively or place heavy articles on it.
- Do not use aerosols near the refrigerator.
- Aerosols used near the refrigerator may cause an explosion or fire.
- Do not install this appliance in a location where gas may leak.
- This may result in an electric shock or fire.



- The installation or any service of this appliance is recommended by a qualified technician or service company.

- Failing to do so may result in an electric shock, fire, explosion, problems with the product, or injury.
- This refrigerator must be properly installed and located in accordance with the manual before it is used.
- Do not install the refrigerator in a damp place or place where it may come in contact with water.
- Deteriorated insulation of electrical parts may cause an electric shock or fire.
- Connect the power plug in the proper position with the cord hanging down.
- If you connect the power plug upside down, the wire can get cut off and cause fire or an electric shock.
- Do not use a cord that shows cracks or abrasion damage along its length or at either end.
- Make sure that the power plug is not squashed or damaged by the back of the refrigerator.
- When moving the refrigerator, be careful not to roll over or damage the power cord.

- This constitutes a fire hazard.
- The appliance must be positioned so that the plug is accessible after installation.
- Keep the packing materials out of reach of children.
- There is a risk of death from suffocation if children put them on their head.
- Failing to do so may result in an electric shock or personal injury.



CAUTION SIGNS FOR INSTALLATION



- The refrigerator must be grounded.
- You must ground the refrigerator to prevent any power leakages or electric shocks caused by current leakage from the refrigerator.
- Never use gas pipes, telephone lines or other potential lightening rods as ground.
- Improper use of the ground plug can result in an electric shock.
- Keep ventilation opening in the appliance enclosure or mounting structure clear of obstruction.
- Allow the appliance to stand for 2 hours after installation.



SEVERE WARNING SIGNS FOR USING



- If the power cord is damaged, have it replaced immediately by the manufacturer or its service agent.
- The fuse on the refrigerator must be changed by a qualified technician or service company.
- Do not insert the power plug with wet hands.
- Do not store items on top of the appliance.
- When you open or close the door, items may fall and cause a personal injury and/or material damage.
- Do not put items filled with water on the refrigerator.
- If spilled, there is a risk of fire or electric shock.

- Do not let children hang on the door.
 - Failure to do so may cause serious personal injury.
 - Do not leave the doors of the refrigerator open while the refrigerator is unattended and do not let children enter inside the refrigerator.
 - Do not allow babies or children to go inside the drawers.
 - It can cause death from suffocation by entrapment or personal injury.
 - Do not sit on the Freezer door.
 - The door can be broken and cause personal injury.
 - Never put fingers or other objects into the dispenser hole.
 - Failure to do so may cause personal injury or material damage.
 - Do not store volatile or flammable substances such as benzene, thinner, alcohol, ether or LP gas in the refrigerator.
 - The storage of any of such products may cause an explosion.
- Do not store low temperature-sensitive pharmaceutical products, scientific materials or other low temperature-sensitive products in the refrigerator.
 - Products that require strict temperature controls must not be stored in the refrigerator.
 - Do not place or use electrical appliances inside the refrigerator, unless they are of a type recommended by the manufacturer.
 - Do not use a hair dryer to dry the inside of the refrigerator. Do not place a lighted candle in the refrigerator for removing bad odours.
 - This may result in an electric shock or fire.
 - Do not touch the inside walls of the freezer or products stored in the freezer with wet hands.
 - This may cause frostbite.
 - Do not use mechanical devices or any other means to accelerate the defrosting process, other than those recommended by the manufacturer.

- Do not damage the refrigerant circuit.
- This appliance should be positioned in such a way that it is accessible to the power plug.
- Failing to do so may result in an electric shock or fire due to electric leakage.



- This product is intended only for the storage of food in a domestic environment.
- Bottles should be stored tightly together so that they do not fall out.
- In the event of a gas leak (such as propane gas, LP gas, etc.), ventilate immediately without touching the power plug. Do not touch the appliance or power cord.
- Do not use a ventilating fan.
- A spark may result in an explosion or fire.
- Use only the LED Lamps provided by manufacturer or service agent.
- Children should be supervised to ensure that they do not play with and/or climb into the appliance.



- Do not disassemble or repair the refrigerator by yourself.
- You run a risk of causing a fire, malfunction and/ or personal injury. In case of malfunction, please contact your service agent.
- Do not attempt to repair, disassemble, or modify the appliance yourself.
- Do not use any fuse (such as cooper, steel wire, etc.) other than the standard fuse.
- When repairing or reinstalling the appliance is required, contact your nearest service center.
- Failing to do so may result in an electric shock, fire, problems with the product, or injury.



- If the appliance generates a strange noise, a burning or smell or smoke, unplug the power plug immediately and contact your nearest service centre.
- Failing to do so may result in an electric shock or fire hazards.

- If you experience difficulty when changing the light, contact service agent.
- If the products is equipped with LED Lamps, do not disassemble the Lamp Cover and LED Lamps by yourself.
- Please contact your service agent.
- If any dust or water is in the refrigerator, pull out power plug and contact your Samsung Electronics service centre.
- There is a risk of fire.



CAUTION SIGNS FOR USING

- ★ • To get best performance from the product,
- Do not place foods too closely in front of the vents at the rear of the appliance as it can obstruct free air circulation in the refrigerator compartment.
- Wrap the food up properly or place it in airtight containers before putting it into the refrigerator.
- Do not put any newly

introduced food for freezing near to already existing food.

- Do not place carbonated or fizzy drinks in the freezer compartment.
Do not put bottles or glass containers in the freezer.
- When the contents freeze, the glass may break and cause personal injury and property damage.
- Do not change or modify the functionality of the refrigerator.
- Changes or modifications may result in a personal injury and/or property damage.
Any changes or modifications performed by a 3rd party on this completed appliance are neither covered under Samsung warranty service, nor is Samsung responsible for safety issues and damages that result from 3rd party modifications.
- Do not block air holes.
- If the air holes are blocked, especially with a plastic bag, the refrigerator can be over cooled.
If this cooling period lasts too long, the water filter may break and cause water

leakage.

- Do not put any newly introduced food for freezing near to already existing food.
- Please observe maximum storage times and expiry dates of frozen goods.
- Do not spray volatile material such as insecticide onto the surface of the appliance.
- As well as being harmful to humans, it may also result in an electric shock, fire or problems with the product.
- Do not apply strong shock or excessive force onto the surface of glass.
- Broken glass may result in a personal injury and/or property damage.
- Fill the water tank, ice tray and water cubes only with potable water (mineral water or purified water).
- Do not fill the tank with tea or a Sports drink.
This may damage the refrigerator.
- Use only the ice-maker provided with the refrigerator.
- The water supply to this refrigerator must only be installed/connected by a

suitably qualified person and connected to a potable water supply only.



CAUTION SIGNS FOR CLEANING AND MAINTENANCE



- Do not directly spray water inside or outside the refrigerator.
- There is a risk of fire or electric shock.
- Do not use or place any substances sensitive to temperature such as inflammable sprays, inflammable objects, dry ice, medicine, or chemicals near the refrigerator.
Do not keep volatile or inflammable objects or substances (benzene, thinner, propane gas, etc.) in the refrigerator.
- This refrigerator is for storing food only.
- This may result in a fire or an explosion.
- Do not spray cleaning products directly on the display.

- Printed letters on the display may come off.
- Remove any foreign matter or dust from the power plug pins.
But do not use a wet or damp cloth when cleaning the plug, remove any foreign material or dust from the power plug pins.
- Otherwise there is a risk of fire or electric shock.
- Never put fingers or other objects into the dispenser hole and ice chute.
- It may cause a personal injury or material damage.
- Clean the unreachable parts such as hinges by using a brush or toothbrush.



- Unplug the refrigerator before cleaning and performing maintenance.
- If any foreign substance such as water has entered the appliance, unplug the power plug and contact your nearest service centre.
- Failing to do so may result in an electric shock or fire.



SEVERE WARNING SIGNS FOR DISPOSAL



- Ensure that none of the pipes on the back of the appliance are damaged prior to disposal.

- R-600a or R-134a is used as a refrigerant.

Check the compressor label on the rear of the appliance or the rating label inside the refrigerator to see which refrigerant is used for your refrigerator.

When this product contains flammable gas (Refrigerant R-600a), contact your local authority in regard to safe disposal of this product.

Cyclopentane is used as an insulation blowing gas.

The gases in insulation material require special disposal procedure.

Please contact your local authorities in regard to the environmentally safe disposal of this product.

Ensure that none of the pipes on the back of the appliances are damaged prior to disposal.

The pipes shall be broken in the open space.

- When disposing of this product or other refrigerators, remove the door/door seals, door latch so that small children or animals cannot become trapped inside. Leave the shelves in place so that children may not easily climb inside. Children should be supervised to ensure that they do not play with the old appliance.
- Please dispose of the packaging material for this product in an environmentally friendly manner.
- Keep all packaging materials well out of the reach of children, as packaging materials can be dangerous to children.
- If a child places a bag over its head, it may result in suffocation.



ADDITIONAL TIPS FOR PROPER USAGE

- In the event of a power failure, call the local office of your Electricity Company and ask how long it is going to last.
- Most power failures that are corrected within an hour or two will not affect your refrigerator temperatures. However, you should minimise the number of door openings while the power is off.
- Should the power failure last more than 24 hours, remove all frozen food.
- If keys are provided with the refrigerator, the keys should be kept out of the reach of children and not be in the vicinity of the appliance.
- The appliance might not operate consistently (possibility of temperature becoming too warm in the refrigerator) when sited for an extended period of time below the cold end of the range of temperature for which the refrigerating appliance is designed.

- Do not store food which spoils easily at low temperature, such as bananas, melons.
- Your appliance is frost free, which means there is no need to manually defrost your appliance, as this will be carried out automatically.
- Temperature rise during defrosting can comply with ISO requirements.
But if you want to prevent an undue rise in the temperature of the frozen food while defrosting the appliance, please wrap the frozen food up in several layers of newspaper.
- Any increase in temperature of frozen food during defrosting can shorten its storage life.
- The temperature of two star section (sections) or compartment (compartments) which have two star symbol (✱✱) is slightly higher than other freezer compartment (compartments).
The two star section (sections) or compartment (compartments) is (are) based

on the instruction and/or the condition as delivered.

- Contains fluorinated greenhouse gases covered by the Kyoto Protocol.
- Foam blown with fluorinated greenhouse gases.
- **Foam blown additive: Perfluorohexane Global Warming Potential (GWP) = 9000**

Saving Energy Tips

- Install the appliance in a cool, dry room with adequate ventilation.
Ensure that it is not exposed to direct sunlight and never put it near a direct source of heat (radiator, for example).
- Never block any vents or grills on the appliance.
- Allow warm food to cool down before placing it in the appliance.
- Put frozen food in the refrigerator to thaw.
You can then use the low temperatures of the frozen products to cool food in the

refrigerator.

- Do not keep the door of the appliance open for too long when putting food in or taking food out.
The shorter time for which the door is open, the less ice will form in the freezer.
- Clean the rear of the refrigerator regularly.
Dust increases energy consumption.
- Do not set temperature colder than necessary.
- Ensure sufficient air flow at the refrigerator base and at the back of the refrigerator.
Do not cover air vent openings.
- Allow clearance to the right, left, back and top when installing.
This will help reduce power consumption and keep your energy bills lower.
- For the most efficient use of energy, please keep the all inner fittings such as baskets, drawers, shelves on the position supplied by manufacturer.

This appliance is intended to be used in household and similar applications such as

- staff kitchen areas in shops, offices and other working environments;
- farm houses and by clients in hotels, motels and other residential type environments;
- bed and breakfast type environments;
- catering and similar non-retail applications.

Setting up your French Door Refrigerator

GETTING READY TO INSTALL THE REFRIGERATOR

Congratulations on your purchase of the Samsung refrigerator.

We hope you enjoy the state-of-art features and efficiencies that this new appliance offers.

Selecting the best location for the Refrigerator

- A location with easy access to a water supply.
- A location without direct exposure to sunlight.
- A location with level (or nearly level) flooring.
- A location with enough space for the refrigerator doors to open easily.
- A location that allows sufficient space to the right, left, back, and top for air circulation. If the refrigerator does not have enough space, the internal cooling system may not work properly.
- A location that allows you to move the refrigerator easily if it needs maintenance or service.
- Do not install the refrigerator in locations where the temperature is over 43 °C or below 5 °C.

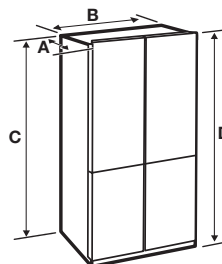

Model	RF34H9960S4, SRF1028CCRS	SRF751CCSS
Depth "A"	906 mm	733 mm
Width "B"	908 mm	908 mm
Height "C"	1822 mm	1749 mm
Overall Height "D"	1850 mm	1777 mm

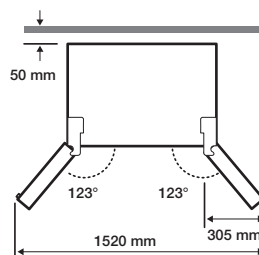

< RF34H9960S4, SRF1028CCRS >

< SRF751CCSS >

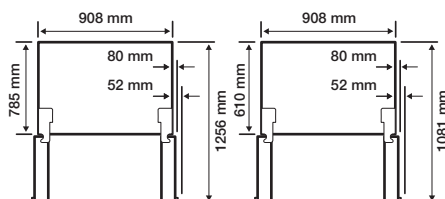

- Each measurement based on the design dimension, so it may differ depending on the measuring method.



When moving your refrigerator

To prevent floor damage, be sure the front leveling legs are in the up position (above the floor). Refer to "HOW TO LEVEL THE REFRIGERATOR" in the manual on page 21.

FLOORING

For proper installation, you must place this refrigerator on a level, hard surface that is the same height as the rest of the floor.

This surface should be strong enough to support a fully loaded refrigerator.

To protect the finish of the flooring, cut a large section of the cardboard carton and place it under the refrigerator where you are working.

When moving the refrigerator, you need to pull and push it straight forwards or back. Do not wiggle it from side to side.

For safety reasons, adjust the front side a little higher than the rear side.

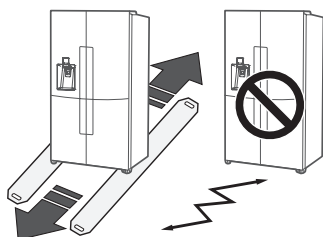

REMOVING THE REFRIGERATOR DOORS

If the refrigerator is too large to pass through your doorways easily, you can remove the refrigerator doors.

If you need to remove the doors, continue below. If you do not need to remove the refrigerator doors, go to 'Leveling the Refrigerator' on page 21.

Tools you will need (Not provided)

Philips screwdriver (+)	Flat-blade screwdriver (-)	Socket wrench 3/8" (10 mm)
Pliers	Allen wrench 5/32" (4 mm)	Allen wrench 7/32" (5 mm)



WARNING

- Disconnect power to the refrigerator before removing the doors or drawers.
- Be careful not to drop, damage or scratch the doors/drawers while removing them.
- Use care when you remove the doors/drawers. The doors are heavy and you could injure yourself.
- Re-attach the doors/drawers properly to avoid:
 - Moisture from air leakage.
 - Uneven door alignment.
 - Wasting energy due to improper door seal.

DISASSEMBLE THE REFRIGERATOR DOORS

1. With the door closed, remove the 6 screws holding the Top Cover (A) with a Phillips (+) Screwdriver, and then remove the Top Cover with the entire wire-harnesses attached.

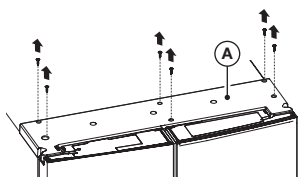

2. Separate the two connectors on the left door and the one connector on the right door. Press the white sleeve [D] of the Water Tube Coupler, and then separate the Water Tube [E].

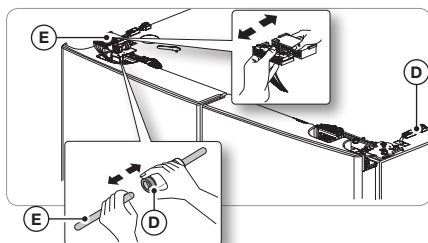

3. Pull up the Fixer Lever (B), and then pull it forward.

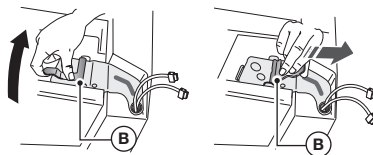

4. Remove the Hinge (C).

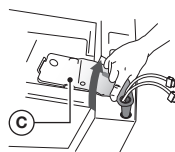

5. Open the door (more than 90°). Lift up and take it off.



- While disassembling and reassembling the door, make sure that the electric wires are not peeled off.
- Do not let the door fall down.

DISASSEMBLE THE FREEZER DOORS



- Be sure to remove the Fridge Door before removing the Freezer Door.
- Be careful with the wires attached to the bottom of the Freezer Door while disassembling.

1. With the door open, remove the screw holding the cover (A) of the Adjustable Leg at the bottom of the door with a Phillips (+) Screwdriver, and then disassemble the Connector (B).

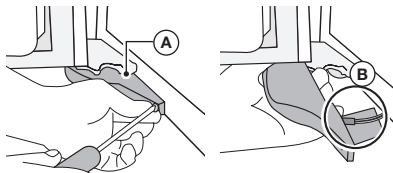

2. While holding the axis of the center hinge (C) in the top of the Freezer Door, pull out the Freezer Door.

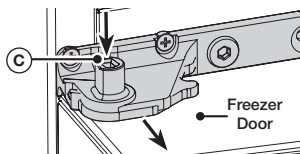

3. Tilt the Door forward a little, and then lift it up to remove.

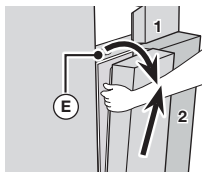

4. Repeat Steps 1 through 3 to remove the other Freezer Door.

RE-ATTACHING THE REFRIGERATOR DOORS



- Be sure to re-attach the Freezer Door before re-attaching the Fridge Door.
- Before re-attaching, make sure that all the wire connectors at the bottom of the Freezer Door are connected.

Once you have moved the refrigerator to its installation location, follow the steps below to re-attach the doors.

How to Re-attach the Freezer Door

1. Insert the door into the lower hinge (A) in the direction of arrow (1) and then push the door in the direction of arrow (2).

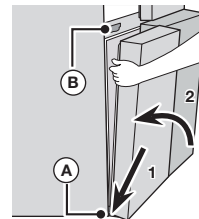

- Be careful not to damage the wires on the bottom of the door. Avoid stepping on them, etc.

2. Insert the hinge axis (C) into the lower hole of the center hinge.

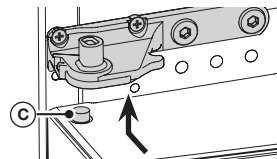

3. With the door open, join the connectors on the bottom of the door.

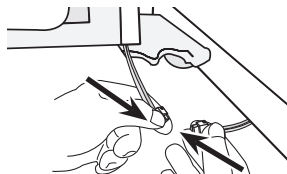

- Be careful not to step on or damage the connectors.

4. Attach the Adjustable Leg Cover using a Phillips (+) Screwdriver.

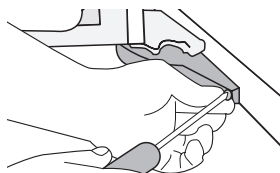

5. Repeat Steps 1 through 4 to re-attach the other Freezer Door.

How to Re-attach Fridge Door

1. Attach the detached Fridge Door to the Mid Hinge. (Attach the Door in the open position.)



2. Slide the Fridge Hinge (C) into the fixing slot, and then press it down so that it is aligned with the hole in the door.

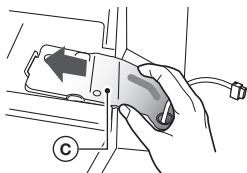

3. Inserting the Fixer Lever (B) in the direction of the arrow, and then flip it down to assemble.

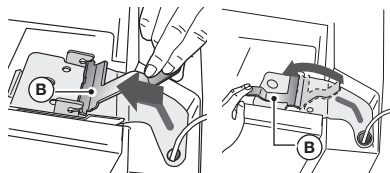

4. Assemble the Wire Connector.

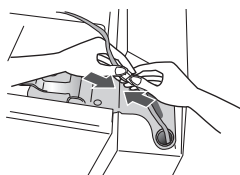

5. Connect the Water Tube [E].
Connect the connector [G] on the left door and the connector [H] on the right door.

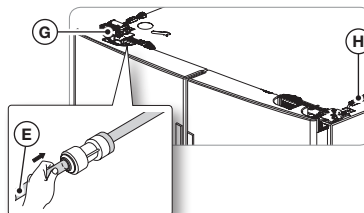

6. Attach the front of the Top Cover, and then press down on its back until it lies flat. Re-attach the screws.

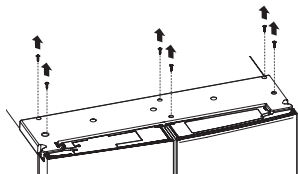

- Assemble the Fridge and Freezer doors in the reverse order of disassembly.
- If the Wire Connectors are cross-assembled, the display will not work properly.

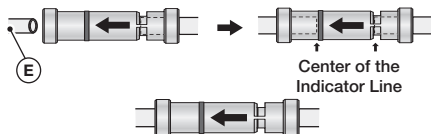

LEVELING THE REFRIGERATOR AND ADJUSTING THE DOOR HEIGHT AND THE GAP BETWEEN THE DOORS

HOW TO LEVEL THE REFRIGERATOR

If the Refrigerator is not level, it can cause a height difference between the doors.

- Insert a Flat-Head (-) Screwdriver into the slot in the Leveling Leg Control Lever and adjust the level by turning the Control Lever clockwise or counter-clockwise. When you rotate the Lever clockwise, you raise the refrigerator. When you rotate the Lever counter-clockwise, you lower the refrigerator.

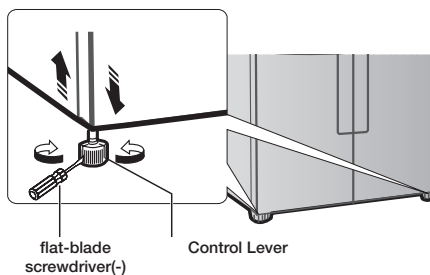

- If the Refrigerator is not level back and front, put a solid panel (such as a plastic panel, a plastic ruler, etc.) on the floor where the rear legs will rest, and then fix it in place with plastic tape. When you push in the Refrigerator, make sure the rear legs rest on the panel.
- If you have a wooden floor or similar soft floor, take care not to damage the floor when pushing the Refrigerator into place.

HOW TO ADJUST THE DOOR HEIGHT

If any one of the doors is lower than the other:

- Check if the Refrigerator is level before adjusting the door.
- Adjust the door height difference by inserting a Snap Ring (①) as shown between the door and the hinge. You can use the rings to raise the right side door of the fresh food compartment and both doors of the freezer compartment.

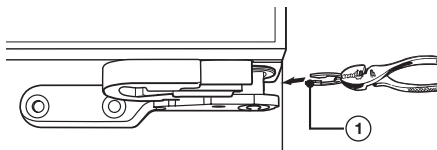
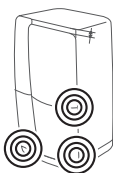

- After checking the height difference, select one Snap Ring with a suitable thickness.
Important: You can only insert one snap ring. Inserting two or more Snap Rings may cause the Snap Rings to slip out or make a rubbing noise.
- Lift up the lower door and insert the Snap Ring into the space between the Door and the Hinge.



- To avoid injury, insert or remove Snap Rings carefully.
- Keep the Snap Rings out of the reach of children and make sure that children do not play with them or put them into their mouths.



- 1 mm, 1.5 mm, 2 mm, and 2.5 mm Snap Rings come with the Refrigerator.
- If the Refrigerator is level before you load it with food, the Refrigerator may become unbalanced due to the weight of the food. If this occurs, adjust the level again using the same procedure.
- If you raise the door too far, it can rub against the Top Cover.

Snap Rings included with the refrigerator:

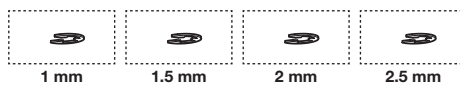

HOW TO ADJUST THE DOOR GAP

If the gap between the left and right fridge compartment doors is not even:

- You can adjust the gap by turning the bolt at the top right of the cold storage compartment door.
- Do not turn the bolt too far. You can break it.

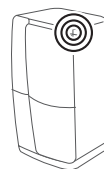

1. With the doors closed, remove the 6 screws holding the top cover using a Phillips screwdriver, and then lift it off together with the connected cables.

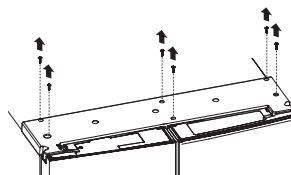

2. Turn the bolt with a 4 mm hexagonal L-wrench to adjust the gap.
(Not provided)

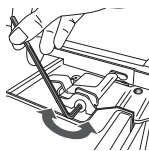

3. Turn the bolt clockwise to (↻) widen the gap. Turn the bolt counter clockwise (↻) to narrow the gap.

INSTALLING THE WATER DISPENSER LINE

A water dispenser with a filter is one of the helpful features on your new refrigerator. To help promote better health, the water filter removes unwanted particles from your water. However, it does not sterilize or destroy microorganisms.

You may need to purchase a water purifying system to do that.

In order for the ice maker to operate properly, a water pressure of 138 ~ 862 kPa is required.

Under normal conditions, a 170 cc (5.75 oz.) cup can be filled in about 10 seconds.

If the refrigerator is installed in an area with low water pressure (below 138 kPa), you can install a booster pump to compensate for the low pressure.

After you have connected the water line, make sure the water storage tank inside the refrigerator is properly filled. To do this, press the water dispenser lever until the water runs from the water outlet.



- Water line installation kits are include with unit. You can find it in freezer drawer.
- The new hose-sets supplied with the appliance are to be used and that old hose-sets should not be reused.

Parts for water line Installation



Water line fixer and screws



Pipe connector



Water line

Connecting to the water supply line

1. First, shut off the main water supply line.
2. Locate the nearest cold, drinking water line.
3. Follow the Water line Installation Instructions in the installation kit.

CAUTION

The water line must be connected to the cold water pipe. If it is connected to the hot water pipe, it may cause the purifier to malfunction.

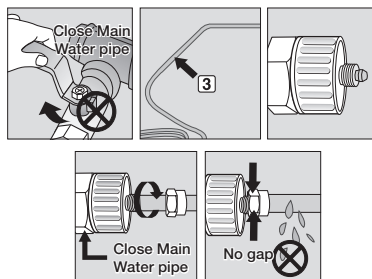

4. After connecting the water supply to the water filter, turn your main water supply back on and dispense about 3 L to clear and prime the water filter.

Connecting the water line to the refrigerator

1. Remove the cap from the water line on the unit and insert the compression nut of the water line into the water line on the unit.
2. Connect the water line on the unit with the water line in the kit.
3. Tighten the compression nut onto the compression fitting. There should be no gaps between (A, B & C).
4. Turn water on and check for any leakage.



- Only connect the water line to a drinkable water source.

If you have to repair or disassemble the water line, cut off 6.5 mm of the plastic tubing to make sure you get a snug, leak-free connection.

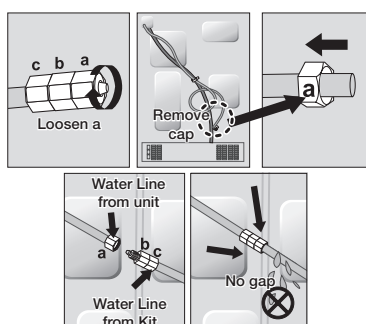

Before being used, the leakage in these places should be examined.

- Samsung Warranty does not cover WATER LINE INSTALLATION.
- It will be done at customer's charge unless the retail price includes installation cost.
- Please contact Plumber or Authorized Installer for the installation if needed.
- If Water leakage occurs due to improper installation, Please contact installer.

INSTALLING A SODASTREAM 60 L CO₂ CARBONATOR (FOR SPARKLING WATER REFRIGERATORS ONLY - OPTIONAL)

To use the Sparkling Water feature on your refrigerator, you need to install a Sodastream 60 L CO₂ Carbonator. If you don't have a sparkling water refrigerator, go to page 22.

Purchasing Sodastream 60 L CO₂ Carbonators

- Purchase SodaStream 60 L Carbonators at the nearest SodaStream retailer or on line at **www.sodastream.com**.
- USE ONLY SodaStream 60 L Carbonators. SAMSUNG and SODASTREAM are not legally responsible for any damage, including, but not limited to, property damage caused by gas leakage from the use of generic carbonators (or CO₂ cylinders (60 L)). The sparkling water system in your SAMSUNG refrigerator is designed to work ONLY WITH SodaStream 60 L Carbonators.
- We suggest buying extra carbonators for later use. Store extra carbonators in a cool, open space, well out of the reach of children.



If sparkling water is produced when the internal refrigerator temperature or the temperature of the CO₂ cylinder is high, you may hear a "horn sound".

When you turn on your refrigerator for the first time, you should not generate sparkling water production until after approximately 2 hours. When you purchase a new CO₂ cylinder, be sure to store it in a cool dry place until you are ready to install it -5 ~ 20 °C.

If the cylinder is stored in higher temperatures, it may build up extra internal pressure, which could create a "horn sound" when sparkling water is produced.

Water Line Hookup

- Make sure that you have connected the refrigerator to a water line before installing the cylinder.

Installing a Carbonator into the Refrigerator

To install a new SodaStream 60 L Carbonator in the refrigerator, follow these steps:

1. Open the Cylinder Cover.

- The refrigerator comes from the factory with the Sparkling Water function set to Off. If the Sparkling Water function is Off, the OFF icon is displayed on the Display Panel.

Refer to Page 42 : Turning Off the Sparkling Water Function.



2. Attach the SodaStream 60 L Carbonator to the Regulator, and then rotate it clockwise.

- You must use a SodaStream™ 60 L CO₂ Carbonators.
- Replacement SodaStream cylinders are available for easy exchange or refill at local SodaStream retailers.
- Visit for more information.



www.sodastream.com.au (Australia) or **www.sodastream.co.nz** (New Zealand), **www.sodastream.co.za** (South Africa)

- In Australia and New Zealand, please return empty CO₂ Cylinder to the service or information counter at your local retailer for exchange/refill.



- All costs associated to the refill or exchange of the CO₂ Cylinder are that of the refrigerator owner.
- Thread of CO₂ cylinder is different according to country by country.

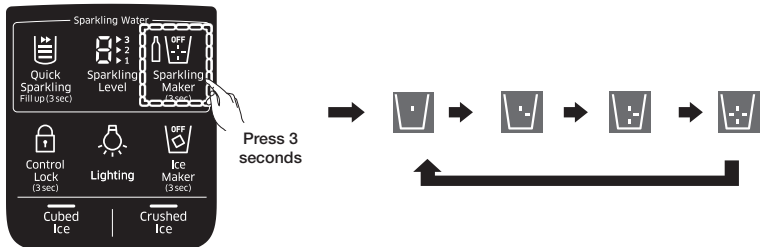

<p>3. Push the SodaStream 60 L Carbonator into the Support.</p>	
<p>4. Lock the SodaStream 60 L Carbonator into place by pressing the Lever.</p> <ul style="list-style-type: none"> • The inner pressure of the Carbonator may make it difficult to press the lever down. Hold the lever as shown in the illustration on the right, and then push down. • If you don't lock the Carbonator into place, the refrigerator won't produce sparkling water. • If the Carbonator is not tightly connected to the Regulator, it will leak CO₂ gas, producing a hiss. If this occurs, repeat Steps 2, 3, and 4, making sure that the Carbonator is firmly attached and locked into place. 	
<p>5. Press the Sparkling Maker button 3 seconds to run the Sparkling Making function. Wait about 20 minutes. (the amount of time needed for a medium level of carbonation) while the refrigerator makes sparkling water.</p> <ul style="list-style-type: none"> • To make sparkling water, the refrigerator injects CO₂ from the CO₂ cylinder into water stored in the Sparkling Water tank. The water enters the tank through the refrigerator's water supply line. <div data-bbox="276 820 1036 1067">  <p>The diagram illustrates the Sparkling Maker function. On the left, a control panel shows the 'Sparkling Maker' button (a glass with a checkmark) being pressed. Below it, a label says 'Press 3 seconds'. To the right, a sequence of four glasses shows the progression of carbonation: the first is empty, the second has a small amount of bubbles, the third has more, and the fourth is full of bubbles. Arrows connect the glasses in sequence, with a long arrow looping back from the fourth glass to the first, indicating a continuous cycle.</p> </div>	
<p>6. To remove any residual substances that may be in the water, dispense 2 or 3 large glass fulls of Sparkling Water and empty them into a sink.</p>	

For more information about using the Sparkling Water function, see Using the Sparkling Water Function.

COMPLETING THE SET UP

Now that you have your new refrigerator installed in place, you are ready to set up and enjoy the features and functions of the appliance. By completing the following steps, your refrigerator should be fully operational.

1. Make sure your refrigerator is in an appropriate location with reasonable clearance between it and the wall. Refer to installation instructions in this manual.
2. Once the refrigerator is plugged in, make sure the interior light comes on when you open the doors.
3. Set the Temperature control to the coldest temperature and wait for an hour. The freezer will get slightly chilled and the motor will run smoothly. Reset the refrigerator and freezer to the temperatures you want.
4. After you plug the refrigerator in. It will take a few hours to reach the appropriate temperature. You can store food and drinks in the refrigerator after the temperature is sufficiently cool.



If condensation or water drops appears on both sides of fridge door's central part, turn the Energy Saving mode off after removing the condensation.
(See the explanation of the Energy Saving button in USING THE CONTROL PANEL on page 24.)

Operating your French Door Refrigerator

USING THE MAIN CONTROL PANEL

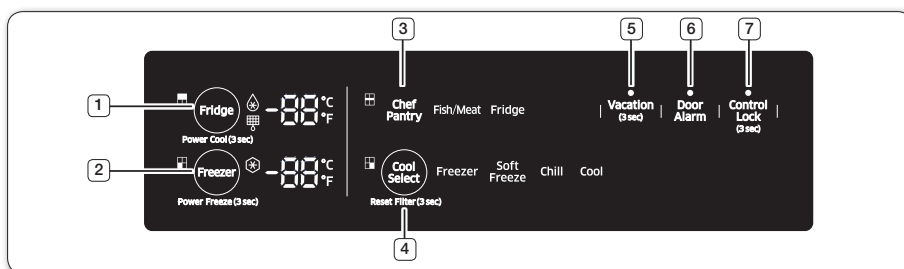

(1) Fridge (Hold 3sec for Power Cool)



The Fridge button serves two purposes:

- To set the Fridge to your desired temperature.
 - To turn the Power Cool function on and off.
1. To set the Fridge temperature, touch the Fridge button to set the refrigerator to the temperature you want. You can set the temperature 7 °C and 1 °C .
 2. Power Cool function
Touch and hold this button for 3 seconds to decrease the time needed to cool products in the Refrigerator. It can be helpful if you need to quickly cool easily spoiled items or if the temperature in the fridge has warmed dramatically (For example, if the door was left open).

(2) Freezer (Hold 3 sec for Power Freeze)



The Freezer button serves two purposes:

- To set the Freezer to your desired temperature.
 - To turn the power freezer function on and off.
1. To set the Freezer temperature, touch the Freezer button to set the Freezer to your desired temperature. You can set the temperature -15 °C and -23 °C.
 2. Power Freezer function
Touch and hold this button for 3 seconds to decrease the time needed to freeze products in the Freezer.
It can be helpful if you need to quickly freeze easily spoiled items or if the temperature in the freezer has warmed dramatically (For example, if the door was left open).
When you use this function the energy consumption of the refrigerator will increase. Remember to turn it off when you don't need it and return the freezer to your original temperature setting. If you need to freeze a large amount of food, activate Power Freeze function at least 20 hours before.

(3) Chef Pantry	
Chef Pantry	<p>Chef pantry will change to Fish/Meat or Fridge Mode automatically depending on the set fridge temperature.</p> <p>The Fish/Meat Mode lets you store fish and meat at its freshest for a short period of time.</p> <p>To store fish or meat for longer, put it into the Cool Select Room and select the "Freezer" or "Soft Freeze" functions.</p> <ul style="list-style-type: none"> If you set the fridge temperature to 1~2 °C, the Chef Pantry changes to Fish/Meat Mode and the Fish/Meat icon lights. The Chef Pantry is set to -1 °C in the Fish/Meat mode. If you set the fridge temperature to 3~7 °C, the Chef Pantry changes to Fridge Mode and the Fridge Icon turns on.



(4) CoolSelect (Hold 3 sec for Reset Filter)	
	<ul style="list-style-type: none"> The CoolSelect button lets you set the Cool Select Room on the bottom right of your refrigerator to one of four settings: Freezer, Soft Freezing, Chill, or Cool. To reset the water filter life indicator. After you replace the water filter, touch and hold this button for 3 seconds to reset the water filter life indicator.
Freezer	<p>Touch Freezer to set the Cool Select Room to the same temperature as the freezer.</p> <ul style="list-style-type: none"> Use this setting to keep frozen food fresh.
Soft Freeze	<ul style="list-style-type: none"> Touch Soft Freeze to set the temperature in the Cool Select Room to -5 °C. This feature helps keep meat and fish fresh longer.
Chill	<ul style="list-style-type: none"> Touch Chill to set the temperature of the Cool Select Room to -1 °C.

Cool	<ul style="list-style-type: none"> Touch Cool to set the temperature of the Cool Select Room to 2 °C. You can keep water, juice, soft drinks, beer, etc. cold.
-------------	---

Filter	
	<p>Water filter usage</p> <p>This icon lights when you need to change the filter, usually after the refrigerator has dispensed about 300 gallons of water (after about 6 months). The icon will blink red for several seconds when you open or close the door.</p> <p>After you install the new water filter, reset the filter indicator by touching and holding the CoolSelect/hold 3 sec for Filter Reset button for 3 seconds.</p> <ul style="list-style-type: none"> If water is not dispensing or dispensing slowly, you need to replace the water filter because the water filter is clogged. Some areas have large amounts of lime in their water, which causes the water filter to clog more quickly.

(5) Vacation(3 sec)	
Vacation	Touching this button for 3 seconds to turn Vacation mode on and off.
	<p>If you are going on vacation or business trip or you do not need to use the refrigerator, press the Vacation button. When you select vacation button for fridge compartment(including chef pantry room) off, display LED of Vacation will be on(fridge and chef pantry room's LED and Star Display's all LED will be off).</p> <p>The freezer and CoolSelect will work normally during vacation mode is on.</p>
	 <p>It is strongly requested to remove foods in the fresh-food compartment and do not leave the door open when you select Vacation function.</p>

(6) Door Alarm	
Door Alarm	<p>To turn the door open alarm on and off</p> <p>If the door alarm is set to On, an alarm beeps if any refrigerator door is left open for more than two minutes. The beeping stops when you close the door. The door alarm function is pre-set to On in the factory. You can turn it off by touching and then releasing this button. You can turn it back on in the same fashion. The icon lights up when the function is on.</p> <p>When the Door Alarm function is on and the alarm sound is triggered, the Door Alarm Icon will blink while the alarm sounds.</p>

(7) Main Control Panel Lock (3 sec)	
Control Lock	<p>Touch and hold the Control Lock button for 3 seconds to lock the Main Control Panel. If Main Control Lock is on, none of the buttons on the Main Control Panel work.</p> <p>(However, the dispenser control panel and the dispenser level will continue to work, because the dispenser control panel has its own, independent Control Lock button.)</p> <p>To unlock the Main Control Panel, touch and hold the main Control Lock button for 3 seconds again.</p>
	 <ul style="list-style-type: none"> • The Main Control Panel locks automatically one minute after the last button input, after you have set Main Lock Control on. • If you Lock the Dispenser Control Panel, the Lock Icon () on the STAR DISPLAY is displayed. The Dispenser Control Lock doesn't affect the Main Control Panel. The Main Control Panel control panel has its own lock button. If you lock the Main Control Panel, the dot on the Main Control Lock () lights.

STAR DISPLAY INDICATORS

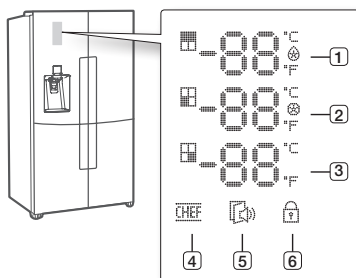

The Star Display contains indicators and icons that graphically display the state of your refrigerator. For example, the Power Cool mode indicator lights when the Power Cool mode is on.

(1) Fridge

1. Fridge temperature display (°C/°F).
2. 'Power Cool' Mode Indicator ().

(2) Freezer

1. Freezer temperature display (°C/°F).
2. 'Power Freezer' Mode Indicator ().

(3) Cool Select (Cool Select Room)

The displayed temperature corresponds to the Cool Select Room setting.

Freezer: Same as the freezer temperature (°C).

Soft Freeze: -5 °C

Chill: -1 °C

Cool: 2 °C

(4) Chef Pantry

If this icon lights up, it means that the CHEF Mode is operating now.

(5) Door Open indicator

If the door is open for a certain length of time, this indicator icon blinks and the refrigerator beeps.

(6) Dispenser Control Panel Lock

If you Lock the Dispenser Control Panel, the Lock icon () on the Door is displayed.

The Dispenser Lock doesn't affect the Main Control Panel. The Main Control Panel has its own lock button.

If you lock the Main Control Panel, the dot on the Main Control Lock () will be displayed.

USING THE DISPENSER
CONTROL PANEL

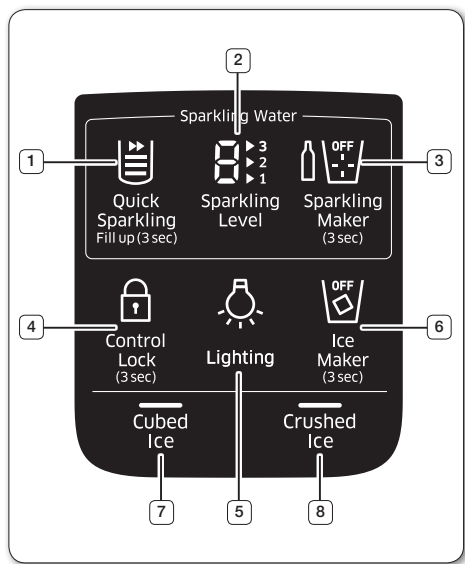

(For Sparkling model Only)

(1) Quick Sparkling / Fill up (3 sec)

When you touch the Quick Sparkling button, the (►►) icon lights and the refrigerator makes sparkling water rapidly at the level indicated by the Sparkling Level icon.

If there is no sparkling water in the Sparkling Water tank, the refrigerator will begin making sparkling water immediately.

If there is sparkling water in the tank, the refrigerator applies the Quick Sparkling function the next time it makes sparkling water.

When you replace the SodaStream carbonator, press the 'Quick Sparkling/ Fill up (3 sec)' button for 3 seconds to activate the Fill up function.



The refrigerator will fill the sparkling water tank with water and inject CO₂ gas into the water to make sparkling water.

The sparkling level of the water may differ from the set level, depending on the amount and CO₂ concentration of the sparkling water remaining in the tank.

If the tank is empty or the concentration is very low, the refrigerator will make sparkling water at the level Indicated by the Sparkling Level icon.

The Quick Sparkling icon (►►) also indicates the amount of sparkling water in the sparkling water tank. When the tank is full, three bars light.

The number of bars lit decreases as the amount of sparkling water decreases.

(2) Sparkling Level



The refrigerator can make sparkling water in three sparkling levels: low (1), medium (2), and high (3).

To set the sparkling level, tap the Sparkling Level button. Each time you tap the button, the small numbers on the right side (▶1, ▶2, ▶3) change.

Stop when you have selected the sparkling level you want.

The next time the refrigerator makes sparkling water, it will make it at the sparkling level you have selected.

The large number on the left (8) indicates the current sparkling level.

If there is previously produced sparkling water inside the Sparkling Water tank, the refrigerator dispenses sparkling water at this level. (Changes to the sparkling level do not take effect until the next time the refrigerator makes sparkling water.

(3) Sparkling Maker (3 sec)



Touch and hold for 3 seconds to turn on the sparkling water maker.

Touch and hold for 3 seconds again to turn it off.

If the SodaStream carbonator runs out of CO₂, the icon turns on () and you must replace the carbonator with a new one.



The Cylinder icon may turn on and off briefly several times when the cylinder has a little CO₂ remaining.

(4) Dispenser Control Panel Lock (3 sec)



Touch this button for 3 seconds to turn on Dispenser Control Lock which locks the dispenser and dispenser panel buttons so the buttons can not be used.

The Control Lock icon lights up to indicate you've activated the Control Lock function. Press 3 seconds to unlock.

(5) Lighting



Touching this button sets the Dispenser LED lamp (under the display) to continuous mode so that it stays on continuously.

The button also lights up.

If you want the Dispenser lamp to come on only when some one uses the dispenser, touch this button to turn the continuous mode off.

(6) Ice Maker (3 sec, On/Off)

To turn off or on the ice maker, touch and hold the Ice Maker button for 3 seconds.

The 'Off' LED lights and the Ice-Maker stops making ice. To turn the ice maker on, touch and hold the Ice Maker button again for 3 seconds. The 'Off' LED turns off.



We recommend you stop ice making if the following occur:

- There is enough ice in the ice bucket.
- You want to save water and energy.
- Water is not being supplied to the refrigerator.



If the ice maker function is ON, and the water line is not connected, there will be a water valve noise from the back of the unit. If this occurs, touch and hold the Ice Maker button for 3 seconds to turn the ice maker off.

(7) Cubed Ice (8) Crushed ice

Cubed Ice

Crushed Ice

Touch the Cubed Ice or Crushed ice button to select the type of ice you want dispensed.

Each time you touch the button, the cubed and crushed ice modes alternate and the Cubed or Crushed ice icon lights up, indicating your selection.

CHANGING THE WATER FILTER



- To reduce the risk of water damage to your property **DO NOT** use generic brands of water filters in your SAMSUNG Refrigerator.

USE ONLY SAMSUNG BRAND WATER FILTERS. SAMSUNG is not legally responsible for any damage, including, but not limited to, property damage caused by water leakage from the use of a generic water filter. SAMSUNG Refrigerators are designed to work **ONLY WITH SAMSUNG** Water Filter.

The Filter light turns red to let you know when it is time to change your water filter cartridge.

To give you time to get a new filter, the red light comes on just before the capacity of the current filter runs out. Changing the filter on time provides you with the freshest, cleanest water from your refrigerator.



TO CHANGE THE WATER FILTER

1. Shut off the water supply. Pull down the filter cover, and then turn the water filter (1) about 1/4 turn, counter-clockwise.
2. Pull the water filter (1) from the case filter (2).

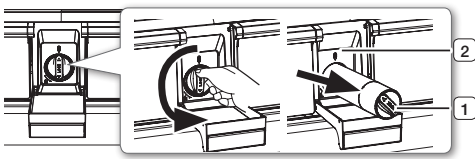

- To change the water filter more easily, shut off the water supply valve.
- Sometimes, it is hard to disassemble the water filter because impurities in the water cause it to stick. If you are having difficulties, grip the water filter firmly and pull it hard.

- When you pull out the water filter, a little water can leak from the opening. This is normal. To minimize the water leaks, keep the filter cartridge horizontal when you pull it.

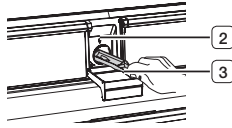

- To prevent overflow, empty the water filter tray (3) and dry around the filter case (2).
1. Insert the new filter into the filter case (4).
 2. Push the filter in, and then turn it clockwise until it locks.



- If you have trouble inserting the water filter because of high water pressure, shut off the water supply valve.
- The locked symbol should be lined up with the indicator line.

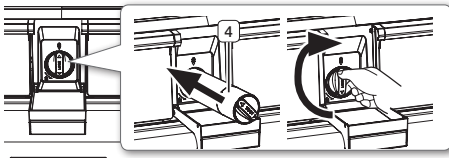

3. Touch the **"CoolSelect"** button for about 3 seconds to reset the water filter. The color of the indicator () changes from red to off.

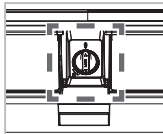

4. If you turned off the water supply, turn it back on.



- For a replacement water filter, visit your local home Improvement center, go to SamsungParts.com on line, or contact your authorized Samsung dealer. Be sure the replacement water filter has the SAMSUNG logo on the box and on the water filter.

Removing any residual matter inside the water supply line after installing the water filter.

1. Turn ON the main water supply if you turned it off when you installed the water filter.
2. Run water through the dispenser until the water runs clear (approx. 6 to 7 minutes). This will clean the water supply system and remove air from the lines.
3. Additional flushing may be required in some households.
4. Open the Refrigerator door and make sure there are no water leaks coming from the water filter.

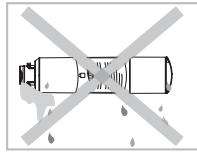

- Be sure to flush the dispenser thoroughly, otherwise water may drip from the dispenser. This means that there is still air in the line.

Reverse Osmosis Water Supply IMPORTANT:

The pressure of the water supply coming out of a reverse osmosis system going to the water inlet valve of the refrigerator needs to be between 35 and 120 psi (241 and 827 kPa).

If a reverse osmosis water filtration system is connected to your cold water supply, the water pressure to the reverse osmosis system needs to be a minimum of 40 to 60 psi (276 to 414 kPa.) If the water pressure to the reverse osmosis system is less than 40 to 60 psi (276 to 414 kPa):

- Check to see whether the sediment filter in the reverse osmosis system is blocked. Replace the filter if necessary.
- Allow the storage tank on the reverse osmosis system to refill after heavy usage.
- If your refrigerator has a water filter, it may further reduce the water pressure when used in conjunction with a reverse osmosis system. Remove the water filter.

If you have questions about your water pressure, call a licensed, qualified plumber.

CONTROLLING THE TEMPERATURE

RECOMMENDED FREEZER AND REFRIGERATOR COMPARTMENT TEMPERATURES

The recommended temperatures for the Freezer and Refrigerator Compartments are -19 °C and 3 °C respectively.

If the temperature of the Freezer and Refrigerator Compartments are too high or low, adjust the temperature manually.

CONTROLLING THE FREEZER TEMPERATURE

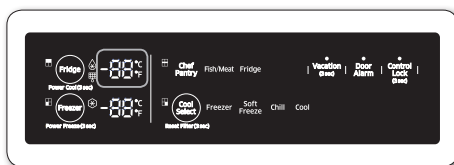

Recommended Temp. : -19 °C

Freezer

The Freezer temperature can be set between -23 °C and -15 °C to suit your particular needs. Press the Freezer button repeatedly until the desired temperature is shown in the temperature display. The temperature will change by 1 °C with each press. See below.

-19 °C → -20 °C → -21 °C → -22 °C → -23 °C →
-15 °C → -16 °C → -17 °C → -18 °C → -19 °C.



- The Freezer or Fridge temp indicator will blink when the temperature in the fridge or freezer compartment goes up dramatically.

(The Freezer or Fridge temperature indicator will stop blinking when the temperature in the Freezer or Fridge becomes normal. If the temperature indicator does not stop blinking after several hours, please contact a Samsung Service Center.

Power Freeze

The Power Freeze function substantially speeds up the freezer compressor, causing the freezer to cool down rapidly to a temperature you choose.

This icon will light up when you press and hold the Freezer button for 3 seconds.

Power Freeze is useful if you need to quick freeze an item, to make a large quantity of ice, or to cool the freezer rapidly if it has warmed dramatically (for example, if the door was left open).

To turn the Power Freeze function off manually, press the Freezer button, and then re-set the Freezer temperature.

Power Freeze turns off automatically after 50 hours to decrease energy consumption.

When you use this function, the energy consumption of the refrigerator will increase.

If you need to freeze large amounts of food, activate the Power Freeze function at least 20 hours before.

CONTROLLING THE FRIDGE TEMPERATURE

The fridge temperature can be set between 1 °C and 7 °C to suit your particular needs. Press the Fridge button repeatedly until the desired temperature is shown in the temperature display. The temperature will change by 1 °C with each press. See below.

3 °C → 2 °C → 1 °C → 7 °C → 6 °C → 5 °C →
4 °C → 3 °C.

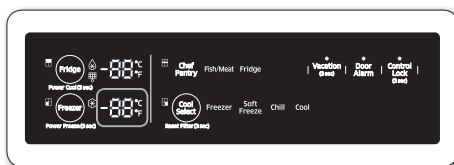

Recommended Temp. : 3 °C



- The temperature of the Freezer, Fridge, or Cool Select Room may rise when you open the doors too frequently, or if a large amount of warm or hot food is placed inside.
- This may cause the digital display to blink. Once the Freezer and Fridge temperature return to their normal set temperatures, the blinking will stop.
- If the blinking continues, you may need to “reset” the Refrigerator. Try unplugging the appliance, waiting for around 10 minutes, and then plugging the power cord back in.
- If there is a communication error between the Display and Main Controller, the Convertible Display light may blink. If the blinking continues for a long period of time, please contact a Samsung Electronics Service Center.

USING THE COLD WATER DISPENSER

PUSH THE APPROPRIATE ICE TYPE BUTTON TO SELECT WHAT YOU WANT DISPENSED.

Using the ice lever (1)

Push the Ice lever dispenser (1) gently with your glass. Ice will be released from the dispenser. You can choose the type of ice by pushing the cubed or crushed button first.

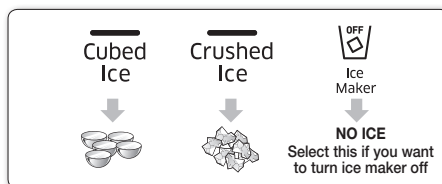

Using the Water lever (2)

Push the Water lever dispenser (2) gently with your glass. Water will be released from the dispenser.

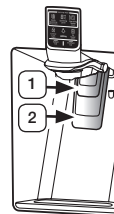

- If you push the water and Ice lever at about the same time, the dispenser operates only the option you actually selected or pushed first.
- Please wait 1 second before removing the glass after dispensing water to prevent spills. Do not pull out the dispenser lever after dispensing ice or water. It comes back automatically.

Using the Ice & Water Dispenser together

To get Ice and water, push the Ice lever (1) first for ice, then move your glass down and press the water dispenser lever (2) for water.

MAINTAINING THE ICE BUCKET

- To clean the ice bin/bucket, wash with a mild detergent, rinse well, and dry thoroughly. Do not use harsh or abrasive cleaners or solvents.
- Ice is made in cubes. When you select "Crushed", the ice maker grinds the ice cubes into crushed ice.
- When you select Cubed Ice after using the Crushed Ice mode, a small amount of residual crushed ice might be produced.
- The ice cubes generated by the rapid ice making process will look white, which indicates they are generated normally.
- If ice doesn't come out, pull out the ice bucket and press the Test button located on the right side of ice maker. See the illustration under Making Ice below.
- Do not press the Test button continuously if the tray is filled with ice or water. Water may overflow or ice may jam the bucket.

MAKING ICE

- To fill the ice bucket to maximum capacity after installation, follow these steps:
 1. Allow your refrigerator to operate and cool down for 24 hours (or 1 full day).
 - Waiting 24 hours will allow your ice maker to cool properly.
 2. Dispense 4 to 6 ice cubes into a glass.
 3. After another 8, and then 16 hours, dispense a full glass of ice.
- To test the ice maker, press the Test button on the ice maker. You will hear the refrigerator chime (ding-dong). When the chime sounds, release the Test button.
- The chime sounds automatically again to let you know the ice maker is working well.

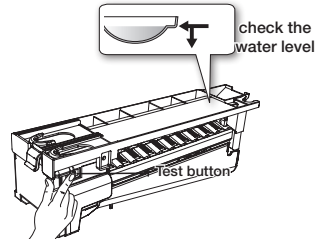

- If you want to remove ice cubes without using the ice bucket, turn the ice maker off and remove the front cover from the ice maker. Then, remove the ice cubes. Note that with the cover removed, the ice cubes in the ice maker can spill out.



- Do not put food in the ice bucket. If you store food in the ice bucket, the food can strike the ice maker when you open or close the door, causing damage to the ice maker.



- Note that the ice cubes in the ice bucket may spill out over the drawer when you remove the ice bucket from the drawer. If this occurs, be sure to pick up any ice cubes that spill.



- If a power failure occurs, ice cubes may melt then freeze together when the power comes back on, causing the dispenser to stop working.

To prevent this problem, after a power failure, pull out the ice bucket and discard the residual ice or water.



- If you use all the ice at once, you must repeat ice making Steps 2 and 3. However, only wait 8 hours before dispensing the first 4 to 6 ice cubes. This will replenish the ice cubes and ensure maximum ice production.

USING THE ICE OFF FUNCTION

When you select the Ice Off mode, remove all ice cubes from the bucket.

If you leave the ice cubes in the bucket, the ice cubes may clump together, making it difficult to remove them.

To remove the ice bucket safely and avoid injury, hold the bottom of the bucket with one hand and the side of the bucket with the other.

Then, lift up on the ice bucket, and pull it straight out.

To put the ice bucket back in, push it firmly straight back.



- If the ice bucket is not pushed firmly into place, ice in the bucket can melt.

If the bucket does not fit, turn the helix 90 degree (see the last illustration on the right, below) and try again.

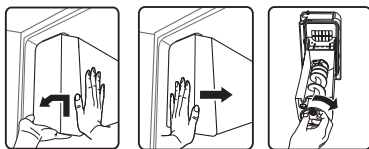

- The inside of the ice bucket stays cold when it is operating. Do not reach deep inside the ice bucket.



- Use only the ice maker provided with the refrigerator. The water supply to this refrigerator must be installed/connected by a suitably qualified person. Connect to a potable water supply only.

GOING ON VACATION...

If you are going on a long vacation or business trip and won't use the water or ice dispensers for a long time:

- Close the water valve. Otherwise, water leakage may occur.
- Remove all food.
- Unplug the refrigerator.
- Wipe excess moisture from inside and leave the doors open. Otherwise, odor and mold may develop.

ICE MAKER DO'S AND DON'TS

Do not put your fingers, hands or any other unsuitable objects in the chute or ice-maker bucket.

- You can hurt yourself or damage the refrigerator. Never put your finger or any other objects in the dispenser opening. You can injure yourself.
- Do not try to disassemble the ice maker.
- Do not wash or spray the ice bucket with water while it is in the refrigerator. Remove it to clean it.



- When you insert the Ice maker tray, be sure that the tray is well centered at the entrance. Otherwise, the tray may be stuck.

Water clouding phenomenon



- All water provided to the refrigerator flows through a core alkaline water filter. In the filtering process, the pressure of the water that has flowed out of the filter has increased, and the water has become saturated with oxygen and nitrogen. When this water flows out into the air, the pressure plummets and the oxygen and nitrogen get supersaturated, which results in gas bubbles. The water may temporarily look misty or cloudy due to these oxygen bubbles. After a few seconds, the water will look clear.

USING THE SPARKLING WATER FUNCTION (FOR SPARKLING WATER REFRIGERATORS ONLY - OPTIONAL)

With a Sodastream CO₂ cylinder installed, your refrigerator can make and dispense sparkling (carbonated) water.

Making Sparkling Water

To produce sparkling water, press and hold the Sparkling Maker button for 3 seconds. When the carbonation process starts, the short lines inside the cup icon turn on one by one clockwise. When the process is complete, all short lines turn solid.



If you leave the Sparkling Water Production function on, and the amount of Sparkling Water becomes low, the refrigerator automatically enters the Sparkling Water production mode and makes more. However, if you turn off the Sparkling Water Production function, the refrigerator will not make additional sparkling water, even if there is little sparkling water left in the Sparkling Water tank.

Sparkling Water Production Time

Depending on the Carbonation (Sparkling) Level you set (See Controlling the Carbonation Level on page 40), the amount of time it takes the refrigerator to complete the sparkling water production process changes. The table below lists the production times by Carbonation Level. The refrigerator is pre-set at the factory to Level 2.

Quick Sparkling enables you to produce sparkling water within 10 minutes. (It consumes more CO₂ gas than production at Level 3.)

Carbonation (Sparkling) Level	Level 3 - High	Level 2 -Mid	Level 1 - Low
Production Time	About 30 minutes	About 20 minutes	About 10 minutes
Available Capacity	1.16 quarts (1.1 L)	1.16 quarts (1.1 L)	1.16 quarts (1.1 L)

Dispensing Sparkling Water

To dispense sparkling water, press the Sparkling-Selection lever above the dispenser down (See the illustration on page 40.) Then, push the Ice/Sparkling Water lever gently with a glass. As time passes, the sparkling water dispensing speed can change. When the water tastes strongly carbonated, the dispensing speed can be faster. When the carbonation is weaker, the dispensing speed can slow.

The dissolved CO₂ in the sparkling water can also cause the water to pop out when you dispense it. In addition, due to the pressure fluctuations in the Sparkling Water Tank, the water stream may shake or become intermittent.

If you keep dispensing sparkling water, the water stream may become unstable or break up. This is caused by changes in pressure in the Sparkling Water Tank. It is not a defect.

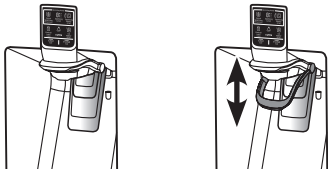

After dispensing Sparkling water, lift the Sparkling-selector lever up.



Do not hang on the Sparkling-selector lever and do not use excessive force to pull it down or lift it up.

Water Dripping

Some time after you have dispensed sparkling water, a few drops of sparkling water can escape from the dispenser. The water dripping is not a product defect, but a natural result of mixing CO₂ and water.

Controlling the Carbonation Level

You can change the sparkling water's carbonation level by pressing the Sparkling Level button. Each time you press the Sparkling Level button, the carbonation level changes as follows:

Medium (Level-2) → Strong (Level-3) → Weak (Level-1) → Medium (Level-2). As you press the button, the small numbers on the right side of the button light up in succession, indicating the level change.

The change in carbonation level is applied the next time the refrigerator makes sparkling water.

- If there is previously produced sparkling water inside the Sparkling Water tank, the refrigerator dispenses sparkling water with the previous carbonation level. (Again, changes in the carbonation level do not take effect until the next time the refrigerator makes sparkling water. The change does not affect sparkling water that is already made.)
- While the refrigerator is producing sparkling water, the Sparkling Level icons light up in rotation (Level-1 → Level-2 → Level-3 → Level-1, etc.). If you press the Sparkling Water button again while the carbonation level is being displayed, the carbonation level changes. The change in the carbonation level will take effect the next time the refrigerator makes sparkling water.
- The main number on the left side indicates the sparkling level of the current sparkling water, while the small numbers on the right side indicate the sparkling level for the next process. Even if you change the sparkling level while the refrigerator is producing sparkling water, the change is not applied to the current process but is applied to the next process.

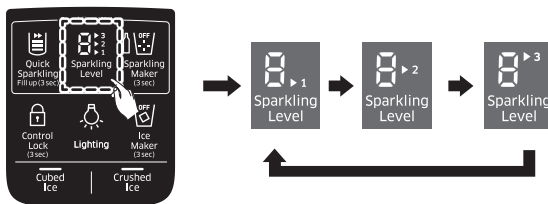

The Sparkling Level is set to Level 2 at the factory. If the sparkling water tastes too strong or too weak, change the carbonation level. Level 1 provides a milder carbonation, Level 3 a stronger carbonation.

- If there is a power interruption when the refrigerator is making sparkling water, the refrigerator may restart the carbonation process when power returns and put too much carbonation into the water. If this occurs, we recommend throwing out the overly carbonated water and starting the process again.
- The lifetime of the CO₂ cylinder can vary, depending on the Sparkling Levels you choose.

Turning Off the Sparkling Water Function

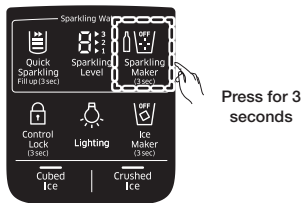

To turn off the Sparkling Water function, press the Sparkling Maker button for 3 seconds.



Any sparkling water remaining in the Sparkling Water tank after you have turned off the Sparkling Water function can still be dispensed.

Replacing a SodaStream Carbonator

If the cylinder icon () turns on, replace the SodaStream 60 L Carbonator with a new one. To replace a Carbonator, follow these steps:

1. Lift up the Lever holding the SodaStream 60 L Carbonator in place.	
2. Pull the Carbonator out of the Support.	
3. Rotate the Carbonator counterclockwise to remove it from the Regulator.	
4. To install a new SodaStream 60 L Carbonator, follow the directions for installing a Carbonator starting at Step 2 in Installing a Carbonator into the Refrigerator on pages 25 and 21.	

Notes

- If you open the refrigerator door while the refrigerator is making sparkling water, it will stop. When you close the door, it will resume making sparkling water in about a minute.
- If you keep dispensing sparkling water, the water stream may become unstable or break up. This is caused by changes in pressure in the Sparkling Water Production Tank. It is not a defect.
- If the water hose is kinked or water is not supplied properly, the Carbonation Level of the Sparkling Water will be high. This occurs because the same amount of carbon dioxide (CO₂) is dispensed by the SodaStream 60 L Carbonator regardless of the amount of water in the Production Tank.
- If the Sparkling Water function is on and you dispense about 1.16 quarts (1.1 L) of sparkling water, the refrigerator automatically begins making more sparkling water.
- If you are not going to be home for a long period of time, do not want to use the Sparkling Water function any more, or you are moving:
 1. Press the Sparkling Maker button for three seconds to turn off the Sparkling Water function.
 2. Empty the Sparkling Water tank by dispensing all the water in the tank.
 3. Remove the CO₂ Cylinder.
- When you dispense sparkling water, the CO₂ in the water causes the dispenser stream to disperse. To ensure that all the water dispenses into your glass, place the glass closer to the dispenser nozzle.
- If you replace a SodaStream 60 L Carbonator that has gas remaining, the Cylinder icon on the display may not turn on for a period of time.
- Purchase cylinders (60 L) at the nearest Sodastream retailer or on line at www.sodastream.com.

PARTS AND FEATURES

Use this page to become more familiar with the parts and features of the Refrigerator.

RF34H9960S4, SRF1028CCRS

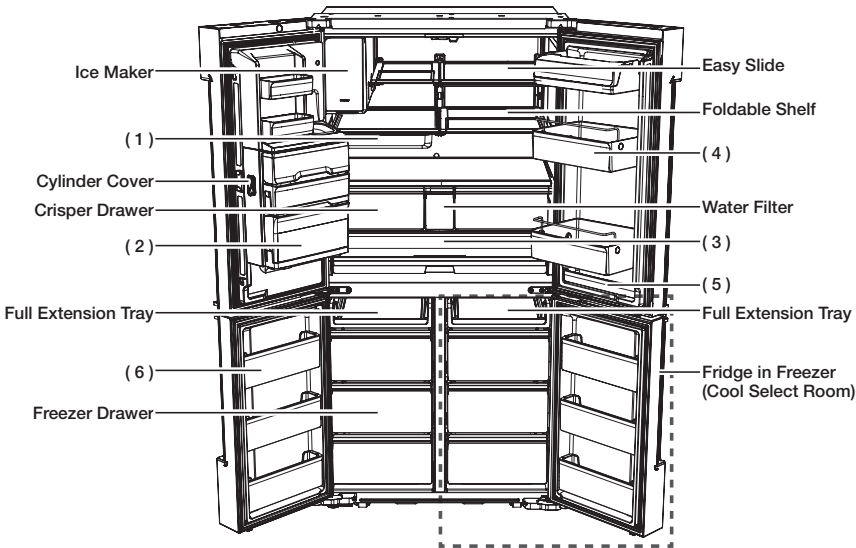

SRF751CCSS

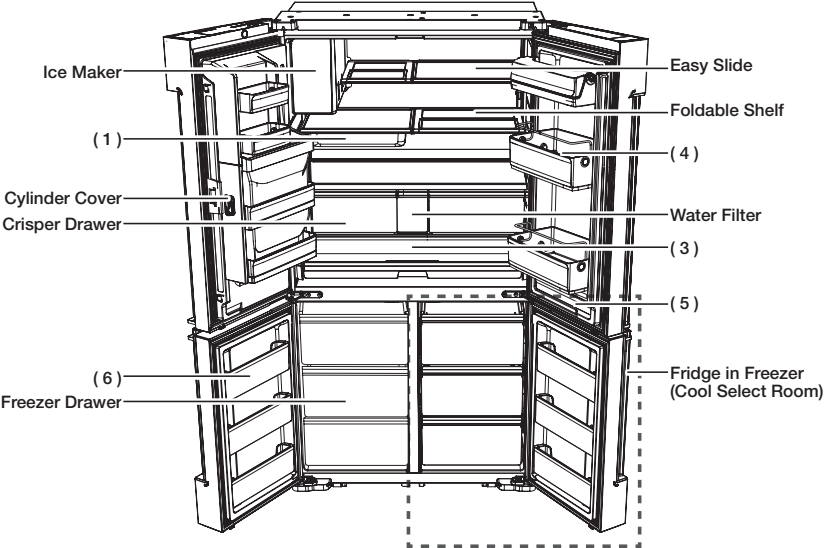

(1) Chef Pan

It may put under the shelf or into a Chef pantry, also it can use in the oven as well.



- Chef pan is not suitable for use in the microwave oven.

(2) Chef Basket

It is able to take out the whole basket for use easily.

Chef basket is able to storage a cheese or vegetable which use often.

(3) Chef Pantry

It can storage the Chef Pan and can be controlled as "Fish/Meat" or "Fridge" depends on the fridge temperature.

(4) Crystal Door Bin

The FLEX DIVIDER can storage the beverage side by side with two layers to prevent beverage falling down.

(5) Utility Corner

It is good for storage the small snack.

(6) Tilting Door Bin

It can incline to take off the groceries easily.



For the greatest energy efficiency, leave all selves, drawers, and baskets in their original positions as shown in the illustration on the previous page.



When closing the door, make sure the Vertical Hinged Section is in the correct position to avoid scratching the other door. If the Vertical Hinged Section is reversed, put it back into the correct position, and then close the door.

Moisture may appear at times on the Vertical Hinged Section.

If you close one door with too much force, the other door may open.



When the door opens, the interlock switch automatically turns off the auger motor in the ice maker for safety reasons.



If the interior or exterior LED lamp has gone out, please contact Samsung service.

MULTI-PURPOSE DOOR BIN

A detachable divider makes it convenient to store food.

How to Use the FLEX DIVIDER

- When not in use, leave the Flex Divider flipped over as shown in the diagram.

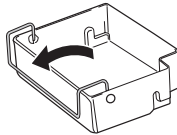

- Flip the Flex Divider to position (1) to prevent items from falling out and over.

(1)

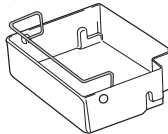

- Flip the Flex Divider to position (2) to use it as a divider.

(2)

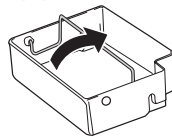

How to User the Tilting Door Bin

- The freezer door bin is designed to be tilted for easy access.
- Tilt the freezer door bin for easy access when inserting food, and put it back upright when closing the door.
- Do not insert too much food in the freezer door bin. The door may not close properly.
- To avoid collisions between the freezer door and drawers, leave the freezer door wide open when using the freezer drawers.

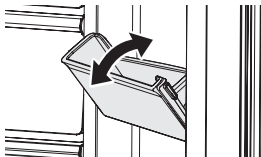

CHEF PAN

Using the chef pan for the first time

- Make sure to clean the chef pan before use.
- Put vinegar and neutral detergent in a 2:1 ratio into warm water. Apply this water to a sponge, and use this sponge to wipe out the chef pan. Rinse the pan in warm water.



This is to remove impurities coming from the production process.

Precautions on cooking on the chef pan



- Chef pan is not suitable for use in the microwave oven.

Storage

- Use a stainless steel detergent with a soft cloth or sponge to clean the pan.

REMOVING THE REFRIGERATOR ACCESSORIES

1. Door Bins Compartment

- To remove - Simply lift the bin up and pull straight out.
- To relocate - Slide it in above the desired location and push down until it stops. Alternatively, for the top bin of the refrigerator, insert the bin so that it is aligned with the marked line inside the door.



There is a marked line for the top bin only.

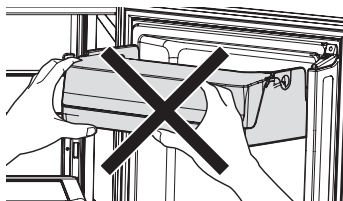

- Do not hold the front side of the door bin when inserting it. The door bin may not fit the door.
- To replace, insert the door bin fully to the marked line of the door. Otherwise, it may not be attached to the door properly.

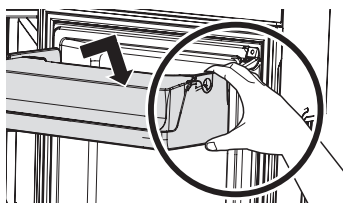

- Hold the rear side of the door bin with both hands, and press down and insert it fully to the marked line inside the door.

Removing bins with covers (Depend on models)

- For bins with covers, open the Door Bin Cover, and then pull the bin out using both hands.

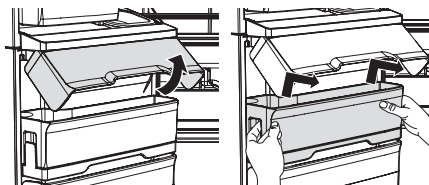

Removing the Chef Basket (Depend on models)

- Tip the Chef Basket top towards you, and then pull the Basket out using both hands.

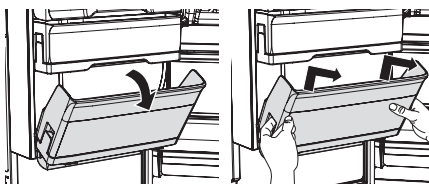

Removing bins

- Simply lift the bin up and pull straight out.

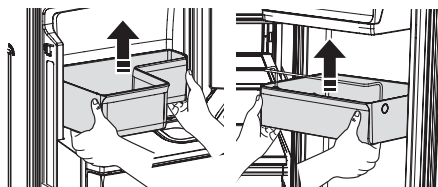

Injuries can occur if the door bins are not firmly attached to the doors. Do not allow children to play with the bins. Sharp corners of the bins may cause injury.



Do not adjust a bin full of food. Remove the food first.

- To remove dust, wash the bins in water.

2. Tempered Glass shelves

- To remove - Tilt up the front of the shelf in the direction shown (1) and lift it up vertically (2). Pull the shelf out.
- To relocate - Tilt the front of the shelf up and guide the shelf hooks into the slots at a desired height. Then, lower the front of the shelf so that the hooks can drop into the slots.



The Tempered Glass shelves are heavy. Use special care when removing them.

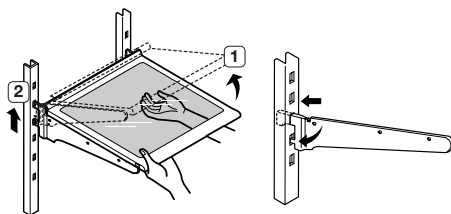

- When re-installing the glass shelves, make sure that all the hooks on both sides of the shelf are firmly engaged in the slots of the support.

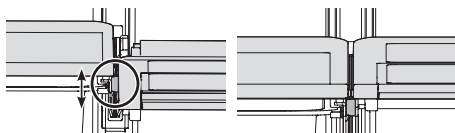

3. Chef Pan

- To insert or remove the chef pan from the shelf, hold both sides of the pan with both hands. Pull out to remove. Push in to re-insert.
- Use only for stainless steel detergent when wash it.

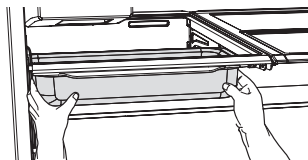

4. Vegetable & Fruit Drawers (EZ Fresh Zone)

- Holding the drawer with one hand, lift it up a little bit while pulling it forward, and then pull it out of the refrigerator.



Remove the door bins before removing the drawer to prevent damage to the door bins.

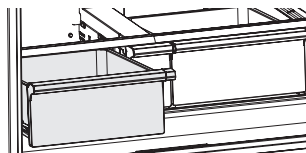

5. Removing the vegetable storage shelf

1. Slide out the left vegetable drawer.

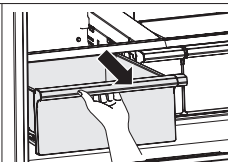

2. Slide in the right foldable shelf.

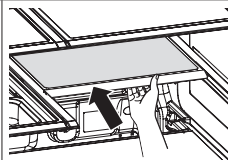

3. While supporting the vegetable storage shelf with one hand, lift it up with the other hand.

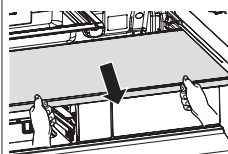

4. Through the empty space created by removing the foldable shelf, take out the vegetable storage shelf. (Reinsert in the reverse order of the removal steps.)

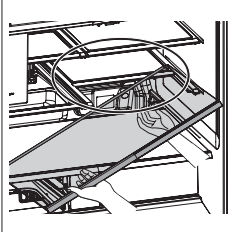

6. Removing the Shelf Pantry

1. Slide out the vegetable drawer.

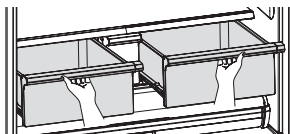

2. Remove the vegetable storage shelf.

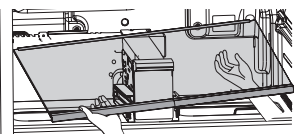

3. Loosen two screws at the back of the water tank.

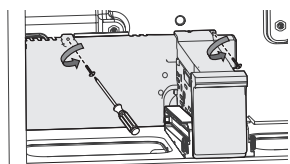

4. Take the rear right corner of the water tank and pull it out a little. (Note that this isn't to fully remove the water tank)



Take caution not to remove the Water Hose.

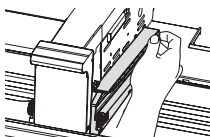

5. Lift up the water tank to remove from the Shelf Pantry, and bend the pantry cover to unlock it from the left.

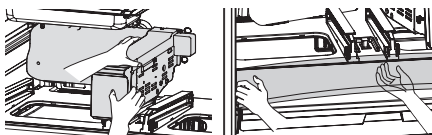

6. Take out the Shelf Pantry. (Reinserting it follows the reverse order of its removal.)

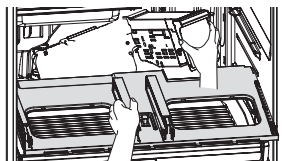

7. Removing the Deodorizer

- Fridge Room

TYPE 1

- Pull out the Chef Pantry, and then pull out the Deodorizer while pushing the Deodorizer cover clip up using a finger.

TYPE 2

- Remove the Chef Pantry drawer, and remove the Deodorizer from inside the fridge room by unlocking the cover clip.

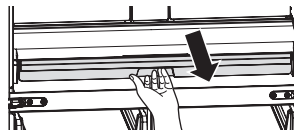

The appearance or detaching instructions of the deodorizer depends on the model. Please check your model first.

TYPE 1



TYPE 2

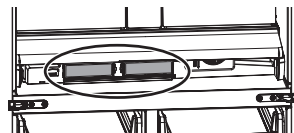

- Freezer/Cool Select Room: Remove the bottom Drawer, and then pull out the Deodorizer while pushing the Deodorizer cover clip up using a finger.

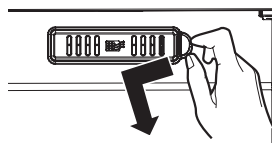
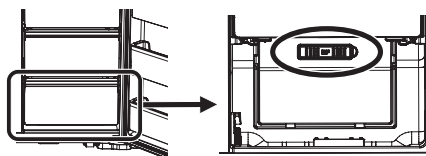

8. Cleaning the Deodorizer

- Clean the Deodorizer once every two years or whenever you feel its performance has diminished. Dry the Deodorizer under the sun for 24 hours and then replace it in the reverse order of its removal.

CLEANING THE REFRIGERATOR



WARNING Do not use benzene, thinner, Clorox, or car detergent to clean the refrigerator. They can damage the surface of the appliance and may cause a fire.

Do not spray the refrigerator with water while it is plugged in. This can cause an electric shock.

To clean the refrigerator, follow these steps:

1. Unplug the power cord of the refrigerator.
2. Slightly dampen a soft, lint-free cloth or paper towel with water.



Do not use any kind of detergent to clean the refrigerator because that can discolor or damage the refrigerator.

3. Wipe the inside and outside of refrigerator until it is clean and dry.
4. Plug the power cord of the refrigerator back in.

CHANGING THE INTERIOR LIGHTS

Freezer / Fridge LED Lamp

- If the LED Lamp Cover is stained with foreign substances, the LED lamp may not look bright. Wipe the surface cover with clean dry cloth to return the light to full brightness.



CAUTION Do not disassemble or replace the LED type lighting yourself. To replace the LED lights, contact a Samsung service center or your authorized Samsung dealer.



If you attempt to replace the LED lamps yourself, you risk subjecting yourself to an electric shock or serious personal injury.

Sparkling Water: Operational Notes

- Be sure to use genuine Soda Stream Cylinders from authorized resellers.



- The refrigerator starts making sparkling water about 10 seconds after you turn on the Sparkling Water Production function.
- If you open the refrigerator door while the refrigerator is making sparkling water, it will stop. When you close the door, it will resume making sparkling water in about a minute.
- If there is a power interruption when the refrigerator is making sparkling water, the refrigerator may re-start the carbonation process when power returns and put too much carbonation into the water. If this occurs, we recommend throwing out the overly carbonated water and starting the process again.
- If you keep dispensing sparkling water, the water stream may become unstable or break up. This is caused by changes in pressure in the Sparkling Water Tank. It is not a defect.
- If the water hose is kinked or water is not supplied properly, the Carbonation Level of the Sparkling Water will be high. This occurs because the same amount of the carbon dioxide (CO₂) is dispensed by the Cylinder regardless of the amount of water in the Production Tank.
- The useful life of a SodaStream carbonator will vary, depending on the level of carbonation you select.
- If you are not going to be home for a long period of time, do not want to use the Sparkling Water function any more, or you are moving:
- To reduce the processing time, use the Quick Sparkling option.
Quick Sparkling sets the Sparkling Level to 3 (high). The refrigerator applies the Quick Sparkling setting the next time it makes sparkling water.
If the refrigerator is making sparkling water when you select the Quick Sparkling option, the refrigerator adjusts the Sparkling Level automatically.
To cancel this option, press the Quick Sparkling button again within 20 seconds after activating it.

- If the cylinder icon () turns on, replace the current SodaStream Carbonator with a new one.
- To dispense the sparkling water, pull down the Sparkling-Selector Lever, and push and hold the Ice/Sparkling Water Lever with a glass.



CAUTION

- Please remove the Soda Stream Carbonator from the compartment located in the left door of the refrigerator before you transport the refrigerator.
1. Press the Sparkling Maker button for three seconds to turn off the Sparkling Water function.
 2. Empty the Sparkling Water tank by dispensing all the water in the tank.
 3. Remove the Soda Stream Carbonator.



Producing sparkling water with Quick Sparkling consumes more CO₂ gas. (Quick Sparkling requires 30 % to 50 % more CO₂ gas compared to Sparkling Level 3.)

OPERATING

Troubleshooting

PROBLEM	SOLUTION
The refrigerator does not work at all or it does not chill sufficiently.	<ul style="list-style-type: none"> • Check if the power plug is properly connected. • Check if the set temperature on the digital display is warmer than the freezer or fridge inner temperature. If it is, set the freezer or fridge to a colder temperature. • Is the refrigerator in direct sunlight or located near a heat source? • Is the back of the refrigerator too close to the wall, preventing proper ventilation?
The food in the fridge is frozen.	<ul style="list-style-type: none"> • Check if the set temperature on the digital display is too low. • Try setting the refrigerator to a warmer temperature. • Is the temperature too low? Set the refrigerator warmer. • Did you store food with a high moisture content in the coldest part of the refrigerator? Try moving those items to the other shelves in the fridge instead of keeping them in the colder areas or bins.
You hear unusual noise or sounds.	<ul style="list-style-type: none"> • Check if the refrigerator is level and stable. • Is the back of the refrigerator too close to the wall, preventing proper ventilation? Try moving the back of the refrigerator at least 2 inches from the wall. • Was anything dropped behind or under the refrigerator? • If you hear a "ticking" sound from inside the refrigerator, this is normal. It occurs because various parts contract or expand in response to temperature changes in the refrigerator interior. • If it sounds as if something is hitting something else inside the refrigerator, this is normal. The sound is caused by the compressor operating at high capacity.
The cabinet-door sealing area of the appliance is hot and condensation is occurring.	<ul style="list-style-type: none"> • Some heat is normal as anti-condensators are installed in the vertical hinged section of the refrigerator to prevent condensation. • Is the refrigerator door ajar? Condensation can occur when you leave the door open for a long time.
The Ice Maker is not producing ice.	<ul style="list-style-type: none"> • Did you wait for 12 hours after installing the water supply line before making ice? • Is the water line connected and the shut-off valve opened? • Did you manually stop the ice making function? • Is the freezer temperature too warm? Try setting the freezer temperature lower.
You can hear water bubbling in the refrigerator.	<ul style="list-style-type: none"> • This is normal. The bubbling comes from refrigerant circulating through the refrigerator.

There is a bad smell in the refrigerator.	<ul style="list-style-type: none"> • Check for spoiled food. • Foods with strong odors (for example, fish) should be tightly covered. • Clean out your freezer periodically and throw away any spoiled or suspicious food.
Frost forms on the walls of the freezer.	<ul style="list-style-type: none"> • Is the air vent blocked? Remove any obstructions so air can circulate freely. • Allow sufficient space between the stored food for efficient air circulation. • Is the freezer drawer closed properly?
The water dispenser is not functioning.	<ul style="list-style-type: none"> • Is the water line connected and the shut-off valve opened? • Has the water supply line tubing been crushed or kinked? • Make sure the tubing is free and clear of any obstruction. • Is the water tank frozen because the fridge temperature is too low? Try selecting a warmer setting on the Digital display.
The auto close system does not work with the freezer door.	<ul style="list-style-type: none"> • Is there an imbalance between the right and left parts of the door? • Open and close the door smoothly 1~2 times. After you do this, the auto close system usually works properly again. • Try opening the door smoothly to avoid unbalancing the right part and the left part of the door.
Condensation or water drops forms on both sides of fridge door's central part.	<ul style="list-style-type: none"> • Condensation or water drops may form if the humidity is too high while the refrigerator is operating. • If condensation or water drops appears on both sides of fridge door's central part, turn the Energy Saving mode off after removing the condensation.
Sparkling water is not dispensed.	<ul style="list-style-type: none"> • Is the water line connected and the shut-off valve opened? • Did you pull down the Sparkling-Selector Lever? • Is the Sparkling Water Production Function Off icon on? Press the Sparkling Maker button for 3 seconds to turn on sparkling water production. The Sparkling Water Production function is set to OFF at the factory. Set it ON to get sparkling water. • Is the Sparkling Maker icon blinking? The blinking icon indicates the refrigerator is producing sparkling water. Please wait until the icon stops blinking. • Is the Sparkling Water Cylinder empty? If the SodaStream Carbonator runs out of CO₂, the cylinder icon () turns on. If the refrigerator dispenses a small amount or no sparkling water, replace the SodaStream 60 L Carbonator with a new one. • Is the refrigerator door open? If the door is open, Sparkling water/Water/Ice are not dispensed. • Is the cylinder lever unlocked? Please open the cylinder cover and lock the cylinder lever. • Is the Control Lock on?

The Quick Making option makes a wind noise while in process.	<ul style="list-style-type: none"> While the Quick Making option is active, the SodaStream Carbonator cycles through injecting and discharging CO₂ gas, which can make such a noise.
The taste of the sparkling water is weak.	<ul style="list-style-type: none"> Increase the Sparkling Level of the sparkling water. When the taste of the sparkling water is too weak or there is no other taste than water, replace the SodaStream Carbonator with a new one. If you use the Fill Up (3 sec) option immediately after replacing the Carbonator, the sparkling water tastes stronger or weaker than normal, depending on the amount and concentration of the CO₂ remaining in the water tank.
The taste of the sparkling water is too high.	<ul style="list-style-type: none"> Decrease the Sparkling Level of the sparkling water. (Sparkling Levels - 1: Low, 2: Medium, 3: High) Empty the sparkling water tank, and then set the Sparkling Level lower. When the refrigerator makes sparkling water, it will make water at a lower level of carbonation. <ul style="list-style-type: none"> * To empty the sparkling water tank, press and hold the “Sparkling Maker” button for 3 seconds to turn the Sparkling water maker off. Dispense all the remaining sparkling water. After emptying the sparkling water, press and hold the “Sparkling Maker” button for 3 seconds to activate the sparkling water maker. * Did you make sparkling water by pressing the “Quick Sparkling/Fill up” button and holding for 3 seconds? If there was still sparkling water in the tank before you started the Quick Fill function, sparkling water of a higher concentration than configured can be produced. Once the sparkling water tank is emptied, the refrigerator will make sparkling water at the Sparkling Level you have set.
The taste of the sparkling water did not change after you changed the sparkling concentration level.	<ul style="list-style-type: none"> If you change the concentration level, the new level is applied to the subsequent production. That is, the change does not affect the sparkling water in the sparkling water tank nor does it affect the sparkling water production currently in progress. The change is only applied to subsequent productions.
After you replaced the Sodastream Carbonator, no sparkling water is being produced.	<ul style="list-style-type: none"> After replacing the SodaStream Carbonator, be sure to touch and hold the “Quick Sparkling/Fill up” button for 3 seconds to reset the SodaStream Carbonator.

<p>The sparkling water suddenly stops being dispensed even though the operation is still in progress.</p>	<ul style="list-style-type: none"> • Check if the short lines inside the cup icon are turning on one by one in a clockwise direction. This indicates that the sparkling water is being produced. When production is complete, all of the short lines inside the cup icon turn on. When production is complete, the refrigerator will dispense sparkling water. • If the refrigerator is not dispensing sparkling water, check if “OFF” is displayed above the cup icon over the Sparkling Maker button. • This indicates that the sparkling water tank is empty and the automatic sparkling water production function is turned off. To produce sparkling water, touch and hold the “Sparkling Maker” button for 3 seconds to start production.
<p>The Sparkling function is turned off but sparkling water continues to be dispensed.</p>	<ul style="list-style-type: none"> • Even if you turn off the sparkling water production function, sparkling water is dispensed for as long as there is sparkling water in the sparkling water tank. • If you do not use the sparkling water maker for an extended period of time, stop the automatic sparkling water production function and remove the sparkling water through the dispenser.
<p>The sparkling water dispenses at a slower rate than regular water.</p>	<ul style="list-style-type: none"> • Check if the tap water valve is closed or the hose is bent and if water is being supplied to your home at the normal pressure. If the tap water pressure is too low, the sparkling water maker may not work properly because too little water is being supplied to the sparkling water tank. • When water is supplied to the sparkling water tank from a water purifier, sparkling water may not be produced properly because too much water is required over a short period of time. We recommend that you do not dispense water from a water purifier less than five minutes before you start a sparkling water production cycle. • If this problem continues, please contact the water purifier manufacturer or ask a plumber to increase the tap water pressure to a normal level.
<p>The sparkling water is not cold enough and tastes flat.</p>	<ul style="list-style-type: none"> • If you continuously produce a lot of sparkling water, you may not be able to enjoy the true taste of sparkling water because there is too little time to cool the water. To drink sparkling water at its optimal state, you have to ensure sufficient cooling time before you dispense sparkling water. • We recommend you wait at least four hours after connecting tap water to the refrigerator before making and dispensing sparkling water.
<p>The sparkling “OFF” icon is displayed, but the sparkling water maker is not turned off.</p>	<ul style="list-style-type: none"> • Check if the short lines inside the cup icon are turning on one by one in a clockwise direction. This indicates that sparkling water is being produced and cannot be stopped immediately. However, if you press and hold the “Sparkling Maker” button for 3 seconds during production, then the “OFF” icon is displayed over the cup icon and automatic sparkling water production will turn off after the current production cycle is complete.
<p>The concentration control function is disabled during sparkling water production.</p>	<ul style="list-style-type: none"> • Check if the short lines inside the cup icon are turning on one by one in a clockwise direction. This indicates that the sparkling water is being produced. Since the sparkling water concentration cannot be changed during a production operation, change the concentration level when production is complete and the blinking stops. The refrigerator applies the new Sparkling Level to the next production operation.

<p>Sparkling water is produced continuously.</p>	<ul style="list-style-type: none"> • Has the sparkling water production time limit been reached? The length of time during which sparkling water is generated is determined by the Sparkling Level setting. (Level 1: Approx. 10 mins; Level 2: Approx. 20 mins; Level 3: Approx. 30 mins) Please wait until the sparkling water production time has been reached. • Check if the refrigerator door is open. If the refrigerator door is open, the sparkling water maker stops to prevent noise that is generated by the sparkling water production. If you open the door frequently, the time during which sparkling water is produced may be extended depending on the Sparkling Level setting. Close the refrigerator door and wait until the sparkling water production time limit has been reached.
<p>The cylinder icon did not turn on when the SodaStream Carbonator remove.</p>	<ul style="list-style-type: none"> • If you remove a SodaStream Carbonator that has a little gas remaining, the cylinder icon on the display may turn on after a several seconds. • If you remove a SodaStream Carbonator that has gas remaining, the cylinder icon on the display may not turn on for a period of time.

OPTIMUM OPERATING ENVIRONMENT FOR SPARKLING WATER

Item	Descriptions
[Water temperature] “We recommend that you only drink sparkling water after it is sufficiently cooled.”	<ul style="list-style-type: none"> • Since the temperature of the sparkling water greatly affects the taste of the water, if the temperature of water is not sufficiently low, you may not be able to get the right taste. • We recommend you wait at least four hours after connecting tap water to the refrigerator before making and dispensing sparkling water. • We also recommend that when the refrigerator is producing sparkling water, that you dispense as little regular water as possible so that the sparkling water is produced with cold water. • If you drink 0.5 gallons (2 liters) or more a day, the water may not be cooled sufficiently. • To store dispensed sparkling water, put the water in an air tight container and keep it in a cold section of the refrigerator for better taste.
[CO₂ concentration of sparkling water 1] “To ensure a precise CO ₂ concentration, dispense all the remaining sparkling water before producing additional sparkling water.”	<ul style="list-style-type: none"> • Because the current system does not measure the CO₂ concentration of the sparkling water remaining in the sparkling water tank before it starts to produce additional sparkling water, the resulting concentration may differ from the from the desired level, depending on the remaining sparkling water in the sparkling water tank. • If you haven't used the sparkling water function for an extended period of time (one week or longer), first remove all the sparkling from the sparkling water tank, and then produce fresh sparkling water for better quality and taste.
[CO₂ concentration of sparkling water 2] “To maintain a precise CO ₂ concentration of sparkling water, replace the CO ₂ cylinder before it is depleted.”	<ul style="list-style-type: none"> • As the time to replace the SodaStream Carbonator comes closer, the CO₂ concentration decreases and sparkling water becomes weaker. • If the SodaStream Carbonator runs out of CO₂, the cylinder icon () turns on. If this occurs, replace the SodaStream 60 L Carbonator with a new one.
[Preparing sparkling water – Capacity] “If you want to have sufficient sparkling water prepared in the morning, we recommend that you touch and hold the Sparkling Maker button for 3 seconds to start the sparkling water production before going to bed.”	<ul style="list-style-type: none"> • If you do not press and hold the “Sparkling Maker” button for 3 seconds to start the sparkling water production, the amount of sparkling water in the water tank may be less than the maximum production capacity of 1.1 liters. • Since a production time of 10~30min is required if you need 1.1 liters or more of sparkling water, we recommend producing and storing enough sparkling water in advance or at least securing the maximum sparkling water capacity of 1.1 liter by pressing and holding the “Sparkling Maker” button for 3 seconds to start sparkling water production.

Item	Descriptions
<p>[The water supply pressure and water taste]</p> <p>"If a water purifier is connected to the refrigerator, we recommend that you do not dispense water from the water purifier less than five minutes before you start a sparkling water production cycle."</p>	<ul style="list-style-type: none"> • If water pressure to the refrigerator is low, check if the water line valve is fully open and if the water line is kinked or bent. • If a water purifier is connected to the refrigerator, there may be insufficient water supply for sparkling water production. • If there is insufficient water supply, the concentration of the sparkling water increases or the amount of sparkling water may decrease.

OPEN SOURCE ANNOUNCEMENT

The software included in this product contains open source software.

You may obtain the complete corresponding source code for a period of three years after the last shipment of this product by sending an email to **mailto:oss.request@samsung.com**.

It is also possible to obtain the complete corresponding source code in a physical medium such as a CD-ROM; a minimal charge will be required.

The following URL **<http://opensource.samsung.com/opensource/ConnectedProduct/seq/0>** leads to the download page of the source code made available and open source license information as related to this product.

This offer is valid to anyone in receipt of this information.



Ambient Room Temperature Limits

This refrigerator is designed to operate in ambient temperatures specified by its temperature class marked on the rating plate.

Class	Symbol	Ambient Temperature range (°C)	
		IEC 62552 (ISO 15502)	ISO 8561
Extended Temperate	SN	+10 to +32	+10 to +32
Temperate	N	+16 to +32	+16 to +32
Subtropical	ST	+16 to +38	+18 to +38
Tropical	T	+16 to +43	+18 to +43



Internal temperatures may be affected by such factors as the location of the fridge/freezer, ambient temperature and the frequency with which you open the door. Adjust the temperature as required to compensate for these factors.

English



Correct Disposal of This Product (Waste Electrical & Electronic Equipment)

(Applicable in countries with separate collection systems)

This marking on the product, accessories or literature indicates that the product and its electronic accessories (e.g. charger, headset, USB cable) should not be disposed of with other household waste at the end of their working life. To prevent possible harm to the environment or human health from uncontrolled waste disposal, please separate these items from other types of waste and recycle them responsibly to promote the sustainable reuse of material resources. Household users should contact either the retailer where they purchased this product, or their local government office, for details of where and how they can take these items for environmentally safe recycling.

Business users should contact their supplier and check the terms and conditions of the purchase contract. This product and its electronic accessories should not be mixed with other commercial wastes for disposal.

Contact SAMSUNG WORLD WIDE

If you have any questions or comments relating to Samsung products, please contact the SAMSUNG customer care center.

COUNTRY	CALL	Web site
AUSTRIA	0800-SAMSUNG (0800-7267864) [Only for Premium HA] 0800-366661 [Only for Dealers] 0810-112233	www.samsung.com/at/support
COLOMBIA	Bogotá en el 600 12 72 Sin costo en todo el país 01 8000 112 112 Y desde tu celular #726	www.samsung.com/co/support
EIRE	0818 717100	www.samsung.com/ie/support
HONG KONG	3698 4698	www.samsung.com/hk/support (Chinese) www.samsung.com/hk_en/support (English)
INDIA	1800 3000 8282 (Toll Free) 1800 266 8282 (Toll Free) 1800110011 (Toll Free) 30308282	www.samsung.com/in/support
MALAYSIA	1800-88-9999 603-77137477 (Overseas contact)	www.samsung.com/my/support
NEW ZEALAND	0800 726 786	www.samsung.com/nz/support
PANAMA	800-0101	www.samsung.com/latin/support (Spanish) www.samsung.com/latin_en/support (English)
PHILIPPINES	1-800-10-726-7864 [PLDT Toll Free] 1-800-8-726-7864 [Globe Landline and Mobile] 02-422-2111 [Standard Landline]	www.samsung.com/ph/support
SINGAPORE	1800-SAMSUNG(726-7864)	www.samsung.com/sg/support
SOUTH AFRICA	0860 SAMSUNG (726 7864)	www.samsung.com/support
UK	0330 SAMSUNG (7267864)	www.samsung.com/uk/support



DA68-03013B-07