

Bottle Trap

Technical Overview

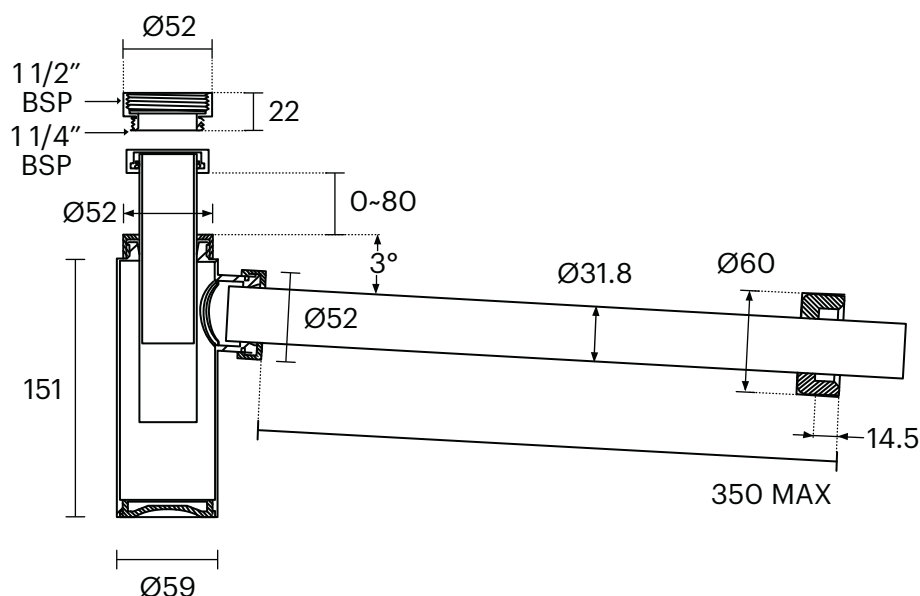

Part List:

- (A) 32x40mm Adaptor
- (B) Adjustable Inlet Tube
- (C) Compression Nut
- (D) Outlet Tube
- (E) Outlet Connection Cover Flange
- (F) Rubber Washer

Bottle Trap
3811000101 — Chrome

11 finishes available

Please note

- Bottle Trap can be connected to either a 32 or 40mm plug & waste with the use of the 32 x 40mm Adapter - Included.
- The outlet connection of the Bottle Trap is designed to connect to 40mm DWV pipe.
- The pipe should be cut square and chamfered/deburred.
- Apply a lubricant (O-ring lubricant or similar) to the 40mm DWV pipe and the rubber washer inside Outlet Connection Cover Flange to achieve an easy fit. Tighten all compression nuts and water test to ensure there are no leaks.
- Rogerseller recommends having the product on site before commencing rough in.
- Full installation instructions come with the product.

Specifications

It is a requirement of State Plumbing Codes that licensed plumbers carry out all tapware installations. All installations should comply with the relevant requirements of AS/NZS 3500 and local plumbing codes.

Care and Maintenance

[1] Product should be inspected for surface damage prior to installation. [2] Cleaning and handling of all finishes must be performed carefully. [3] Clean products using a soft cloth with warm soapy water only. [4] Never use harsh detergents or abrasive cleaners as these will damage the product. [5] Water marks can be removed from Matt Finishes with an application of a carnauba wax based non-abrasive polish on a microfibre cloth. [6] Do not use undue pressure when cleaning and wipe in one direction only. [7] Contact with harsh chemicals such as hair dye, hair bleach etc will result in damage to the finish. [8] Tapware should never be installed using acetone silicones. [9] Avoid the use of wax based furniture creams as this can result in a build up of deposits which will detract from the appearance. [10] Damage to finishes arising from improper installation or post installation use or failure to observe the above care and cleaning instructions will void all warranty agreements.

Warranty

Rogerseller tapware, bathroom fittings and sanitary ware are covered by a five (5) year warranty from date of purchase. For full terms and conditions please refer to rogerseller.com.au

Rogerseller Showrooms —

Melbourne

173-177 Barkly Avenue
Burnley VIC 3121
P 03 9429 8888

Sydney

18 Danks Street
Waterloo NSW 2017
P 02 8396 8700

Brisbane

74-76 McLachlan Street
Fortitude Valley QLD 4006
P 07 3251 4333

Concept Stores —

Southern Innovations

(Fishwick ACT)
P 02 6143 2666

Southern Innovations

(Mitchell ACT)
P 02 6129 7666

Southern Innovations

(Albury NSW)
P 02 6022 2777

Routleys Plumbing Innovations

(Malvern SA)
P 08 8291 3000

BOUNTYBRASSWARE 
www.bountybrassware.com.au

rogerseller.com.au