

VINTEC

TRANSTHERM

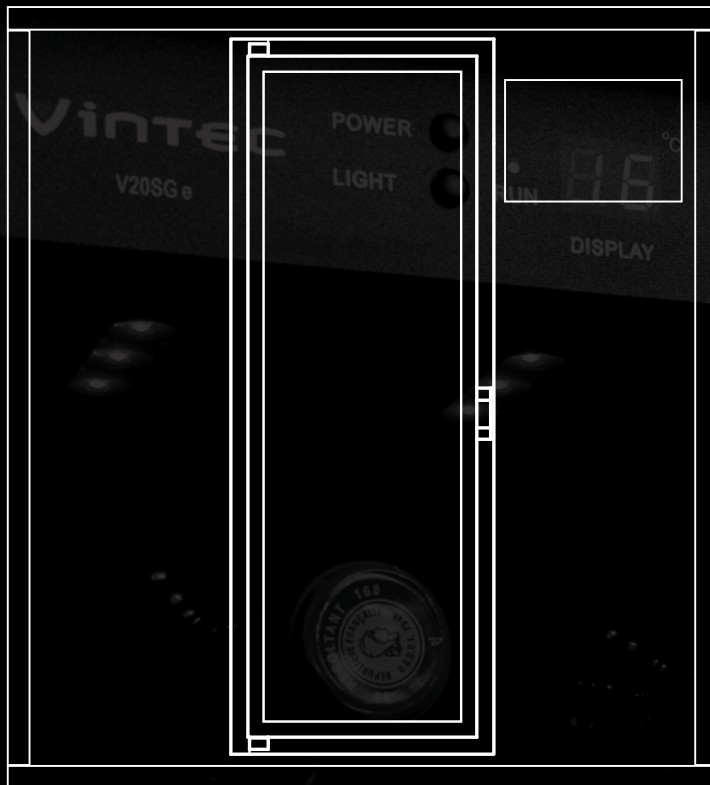

User Manual

Space Walk-in Cellar

ESPACE1000-KIT

ESPACE1500-KIT

ESPACE2000-KIT

ESPACE2500-KIT

ESPACE3000-KIT

ESPACE3500-KIT

ESPACE4000-KIT

ESPACE1000-EXT

Welcome

Thank you for your purchase of a Vintec product. We take particular care in manufacturing our products in terms of their design, ergonomics and ease of use. We hope that you will be completely satisfied with this product.

Safety

This wine cellar, together with its conditioning unit, is not intended for use by persons (including children) with reduced physical, sensory or mental capabilities, or lack of experience and knowledge, unless they have been given supervision or instruction concerning use of the appliance by a person responsible for their safety. Children should be supervised to ensure that they do not play inside the cellar or with any of its components.

! GENERAL WARNINGS:

- Do not use electrical appliances inside the cellar, unless they have been recommended in writing by the manufacturer.
- Do not store explosive substances inside the cellar appliance such as aerosols containing flammable propellant gas.

! R404A REFRIGERANT WARNING:

This appliance contains R404a refrigerant. Avoid safety hazards by carefully installing, handling, servicing and disposing of this appliance.

- Ensure that the tubing of the refrigerant circuit is not damaged during transportation and installation.
- The room for installing appliance must be at least **1m³ per 8g of refrigerant**. The amount of refrigerant charged in the appliance can be found on the rating plate on the appliance.
- Keep ventilation openings in the appliance enclosure, or in the built-in structure, clear of obstruction.



Important information that may impact your Manufacturer's Warranty

Adherence to the directions for use in this manual is extremely important for health and safety. Failure to strictly adhere to the requirements in this manual may result in personal injury, property damage and affect your ability to make a claim under the Vintec manufacturer's warranty provided with your product. Products must be used, installed and operated in accordance with this manual. You may not be able to claim on the Vintec manufacturer's warranty in the event that your product fault is due to failure to adhere to this manual.

Contents

Description of your wine cellar	3
Cellar	3
Conditioner	3
Power supply	4
Caring for the environment and saving energy	4
Installing your cellar	5
Dimensions	5
Preparation for installation	6
Components list	8
Assembly procedure	11
Technical specifications	17
Maintenance	17
Loading and storing your wine	18
Setting your cellar's temperature	19
Notes	20
Warranty	22

Standard wine serving temperatures (°C)

French		Australian	
Alsace	10°	Cabernet franc	16°
Beaujolais	13°	Cabernet sauvignon	17°
Sweet white Bordeaux	6°	Chardonnay	10°
Dry white Bordeaux	8°	Merlot	17°
Bordeaux reds	17°	Muscat à petit grain	6°
Burgundy whites	11°	Pinot noir	15°
Burgundy reds	14°	Sauvignon blanc	8°
Champagne	6°	Semillon	8°
Jura	10°	Shiraz	18°
Languedoc-Roussillon	13°	Verdelho	7°
Provence Rosé	12°	Other	
Savoie	9°		
Dry white Loire wines	13°		
Sweet white Loire wines	7°		
Loire reds	14°		
Rhône wines	15°		
Sweet wines from the South-West	7°		
Reds from the South-West	15°	Californian	16°
Sauternes	10°	Chilean	15°
		Spanish	17°
		Italian	16°

For more information, visit vintecclub.com/best-temp

Description of your wine cellar

Cellar

Exterior

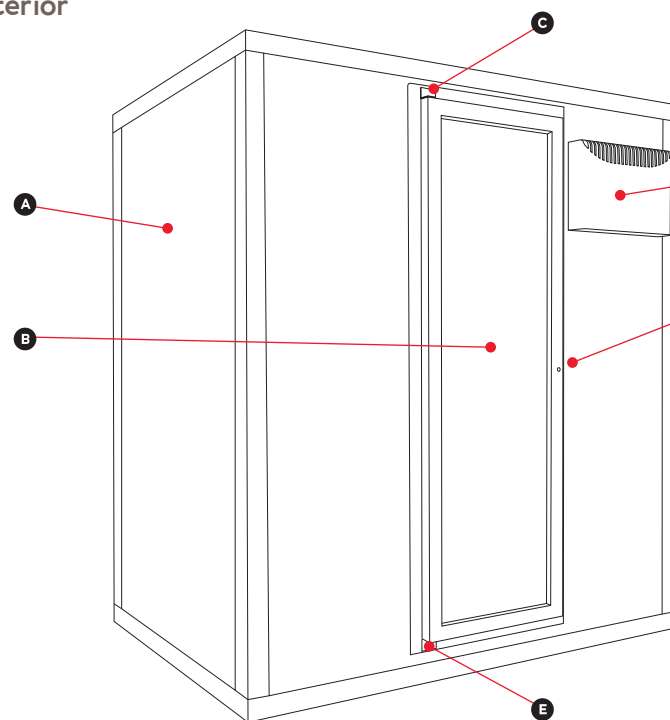

- A Body
- B Door
- C Upper hinge
- D Conditioner unit
- E Lower hinge
- F Lock

Interior



- G Shelf runners
- H Vertical shelving supports
- I Shelves

Conditioner

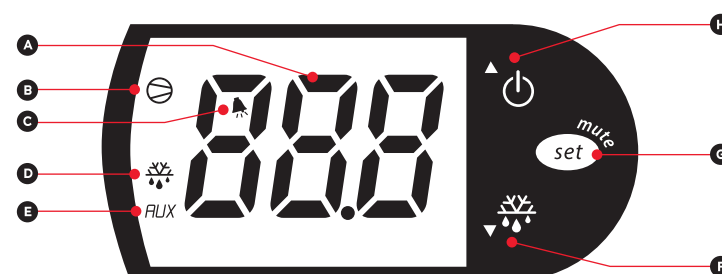

- | | |
|-------------------------------------|----------------------------------|
| A Temperature display | F Decrease temperature |
| B Compressor operation indicator | G Set / mute |
| C Abnormal temperature alarm | H Standby / increase temperature |
| D Defrost cycle operation indicator | I Exhaust air outlet |
| E Heater operation indicator | J Air intake |



Interior Door frame Exterior

Power supply

WARNING: For your personal safety, the wine cellar must be correctly earthed. Ensure that the socket is correctly earthed and that your installation is protected by a circuit breaker (30mA residual current device).

In future, if you move the cellar to a foreign country, check that the power supply characteristics of the conditioner correspond to the destination country (voltage, frequency) – consult a local electrician in that country for advice.

Caring for the environment and saving energy



Disposal of packaging

All packaging used by Vintec is made from recyclable materials.

After unpacking your cellar, take the packaging to a refuse collection point. For the most part, it will be recycled.

To save energy

- Install your wine cellar in a suitable location (see '**Installing your cellar**') and observe the recommended temperature ranges.
- Keep the door open for as short a time as possible.
- Ensure that the door seal is in good working order and that it is not damaged. If it is, contact your Vintec retailer.
- Disable any unusable appliances by unplugging them and cutting off the power lead.

Recycling: a caring gesture

Electrical and electronic equipment can have a harmful effect on the environment and human health owing to the presence of hazardous substances. Therefore, you should never trash electronic and electrical equipment with unsorted municipal waste.

In compliance with legislation relating to protecting and caring for the environment, your wine cellar does not use CFCs.

Installing your cellar

Cellar dimensions

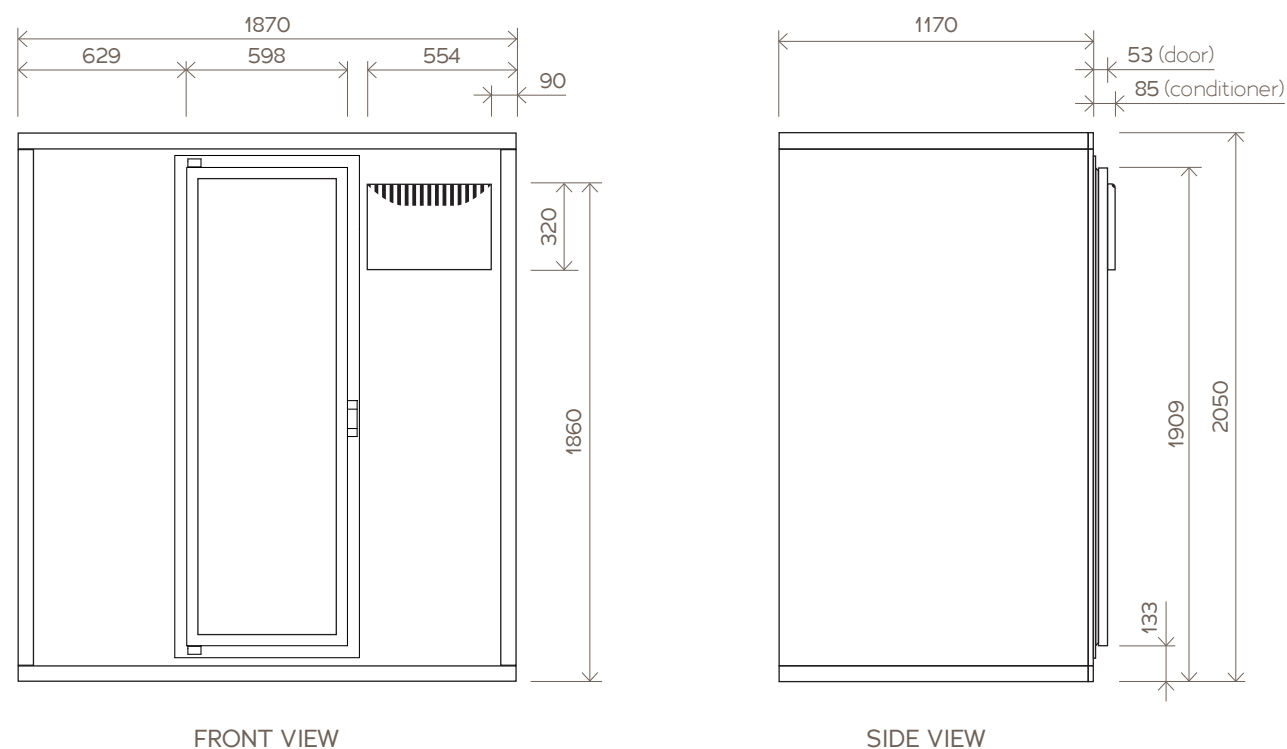

Conditioner dimensions

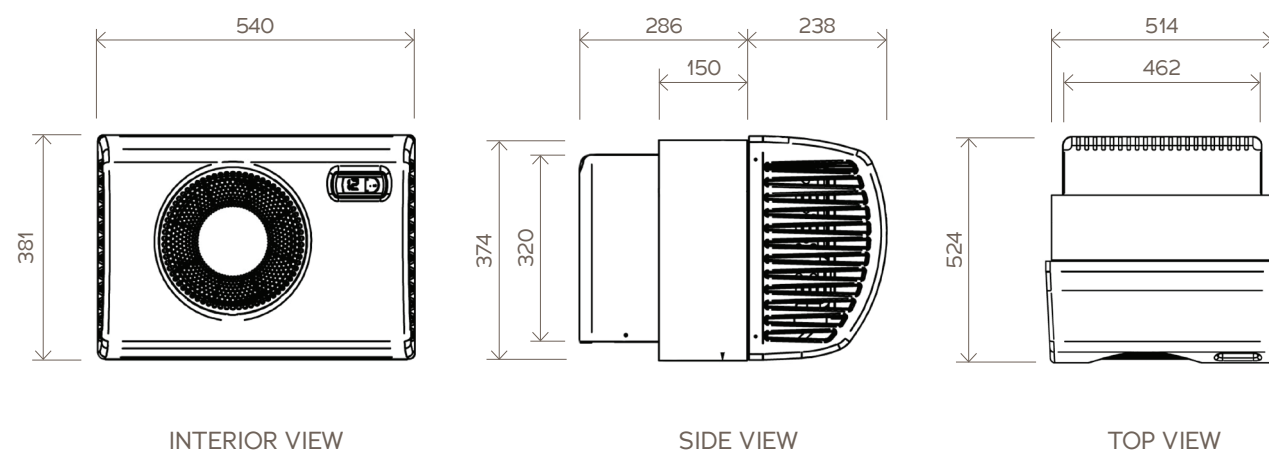

NOTE: Illustrations not to scale.
All dimensions in millimetres.

Installing your cellar (cont'd)

Preparation for installation

CRITICAL WARNINGS:

- **LOCATION FLOOR LOAD:** This walk in cellar and its contents are **EXTREMELY** heavy. It is vital that the floor where it will be located is level and strong enough to handle the load. For example, the Espace1000 base unit weighs 310kg installed, but loading in 1000 standard wine bottles adds a further static load of approximately 1500kg. Each 500 bottle extension kit weighs a further 150kg plus the extra wine weight (~1.5kg per average bottle). If you are not certain of the floor load capacity at the planned location we recommend consulting an architect or structural engineer to assess its strength before receiving delivery or commencing assembly of your cellar.
- **DELIVERY:** Espace cellars are supplied flat-packed in solid wooden crates that weigh up to 400kg in total (espace1000-kit) or a minimum of 150kg (espace1000-ext). Due to the crates' weight and size, careful consideration should be given to site accessibility, as well as the safe lifting capacity of any equipment being used to transport and manoeuvre the crates.
- **ASSEMBLY:** The cellar should be assembled in the same room or space as its final permanent location, because once constructed it will be too wide to move through a standard door opening.

IMPORTANT CONSIDERATIONS:

- **Space for assembly:** Allow ample room for assembly of the cellar's walls. The gap should be big enough to allow the walls to be screwed together and for you to move around it easily during assembly (see below).

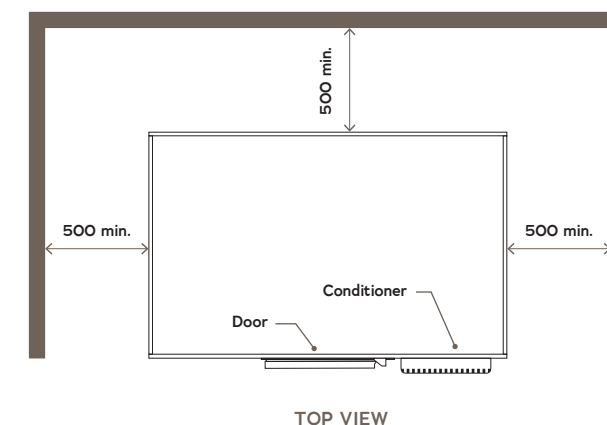

NOTE: Once assembled, you can install the cellar into a space with less or no space at the sides and back, as long as you are able to move the cellar into that space once assembled (will not fit through a standard doorway).
See warning below regarding roof access.

Also allow enough clearance from the ceiling to lift and fit the roof of the cellar during assembly (see below).

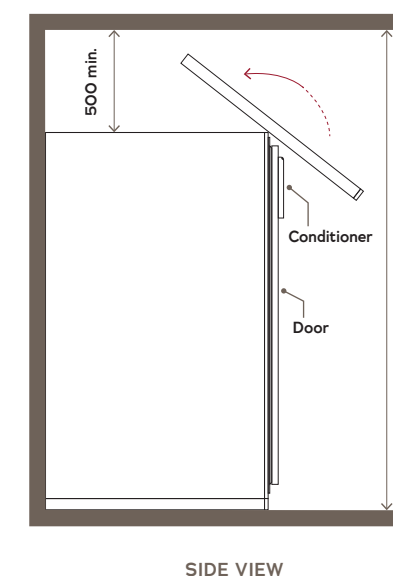

WARNING: Once assembled and installed, you should ideally ensure there is still enough room to allow access to the electrical power lead outlet on the roof (for more info see 'Power' on page 7).

Installing your cellar (cont'd)

- **Direct sunlight/heat:** The cellar (particularly the conditioning unit) must never receive prolonged exposure to direct sunlight or similar sources of intense heat.
- **Ventilation:** The external vents of the conditioning unit must always have access to free flowing cool air from the underside (min 0°C, max 35°C ambient), and an unobstructed passage for hot air to escape from the top into a large space that will allow for heat dissipation (for example a living room).
- **Flooring:** If the cellar is being installed during construction or renovation, it is recommended that installation is completed prior to laying any flooring material that might be damaged, such as timber or carpet.
- **Power:** Should service ever be required, access to switch off, disconnect and reconnect the power cable needs to be possible. A normal install of this unit includes running the conditioner power cable through the pre-cut access hole (sealed with grommets during operation) located in the roof of the cellar, immediately above the conditioning unit:

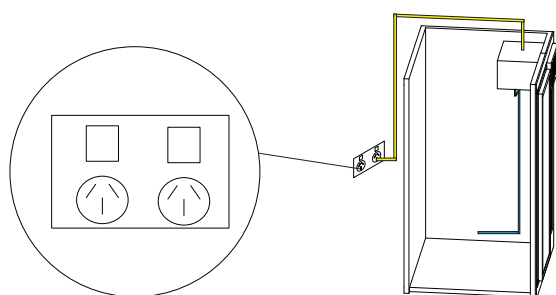

If this is not possible, please ask a licensed and qualified electrician to install a weatherproof power point inside the cellar to provide power for the conditioner:

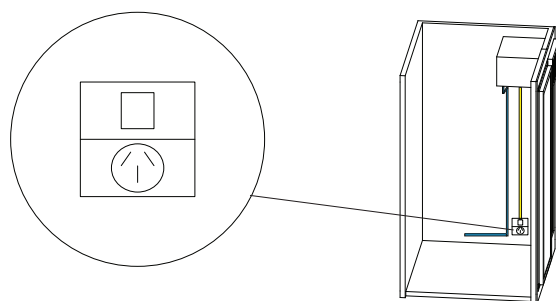

NOTE: Alternatively, hinged cabinetry is an ideal aesthetic and functional solution to maintain access to the cellar's roof.

- **Cellar door:** The cellar door can be installed left or right hand hinged – see warning after step 10 in the 'Assembly

procedure' on page 12. The cellar door itself is not suitable for full integration or mounting behind cabinetry.

- **Position of conditioner unit:** Due to the interlocking design of the wall panels, the conditioning unit can only be installed next to the door on the front right side of the cellar (when viewed from outside).
- **Excess humidity/moisture removal:** The conditioning unit has an excess moisture run-off tube coming from the underside of the conditioning unit (inside the cellar). This must either be fed into a collection vessel (such as an empty Champagne bottle) that is monitored/emptied manually, or alternatively plumbed into your household mains via gravity feed for automatic removal.

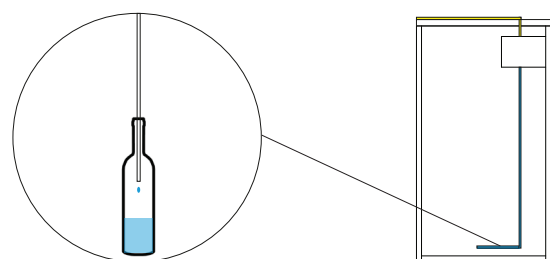

Mains plumbing is recommended for higher humidity or tropical areas such as northern Queensland or the Northern Territory.

- **Noise:** The compressor on the conditioner unit works 24 hours a day, and makes a light humming sound, similar to that of an air conditioning unit.

Other considerations:

- **Filters:** The conditioning unit has a filter which must be periodically cleaned. This is accessed from the underside of the conditioning unit, on the outside of the cellar. Failure to maintain this filter may compromise cellar efficiency, performance and warranty.
- **Lighting:** The cellar is supplied with individual battery operated LED downlights. If you choose to install aftermarket or custom lighting solutions, we suggest the use of LED lights with low UV and heat characteristics, plus the use of timers or motion sensors to remove the risk of lights being left on for long periods as this may affect your wine.
- **Conditioner unit finish:** In addition to the ability to install your own cabinetry in front of and around the majority of the unit, you may choose to spray paint the outer housing of the conditioning unit to match the colour of your cabinetry or surrounding material. Please ensure that this outer housing is removed from the working mechanisms of the conditioning unit prior to any spray coatings being applied.

Installing your cellar (cont'd)

Components list

CELLAR COMPONENTS

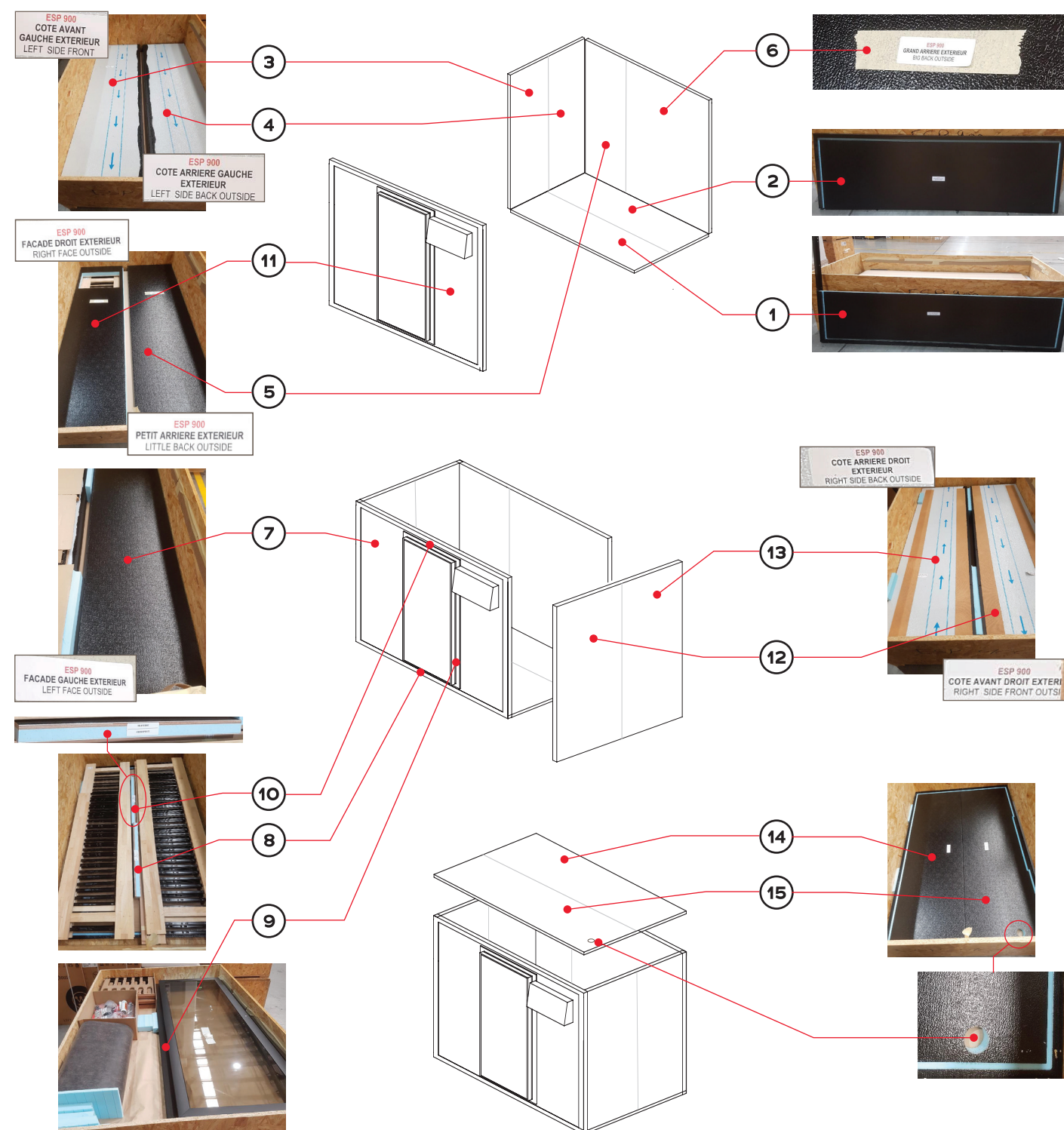

Installing your cellar (cont'd)

ASSEMBLY COMPONENTS

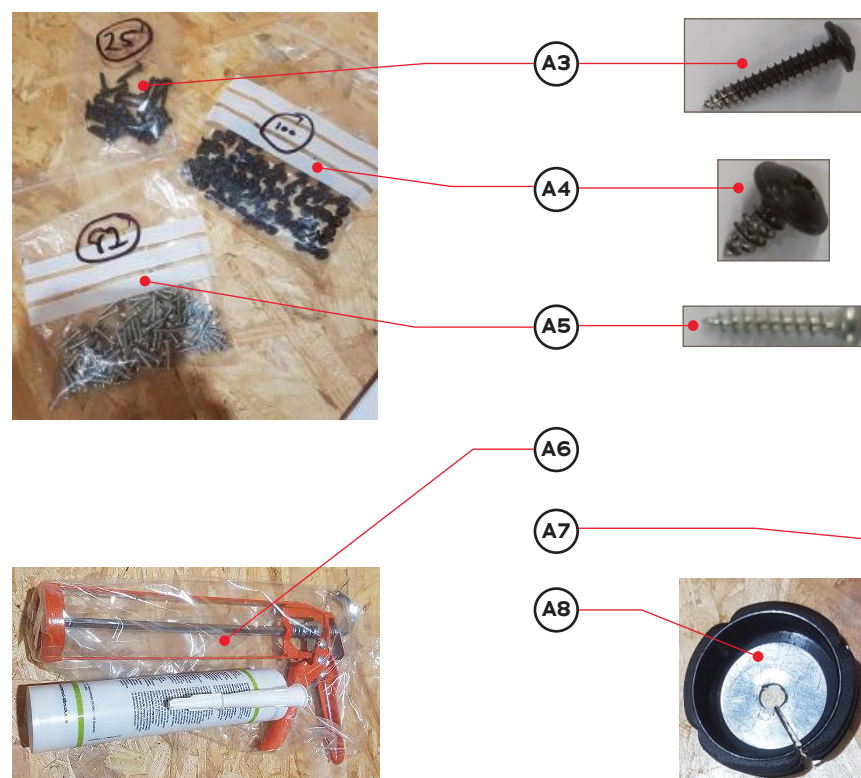
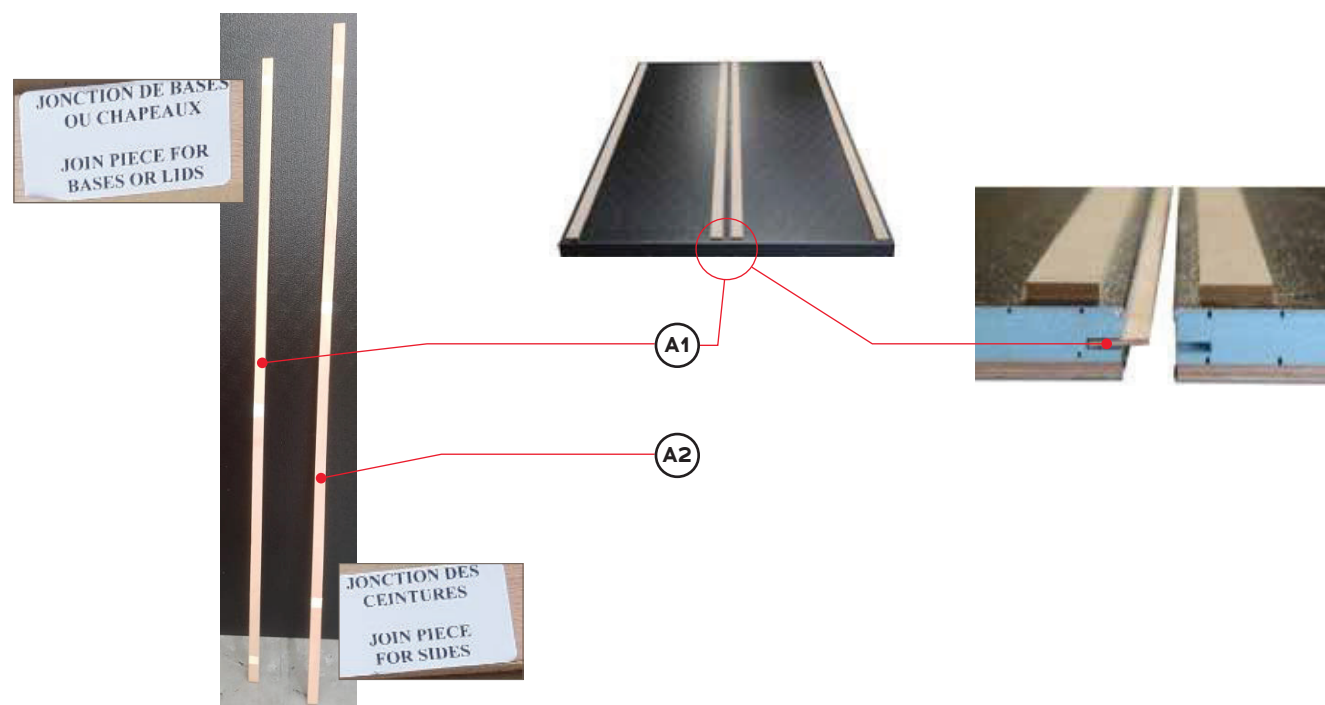

Installing your cellar (cont'd)

CONDITIONER COMPONENTS

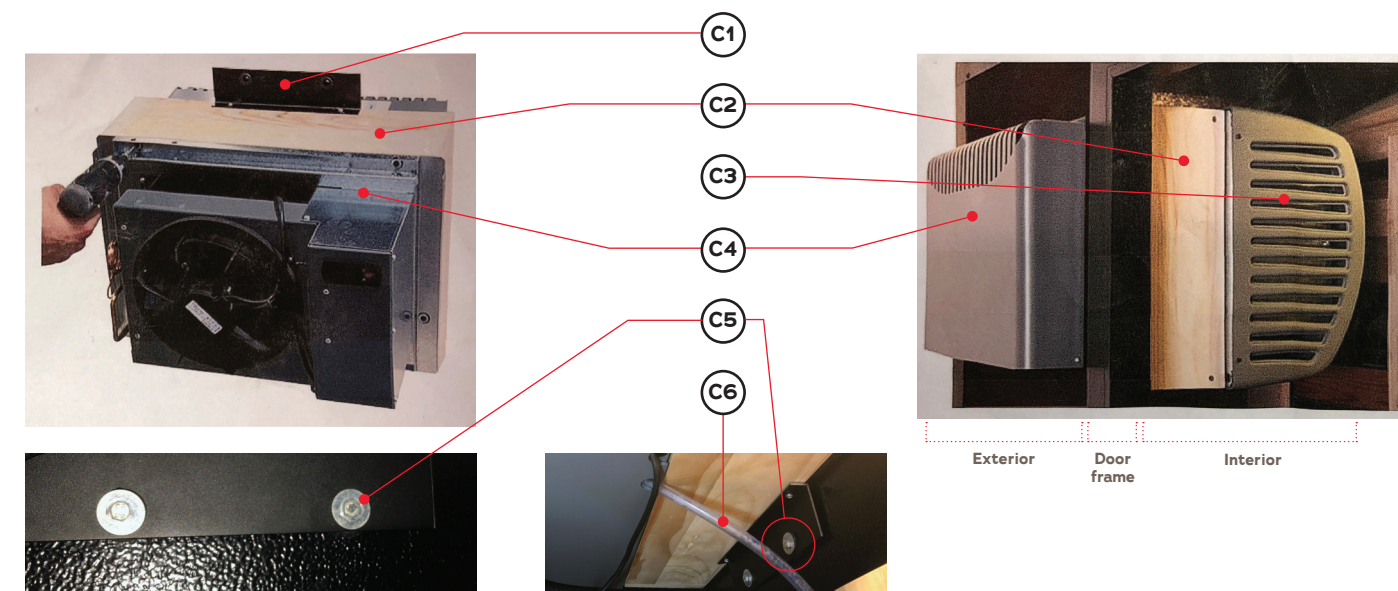

SHELVING COMPONENTS

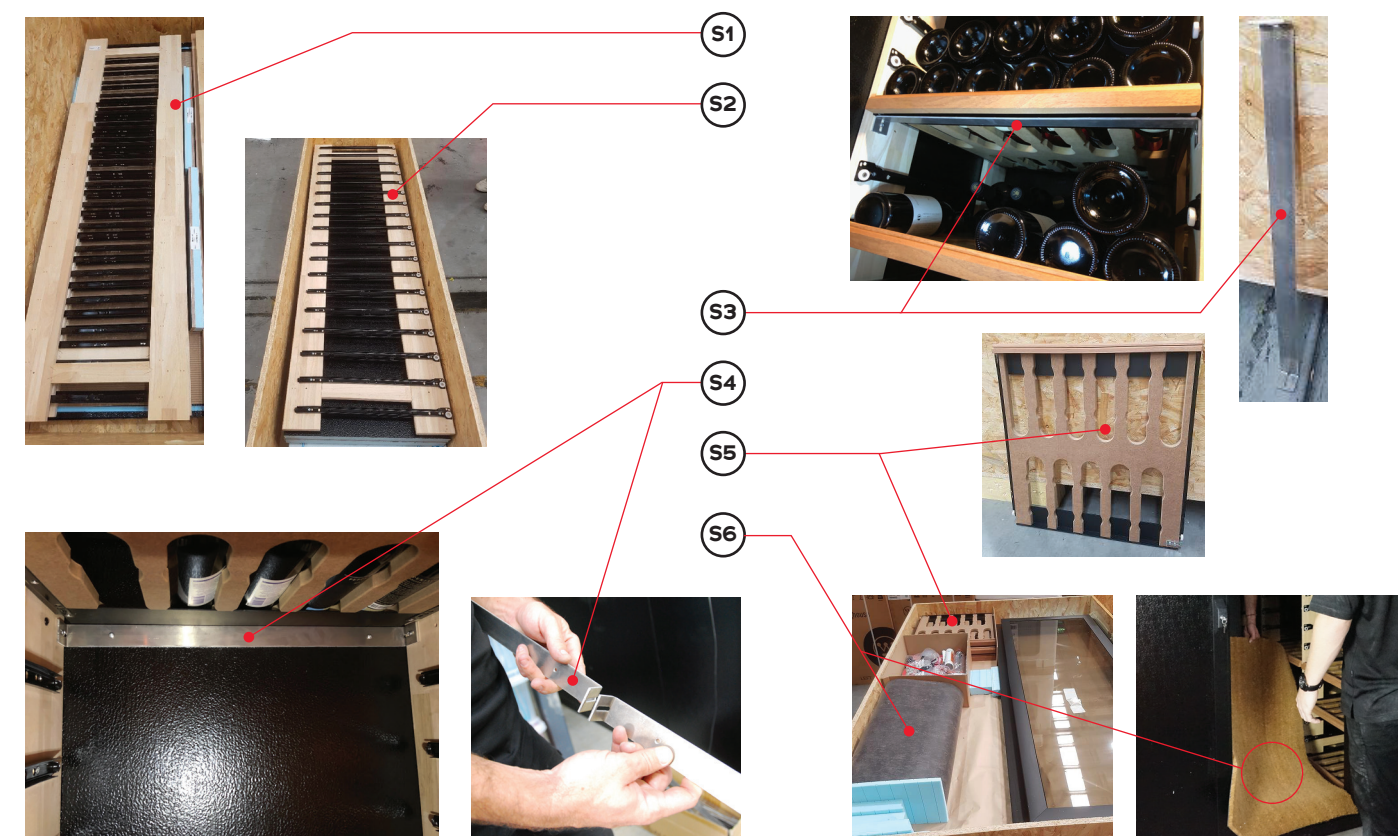

Installing your cellar (cont'd)

Assembly procedure

NOTE: This information is for assembly of the standard Espace 1000 kit (ESPACE1000-KIT) without any extensions. If extension modules (ESPACE1000-EXT) are also being added, they must be inserted between the front and rear panels of the standard kit – see **'Adding extension modules'** on **page 16** for additional instructions.

Although the cellar kit can be assembled by one person only, it is strongly advisable that at least two people work together to complete it.

Before commencing assembly of the kit, make the following preparations:

- Arrange the cellar panels in numerical order.
- Pull back the white protective plastic wrap from the corners/edges of the cellar panels by an inch or two to make sure that any unsightly bits of plastic do not get caught in the corners during assembly (the plastic should be mostly left on until the body is completely assembled to minimise risk of scratching).
- Read through the entire assembly procedure.
- Unwrap the various accessories and tools and familiarise yourself with them.
- Prepare a manual Philips head screwdriver or a cordless drill with a Philips head driver, a roll of removable adhesive tape, and a small step ladder to enable access to the cellar's roof once assembled.
- Unscrew whichever of the door hinges will become the upper hinge (**see warning note after step 10**) and dismount the door, which will be replaced at the very end of assembly.
- One tube of silicone is supplied with your Espace1000 unit, but you may wish to have a second one on hand in case the first one is exhausted during the sealing process. Ideally it should be black in colour and suitable for a high moisture environment.

Exterior body assembly

- 1 Arrange the two floor panels ① and ② on a flat, level surface, leaving enough space around to be able to assemble the walls later. Check that the surface is clean and will not scratch the panels – consider laying down a protective sheet first. The floor panels should initially be laid upside down, so that the timber support slats are facing up.
- 2 Insert one of the **short** joining strips ① into the slot on the inside edge of panel ①, then connect the panels by marrying the joining strip into the corresponding slot in panel ② and pushing them firmly together.

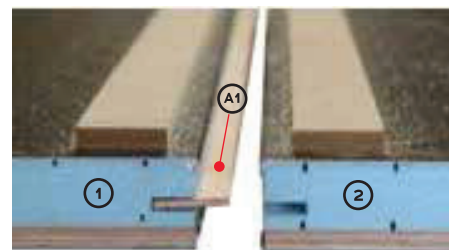

- 3 Secure panels ① and ② together through the metal frame with ④ screws using a Philips head manual screwdriver or a cordless drill with a Philips head driver.
- 4 Once secured, turn the entire floor over so the support slats are facing down. Ensure that the cellar floor is now as stable, even and level as possible – this will make the rest of the assembly much easier and more accurate.

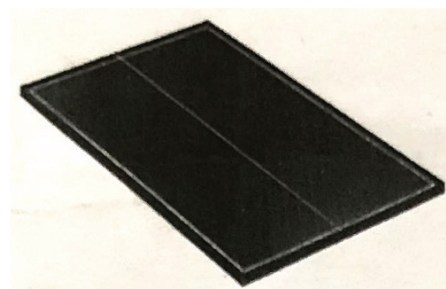

Installing your cellar (cont'd)

- 5 Stand left side panel ④ and small back left panel ⑤ upright in their positions at the rear left corner of the floor (when viewed from the front). Slot them down into the floor grooves (taking care not to damage the panel surfaces) and nest their edges together so the metal angle frame wraps over the exterior (see below).

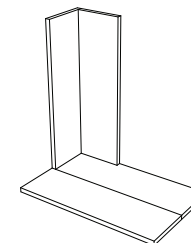

- 6 Secure panels ④ and ⑤ to each other temporarily with the removable adhesive tape. This forms the first corner of the cellar.
- 7 Insert a **long** joining strip ② into the slot on the vertical edge of panel ④ then position left side panel ③ so that it marries against the joining strip and also slots down into the floor groove (see below).

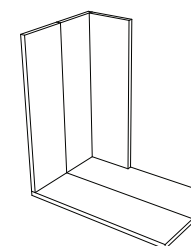

- 8 Repeat step 7 to connect large back right panel ⑥ to panel ⑤ with an ② strip. If necessary, secure panels ③ and ⑥ with adhesive tape (see below).

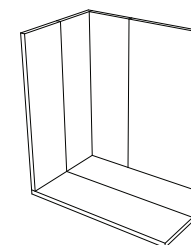

- 9 Position right side panel ⑩ nested against ⑥ to form the rear right corner of the cellar, and secure the corner with adhesive tape (see below).

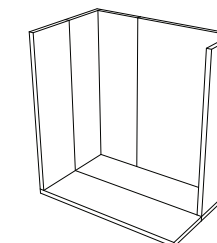

- 10 Slot front left panel ⑦ into its groove on the front left edge of the floor, and temporarily tape it to left side panel ③ (see below).

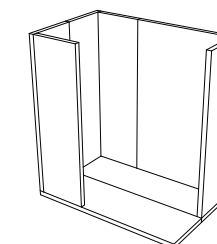

WARNING: Before proceeding to step 11, first decide which way you need the door to hinge/open. The door can be either left or right hinged, but the frame panel it attaches to must match the chosen hinge direction – rotate the door frame ⑨ by 180° in either direction to your chosen hinge position before inserting into place, while still paying attention to the 'inside'/'outside' markings.

- 11 Start assembly of the door section in its position by first slotting the door frame bottom block ⑧ into the front middle edge of the floor. Next place the door frame ⑨ on top of the bottom block (**see warning above**), and finally cap the door frame with the door top block ⑩. Tape if necessary (see below).

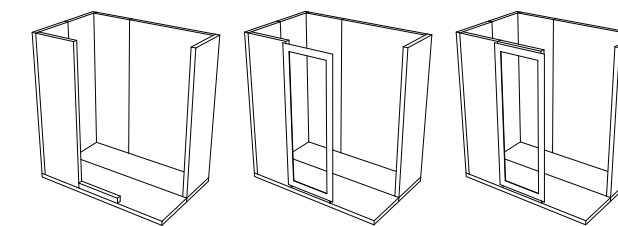

Installing your cellar (cont'd)

- 12 Complete the front side of the cellar by slotting the front right (conditioner) panel (11) into the front right edge of the floor. Tape if necessary (see below).

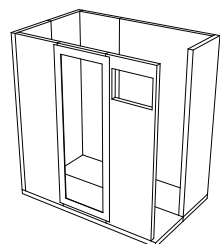

- 13 Insert an (A2) joining strip into the slot on the vertical edge of panel (13) then position right side panel (12) so that it not only marries against the joining strip and slots down into the floor groove, but also nests its metal angle frame around front right panel (11). Secure the corner with adhesive tape (see below). This completes the walls of the cellar.

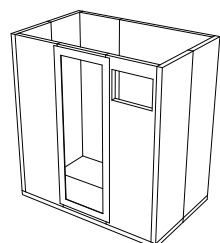

- 14 Use a short joining strip (A1) to connect the two roof panels (14) and (15).
- 15 Secure panels (14) and (15) together through the metal frame with (A4) screws
- 16 Once (14) and (15) are connected, lift the roof up on top of the walls and position carefully until the angled metal frame drops down snugly over all four sides. Walk inside the cellar and inspect the ceiling seams on all sides to ensure a snug fit with minimal gaps. If gaps are visible, carefully adjust the sides and apply pressure to the roof to ensure it is pressed down firmly (see below).

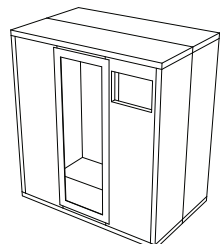

- 17 Ensure that all other panels are also firmly pressed together tightly so that no space is left between any joins and no foam insulation is visible at any seam.
- 18 Use (A4) screws to attach all panels together, screwing through the holes in the angled metal frame brackets. Start around the edges of the floor, then work around the roof, then finally the vertical corner brackets of the walls (see below).

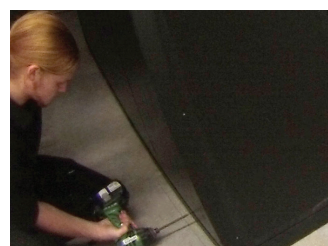

- 19 Apply silicone sealant (A6) to all internal panel seams and smooth to a neat finish (see below). Allow to set before installing the conditioner unit and shelving.

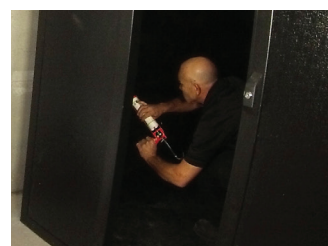
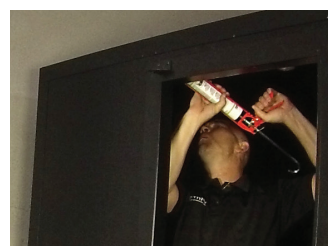

Conditioner unit installation

- 20 Prepare the conditioner unit for installation by first separating it from its timber frame (C2), as well as removing the rear grill cover (C3) (see below).



- 21 Note the four pre-drilled bolt holes on the interior of wall panel (11) – two above the conditioner cutout void and two below.

- 22 Temporarily position one of the black metal angle brackets (C1) above the cutout so that its top holes line up with the bolt holes on wall panel, and partially screw in two of the (C5) bolts (see warning below). The washers can be left off for now.

Installing your cellar (cont'd)

WARNING: Each of the pre-drilled bolt holes in the wall panel have a captive nut secured inside them, which will receive the (C5) bolts that attach the conditioner unit. **DO NOT** use an impact drill or a drill with a high clutch/torque setting to drive in the bolts – this will break the adhesive that holds the nut in place and dislodge it, making it impossible to secure the bolts. Insertion of the bolts should be started by hand to ensure they are aligned correctly and not cross-threaded, and then can be carefully completed using either a manual socket wrench or a drill on a low clutch/torque setting.

- 23 Do the same for the bottom metal bracket (note that the brackets face in opposite directions).

- 24 Temporarily position the timber frame between the two brackets, ensuring that its inner edges align with the edges of the wall panel cutout (see below).



- 25 Using a pencil, mark the position of the (C1) metal brackets' screw holes on the top and bottom of the timber frame.

- 26 Remove the timber frame from the wall panel, as well as carefully removing the bolts and brackets.

- 27 Use (A3) screws to securely attach the top metal bracket onto the timber frame using your pencil marks as a position guide. Do the same for the bottom metal bracket.

- 28 Insert the main conditioner unit (C4) through the timber frame (ensuring that the foam shock absorber strip is on the lower side), and rest the conditioner onto the foam strip.

- 29 Use (A3) screws to securely attach the conditioner (C4) to the timber frame (C2) by screwing from the rear side of the conditioner through its metal edge flange and into the timber frame (see below).



- 30 Prepare the condensation water hose connection on the base of the conditioner unit by removing the plastic shroud over the hose connector outlet.

- 31 Connect the condensation hose (C6) by sliding it onto the connector outlet, and secure it using the spring clamp.

- 32 Feed the ends of the condensation hose and the power cable through their outlet holes in the rear grill cover (C3) (see below) and re-attach the grill cover to the body of the conditioner unit.

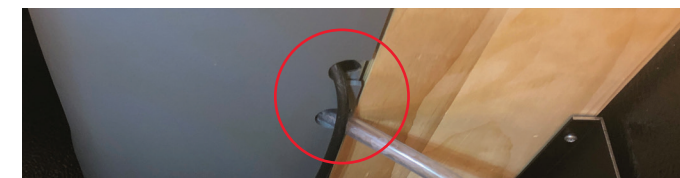

- 33 Lift the conditioner/frame assembly into position and attach it to wall panel (11) by carefully re-inserting the two (C5) bolts (including the wide washers this time) through the metal brackets (see warning after step 22 above).

- 34 Feed the power lead out through the pre-cut hole in the roof panel, ready for connection to mains power.

- 35 Standing inside the cellar, take one half of the plastic hole cover grommet (A8) and ease it sideways onto the power lead via the grommet's pre-cut slit so that the power lead runs up through the centre of the grommet, then slide the grommet up to the ceiling and press it into the roof hole so that it forms a tight seal.

- 36 From outside the cellar, use a step ladder to access the roof and repeat step 35 by attaching the other half of the grommet to the power lead, then slide it down and press it firmly into the roof hole to seal it.

Interior shelving assembly

- 37 Sort and arrange the various vertical timber shelving support frames. Those with shelf runners only on one side – (S1) – should be installed at the front and back of the cellar. Those with runners on both sides – (S2) – should be installed in the centre. Take care to ensure the supports are facing in the correct direction (front to back, and top to bottom) so that shelves can slide onto their runners correctly (see below for reference).



Installing your cellar (cont'd)

NOTE: The shorter support frame must be installed in the front right corner of the cellar, underneath the conditioner unit (see below).

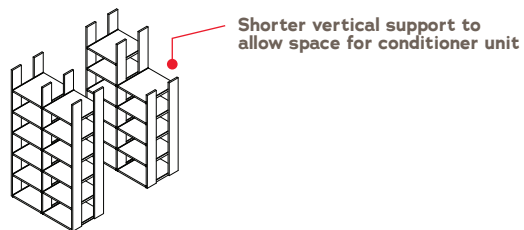

38 Sort and arrange the two types of metal cross-bars. Those with pre-drilled holes – (S4) – are for attaching to walls and the floor. Those without holes – (S9) – are for lateral bracing between the vertical support frames.

39 Begin assembly by positioning the first (S1) single-sided support frame in the front left corner of the cellar. Using (A5) screws, attach it to the inside face of front wall panel (7) by screwing through the larger pre-drilled holes in the timber of the support frame and into the wall panel.

40 Loosely attach drilled cross-bars (S4) to the rear and base of the support frame using (A5) screws, following the partially drilled guide marks for their location, then also screw through the holes in the cross-bars into the wall and floor. Use 1x cross-bar to attach the bottom front edge of the vertical supports to the floor of the cellar, and 2x cross-bars to attach the rear edges of the vertical supports to the wall of the cellar (see below).

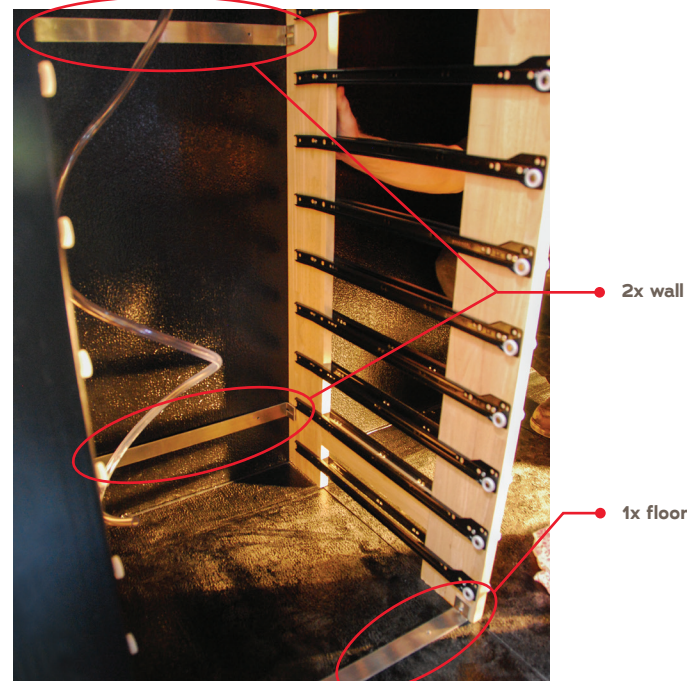

41 Position the central double-sided (S2) support frame and screw it to the drilled cross-bars (S4) to secure it, then go back and firmly secure the screws attached at step 40.

42 Repeat steps 40 and 41 to attach drilled cross-bars (S4) to the other side of the central support frame, then another single-sided (S1) support frame at the far end.

43 Check that all vertical supports and cross-bars are firmly secured and aligned.

NOTE: The last vertical support at the end of the row does not need to be screwed to the back wall of the cellar. There is likely to be a small gap between the support and the back wall.

44 Attach the non-drilled cross-bracing bars (S3) between the front edges of the support frames (see warning and note below). This completes assembly of the shelving frames for the left side of the cellar.

WARNING: At the location where cross-bracing bars (S3) are to be attached to the central, double sided timber support frame (S2), two partially drilled screw guide marks have been provided on each side, one above the other. Screw into the upper guide mark on one side of the support frame, and into the lower guide mark on the opposite side – this avoids the two screws bumping into each other and splitting the timber (see below).

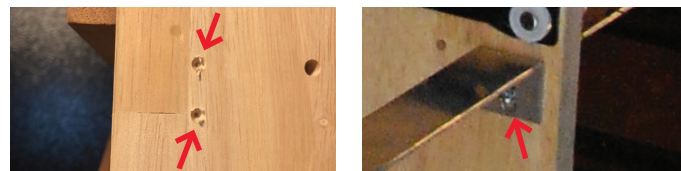

NOTE: Whilst the position of cross-bracing bars is adjustable, it is recommended to install them as close as possible to the shelf above to prevent the bars from rubbing against the labels of bottles on the shelf below (see below).



Installing your cellar (cont'd)

45 Repeat steps 39 to 44 to install shelving on the right hand side of the cellar, starting at the front and working to the back, ensuring that the shorter support frame is positioned at the front (under the conditioner unit).

46 Insert all the sliding shelves (S5) onto their runners.



Finishing touches

47 Attach the supplied internal lights (A7) to the ceiling of the cellar.

48 Lay the supplied carpet strip (S6) onto the floor in the centre of the cellar between the two rows of shelves (this cushions the fall of any bottles that may be dropped during handling).

49 Mount the cellar door back onto its lower hinge, then screw the upper hinge back into place (this requires either assistance from another person or support blocks under the door to hold its weight).

50 Connect the power lead to a mains power outlet and switch on the conditioner unit.

51 Congratulations, the installation of your Espace cellar is now complete – raise a glass to yourself!



Adding extension modules (ESPACE1000-EXT)

The Espace range enables you to expand your wine collection by adding extension modules that increase the capacity of the standard cellar by 500 bottle increments up to a maximum of 4000 bottles.

e1 At step 2, add the extra base panel(s) between panels (1) and (2), as well as adding the extra timber joining strip(s) plus the extra angled metal frame brackets to the outside edges.

e2 At step 7, add the extra side panel(s) and joining strip(s) between panels (3) and (4).

e3 At step 13, add the other extra side panel(s) and joining strip(s) between panels (12) and (13).

e4 At step 15, add the extra roof panel(s), joining strip(s) between panels (14) and (15), plus the extra angled metal frame brackets to the outside edges.

e5 At step 19, depending on how many extension modules are being added and how liberally silicone sealant is applied, additional tubes of silicone may be required (not supplied with extension).

e6 For steps 39 to 45, follow the same procedure and sequence for shelving installation by working from the front to the back of the cellar, but add the extra double-sided support frames and cross-bracing bars to the central section of the cellar.

Technical specifications

	Espace 1000 base cellar	Extension kit	Conditioner unit (Fondis C25S)
Bottle capacity ¹	1000	500	N/A
Dimensions (D x W x H)	1170 x 1855 x 2050	520 x 1855 x 2050	525 x 540 x 380
Finish	Classic Black	Classic Black	N/A
Function	Primary storage capacity	Extra storage capacity	Consistent temperature
Weight (kg)	310	150	31
Refrigerant	N/A	N/A	R404a
Air conditioning capacity ²	N/A	N/A	Up to 25m³
Electrical supply	N/A	N/A	230-240V - 50Hz
Power consumption	N/A	N/A	440W
Cooling capacity	N/A	N/A	550W
Running current	N/A	N/A	2.2A
Heating resistance	N/A	N/A	250W
Noise level (at 1m / at 3m)	N/A	N/A	46dB / 40dB
Airflow inside cellar	N/A	N/A	96m³/h at 198m³/h
Airflow outside cellar	N/A	N/A	179m³/h

1 Based on a 750mL Standard Bordeaux Bottle
2 In a well isolated cellar

Maintenance

Your Vintec cellar is a tried and tested appliance. However, we recommend the following maintenance operations be carried out approximately once a year for optimal performance:

- 1 Switch off and unplug the conditioner unit.
- 2 Vacuum the interior and exterior vents of the conditioner unit, as well as the floor of the cellar and the carpet strip.
- 3 Clean the interior walls of the cellar with water and a gentle cleaning product, then rinse thoroughly.
- 4 Check that the door seals are clean and in good condition.

NOTE: Replacement of the LEDs on the control panel must only be carried out by a qualified electrician.

Loading and storing your wine

Different types of shelving available for your Espace cellar

Wooden standard shelf

Model #: TAS19WA



Wooden Champagne shelf

Model #: TAS22WA



Wooden Magnum shelf

Model #: TAS23WA



NOTE: Champagne and Magnum shelves are not fitted with a shelf lock.

Layout advice

Your Espace wine cellar has been designed to safely hold a maximum number of bottles. We recommend that you observe the following suggestions to optimise loading.

NOTE: Bottles must be arranged so that they do not come into contact with the walls of the cellar. If this happens, the condensation created on the wall may trickle onto the shelves and damage the bottle labels. In addition, contact with the cold wall may create a frost point, which is harmful to your wine.

- Distribute your bottles as uniformly as possible over the entire cellar rather than placing bottles all on the top, bottom, front or back shelves.
- If you need to stack bottles for long term cellaring, it is best to use the shelf lock for safety and avoid sliding out those stacked shelves. The lock is located at the back left corner of each standard shelf (see below).

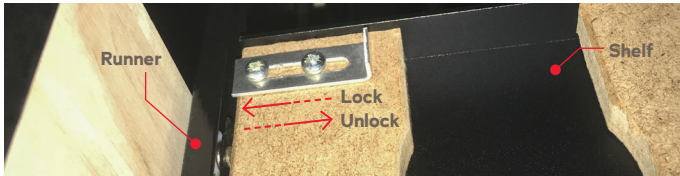

- For regular serving access to bottles that have matured and are ready to drink, it is recommended to use single layers of bottles on a sliding shelf, or lock a shelf and use the following vertical stacking system:

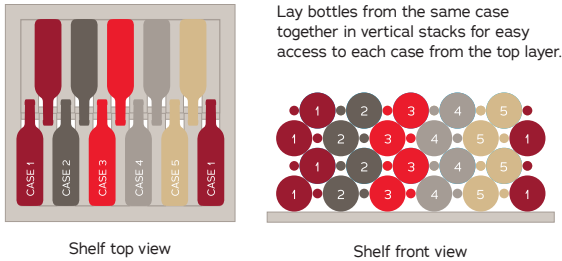

- When accessing your wines, never pull out more than one sliding shelf at a time.
- If you are top-and-tail stacking super-premium Bordeaux bottles (extra tall), depth can be an issue. Make a flat base layer of standard Bordeaux bottles on the locked shelf first, then you can stack your super-premiums on top of that base with their tails hanging over the edge of the shelf slightly. To avoid bumping into these bottles as you move down the aisle of the cellar, it is best to use shelves at the back of the cellar for this purpose.

Setting your cellar's temperature

Temperature guidance

NOTE: For optimal performance, we recommend that you fill your cellar to at least 75% of its capacity.

The default setting is 12°C (ideal maturing temperature). However, you can set the temperature between 6 – 18°C. The recommended ideal range for maturing is 10 – 14°C. See page 2 for recommended serving temperatures across the range of varietals.

WARNING: In order to operate correctly, your cabinet must be placed in a room with an **ambient temperature between 0°C and 35°C**.

Procedure

- 1 Press and hold the **set** button on the conditioner unit control panel for a few seconds until the temperature display flashes.
- 2 Adjust the target temperature to the desired level using the **▲** and **▼** arrows.
- 3 Confirm the target temperature by pressing the **set** button again. **NOTE:** If you do not confirm the setting, the modification will not be registered.
- 4 If necessary, to put the conditioner unit on standby, press and hold down the **⏻** button for several seconds. The temperature will display as OFF and the conditioner thermostat will no longer be operating. To reactivate the thermostat, press and hold down the **⏻** button for several seconds again.



Status lights

- A Compressor:** Indicates that the compressor is operating. When this flashes, it means that the compressor is going to start up in a few minutes (technical delay).
- B Alarm:** Informs you that there is an abnormally high or low temperature inside the cellar.
- C Defrosting cycle:** Indicates that an automatic defrosting cycle is underway.
- D Heater:** Indicates that the heater is operating.

NOTE: When there has been a significant modification in set temperatures, it can take several hours for your Espace cellar to stabilise and the conditioner unit to display the desired temperature. Also, if you have loaded your cellar with a large number of bottles, it can take +/- 24 hours for your cellar's temperature to stabilise. The alarm warning light may appear – if it does, then wait 48 hours and check again. If the alarm light does not disappear after a few days, please contact your retailer.

Important wine information

Your Vintec cellar has been designed to provide the optimum conditions for storing and/or serving your wine. Wine is a highly complex product, requiring long and gentle development as well as specific conditions in which to reach its full potential. All wine should be cellared at the same temperature – only the temperatures for serving and wine tasting should vary depending on the grape variety (see page 2).

The exact cellaring temperature is not as important as its constancy and consistency. In other words, as long as the temperature of your cellar is set somewhere between 10°C and 14°C, your wine will be stored in ideal conditions if the temperature is not subject to any significant fluctuation.

NOTE: Irrespective of the cause, if you notice either abnormal temperature or humidity levels inside your cellar, rest assured that only long exposure to these abnormal conditions can have a detrimental effect on your wines. Quickly returning the values to their optimal settings can avoid any permanent damage to the flavour profiles of your wines.

Notes

FOR SALES IN AUSTRALIA AND NEW ZEALAND
APPLIANCE: ALL VINTEC/TRANSTHERM

1. **In this warranty:**
 - (a) 'ACL' or 'Australian Consumer Law' means Schedule 2 to the Competition and Consumer Act 2010;
 - (b) 'Appliance' means any Electrolux product purchased by you and accompanied by this document;
 - (c) 'ASC' means Electrolux's authorised serviced centres;
 - (d) 'Vintec/Trantherm' is the brand controlled by Electrolux Home Products Pty Ltd of 163 O'Riordan Street, Mascot NSW 2020, ABN 51 004 762 341 in respect of Appliances purchased in Australia and Electrolux (NZ) Limited (collectively "Electrolux") of 3-5 Niall Burgess Road, Mount Wellington, in respect of Appliances purchased in New Zealand;
 - (e) 'Warranty Period' means the period specified in clause 3 of this warranty;
 - (f) 'you' means the purchaser of the Appliance not having purchased the Appliance for re-sale, and 'your' has a corresponding meaning.
2. **Application:** This warranty only applies to new Appliances, purchased and used in Australia or New Zealand and is in addition to (and does not exclude, restrict, or modify in any way) other rights and remedies under a law to which the Appliances or services relate, including any non-excludable statutory guarantees in Australia and New Zealand.
3. **Warranty Period:** Subject to these terms and conditions, this warranty continues for in Australia for a period of 24 months and in New Zealand for a period of 24 months, following the date of original purchase of the Appliance.
4. **Repair or replace warranty:** During the Warranty Period, Electrolux or its ASC will, at no extra charge if your Appliance is readily accessible for service, without special equipment and subject to these terms and conditions, repair or replace any parts which it considers to be defective. Electrolux may, in its absolute discretion, choose whether the remedy offered for a valid warranty claim is repair or replacement. Electrolux or its ASC may use refurbished parts to repair your Appliance. You agree that any replaced Appliances or parts become the property of Electrolux.
5. **Travel and transportation costs:** Subject to clause 7, Electrolux will bear the reasonable cost of transportation, travel and delivery of the Appliance to and from Electrolux or its ASC. Travel and transportation will be arranged by Electrolux as part of any valid warranty claim.
6. **Proof of purchase** is required before you can make a claim under this warranty.
7. **Exclusions:** You may not make a claim under this warranty unless the defect claimed is due to faulty or defective parts or workmanship. This warranty does not cover:
 - (a) light globes, batteries, filters or similar perishable parts;
 - (b) parts and Appliances not supplied by Electrolux;

- In addition, Electrolux is not liable under this warranty if:
- (a) the Appliance has been, or Electrolux reasonably believes that the Appliance has been, used for purposes other than those for which the Appliance was intended, including where the Appliance has been used for any non-domestic purpose;
 - (b) the Appliance is modified without authority from Electrolux in writing;
 - (c) the Appliance's serial number or warranty seal has been removed or defaced.
- 8. How to claim under this warranty:** To enquire about claiming under this warranty, please follow these steps:
- (a) carefully check the operating instructions, user manual and the terms of this warranty;
 - (b) have the model and serial number of the Appliance available;
 - (c) have the proof of purchase (e.g. an invoice) available;
 - (d) telephone the numbers shown below.
- 9. Australia:** For Appliances and services provided by Electrolux in Australia: Electrolux goods come with guarantees that cannot be excluded under the Australian Consumer Law. You are entitled to a replacement or refund for a major failure and for compensation for any other reasonably foreseeable loss or damage. You are also entitled to have the Appliance repaired or replaced if the Appliance fails to be of acceptable quality and the failure does not amount to a major failure. 'Acceptable quality' and 'major failure' have the same meaning as referred to in the ACL.
- 10. New Zealand:** For Appliances and services provided by Electrolux in New Zealand, the Appliances come with a guarantee by Electrolux pursuant to the provisions of the Consumer Guarantees Act, the Sale of Goods Act and the Fair Trading Act. Where the Appliance was purchased in New Zealand for commercial purposes the Consumer Guarantees Act does not apply.
- 11. Confidentiality:** You accept that if you make a warranty claim, Electrolux and its agents including ASC may exchange information in relation to you to enable Electrolux to meet its obligations under this warranty.

Before calling for service, please ensure that the steps listed in clause 8 above have been followed.

<p>FOR SERVICE or to find the address of your nearest authorised service centre in Australia PLEASE CALL 1800 771 776 (For the cost of a local call (Australia only))</p>	<p>AUSTRALIA ELECTROLUX HOME PRODUCTS 163 O'Riordan Street, Mascot NSW 2020 vintec.com.au</p>	<p>FOR ACCESSORIES PLEASE CALL 1800 666 778 (For the cost of a local call (Australia only)) or visit www.vintecclub.com</p>
<p>FOR SERVICE or to find the address of your nearest authorised service centre in New Zealand PLEASE CALL 0800 550 020 (New Zealand only)</p>	<p>NEW ZEALAND ELECTROLUX (NZ) Limited 3-5 Niall Burgess Road, Mount Wellington vintec.co.nz</p>	<p>FOR ACCESSORIES PLEASE CALL 0800 550 020 (New Zealand only) or visit www.vintecclub.com</p>

VINTEC

TRANSTHERM

Service and support

In the rare event that your Vintec cabinet does not perform to your satisfaction, contact our dedicated support team:

1800 771 776

concierge@vintecclub.com

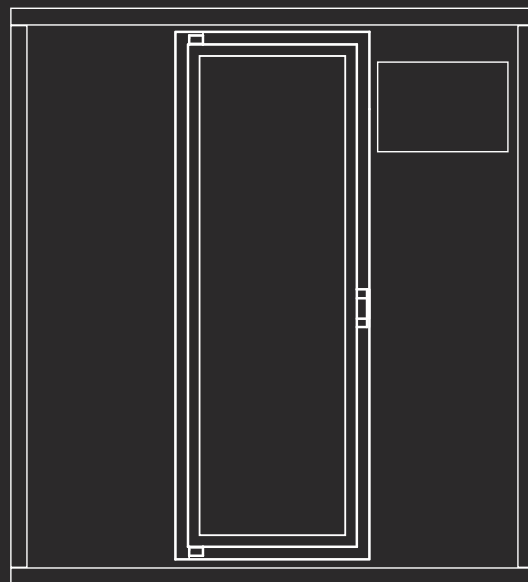

Vintec. We are part of the Electrolux Family. To add a touch of professional inspiration to your home, visit electrolux.com.au

Stay in touch and share your user experience by following us:

