

# SA520TX60 rangehood

ID241109  
SA520TX60

deluxe 60cm, front recirculating, retractable rangehood, halogen lights, silverfrost/stainless steel



FINISH	silverfrost carcase, stainless steel fascia, clear glass deflector, fascia rail replaceable for integration
SIZE	60cm
INSTALLATION	built into overhead cabinetry
MOTOR	100 watt single shaded motor with impellor
CONTROLS	two front mounted, right
SPEEDS	3 settings — LOW, MID, HIGH -- presettable
ILLUMINATION	two x 20 watt halogen lights
NOISE	37–53dB
CAPACITY	210 cubic metres/hour net, 273 cubic metres/hour gross
FILTER	one-piece aluminium mesh (removable)
AIR EXTRACTION	ducted or recirculated
ACCESSORY	activated charcoal filter (removable/replaceable), 60cm code CF3061
WARRANTY	two years parts and labour

## DIRECT RECIRCULATION

No longer is a ducting kit required to be installed in the cabinetry above the rangehood to redirect the filtered air back into the kitchen. Simply remove the cover plate positioned behind the telescopic fascia rail and the air is efficiently recirculated.

## SPACE SAVING

This direct recirculation frees the overhead cabinetry space for extra kitchen storage.

## COST CUTTING

As well as the absence of a recirculation kit and its associated purchase costs, there is no further carpentry involved with this single and simple installation requirement.

## FULL INTEGRATION

Mounted above the cooktop in cupboard and suspended from a shelf in the cabinet cavity, the front fascia rail is fully integrated into the cupboard line when the rangehood is not in use. This front rail is replaceable by a decor strip of timber or laminated material.

## AUTOMATION

Preset fan speed and/or lights to operate automatically when rail is pulled forward.

## MAINTENANCE

Easy lift-out grease filter is washable; removable light diffuser for bulb access. All clean lines for wipe-over maintenance.

## PERFORMANCE

Highly-efficient air extraction of up to 273 cubic metres an hour further enhanced by large catchment area when glass visor is telescoped outwards.

## QUIETNESS

37–53 dB. The motor/impellor encasement and flues are all smooth-walled to minimise air drag and hence noise, welded metal joints for no vibration.

## SAFETY

Thermal overload protector on motor; fire-retardant hardened metal and mesh. VO self-extinguishing polycarbonate for motor housing and internal flue.

## CHARCOAL FILTER

This accessory is fitted for the effective removal of cooking odours in the circulation application. These filters are not to be washed and are replaceable.

## DIRECT DUCTING

When the extracted air can be sent straight to atmosphere, simply replace the front coverplate and the top exit, in conjunction with a duct pipe.

# SA520TX60 rangehood

ID241109  
SA520TX60

deluxe 60cm, front recirculating, retractable rangehood, halogen lights, silverfrost/stainless steel

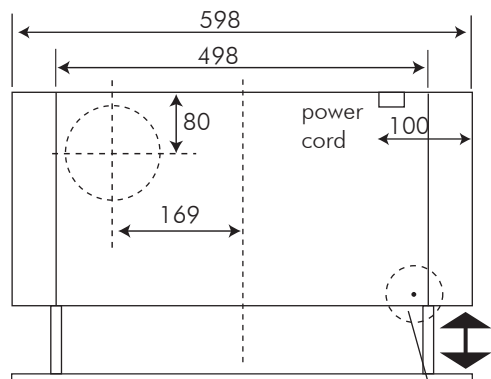
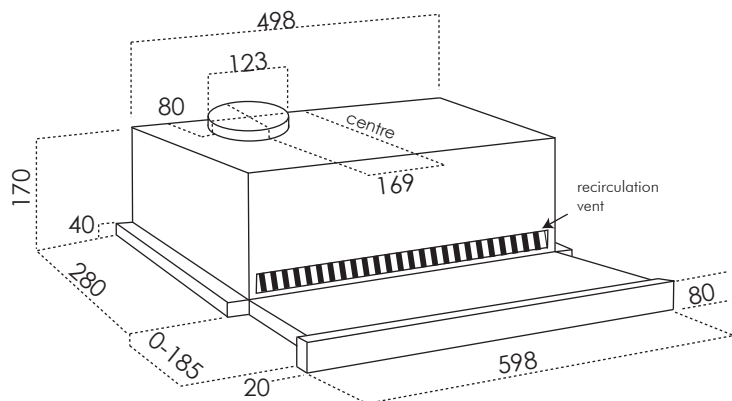

PLAN

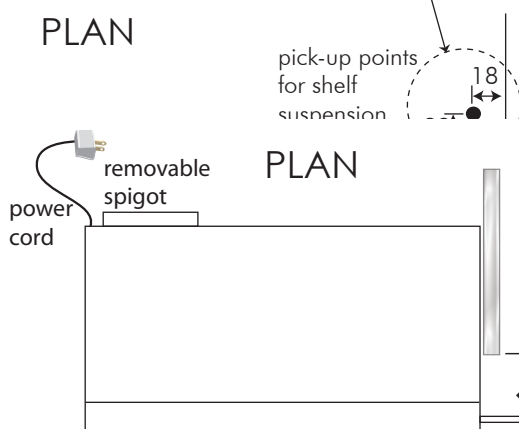

PLAN

height	170mm
width	598mm
depth	retractable visor closed — 300mm retractable visor open — 485mm
packaged dimensions	645mm x 390mm x 255mm = 0.065m³
net weight	8.6kg
gross weight	9.7kg
capacity	273m³/hr gross, 210m³/hr net
noise rating	37–53 dB
electrical supply	240 volt, 50 Hz
electrical connection	3-pin plug, 1.25m power cord
wattage	motor: 100 watt, single-shaded pole light: 2 x 20 watt halogen total: 140 watt
total current	0.6 amp
air exit aperture	123mm diameter for 125mm (5") dia duct pipe
supplied	template for mounting, spigot for duct pipe, screws, instructions for instalation, operation and maintenance

## PLEASE NOTE

**automatic recirculation:** unpacked, the hood has a 475mm x 44mm cover platge screwed in place over the recirculation vent visible behind the telescopic fascia rail — remove cover for recirculation mode.

**direct ducting to atmosphere:** leave cover plate in place, use roof exit and fit the supplied spigot (123mm diameter) to take a 125mm (5") diameter duct pipe.

**NB: drawings are not to scale — they are to assist only**

## air filtering options

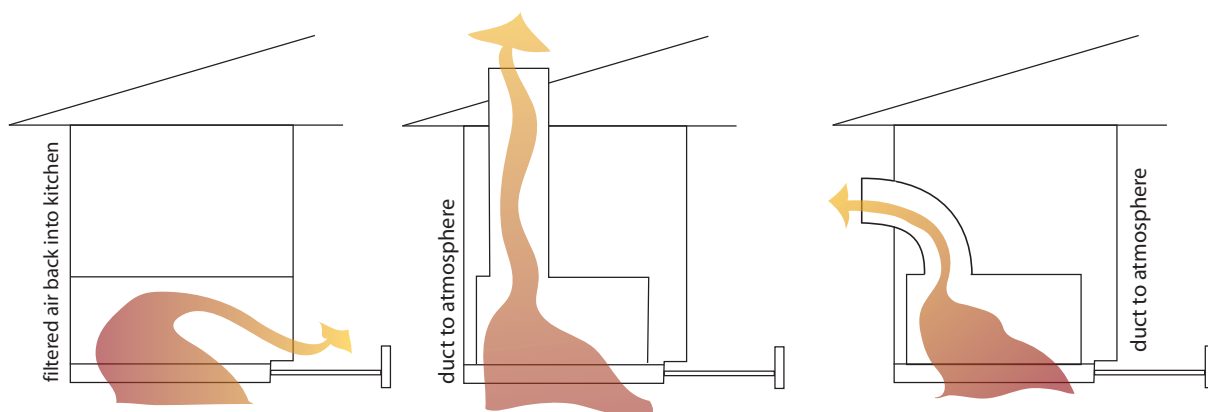

**WARNING:** technical specifications and product sizes can be varied by the manufacturer without notice. Cutouts for appliances should only be by physical product measurements. The above information is indicative only.