

**Series 8, Built-in oven, 60 x 60 cm,
Black
HBG976MB1A**

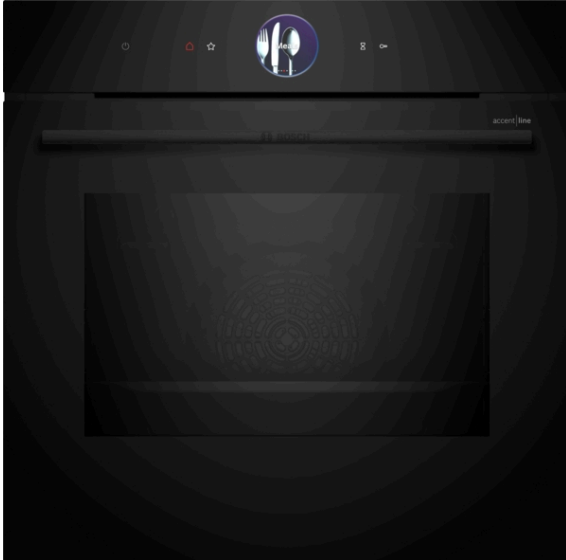

Included accessories

2 x combination grid
1 x universal pan
1 x Air-Fry grid

Optional accessories

HEZ327000 : Pizza stone
HEZ530000 : Half tray
HEZ531010 : Baking tray, non-stick ceramic coated
HEZ532010 : Universal pan, non-stick ceramic coated
HEZ631070 : Baking tray, anthracite enamelled
HEZ633001 : Lid for professional pan, enamelled anthracite
HEZ633073 : Professional pan, anthracite enamelled
HEZ634000 : Baking and roasting grid (standard)

The built-in oven with Digital Control Ring and TFT-touchdisplay, Assist function for meals, Air Fry, PerfectRoast Plus, Home Connect for control via the App.

- **TFT Touch Display Plus:** easy control thanks to an innovative Digital Control Ring and enlarged TFT touchscreen.
- **Air Fry Function with tray:** for perfectly fried foods, such as vegetables and chips.
- **Pyrolytic self-cleaning:** automatically cleans the oven, just wipe out the ash.
- **PerfectRoast Plus:** knows exactly when your roast is done.
- **Recipe World:** delicious inspirations that match your taste.

Technical Data

Color / Material Front : Black
Built-in / Free-standing : Built-in
Door opening : Drop down
Cleaning : Pyrolytic+Hydrolytic
Control Panel Material : Glass
Door Material : Glass
Dimensions (HxWxD) : 595 x 594 x 548 mm
Dimensions of the packed product (HxWxD) : 670 x 680 x 670 mm
Min. required niche size for installation (HxWxD) : 585-595 x 560-568 x 550 mm
Cavity dimensions : 357 x 480 x 415 mm
Usable volume of cavity : 71 l
Number of interior lights : 1
Net weight : 39.3 kg
Gross weight : 41.7 kg
EAN code : 4242005326877
Connection Rating : 3600 W
Fuse protection : 16 A
Voltage : 220-240 V
Frequency : 50; 60 Hz
Length electrical supply cord : 120.0 cm



4 242005 326877

Series 8, Built-in oven, 60 x 60 cm, Black HBG976MB1A

The built-in oven with Digital Control Ring and TFT-touchdisplay, Assist function for meals, Air Fry, PerfectRoast Plus, Home Connect for control via the App.

Heating Functions

- Oven with 14 heating methods: 4D HotAir, Top/bottom heating, Hot air grilling, Full width grill, Half width grill, Pizza setting, Bottom heating, Slow cooking, Defrost, Preheat ovenware, Keep warm, Hotair gentle, Conventional heat gentle, AirFry
- Temperature range 30 °C - 300 °C
- Cavity volume: 71 net usable litres

Hook-in racks / rails

- Number of shelf levels: 5
- 1 set of level independent telescopic rails (Clip-on rail), pyrolytic proof, fully extendable, safety stop function

Design

- Carbon Black Design
- Anthracite enamel cavity with 5 shelf positions
- Touch control
- Digital Control Ring

Cleaning

- Pyrolytic self-cleaning function
- Cleaning Assistance (HydroClean program)

Convenience

- TFT-Touchdisplay Plus
- Automatic temperature proposal, Residual heat indicator, Actual temperature display, Meat probe function
- Air Fry Function
- PerfectRoast Plus
- Bosch Assist - a menu of dishes for automatic cooking
- HomeConnect
- Oven Assistant with Voice Control
- Automatic rapid heat function
- Drop down door
- Oven door with SoftOpen and SoftClose
- Integrated cooling fan
- LED lighting
- Electronic clock/timer with end time programming

Accessories

- 1 x Air-Fry grid, 2 x combination grid, 1 x universal pan

Safety and Environment

- Electronic door lock, Child lock, Automatic safety switch off function, Residual heat indicator, Start button, Door contact switch
- Quadruple glazed CoolTouch door
- Low door temperature during pyrolytic cleaning
- Full glass inner door

Technical Info

- Length of mains cable: 120 cm
- Nominal voltage: 220 - 240 V
- Total connected load electric: 3.6 KW

Dimensions

- Appliance dimensions (HxWxD): 595 mm x 594 mm x 548 mm
- Installation dimensions (HxWxD): 585 mm - 595 mm x 560 mm - 568 mm x 550 mm
- Please reference the built-in dimensions provided in the installation drawing

Series 8, Built-in oven, 60 x 60 cm, Black HBG976MB1A

Installing two appliances on top of each other
other
Air exchange

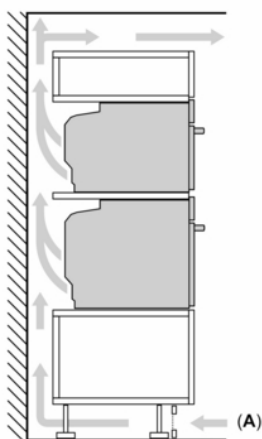

If the appliance will be installed underneath a hob, the following worktop thicknesses (including substructure if necessary) must be taken into account.

Hob type	min. worktop thickness	
	fitted	flush
Induction hob	37 mm	38 mm
Full surface Induction hob	47 mm	48 mm
Gas hob	30 mm	38 mm
Electric hob	27 mm	30 mm

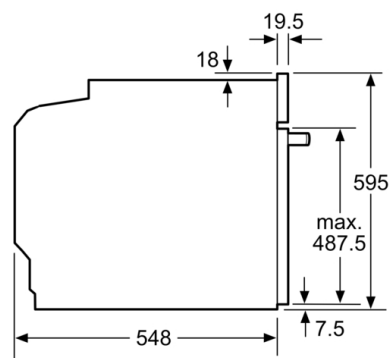
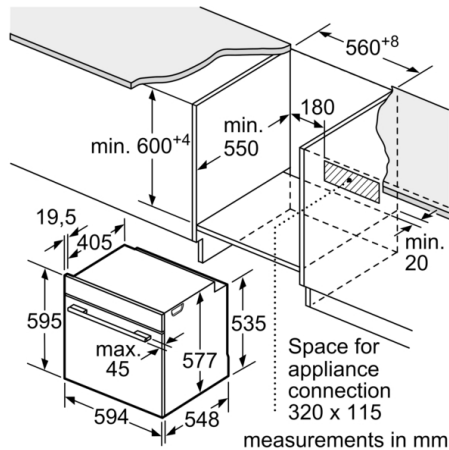

measurements in mm

