

Specifications

It is a requirement of State Plumbing Codes that licensed plumbers carry out all tapware installations. All installations should comply with the relevant requirements of AS/NZS 3500 and local plumbing codes.

Pressure:

[1] Maximum Hydrostatic Pressure: 1000kpa. This pressure may be exceeded only under test conditions as per AS/NZS 3500. Where hydrostatic pressure exceeds the maximum stated above, pressure-limiting valves should be installed.

[2] Recommended Maximum Hydrostatic Pressure: 500kpa (AS/NZS 3500). [3] Recommended Minimum Hydrostatic Pressure: 150kpa

Temperature:

Maximum Water Temperature: 80° C. For optimum performance, hot and cold inlet water pressure should be equal.

Care and Maintenance

[1] Product should be inspected for surface damage prior to installation. [2] Cleaning and handling of all finishes must be performed carefully. [3] Clean products using a soft cloth with warm soapy water only. [4] Never use harsh detergents or abrasive cleaners as these will damage the product. [5] Water marks can be removed from Matt Finishes with an application of a carnauba wax based non-abrasive polish on a microfibre cloth. [6] Do not use undue pressure when cleaning and wipe in one direction only. [7] Contact with harsh chemicals such as hair dye, hair bleach etc with result in damage to the finish. [8] Tapware should never be installed using acetone silicones. [9] Avoid the use of wax based furniture creams as this can result in a build up of deposits which will detract from the appearance. [10] Rose Copper: A protective lacquer has been applied to this finish. This is required to maintain the stability of this finish and will be damaged if the above care and cleaning instructions are not followed. [11] Damage to finishes arising from improper installation or post installation use or failure to observe the above care and cleaning instructions will void all warranty agreements.

Warranty

Rogerseller tapware, bathroom fittings and sanitary ware are covered by a five (5) year warranty from date of purchase. For full terms and conditions please refer to rogerseller.com.au

Rogerseller Showrooms —

Melbourne
173-177 Barkly Avenue
Burnley VIC 3121
P 03 9429 8888

Sydney
18 Danks Street
Waterloo NSW 2017
P 02 8396 8700

Brisbane
74-76 McLachlan Street
Fortitude Valley QLD 4006
P 07 3251 4333

Concept Stores —

**Southern Innovations
(Fishwick ACT)**
P 02 6143 2666

**Southern Innovations
(Mitchell ACT)**
P 02 6129 7666

**Southern Innovations
(Albury NSW)**
P 02 6022 2777

**Routleys Plumbing Innovations
(Malvern SA)**
P 08 8291 3000

rogerseller

rogerseller.com.au

Arq ii
by Rogerseller

Floor Mount Bath Outlet

Installation
Instructions

rogerseller

Arq ii by Rogerseller

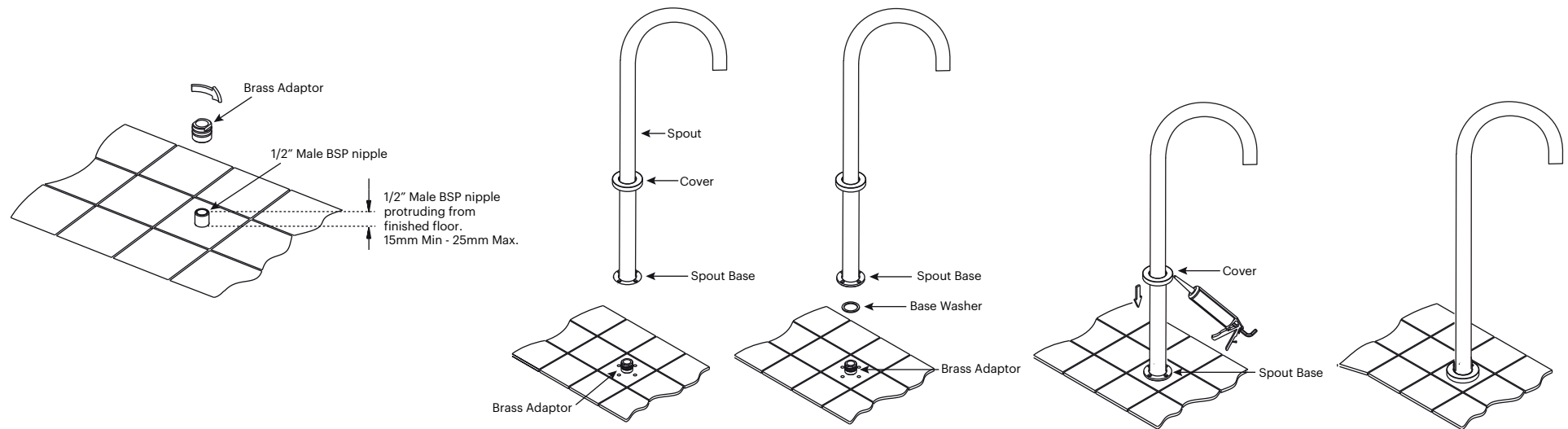

Arq ii by Rogerseller Floor Mount Bath Outlet

3646000901 — Chrome

4 finishes available

Installation

1. The Brass Adaptor requires an existing 1/2" BSP threaded male nipple protruding from the floor. Screw brass Adaptor Nipple to the 1/2" BSP threaded male nipple.
2. Carefully slide the cover up the spout. Place the spout over the Brass Adaptor Nipple and swivel the entire spout to the desired orientation. Once in position mark the fixing holes through the spout base. Remove the spout and the Brass Adaptor Nipple and drill holes. Note: Before drilling holes care should be taken to protect the 1/2" BSP threaded male nipple from damage and also choosing the correct type of fasteners to be used.
3. Apply thread tape or sealant to the 1/2" BSP threaded male nipple. Then screw on the brass adaptor nipple until flush with the finished floor. Insert the Base Washer into the recess of the Spout Base and place the Spout over the Brass Adaptor Nipple ensuring that the Base Washer is located between the finished floor and Spout Base. Once the spout is in the desired orientation then fix to the floor with appropriate fasteners.
4. Apply a bead of non acetone silicone around the base of the cover and carefully slide it over the spout base.

Please leave instructions with the tap or home owner