

### A81.05.48

#### WALL SET

[AVAILABLE WITH FLOW CONTROL, ADD **.FC** TO END OF CODE - 6 STAR/3.5Lpm WELS RATING]

STANDARD WITH INDENT HANDLE  
OTHER LEVER HANDLE OPTIONS

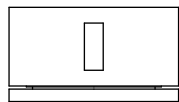
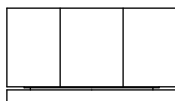

**.V2** PIN HANDLE

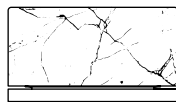

**.V3** WHITE CARRARA MARBLE  
**.V4** BLACK MARQUINA MARBLE

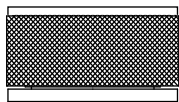

**.V5** KNURLED

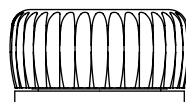

**.V6** REEDED

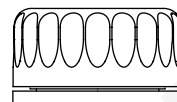

**.V7** FLUTED

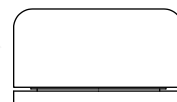

**.V8** ROUND DIAL

- Tapware to be installed by a licenced plumber in accordance with AS/NZS 3500:2003
- Recommended working water pressure 150 - 500kPa
- Maximum water temperature is 65 deg°C
- Ensure only parallel thread fittings are used (not tapered thread)
- After completing the installation check function of tapware and ensure no water leaks.

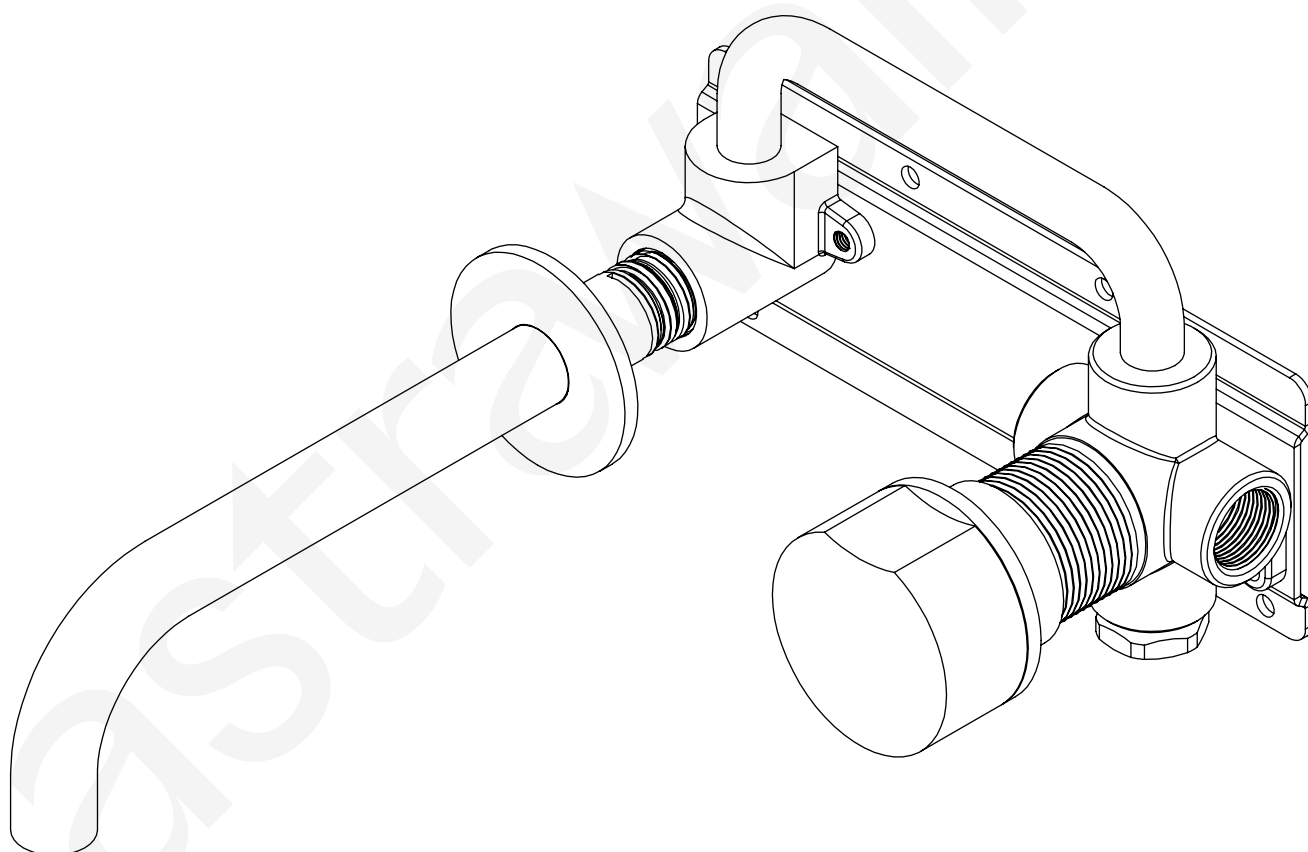

A81.05.48

WALL SET

[AVAILABLE WITH FLOW CONTROL, ADD **.FC** TO END OF CODE - 6 STAR/3.5Lpm WELS RATING]

Install the wall breach supplied to a secure nogging at the correct depth as shown in the drawing below. Ensure the breach is square and parallel between the wall studs. To allow the tapware to fit correctly the thickness of the finished wall surface must be calculated prior to 'rough-in'.

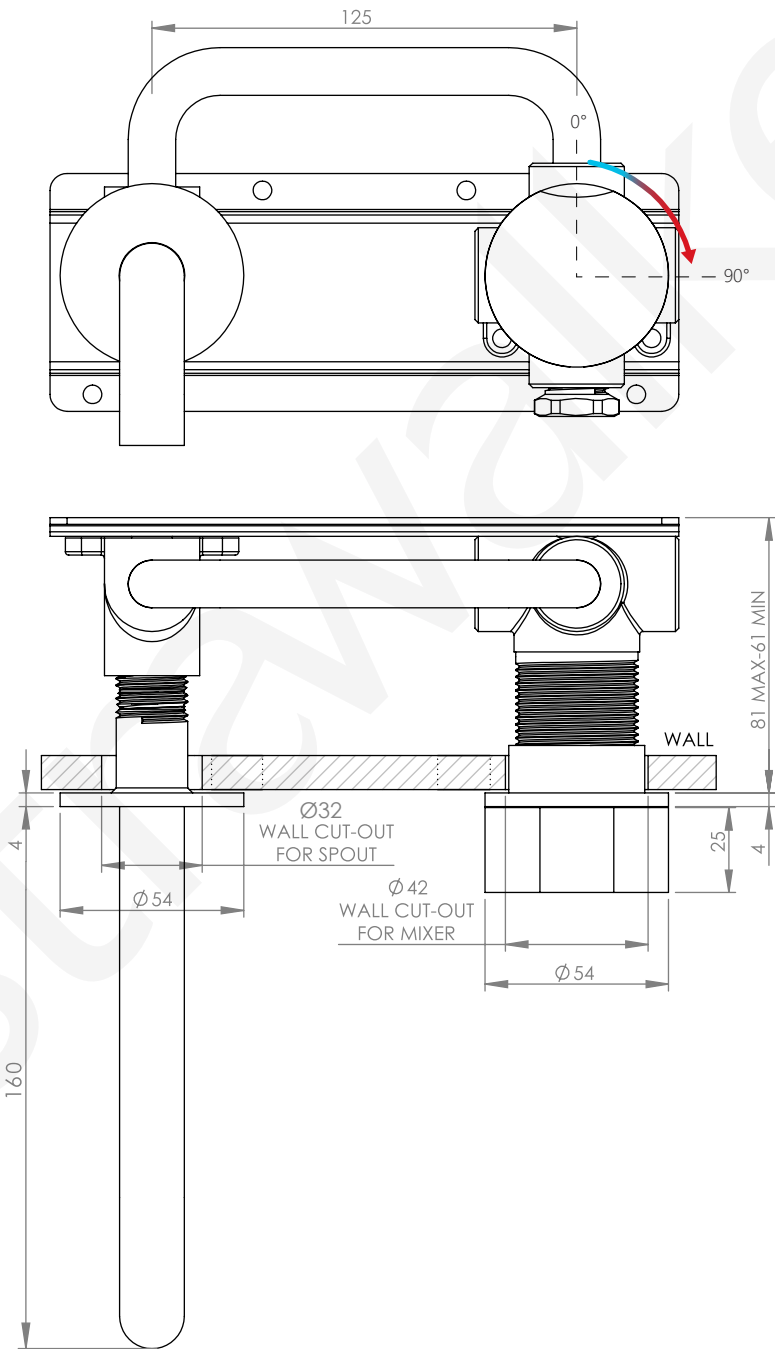

### A81.05.48

#### WALL SET

[AVAILABLE WITH FLOW CONTROL, ADD **.FC** TO END OF CODE - 6 STAR/3.5Lpm WELS RATING]

Ensure water lines are completely flushed prior to connecting the mixer.

Prior to fit off ensure the correct size cut-out around the mixer and spout has been achieved.

Secure the cover flange for the mixer to the mixer body and ensure this is sealed and water-tight. If required, cut spindle spline to suit installation using the handle as a guide for correct tolerance. Attach handle to the spindle spline and adjust into correct position. Tighten well using an Allen Key.

To fit-off the outlet, apply sealing tape (Teflon) to male thread. Fit and align the outlet into the breach.

