

MINT WALL MIXER AND OUTLET

[328200]

NOTE

- Secure the mixer body to a suitable noggin, take note of the finished wall dimension to ensure the mixer body is positioned correctly.
- The mixer must be installed square to the finished tile face to ensure the cover-plate sits flush.
- During rough in always make sure the protective cover is left on to prevent damage to the mixer.
- Brazed connections should NOT be made directly onto the mixer as excessive heat will damage it.
- Supply pipe work must be flushed clean before installation.
- Maximum working pressure 1000kpa. Minimum working pressure 100kpa. Recommended working pressure 200 – 500kpa.
- Full installation instructions come with the product.

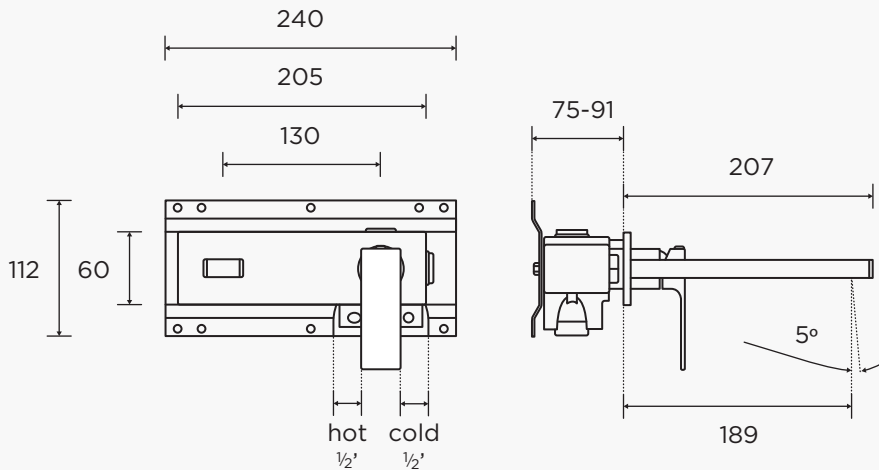

1.

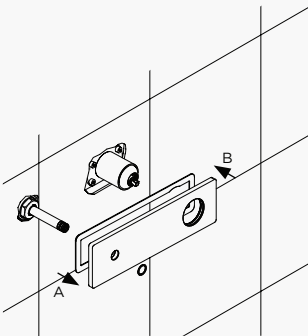

2.

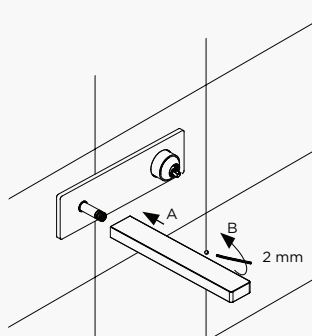

3.

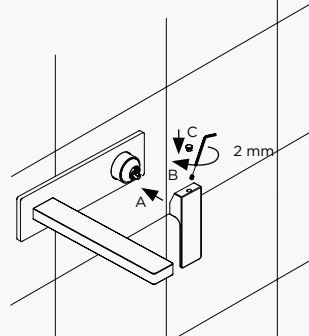

4.

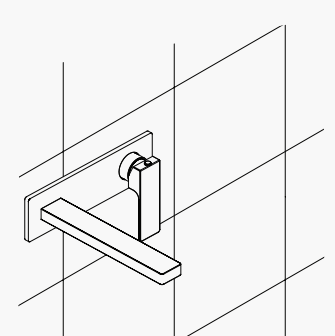

5.

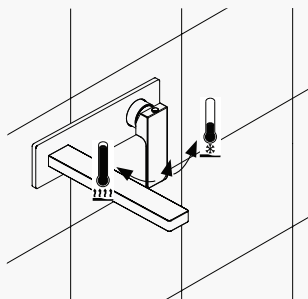

6.

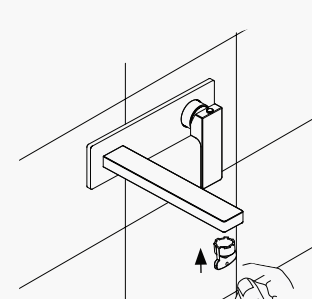

7.

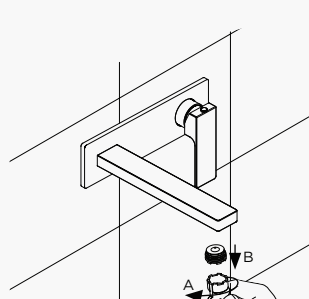

8.

