



HOSHIZAKI

KM-1301 SAJ-E

Crescent Ice Maker

PRODUCT FEATURES

- Individual premium crescent cube.
- Stainless steel evaporator.
- Protected by HoshiGuard Antimicrobial Agent.
- CycleSaver Design.
- EverCheck alert system.
- Durable stainless steel exterior.
- Removable air filters.
- 3 years parts and labour on the entire unit, 5 years (parts only) on compressor and air cooled condenser coil.

CUBE SIZE:

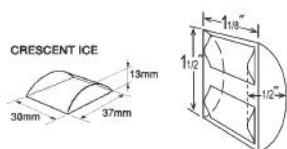

TECHNICAL DRAWING

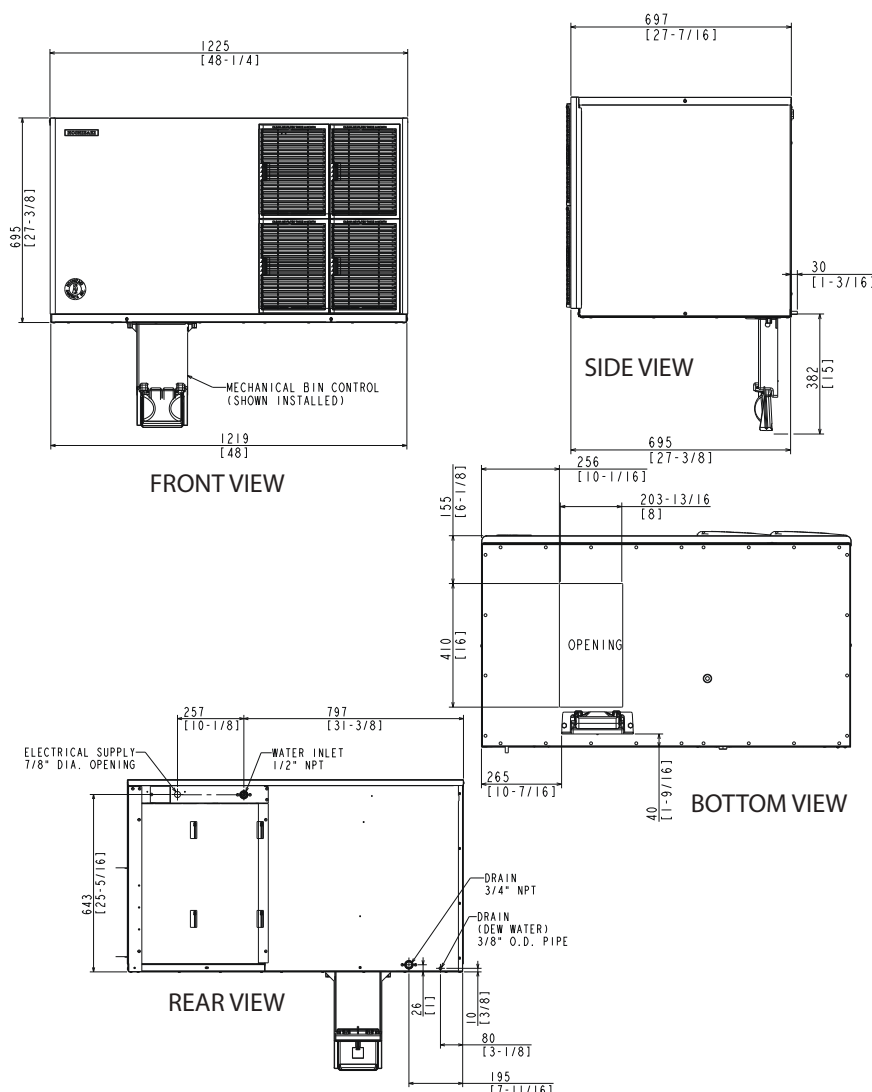

PRODUCT SPECIFICATION

Production Capacity per 24hours	Approx. 624kg @ 21°C Air temp; 10°C Water Approx. 501kg @32°C Air temp;21°C Water
Max Storage Capacity	Shown on optional bin -B 801
Freeze Cycle Time	Approx. 33-44Min
Ice Production Per cycle	Approx. 16.3kg/1440pcs
Dimensions	1219mm (W) x 695mm (D) x 695mm (H)
Cooling	Air
Weight Net/Gross (kg)	136/154
AC Supply Voltage	1 PHASE 220-240V 50Hz
Amperage	Running: 11.35A
Refrigerant Charge	R404A
Operating Conditions	Ambient Temp.: 7-38°C Water Supply Temp.: 7-32°C Water Supply Pressure: 69-779KPa Voltage Range: 198-254V
Double Production Capacity	Achieved by stacking these units on top of each other. For pricing please contact your Hoshizaki Sales Rep.



Descriptions and specifications are subject to change at any time, without notice. Illustrations for demonstration purposes.

Copyright © 2019 Hoshizaki Lancer Pty Ltd. All right reserved. E&OE Date: Oct 2019