

Installation Guide

Heated Rail - 24V

PLEASE FOLLOW THIS INSTALLATION GUIDE CLOSELY - Failure to do so could void the warranty - This installation procedure has been carefully designed and works very well However, it may be different to other products and your own experience. The supplied fixings are specially designed for this product - please do not substitute them!

COMMON ISSUES TO BE AVOIDED

- Install the supplied twin multi strand wire - do not use thicker wire.
- Install a separate wire for each rail back to the transformer - do not daisy chain.
- Avoid installing on grout lines - this is the weakest point of the tile.
- The transformer must be installed in a ventilated accessible location.
- The supplied low voltage wire is 2.5 meters, however this can be extended (5 meters Max).

In-Wall Kit





Transformer
24V



Heated Towel
Rail



SPECIFICATIONS

Voltage 24 Volts AC or DC (No Polarity)	Standards EN/AS/NZ 60335.2.43	AUSTRALIAN MANUFACTURER 
Material Brass	Electrical Connection Concealed Wiring	HEATING TIME 30 MINUTES 
Finish Polished, Brushed, Matte	Heating Method Dry Internal Heating Element	WARRANTY 10 YEAR 
Ingress Protection IPX5 (Suitable for wet areas)	Required / Sold Separately In-Wall Kit - per rail	



A licensed electrician is required to carry out the installation of Heated Towel Rails using the Concealed Wiring System (In-Wall Kit).



A timer should be fitted to control the mains supply to the transformer, in order to prolong the life of the heating elements, transformer and save energy.

WARRANTY

The warranty covers products against defective materials and workmanship for a period of 10 years from the date of purchase. Transformers are warranted for 5 years and labour is covered for the first 12 months only. Please note this warranty does not cover installation issues - if you are having difficulties with installation we are happy to assist. For technical support please contact servicedept@rogerseller.com.au

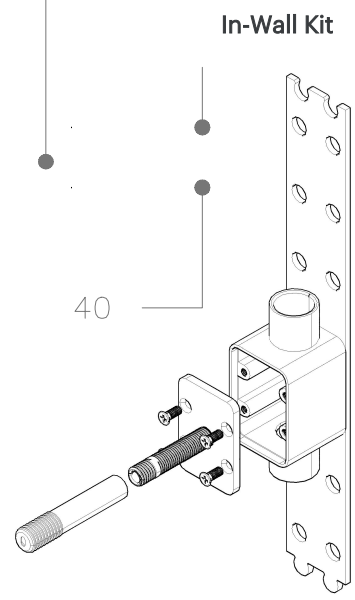
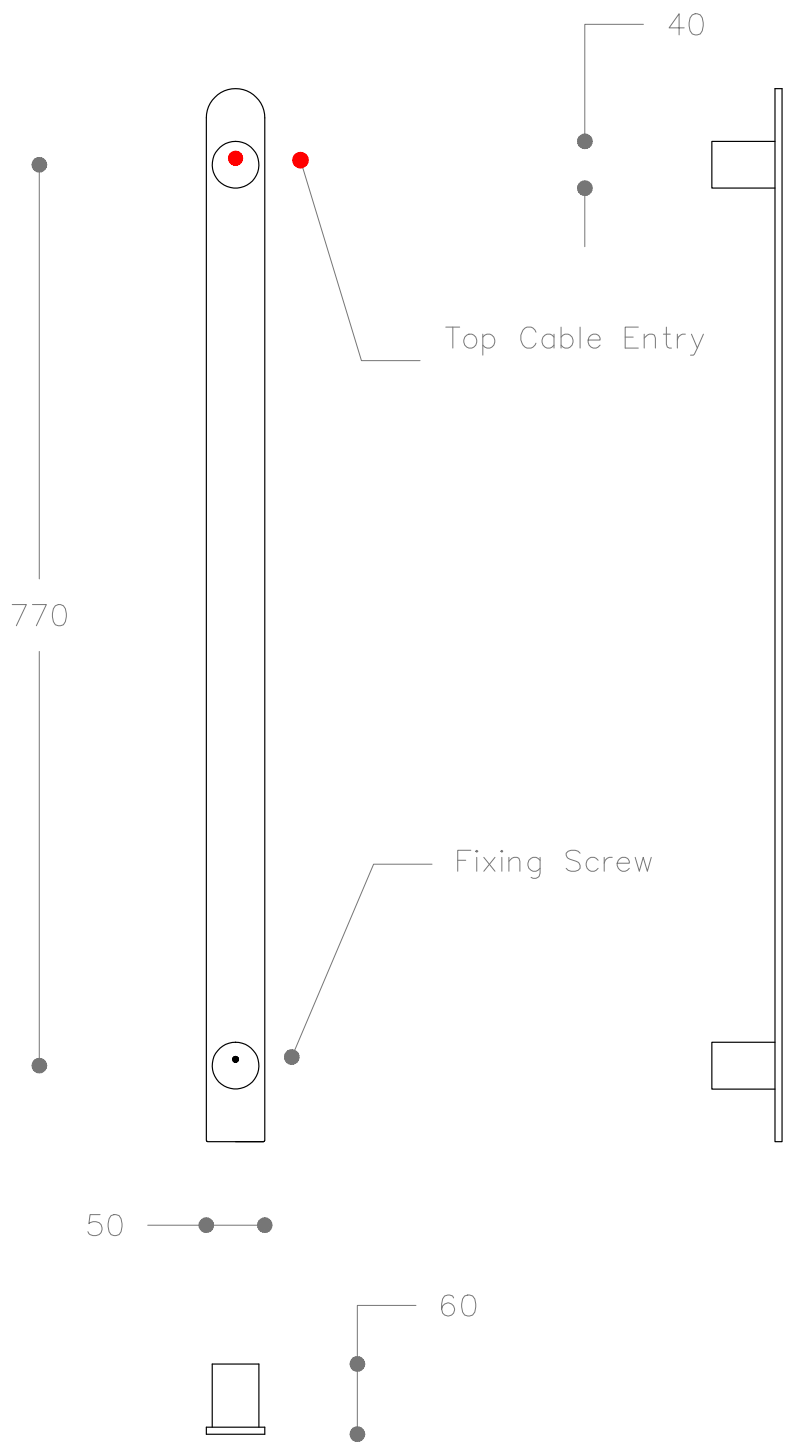

DIMENSIONS

Depth	H1 (Fixings)	H2 (Overall)
60mm	770mm	900mm

Recommended Spacing

160-400mm
Typical 300mm
(40mm Increments)

1-3 Rails recommended per
Bathroom

Click-On Rail Removal Guide

REMOVAL PROCEDURE

- The rail uses a Click-On system to attach onto the wall mounting components (no grub screws).
- To remove (un-click), use a suitable piece of timber (similar in dimensions to the space behind the rail), to lever the rail off the wall.
- Gently lever the rail on one side and then the other just enough to un-click the fixing (5-10mm).
- Remove rail from wall - The electrical connection will unplug automatically.

CORRECT

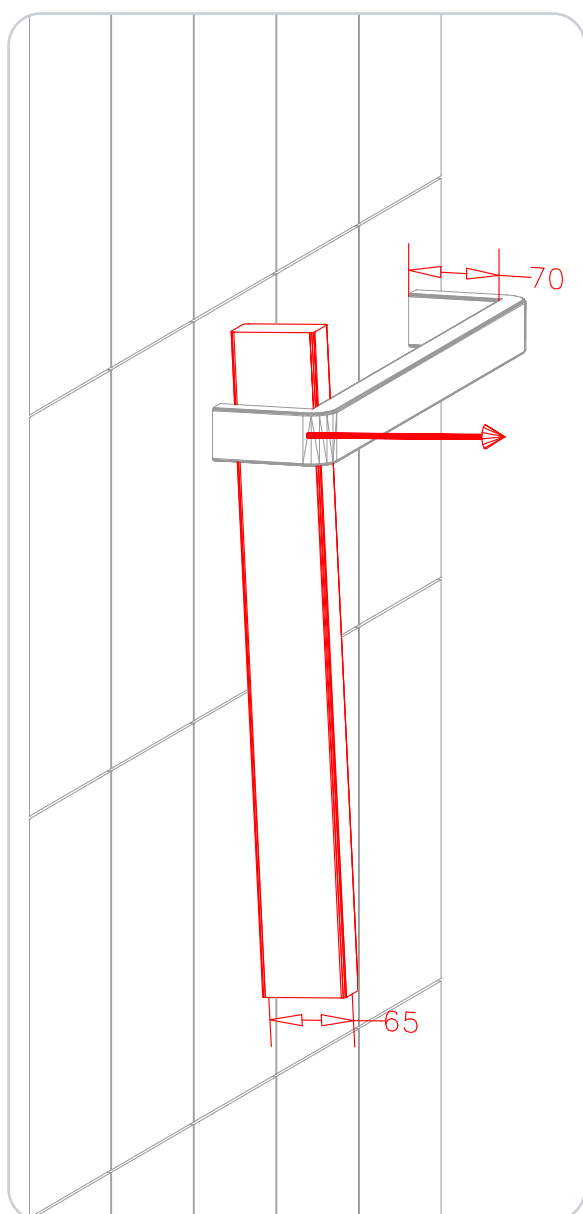

INCORRECT

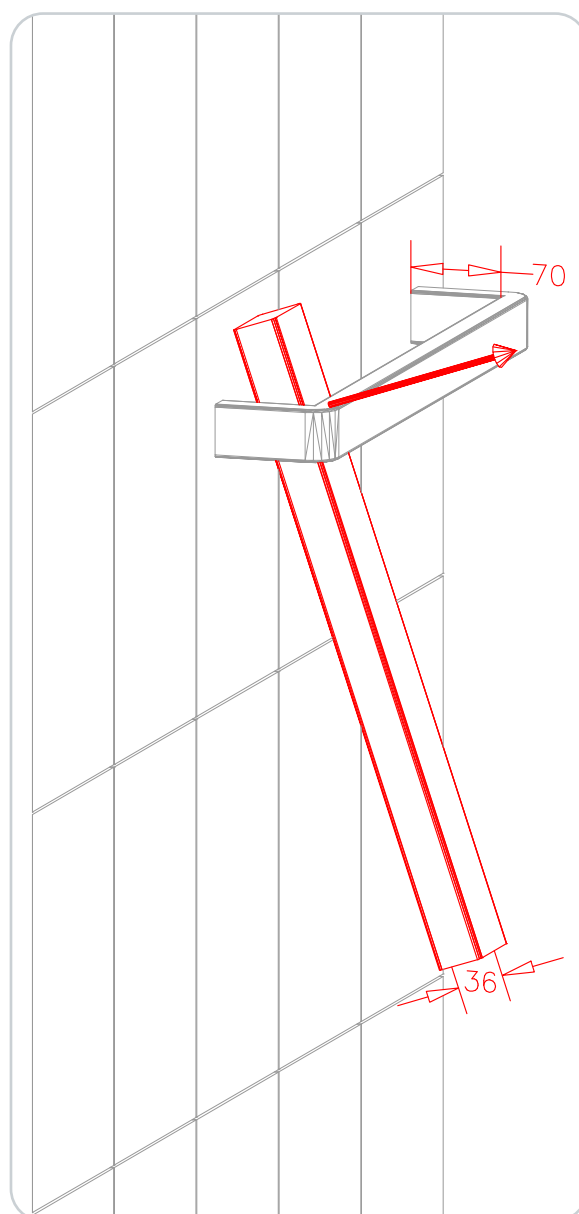

Note: It is very important that the rails are very securely fixed to the wall in order to allow the rails to be removed if needed.