

LK30C

ABEY LAUNDRY TROUGH WITH
BYPASS AND OVERFLOW



INCLUDED ACCESSORIES



VPBW



VPBK



ICE10



LY011A

DIMENSIONS

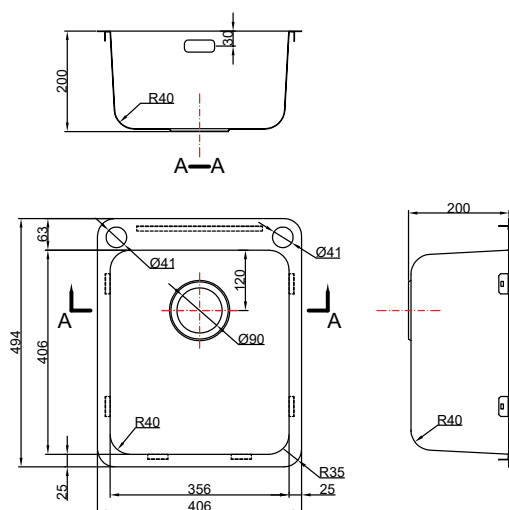

SPECIFICATIONS

Description	45L Laundry Drop In Bowl (2TH)
Overall Sink Size	L605mm x W505mm x D240mm
Bowl Dimensions	L513mm x W413mm x D240mm
Drain Length	N/A
Technic	Pressed
Material	Stainless steel SUS304

INSTALLATION

Fixings	Clips
Min Cabinet Size	700mm
Tap Holes	1 x 90mm round compatible with waste disposal

SURFACE FINISH



SILK

WASTE KIT

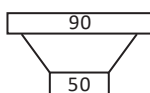

MATERIAL



PLUMBING

Waste Fittings	1 x (90mm x 2") basket wastes included
Overflow	Yes

INSTALLATION OPTIONS



TOPMOUNT

PACKAGING

Net Weight	4.1kg
Carton Size	540mm x 450mm x 240mm
Pack QTY	1